

VOLLEYBALL JUDGE'S STAND

669100

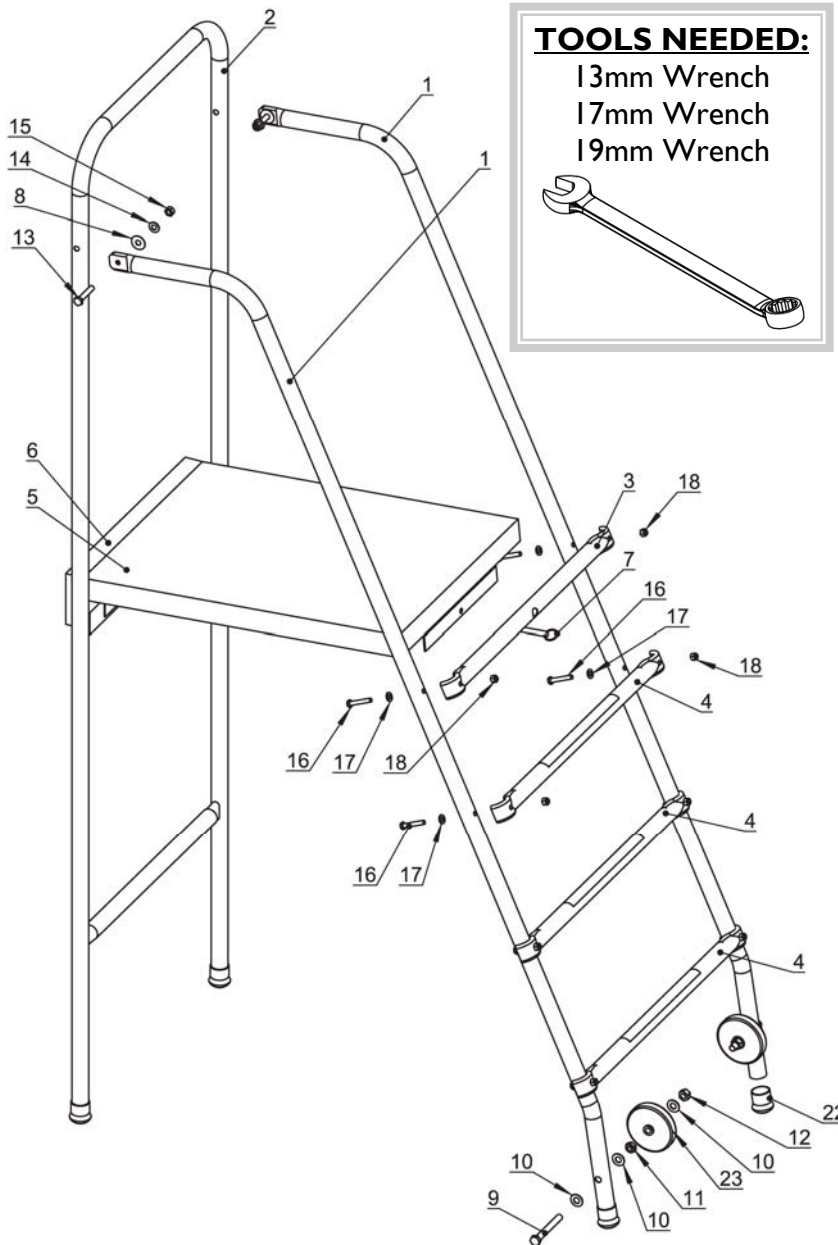

Item	Description	QTY
1	Ladder frame	2
2	Front frame	1
3	Ladder cross bar –top	1
4	Ladder cross bar	3
5	Platform	1
6	Front pad	1
7	Lock pin	1
8	Teflon washer	2
9	Hex bolt –M12x100	2
10	Flat washer –M12	4
11	Hex nut –M12	2
12	Lock nut –M12	2
13	Hex bolt –M10x57	2
14	Flat washer –M10	2
15	Lock nut –M10	2
16	Hex bolt –M8x50	8
17	Flat washer –M8	8
18	Lock nut –M8	8
*19	Philips screw –M6x55	8
*20	Philips screw –M6x35	6
*21	Flat washer –M6	14
*22	End cap	4
23	6" wheel	2

1. Unpack all parts and check against parts list to ensure that all have been included.

**Pre-assembled*

2. Assemble Ladder frame(1) to Front frame(2) using Hex bolt M10x57mm(13), Teflon washer(8), Flat washer M10(14), and Lock nut M10(15). The Teflon washer(8) should be placed between the Front frame(2) and Ladder frame(1).

3. Attach Ladder cross bar-top(3) [with hole for lock pin] to the Ladder frame(1) using Hex bolt M8x50(16), Flat washer M8(17), and Lock nut M8(18). NOTE: the pin hole should be horizontal after installation

4. Pull up the Platform(5) and place its metal bracket over the Ladder cross bar-top(3). Align the hole in the bracket with the hole in the Ladder cross bar-top(3). Slide the Lock pin(7) all the way thru aligning the holes until it is locked.

5. Attach Ladder cross bar (4) [with non-slip pad] to the Ladder frame(1) using Hex bolt M8x50(16), Flat washer M8(17), and Lock nut M8(18). NOTE: non-slip pad MUST face up.

6. Assemble the Wheel(23) to the bottom of the Ladder frame(1) using Hex bolt M12x100(9), Washer M12(10), Hex nut M12(11), and Lock nut M12(12). Fasten the Hex nut M12(11) to make sure the Hex bolt(9) is fixed securely, and loosen the Lock nut M12(12) to allow the Wheel(23) to spin smoothly.

7. Check all connections, and tighten all bolts & nuts

(888) 277-7778

VOLLEYBALL JUDGE'S STAND

669100

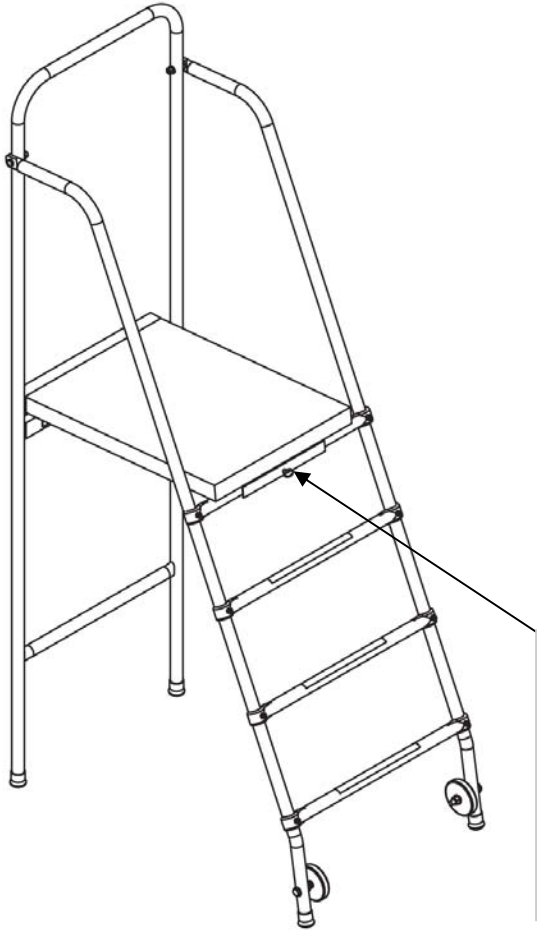

WARNING

MAXIMUM ALLOWABLE LOAD IS 250 POUNDS. DO NOT LEAN ACROSS RAILINGS OR THE UNIT MAY TOPPLE OVER. ONLY ONE PERSON SHOULD BE ON THE STAND AT ANY TIME.

PADDING IS STRONGLY RECOMMENDED!



WARNING: This product can expose you to Vinyl Chloride, which is known to the State of California to cause cancer. For more information go to www.p65warnings.ca.gov.

LOCK PIN (7) MUST BE FULLY INSERTED THRU THE PLATFORM BRACKET TO SAFELY LOCK IT INTO POSITION.

YOU MUST CHECK THIS CONNECTION BEFORE EVERY USE.

- THE OPERATION AND TRANSPORT OF THIS JUDGE'S STAND MUST BE DONE BY AUTHORIZED ADULTS ONLY, WHO ARE PHYSICALLY CAPABLE OF PERFORMING THESE OPERATIONS.
- INSPECT THE UNIT BEFORE EACH USE FOR LOOSE OR MISSING HARDWARE, DAMAGED COMPONENTS, AND REPAIR OR REPLACE BEFORE USING THE UNIT.
- DO NOT CLIMB, LEAN, PLAY, OR PERFORM TRAINING DRILLS ON THE STAND.
- AT NO TIME SHOULD THIS JUDGE'S STAND BE TRANSPORTED WHILE IT IS IN THE PLAYING POSITION. THE PLATFORM MAY DISENGAGE FROM THE LADDER UNEXPECTEDLY, CAUSING THE JUDGE'S STAND TO COLLAPSE SUDDENLY.
- AT ALL TIMES DURING THE FOLDING, TRANSPORTING AND UNFOLDING OPERATIONS, KEEP HANDS, FINGERS, FEET, ETC. AWAY FROM ALL PINCH OR CRUSH POINTS.
- ALTERATION OR MODIFICATION OF EQUIPMENT MAY BE HAZARDOUS. USE ONLY AS INTENDED.

THE OWNER OF THIS EQUIPMENT IS RESPONSIBLE TO ENSURE THAT ALL INDIVIDUALS FOLLOW THESE SAFETY AND OPERATING INSTRUCTIONS TO AVOID INJURIES OR PROPERTY DAMAGE.

PROPER USE AND SUPERVISION OF THIS EQUIPMENT IS ESSENTIAL TO HELP REDUCE THE POSSIBILITY OF ACCIDENTS OR INJURIES.

(888) 277-7778