

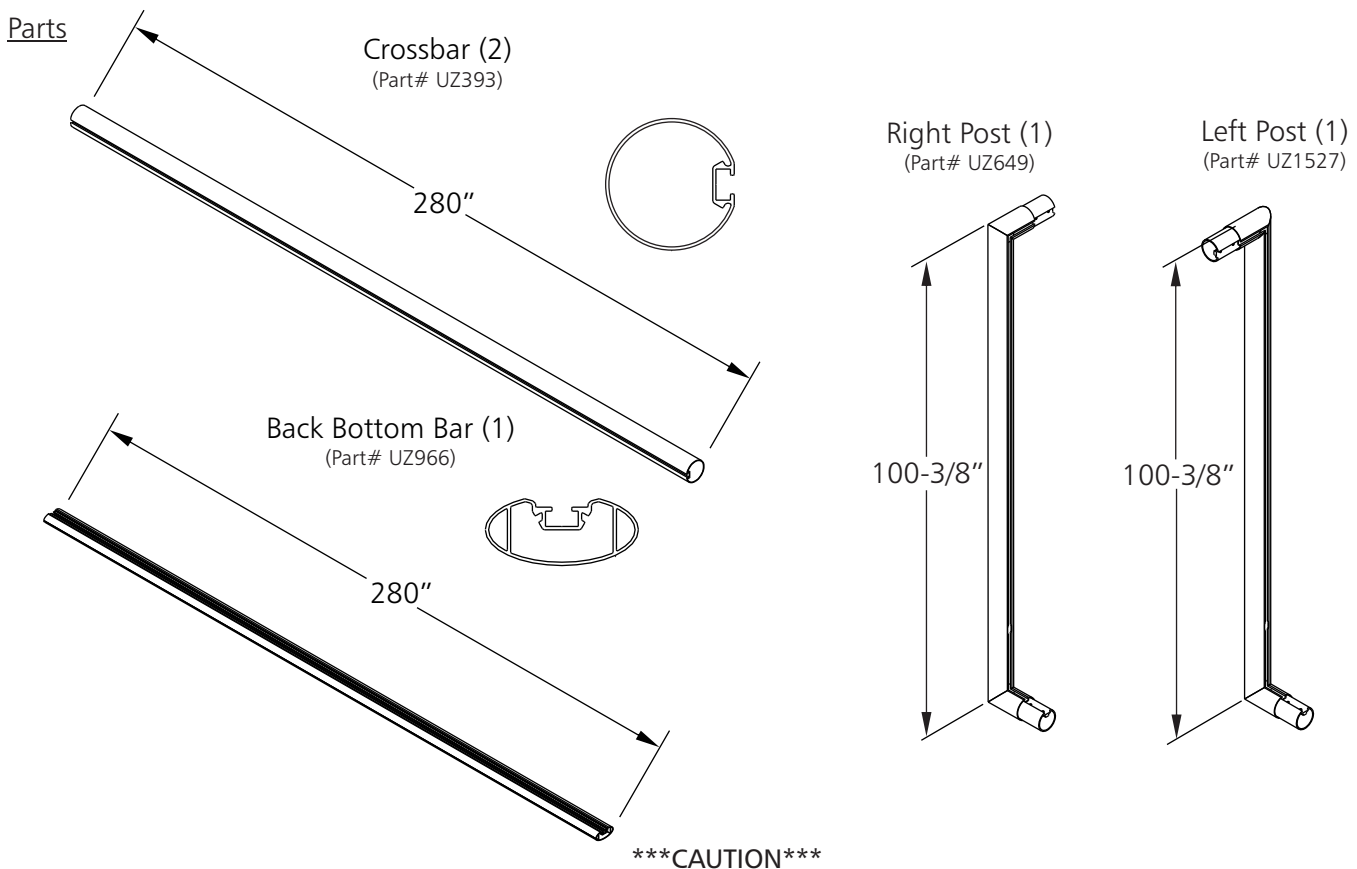

## ASSEMBLY INSTRUCTIONS FOR 2B9006 & 2B9006SW PRO PREMIER<sup>®</sup> COPA GOAL

1. Unpack all parts and check for damage that may have occurred during shipping. If damage has occurred, notify Kwik Goal immediately. Lay out all parts. Remove all cardboard and packaging immediately. Wet or damp packaging may damage contents.
2. Read through entire instruction before beginning assembly and installation.

**NOTE:** Components may be packaged in one or more additional boxes.



This goal has been designed to be used for the game of soccer only. Goal posts must be anchored AT ALL TIMES and shall be secured against overturning. Do not climb on the net or goal framework at any time! All fastenings must be checked to insure they are fully tightened before and after each use of this product. Goal posts not in use must be disassembled and properly stored in a safe, secure area (See included Guidelines for Moveable Soccer Goal Safety.). Assembled goal posts should not be left unattended. Remove nets when goals are not in use. Do not use this equipment during the threat of high winds. Goal posts should be checked for safety before and after each use.

All warning and safety labels included with this product must be visible at all times.

Any modifications to this or any Kwik Goal product will void any and all warranties.

140 Pacific Drive Quakertown, PA 18951

(P) 215-536-2200 / (P) 800-531-4252 / (F) 215-536-4309 / (F) 800-778-8869

Visit our website @ [kwikgoal.com](http://kwikgoal.com)

© 2016, Rev. 2019 Kwik Goal Ltd.

NZ391 Rev. 07/15/19



**IMPORTANT GOAL SAFETY INSTRUCTIONS**  
**READ CAREFULLY**

1. Check for structural integrity and proper connecting hardware before every use. Replace damaged or missing parts or fasteners immediately.
2. Safety/Warning labels must be clearly visible.
3. Securely anchor moveable soccer goals at ALL times.
4. Always instruct players, managers, coaches, trainers, teachers, maintenance workers and all other personnel who might come in contact with the goal, on the safe handling of and potential dangers associated with moveable soccer goals.
5. Always exercise extreme caution when moving goals and provide adequate manpower to move goals of varied sizes and weights. Moveable soccer goals should only be moved by authorized personnel.
6. NEVER allow anyone to climb on the net or goal framework.
7. Moveable soccer goals should only be used on LEVEL fields, NEVER on a slope or hill area.
8. Remove nets when goals are not in use.
9. Most of the tip-over injuries occurred when goals were unattended. Anchor or chain one goal to another or to nearby fence posts, dugouts, or any other similar sturdy fixture when not in use. If this is not practical, store moveable soccer goals in a place where children cannot have access to them.
10. Fully disassemble goals for seasonal storage.

Left Base (1)  
(Part# UZ1520)

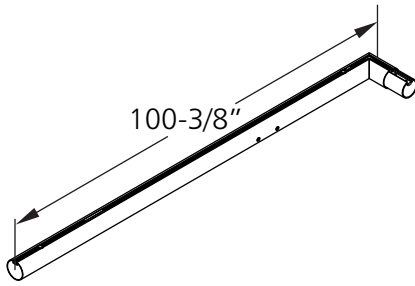

Right Base (1)  
(Part# UZ1521)

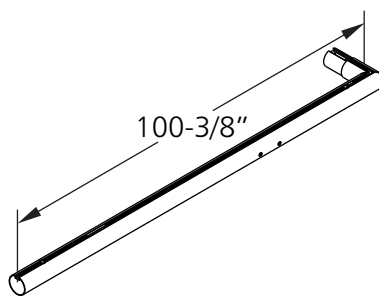

Back Pole (2)  
(Part# UZ1524)

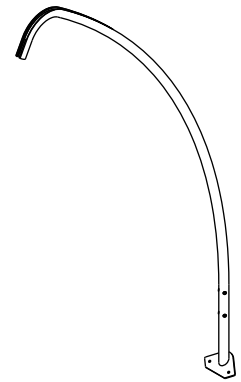

Back Pole Brace (2)  
(Part# UZ1525)

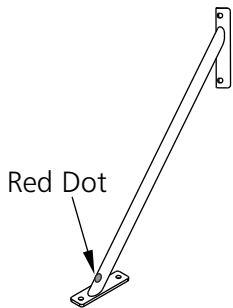

Back Pole Brace (2)  
(Part# UZ1526)

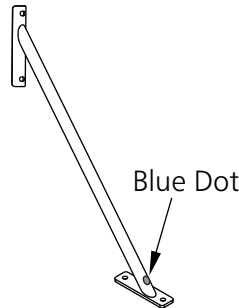

Back Bottom Bar  
Connector (2)  
(Part# UZ1033)

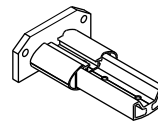

Post Brace (2)  
(Part# UZ737)

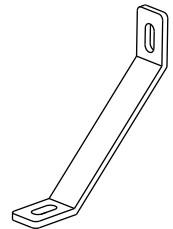

Channel Spacer (8)  
(Part# UZ812)

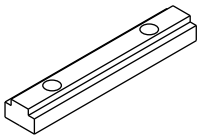

Back Pole Cap (2)  
(Part # VZ719)



Tamper Resistant  
Net Clip (100)  
(Part# 10B3401 Pack of 100)



Bolt Cap (4)  
(Part# VZ751)



Net Clip Driver (1)  
(Part# VZ140)

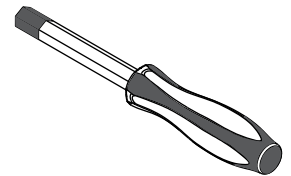

Ground Anchor (4)  
w/hardware  
(Part# 10B101 Set of 4)

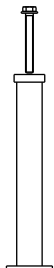

Chain (4)  
w/ Snap Link & Anchor Plate  
(Part# UZ846)

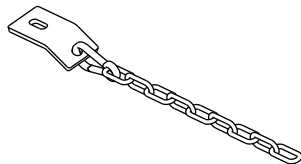

Anchor Bag (6)  
(Part# 10B1605)

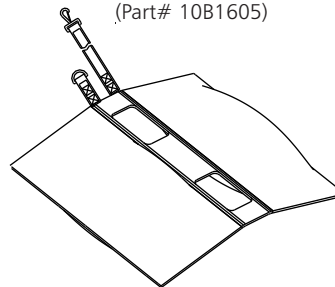

Net (1)  
(Part# 3B1502)

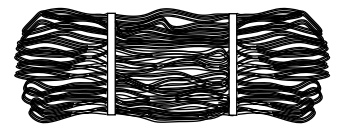

\*\*\*CAUTION\*\*\*

This goal has been designed to be used for the game of soccer only. Goal posts must be anchored AT ALL TIMES and shall be secured against overturning. Do not climb on the net or goal framework at any time! All fastenings must be checked to insure they are fully tightened before and after each use of this product. Goal posts not in use must be disassembled and properly stored in a safe, secure area (See included Guidelines for Moveable Soccer Goal Safety.). Assembled goal posts should not be left unattended. Remove nets when goals are not in use. Do not use this equipment during the threat of high winds. Goal posts should be checked for safety before and after each use.

All warning and safety labels included with this product must be visible at all times.

Any modifications to this or any Kwik Goal product will void any and all warranties.

Knob w/o Threads (4)  
(Part# VZ687)



Pole Rope  
Assembly (4)  
(Part# JZ222 Pack of 4)

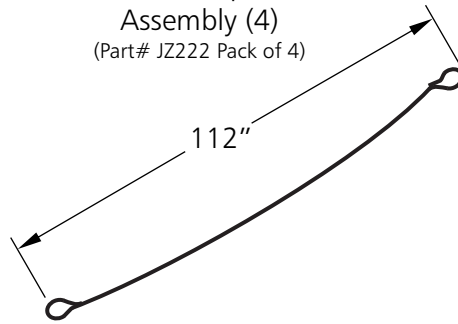

Net Rope  
Assembly (2)  
(Part# JZ215 Pack of 2  
w/ Snaplink)

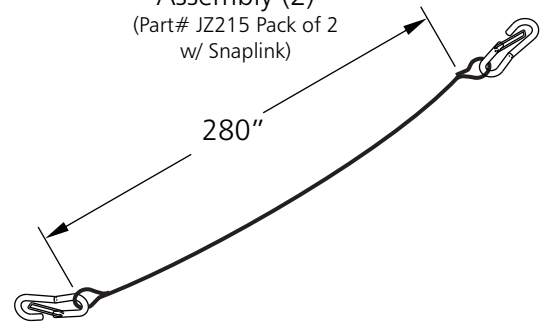

### Hardware

**Note:** Hardware may be packaged separately in one or more boxes. Open all packages before beginning assembly.

7/16" X 6" Hex Bolt (Part# TZ380)	(4)
7/16" Flat Washer (Part# TZ171)	(8)
7/16" Lock Nut (Part# TZ47)	(4)
3/8" x 1-3/4" Hex Bolt (Part# TZ227)	(16)
3/8" x 7/8" Hex Bolt (Part# TZ249)	(18)
3/8" x 5/8" Hex Bolt (Part# TZ383)	(4)
3/8" Lock Washer (Part# TZ65)	(36)
3/8" Flat Washer (Part# TZ60)	(40)
3/8" Square Nut (Part# TZ247)	(22)
5/16" X 1" Hex Bolt (Part# TZ121)	(8)
5/16" Flat Washer (Part# TZ269)	(8)
5/16" Lock Washer (Part# TZ122)	(8)
1/4" X 2" Eye Bolt (Part# TZ381)	(2)
1/4" Flat Washer (Part# TZ361)	(2)
1/4" Lock Nut (Part# TZ19)	(2)

### Assembly Tools

7/16", 1/2", 5/8",  
9/16" & 3/4"  
Wrenches

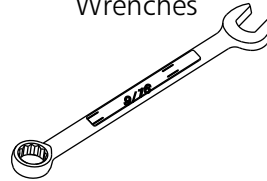

Ratchet with  
7/16", 1/2", 5/8",  
9/16" & 3/4"  
Sockets

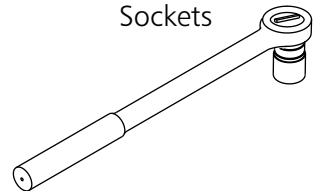

Rubber Mallet

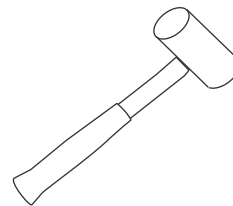

### \*\*\*CAUTION\*\*\*

This goal has been designed to be used for the game of soccer only. Goal posts must be anchored AT ALL TIMES and shall be secured against overturning. Do not climb on the net or goal framework at any time! All fastenings must be checked to insure they are fully tightened before and after each use of this product. Goal posts not in use must be disassembled and properly stored in a safe, secure area (See included Guidelines for Moveable Soccer Goal Safety.). Assembled goal posts should not be left unattended. Remove nets when goals are not in use. Do not use this equipment during the threat of high winds. Goal posts should be checked for safety before and after each use.

All warning and safety labels included with this product must be visible at all times.

Any modifications to this or any Kwik Goal product will void any and all warranties.

3. Attach left post and right post to crossbar using channel spacers and 3/8" hex bolts. Note direction of decals before fastening. Be sure connections are pressed firmly together before tightening hex bolts.
4. Insert one square nut in each of the assembled posts.

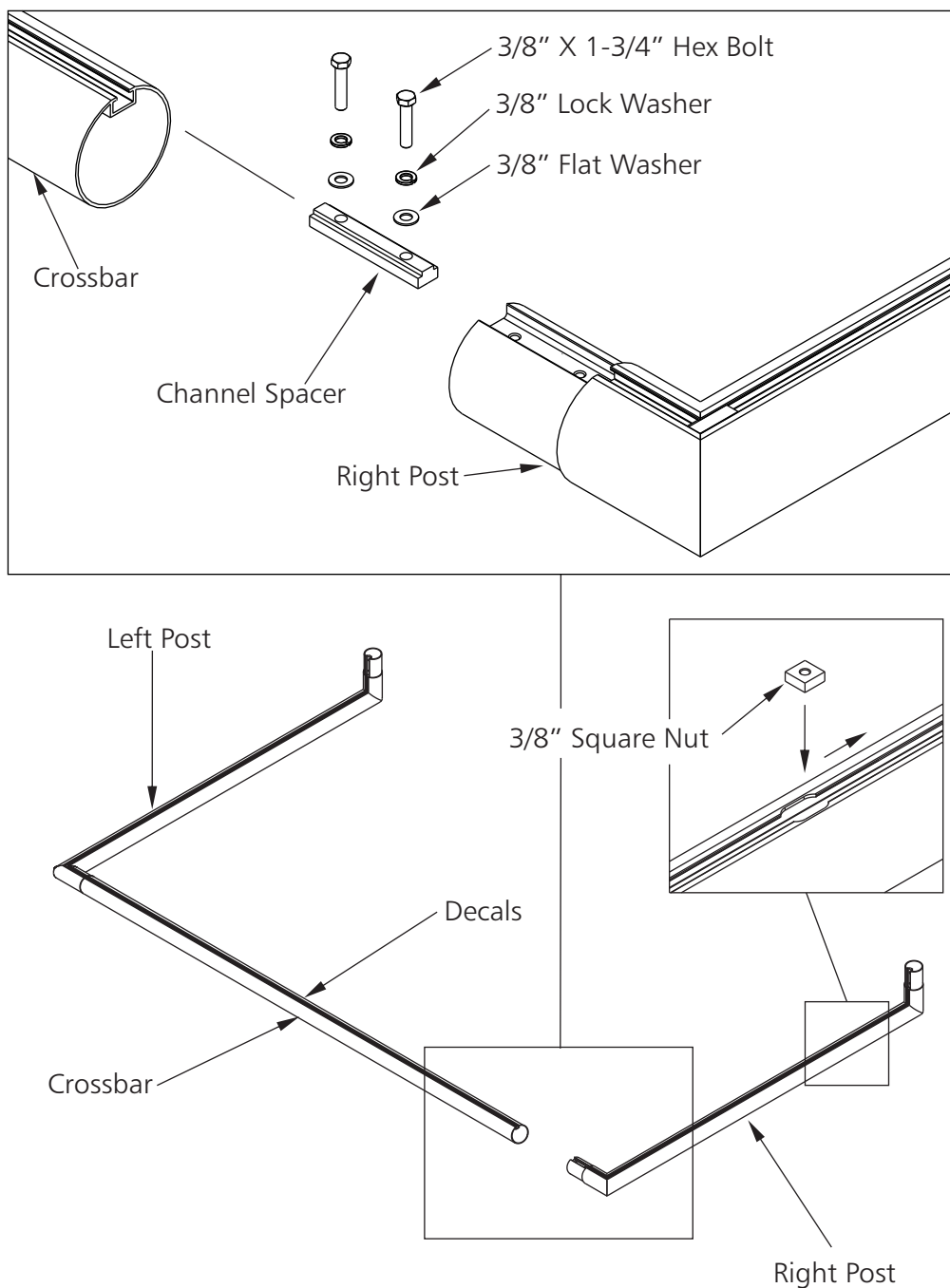

**\*\*\*CAUTION\*\*\***

This goal has been designed to be used for the game of soccer only. Goal posts must be anchored AT ALL TIMES and shall be secured against overturning. Do not climb on the net or goal framework at any time! All fastenings must be checked to insure they are fully tightened before and after each use of this product. Goal posts not in use must be disassembled and properly stored in a safe, secure area (See included Guidelines for Moveable Soccer Goal Safety.). Assembled goal posts should not be left unattended. Remove nets when goals are not in use. Do not use this equipment during the threat of high winds. Goal posts should be checked for safety before and after each use.

All warning and safety labels included with this product must be visible at all times.  
Any modifications to this or any Kwik Goal product will void any and all warranties.

5. Attach base to crossbar and bottom back bar as shown. Note direction of decals before fastening. Assemble all hardware first, then go back and tighten each bolt. Be sure connections are pressed firmly together before tightening hex bolts.

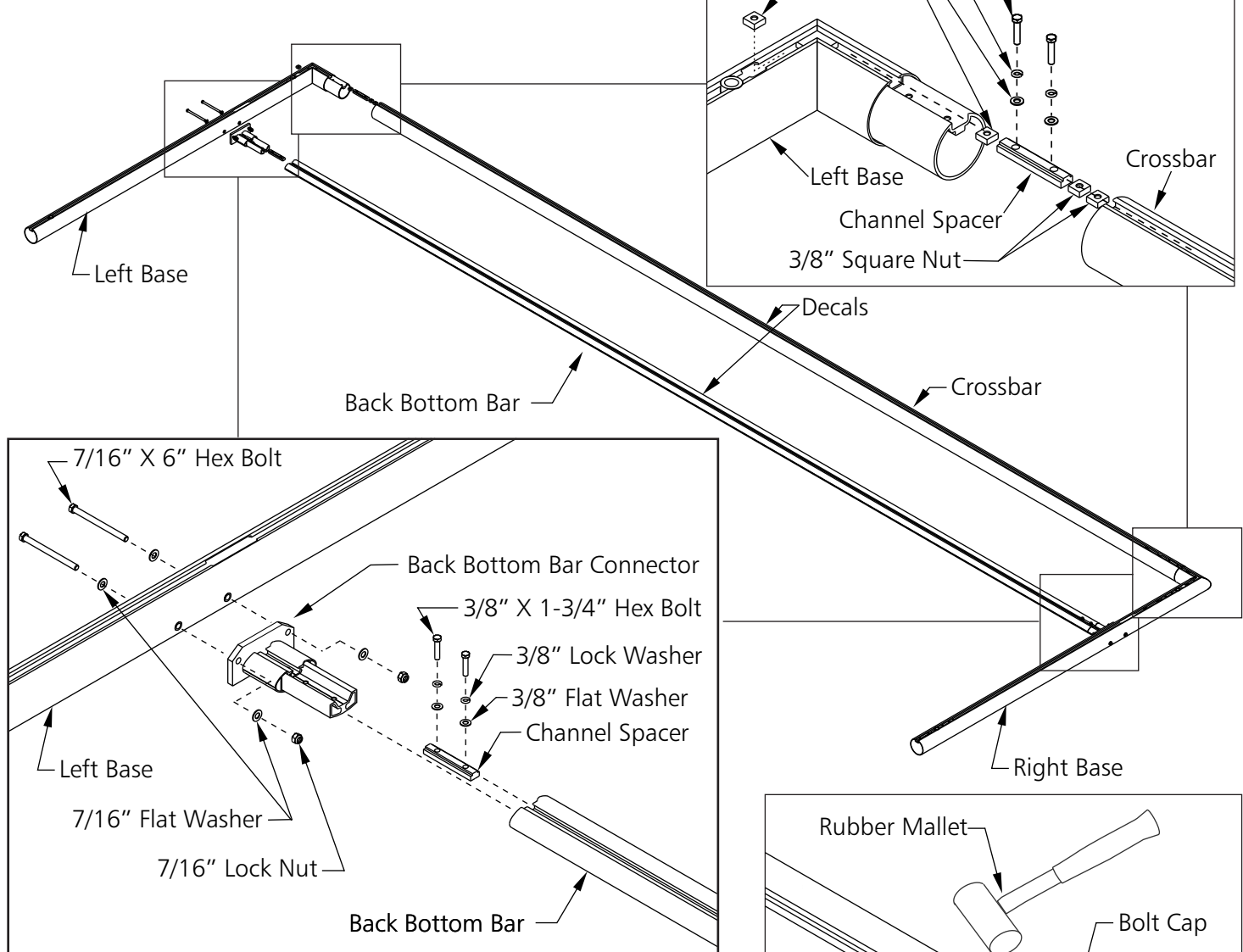

6. Using a rubber mallet, install bolt caps on exposed threads of 7/16\" X 6\" hex bolts.

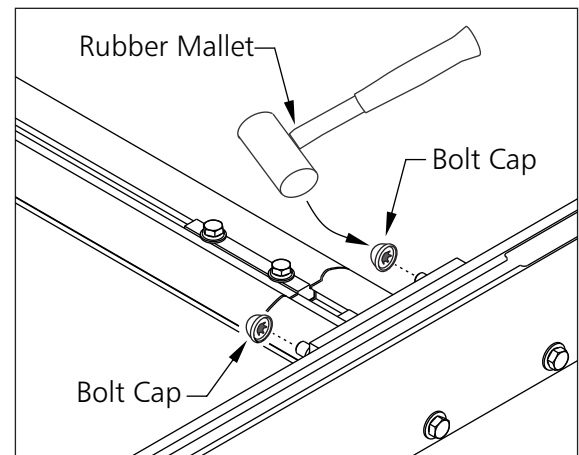

\*\*\*CAUTION\*\*\*

This goal has been designed to be used for the game of soccer only. Goal posts must be anchored AT ALL TIMES and shall be secured against overturning. Do not climb on the net or goal framework at any time! All fastenings must be checked to insure they are fully tightened before and after each use of this product. Goal posts not in use must be disassembled and properly stored in a safe, secure area (See included Guidelines for Moveable Soccer Goal Safety.). Assembled goal posts should not be left unattended. Remove nets when goals are not in use. Do not use this equipment during the threat of high winds. Goal posts should be checked for safety before and after each use. All warning and safety labels included with this product must be visible at all times. Any modifications to this or any Kwik Goal product will void any and all warranties.

7. Lift assembled posts and insert into assembled bases. Be sure connections are pressed firmly together before tightening bolts. Be sure to tighten both bolts on each post brace.

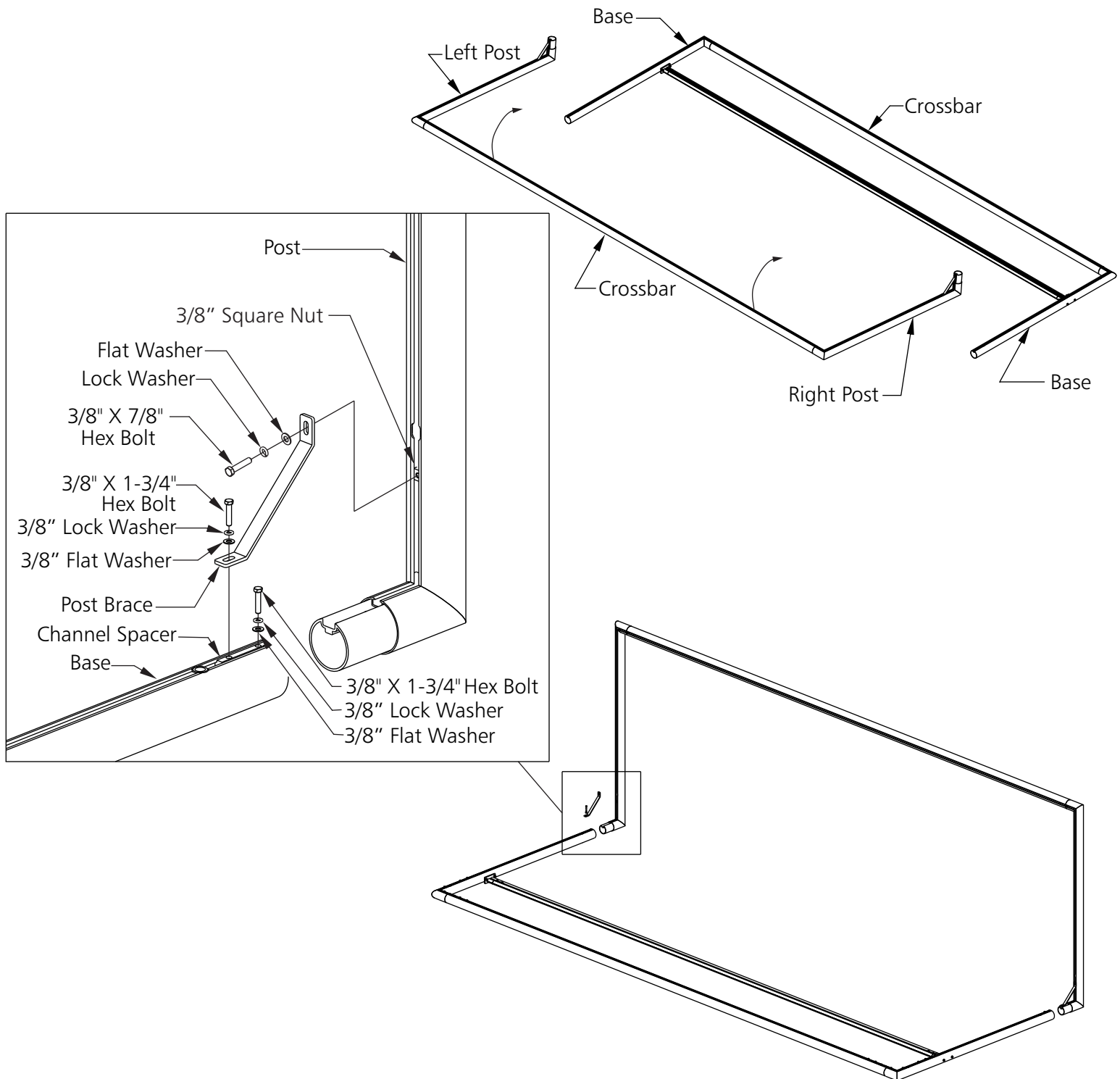

\*\*\*CAUTION\*\*\*

This goal has been designed to be used for the game of soccer only. Goal posts must be anchored AT ALL TIMES and shall be secured against overturning. Do not climb on the net or goal framework at any time! All fastenings must be checked to insure they are fully tightened before and after each use of this product. Goal posts not in use must be disassembled and properly stored in a safe, secure area (See included Guidelines for Moveable Soccer Goal Safety.). Assembled goal posts should not be left unattended. Remove nets when goals are not in use. Do not use this equipment during the threat of high winds. Goal posts should be checked for safety before and after each use.

All warning and safety labels included with this product must be visible at all times.

Any modifications to this or any Kwik Goal product will void any and all warranties.

8. If using swivel wheels (2B9006SW) - skip to step 10, for all other goals continue to step 9.
9. Insert two 3/8" square nuts into left base and right base. **NOTE: If installing optional wheels (Part# 10B409), also include two threaded channel spacers from wheel option package in each base.**

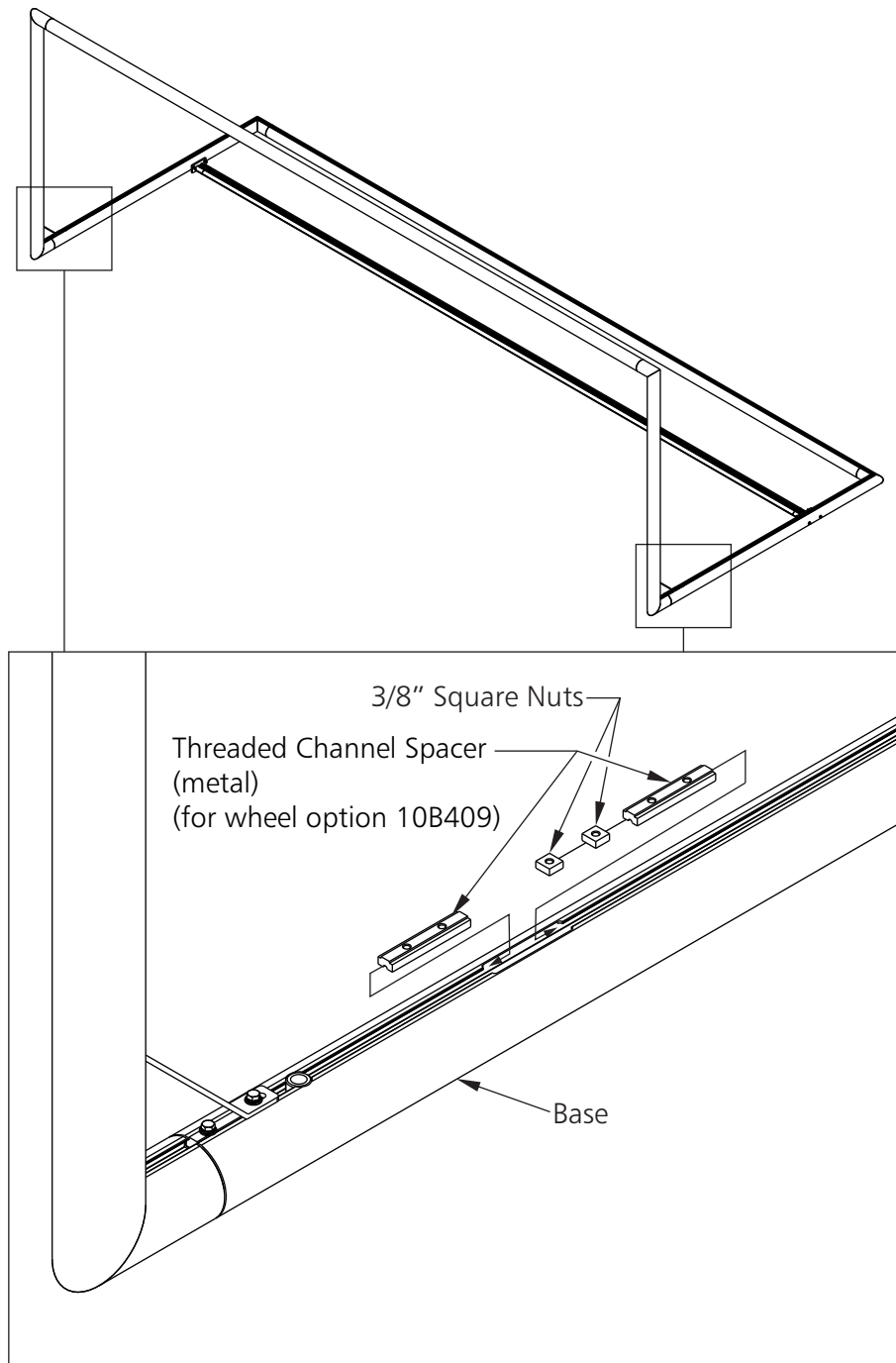

\*\*\*CAUTION\*\*\*

This goal has been designed to be used for the game of soccer only. Goal posts must be anchored AT ALL TIMES and shall be secured against overturning. Do not climb on the net or goal framework at any time! All fastenings must be checked to insure they are fully tightened before and after each use of this product. Goal posts not in use must be disassembled and properly stored in a safe, secure area (See included Guidelines for Moveable Soccer Goal Safety.). Assembled goal posts should not be left unattended. Remove nets when goals are not in use. Do not use this equipment during the threat of high winds. Goal posts should be checked for safety before and after each use.

All warning and safety labels included with this product must be visible at all times.  
Any modifications to this or any Kwik Goal product will void any and all warranties.

10. Assemble back poles as shown. Make sure eyebolt is in slot before tightening. **Do not overtighten.**

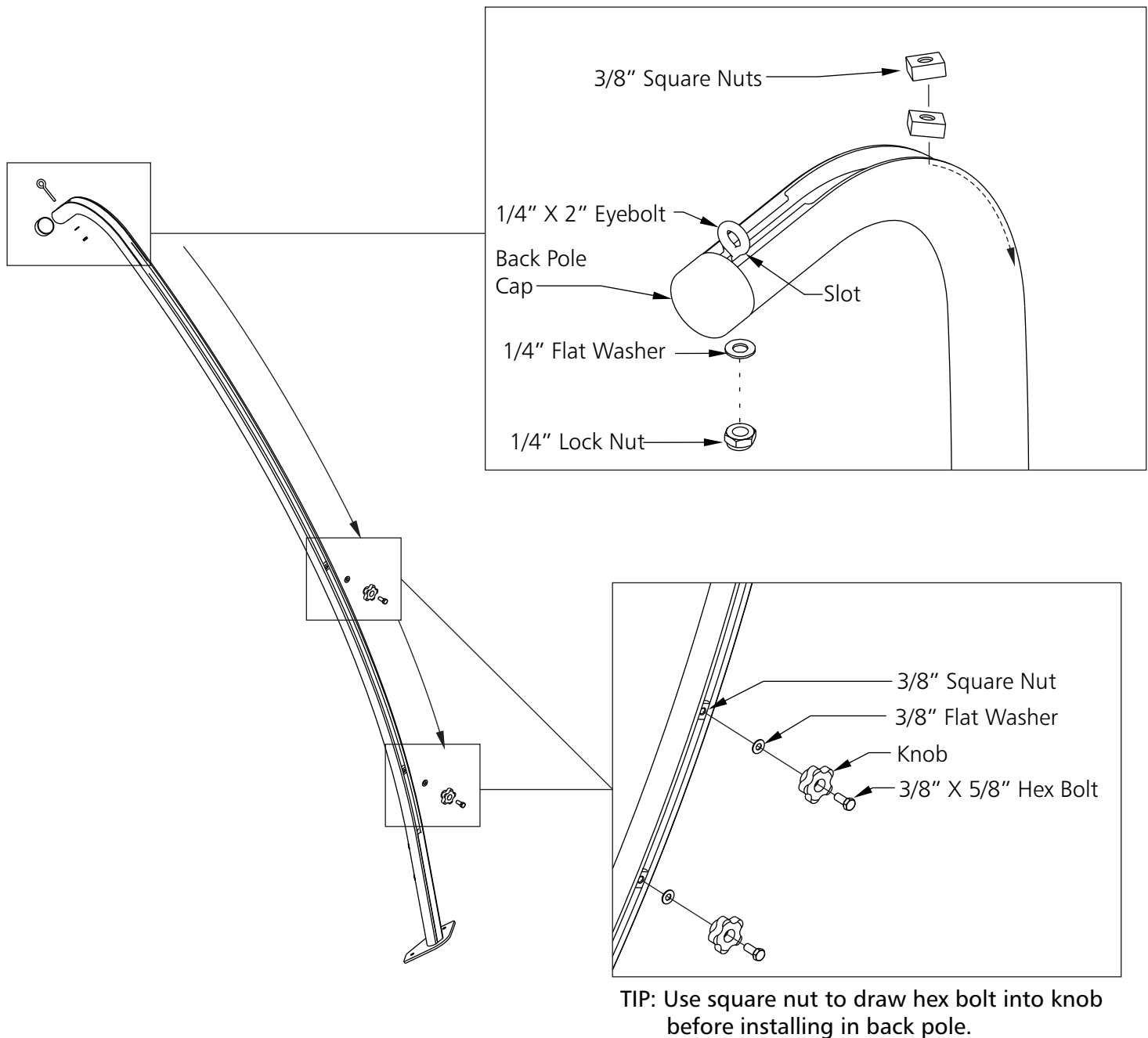

\*\*\*CAUTION\*\*\*

This goal has been designed to be used for the game of soccer only. Goal posts must be anchored AT ALL TIMES and shall be secured against overturning. Do not climb on the net or goal framework at any time! All fastenings must be checked to insure they are fully tightened before and after each use of this product. Goal posts not in use must be disassembled and properly stored in a safe, secure area (See included Guidelines for Moveable Soccer Goal Safety.). Assembled goal posts should not be left unattended. Remove nets when goals are not in use. Do not use this equipment during the threat of high winds. Goal posts should be checked for safety before and after each use.

All warning and safety labels included with this product must be visible at all times.  
Any modifications to this or any Kwik Goal product will void any and all warranties.

11. Put loop end of pole ropes (2) through eyebolt and place rope in channel. With rope assemblies placed in channel, insert tamper resistant net clips at locations shown.

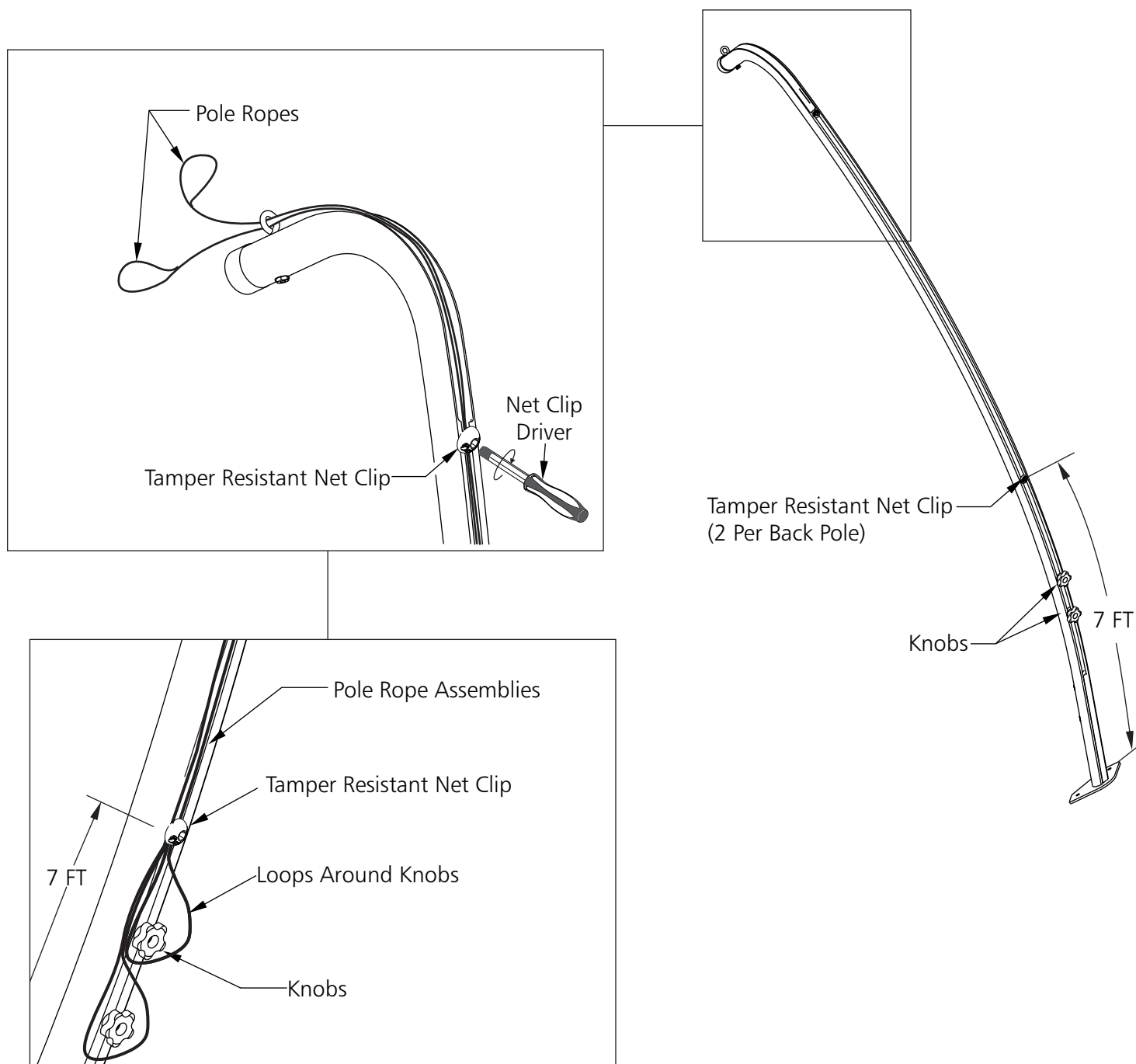

**\*\*\*CAUTION\*\*\***

This goal has been designed to be used for the game of soccer only. Goal posts must be anchored AT ALL TIMES and shall be secured against overturning. Do not climb on the net or goal framework at any time! All fastenings must be checked to insure they are fully tightened before and after each use of this product. Goal posts not in use must be disassembled and properly stored in a safe, secure area (See included Guidelines for Moveable Soccer Goal Safety.). Assembled goal posts should not be left unattended. Remove nets when goals are not in use. Do not use this equipment during the threat of high winds. Goal posts should be checked for safety before and after each use.

All warning and safety labels included with this product must be visible at all times.  
Any modifications to this or any Kwik Goal product will void any and all warranties.

12. Attach back pole and braces to goal base. Use color dots on braces as a guide for brace location. Assemble all hardware first, then go back and tighten each bolt. **Do not overtighten.**

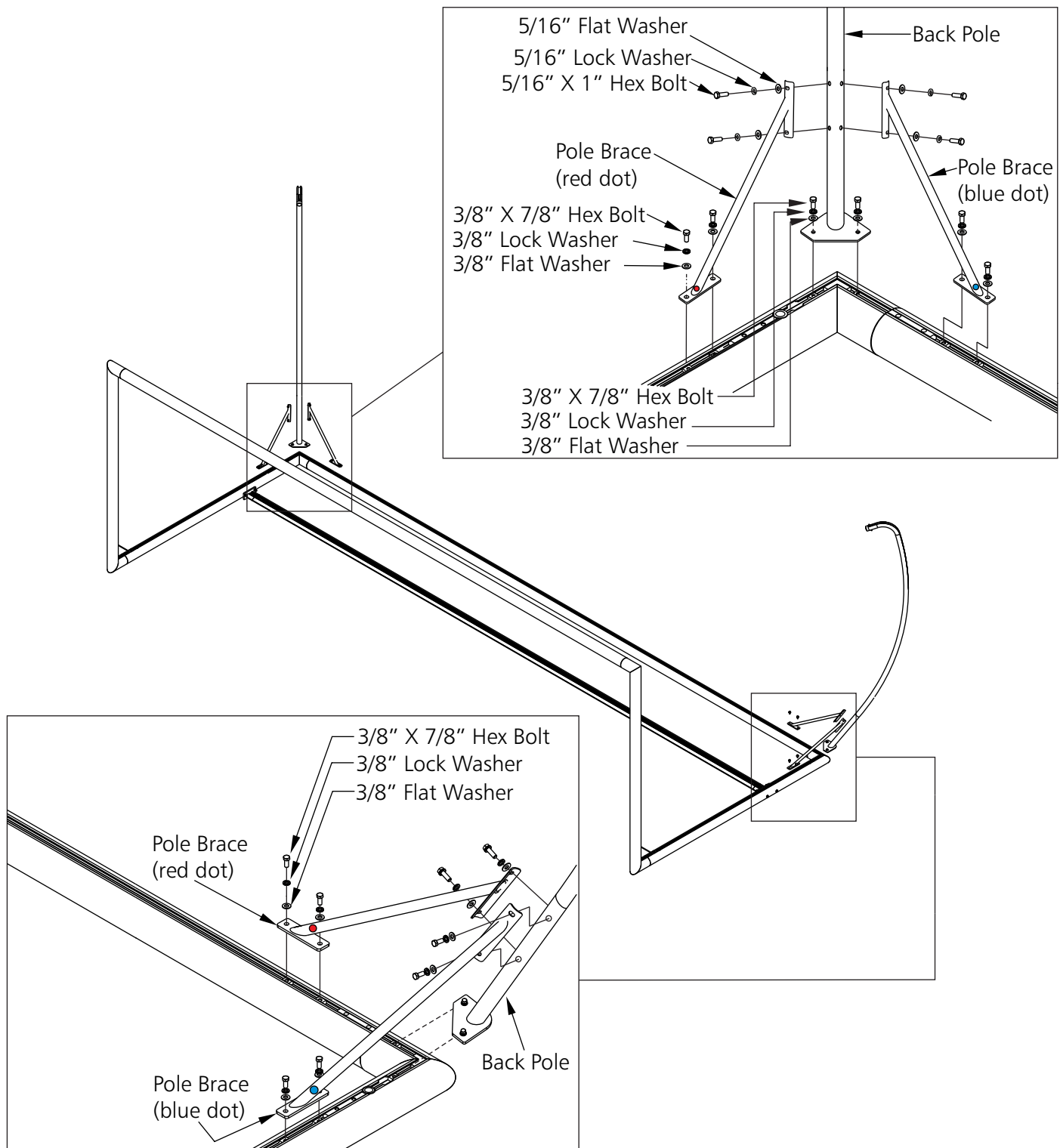

\*\*\*CAUTION\*\*\*

This goal has been designed to be used for the game of soccer only. Goal posts must be anchored AT ALL TIMES and shall be secured against overturning. Do not climb on the net or goal framework at any time! All fastenings must be checked to insure they are fully tightened before and after each use of this product. Goal posts not in use must be disassembled and properly stored in a safe, secure area (See included Guidelines for Moveable Soccer Goal Safety.). Assembled goal posts should not be left unattended. Remove nets when goals are not in use. Do not use this equipment during the threat of high winds. Goal posts should be checked for safety before and after each use.

All warning and safety labels included with this product must be visible at all times.

Any modifications to this or any Kwik Goal product will void any and all warranties.

13. To attach chain leashes insert two square nuts into each base. Attach chain leash at locations shown.

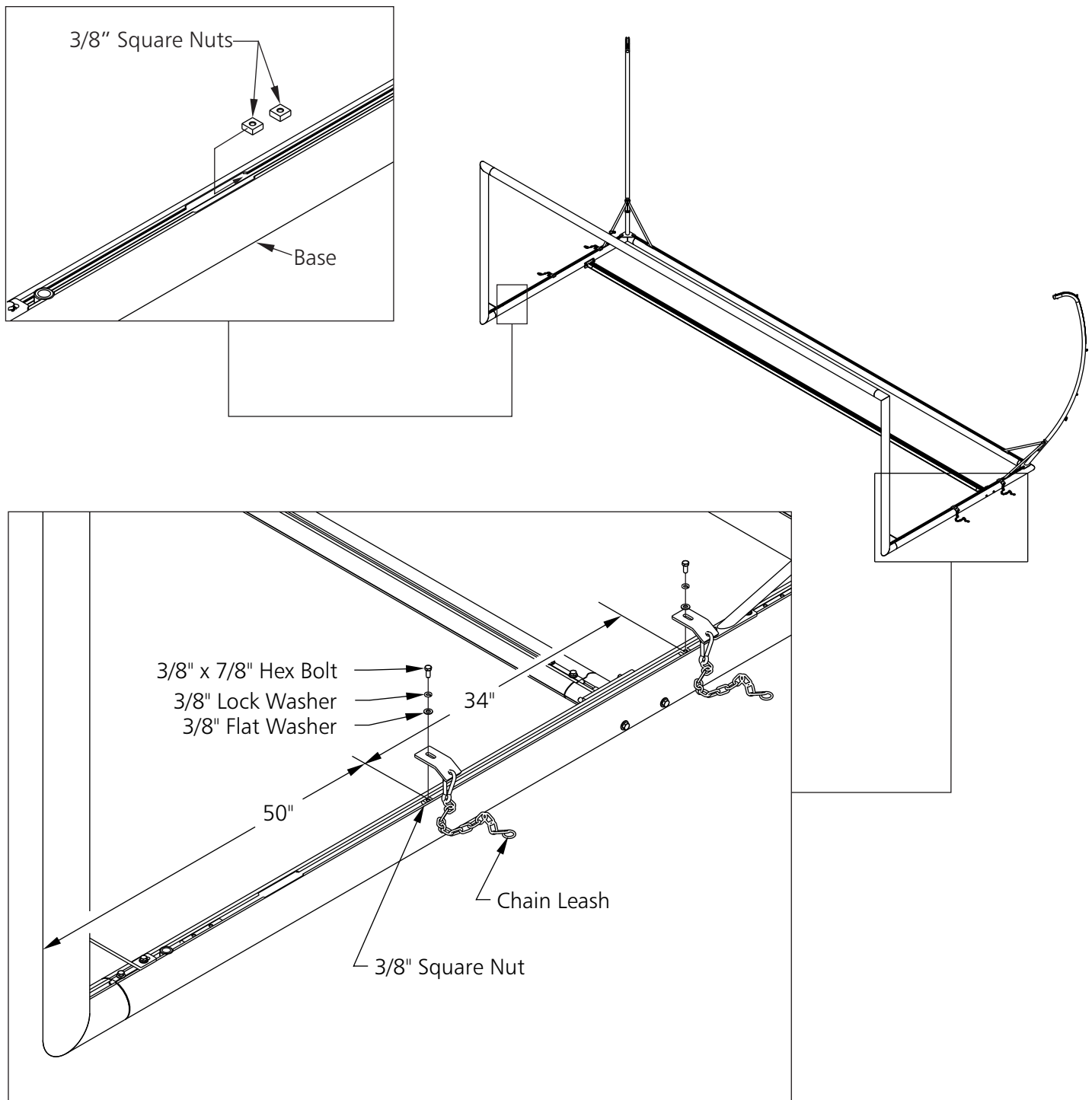

\*\*\*CAUTION\*\*\*

This goal has been designed to be used for the game of soccer only. Goal posts must be anchored AT ALL TIMES and shall be secured against overturning. Do not climb on the net or goal framework at any time! All fastenings must be checked to insure they are fully tightened before and after each use of this product. Goal posts not in use must be disassembled and properly stored in a safe, secure area (See included Guidelines for Moveable Soccer Goal Safety.). Assembled goal posts should not be left unattended. Remove nets when goals are not in use. Do not use this equipment during the threat of high winds. Goal posts should be checked for safety before and after each use.

All warning and safety labels included with this product must be visible at all times.

Any modifications to this or any Kwik Goal product will void any and all warranties.

14. Mark ground anchor hole locations. Prepare holes, install ground anchors and pour concrete.

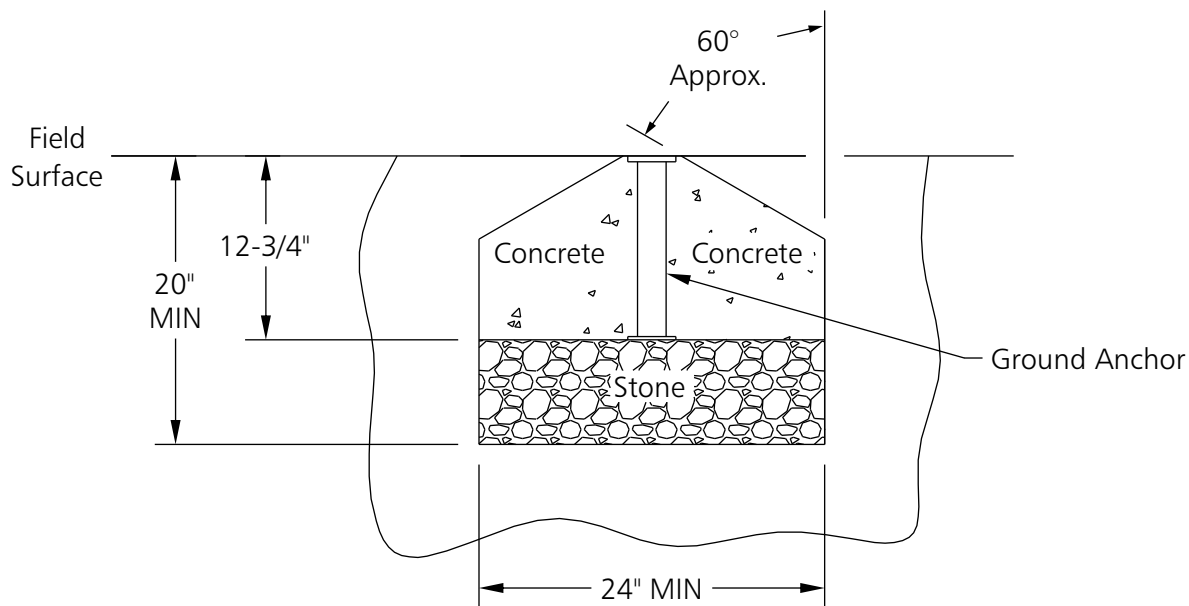
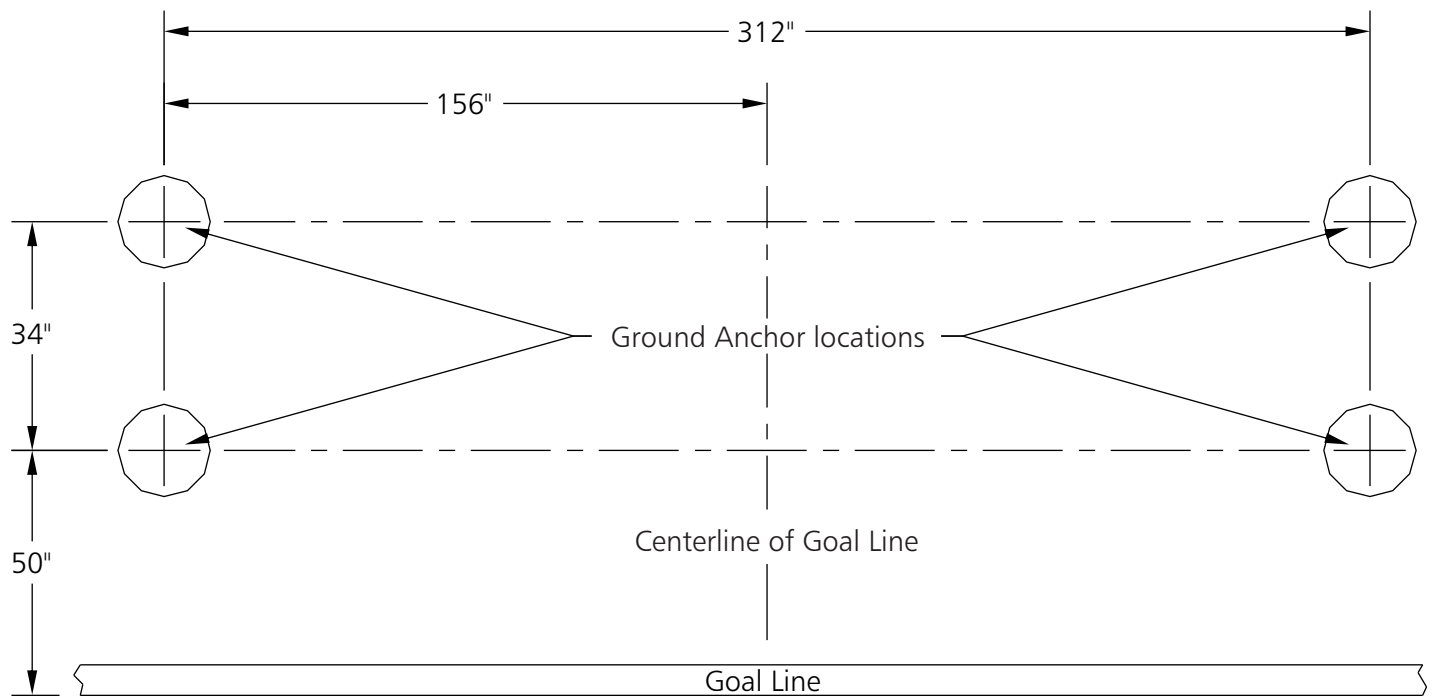

**Anchor Hole Detail**  
(4 places per goal)

\*\*\*CAUTION\*\*\*

This goal has been designed to be used for the game of soccer only. Goal posts must be anchored AT ALL TIMES and shall be secured against overturning. Do not climb on the net or goal framework at any time! All fastenings must be checked to insure they are fully tightened before and after each use of this product. Goal posts not in use must be disassembled and properly stored in a safe, secure area (See included Guidelines for Moveable Soccer Goal Safety.). Assembled goal posts should not be left unattended. Remove nets when goals are not in use. Do not use this equipment during the threat of high winds. Goal posts should be checked for safety before and after each use.

All warning and safety labels included with this product must be visible at all times.  
Any modifications to this or any Kwik Goal product will void any and all warranties.

15. After concrete has fully cured, attach chain leashes to ground anchors. Be sure to apply a liberal amount of anti-seize on bolt threads before installing into anchors. With goal leashed to all four anchors, test in accordance with step 16.

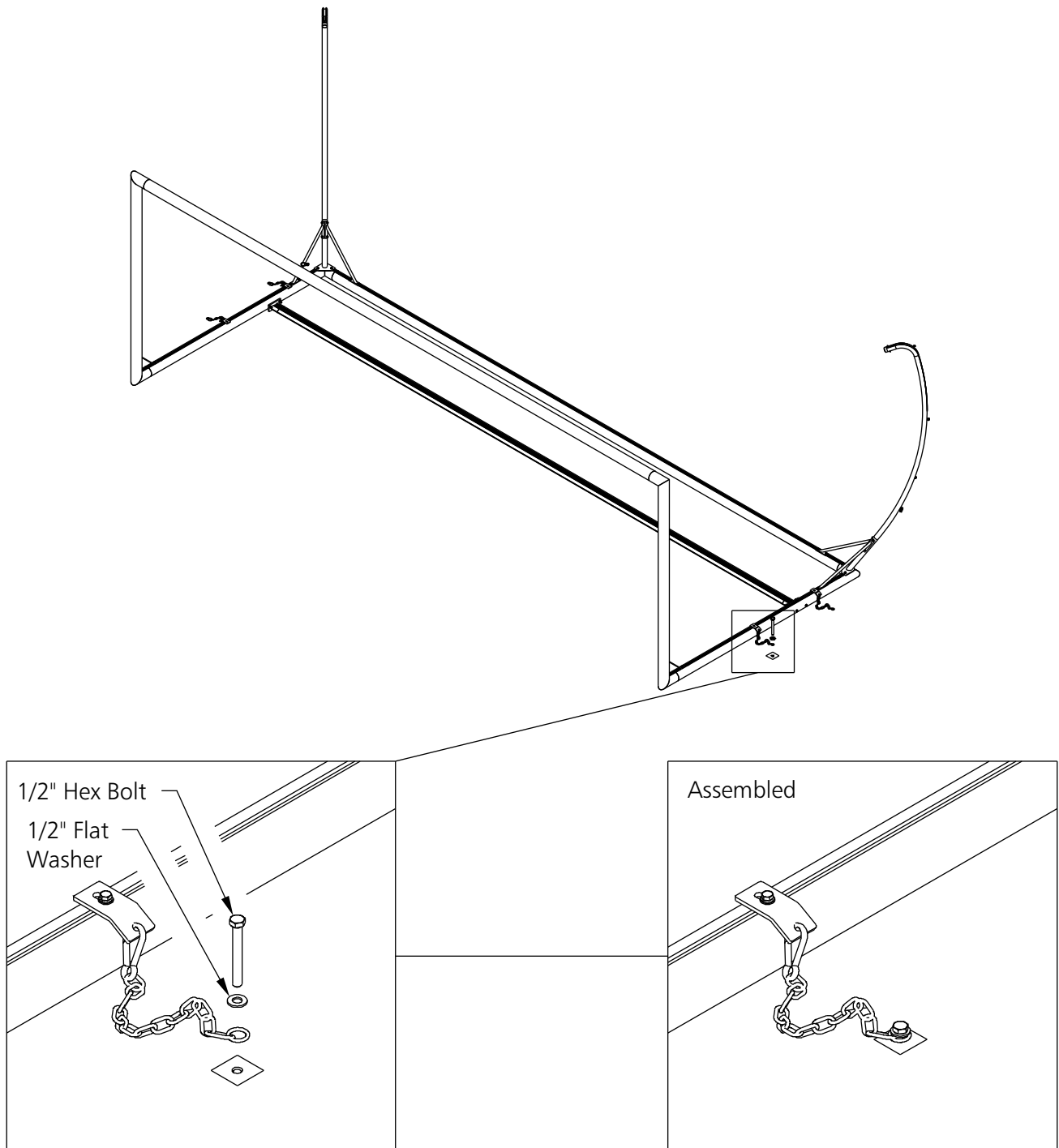

\*\*\*CAUTION\*\*\*

This goal has been designed to be used for the game of soccer only. Goal posts must be anchored AT ALL TIMES and shall be secured against overturning. Do not climb on the net or goal framework at any time! All fastenings must be checked to insure they are fully tightened before and after each use of this product. Goal posts not in use must be disassembled and properly stored in a safe, secure area (See included Guidelines for Moveable Soccer Goal Safety.). Assembled goal posts should not be left unattended. Remove nets when goals are not in use. Do not use this equipment during the threat of high winds. Goal posts should be checked for safety before and after each use.

All warning and safety labels included with this product must be visible at all times.

Any modifications to this or any Kwik Goal product will void any and all warranties.

16. The ground anchor and chain leash system supplied is the recommended and the safest method of anchoring your goal. However, counterbalance weight may be used as a temporary anchoring system. A minimum of 240 lbs. must be placed on the back bottom bar for the goal to be stabilized. Test anchoring in accordance with step 17.

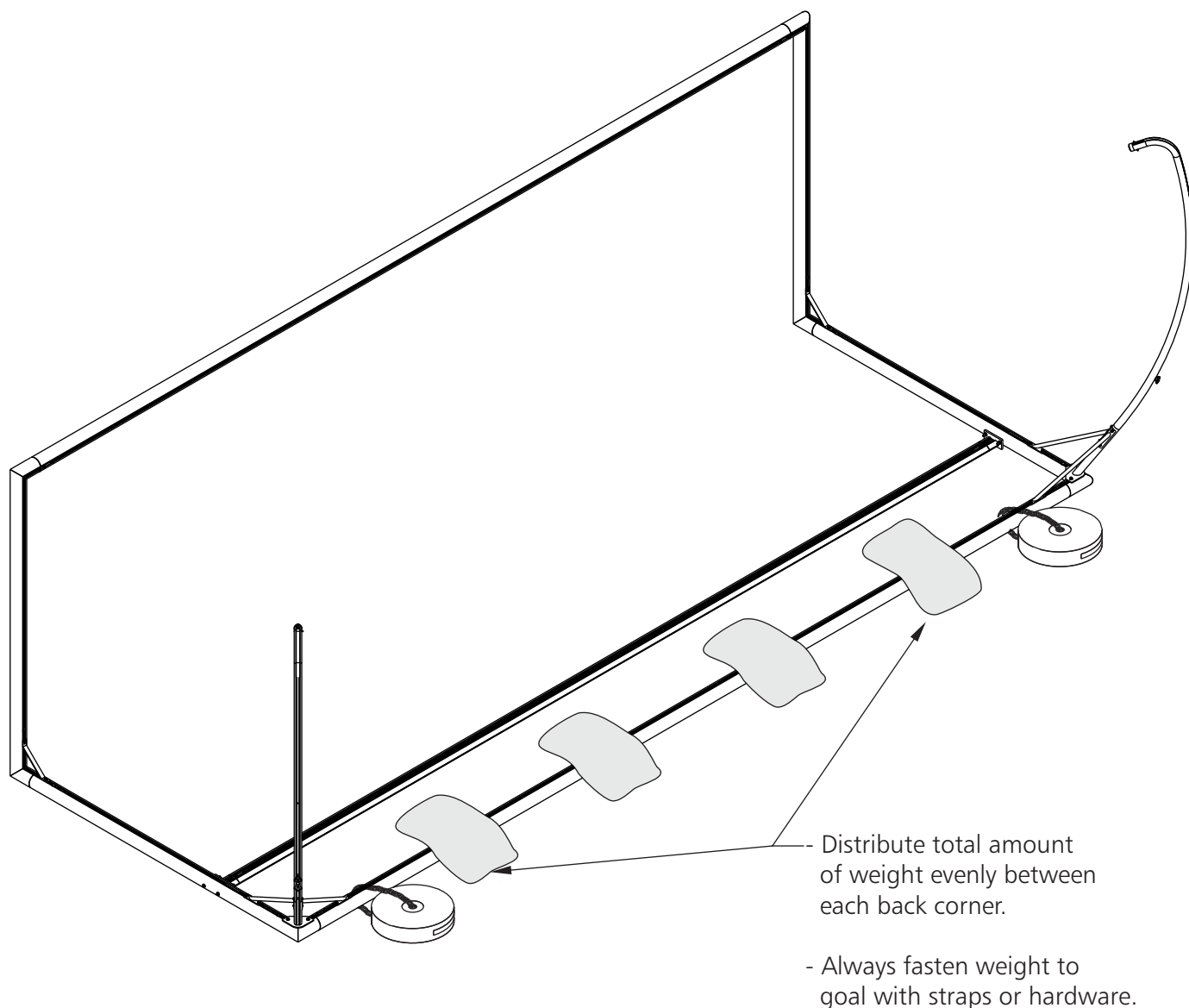

**\*\*\*CAUTION\*\*\***

This goal has been designed to be used for the game of soccer only. Goal posts must be anchored AT ALL TIMES and shall be secured against overturning. Do not climb on the net or goal framework at any time! All fastenings must be checked to insure they are fully tightened before and after each use of this product. Goal posts not in use must be disassembled and properly stored in a safe, secure area (See included Guidelines for Moveable Soccer Goal Safety.). Assembled goal posts should not be left unattended. Remove nets when goals are not in use. Do not use this equipment during the threat of high winds. Goal posts should be checked for safety before and after each use.

All warning and safety labels included with this product must be visible at all times.  
Any modifications to this or any Kwik Goal product will void any and all warranties.

17. After installing, test as described below to verify effectiveness of anchor system. If applicable, allow concrete to fully cure before testing.

### ANCHOR TEST

1. Clear all persons from a minimum 50 foot radius surrounding the goal.
2. Verify goal is attached to anchors according to instruction.
3. Apply a horizontal pull force of 247 lbs. to the center of the crossbar for 60 - 70 seconds.  
Full safety precautions must be taken while performing test.
4. If goal overturns during application of force or does not return to an upright position after removing force, an alternate anchoring system must be used

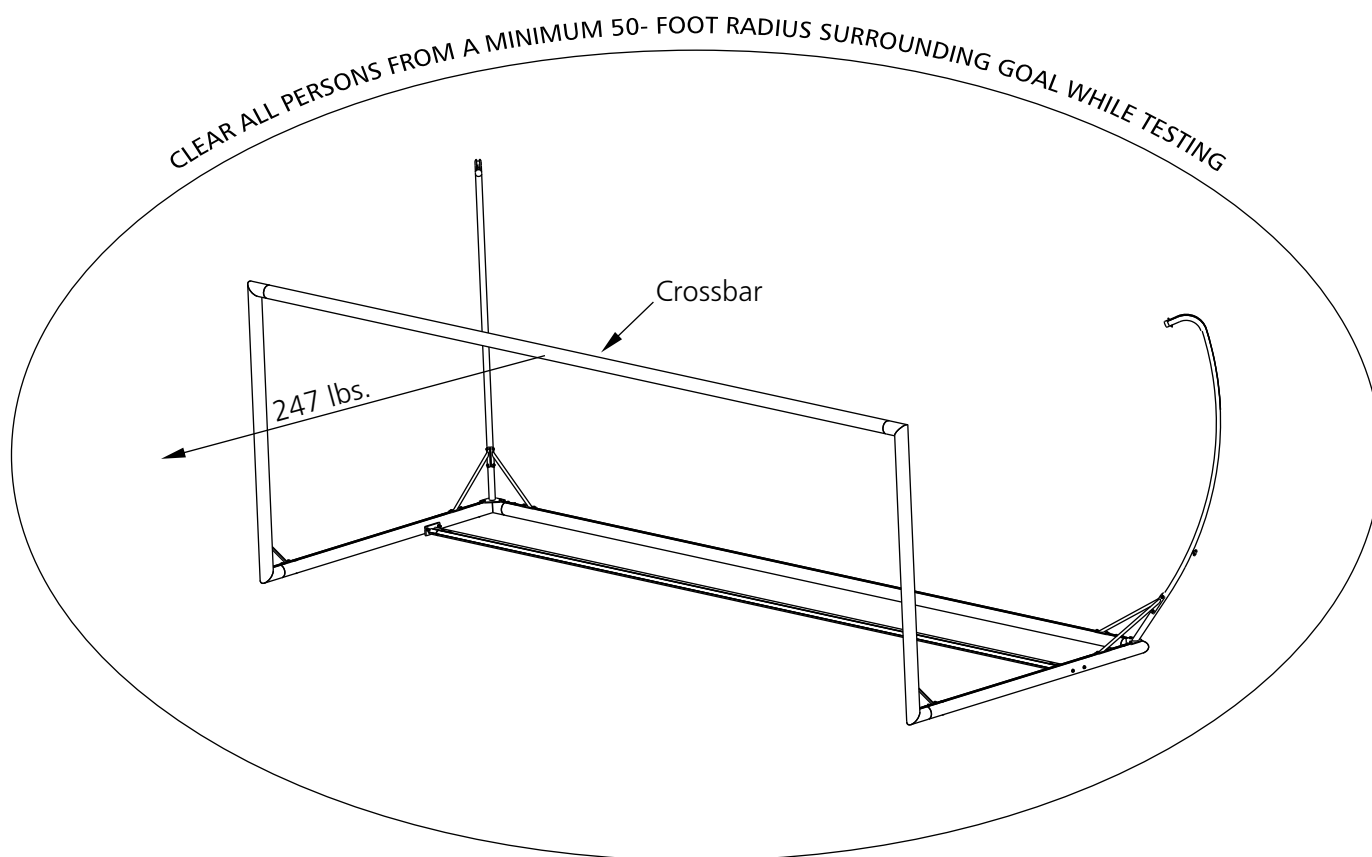

### \*\*\*CAUTION\*\*\*

This goal has been designed to be used for the game of soccer only. Goal posts must be anchored AT ALL TIMES and shall be secured against overturning. Do not climb on the net or goal framework at any time! All fastenings must be checked to insure they are fully tightened before and after each use of this product. Goal posts not in use must be disassembled and properly stored in a safe, secure area (See included Guidelines for Moveable Soccer Goal Safety.). Assembled goal posts should not be left unattended. Remove nets when goals are not in use. Do not use this equipment during the threat of high winds. Goal posts should be checked for safety before and after each use.

All warning and safety labels included with this product must be visible at all times.  
Any modifications to this or any Kwik Goal product will void any and all warranties.

18. Attach net to goal frame with tamper resistant net clips using net clip driver as shown. Untie, remove, and discard backdrop rope.

**CAUTION: DO NOT ATTEMPT TO CLIMB ON GOAL WHILE ATTACHING NET.**  
**CAUTION: GOALS MUST BE PROPERLY ANCHORED OR STORED AT ALL TIMES.**

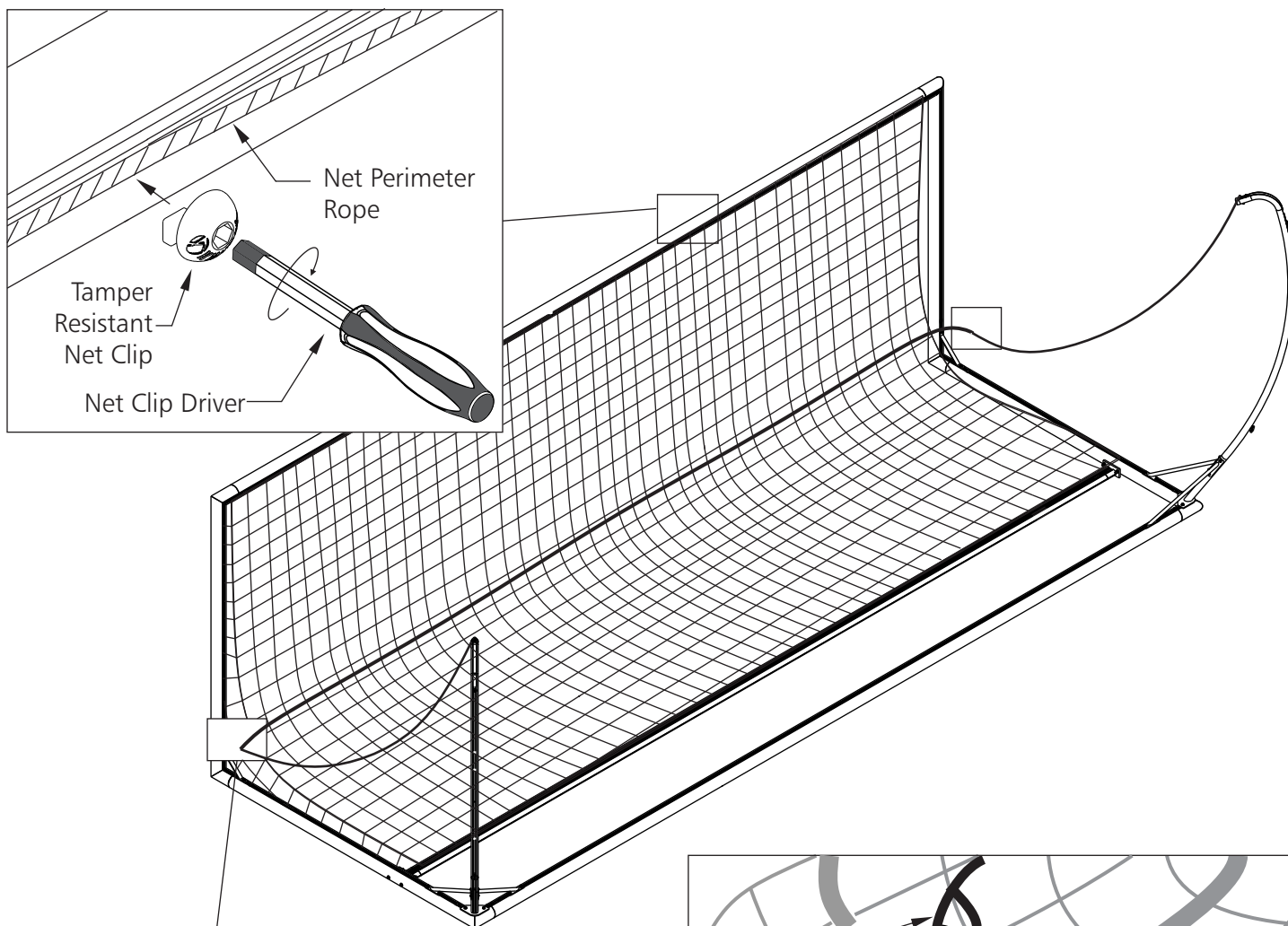

19. From underside of net, push end of 1st net rope assembly through top rear corner of net. Clip net corner, pole rope assembly, and net rope assembly together with a snap link. Repeat for opposite corner of net, with opposite end of net rope assembly.

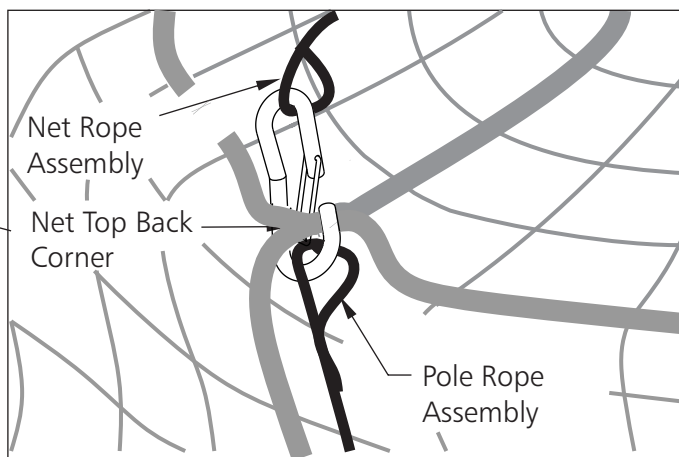

\*\*\*CAUTION\*\*\*

This goal has been designed to be used for the game of soccer only. Goal posts must be anchored AT ALL TIMES and shall be secured against overturning. Do not climb on the net or goal framework at any time! All fastenings must be checked to insure they are fully tightened before and after each use of this product. Goal posts not in use must be disassembled and properly stored in a safe, secure area (See included Guidelines for Moveable Soccer Goal Safety.). Assembled goal posts should not be left unattended. Remove nets when goals are not in use. Do not use this equipment during the threat of high winds. Goal posts should be checked for safety before and after each use.

All warning and safety labels included with this product must be visible at all times.

Any modifications to this or any Kwik Goal product will void any and all warranties.

20. From underside of net, push end of 2nd net rope assembly through the 18th mesh of the net. Clip net rope assembly to 2nd pole rope assembly. Wrap 2nd net rope assembly around 1st net rope assembly approximately 12 times at center of net. Do NOT weave rope through meshes of nets. Nets must be free to slide on ropes. Push end of 2nd net rope assembly through 18th mesh from opposite corner. Clip 2nd net rope assembly to remaining 2nd pole rope assembly.

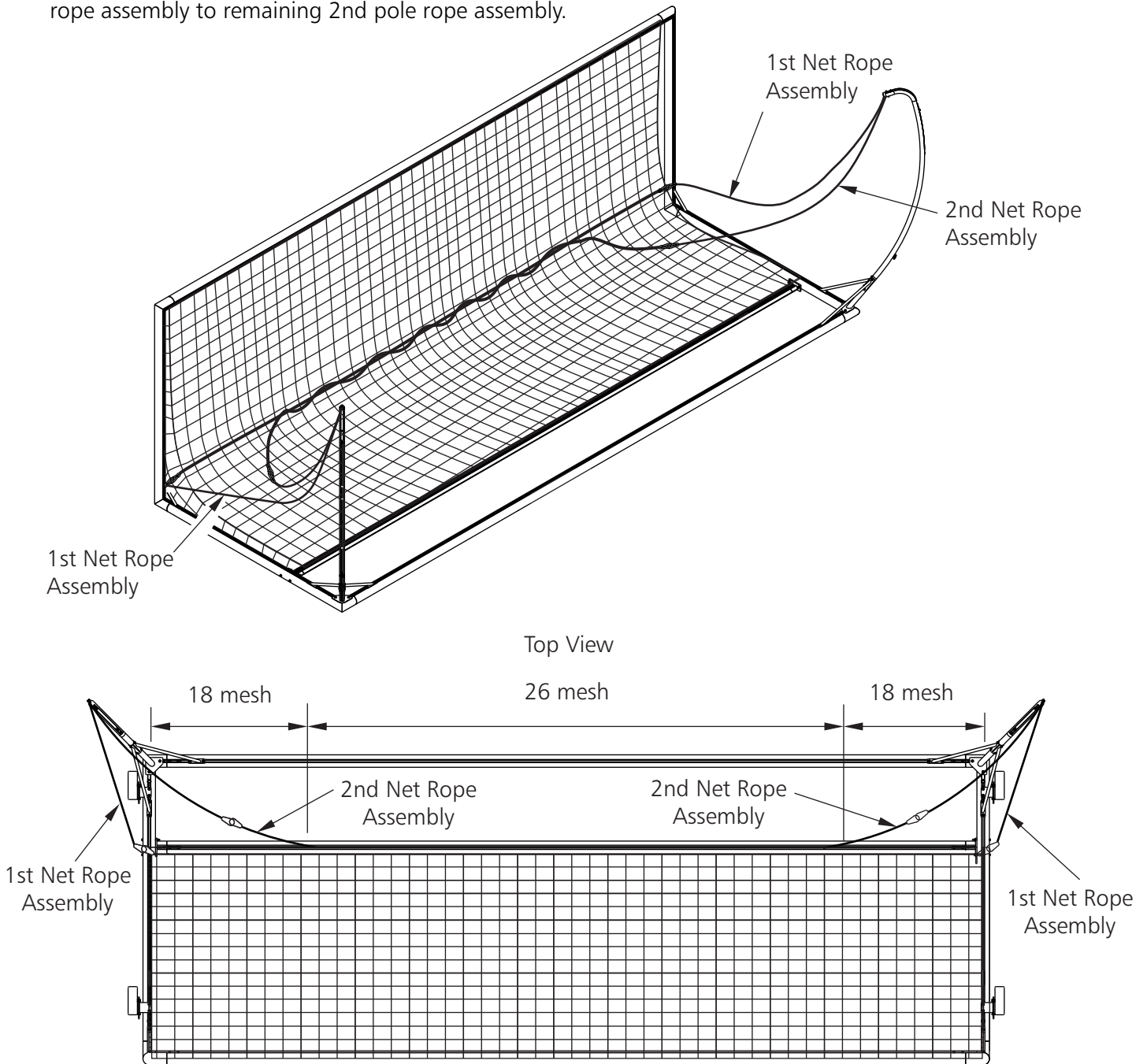

\*\*\*CAUTION\*\*\*

This goal has been designed to be used for the game of soccer only. Goal posts must be anchored AT ALL TIMES and shall be secured against overturning. Do not climb on the net or goal framework at any time! All fastenings must be checked to insure they are fully tightened before and after each use of this product. Goal posts not in use must be disassembled and properly stored in a safe, secure area (See included Guidelines for Moveable Soccer Goal Safety.). Assembled goal posts should not be left unattended. Remove nets when goals are not in use. Do not use this equipment during the threat of high winds. Goal posts should be checked for safety before and after each use.

All warning and safety labels included with this product must be visible at all times.

Any modifications to this or any Kwik Goal product will void any and all warranties.

21. Tension 1st net rope assembly to remove any slack in the net side walls, both vertically and horizontally. Loop ends of 1st net rope assembly around top knobs and tighten knobs to hold tension in rope. Minimum tension required for a good appearance is recommended. Knobs should be locked in place at approximately the same height on left and right poles.

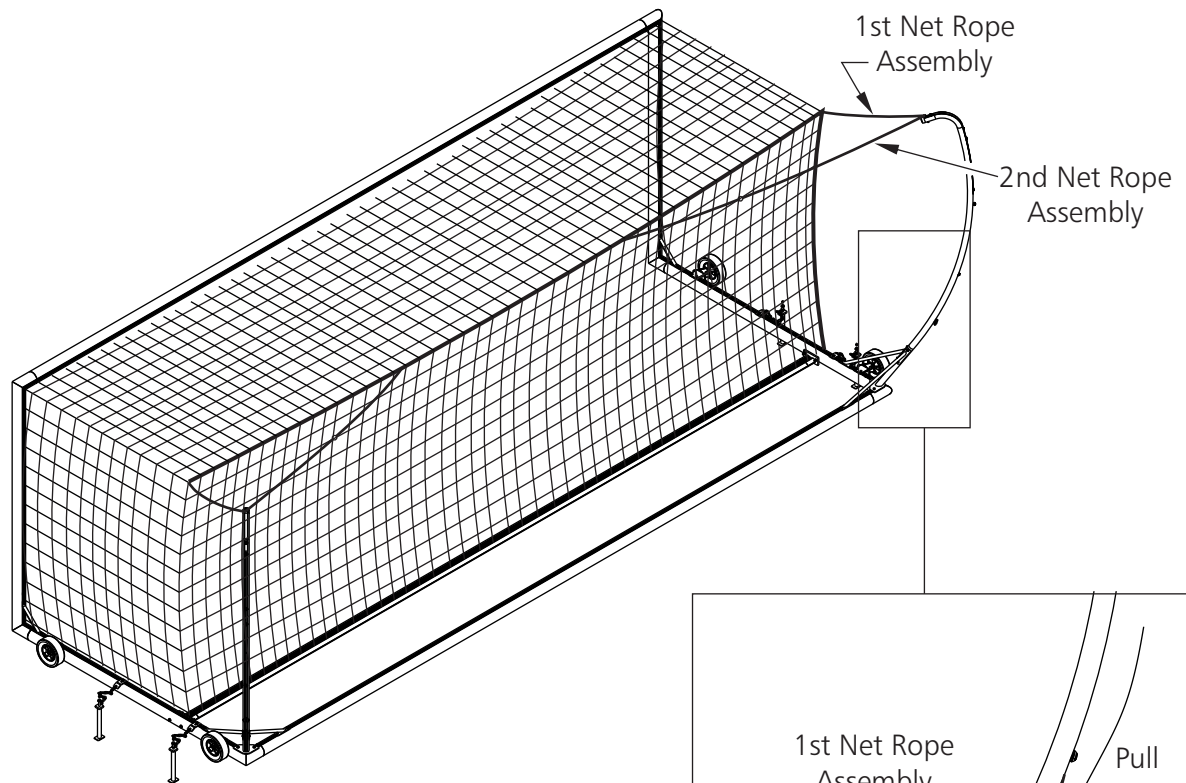

22. Remove sag in the net by tensioning 2nd net rope assembly. Loop the ends of 2nd net rope assembly around bottom knob in left and right poles. Minimum tension required for a good appearance is recommended. Knobs should be locked in place at approximately the same height on left and right poles.

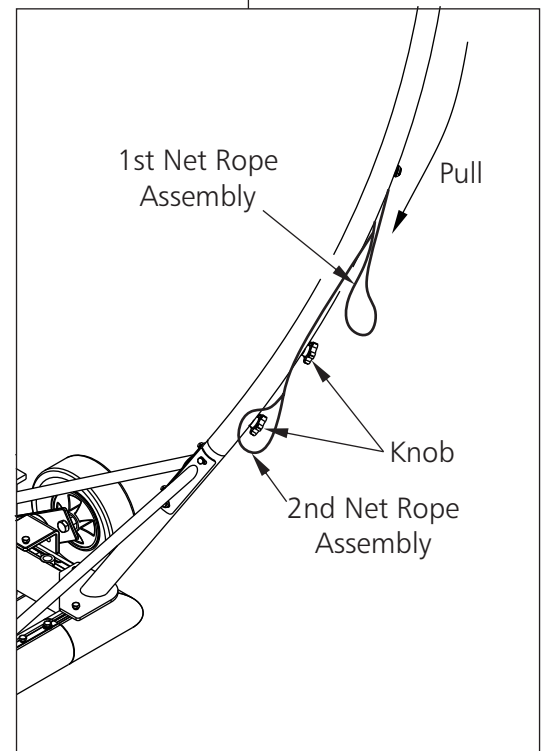

Go to [kwikgoal.com](http://kwikgoal.com) for additional product information.

\*\*\*CAUTION\*\*\*

This goal has been designed to be used for the game of soccer only. Goal posts must be anchored AT ALL TIMES and shall be secured against overturning. Do not climb on the net or goal framework at any time! All fastenings must be checked to insure they are fully tightened before and after each use of this product. Goal posts not in use must be disassembled and properly stored in a safe, secure area (See included Guidelines for Moveable Soccer Goal Safety.). Assembled goal posts should not be left unattended. Remove nets when goals are not in use. Do not use this equipment during the threat of high winds. Goal posts should be checked for safety before and after each use.

All warning and safety labels included with this product must be visible at all times.

Any modifications to this or any Kwik Goal product will void any and all warranties.



## ASSEMBLY INSTRUCTIONS FOR SWIVEL WHEELS

1. Unpack all parts and check for damage that may have occurred during shipping. If damage has occurred, notify Kwik Goal immediately. Lay out all parts. Remove all cardboard and packaging immediately. Wet or damp packaging may damage contents.
2. Read through entire instruction before beginning assembly and installation.

### Parts

Swivel Wheel Mounting Bracket (4)  
(Part# UZ1356)

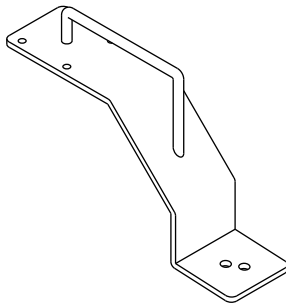

Mounting Bracket Pin (4)

Part#	Dim (A)	Goal Model Number			
TZ347	3-5/16"	2B3306SW	2B3406SW	2B3706SW	-
TZ348	5-5/8"	2B2001SW	2B3806SW	2B9006SW	2B9004SW
TZ378	4-3/16"	2B3006SW	-	-	-

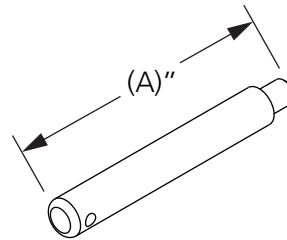

Swivel Wheel (4)  
(Part# VZ629)

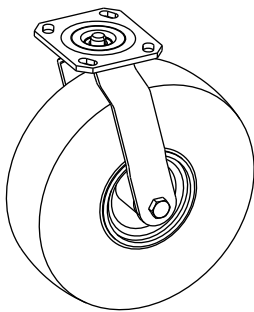

Rubber Pad (8)  
(Part# VZ654)



Cable Lanyard (4)  
(Part# VZ653)

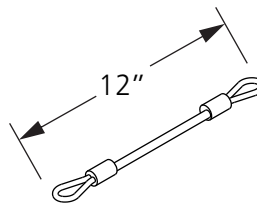

Hairpin Cotter (4)  
(Part# TZ351)

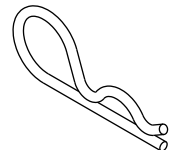

### **\*\*\*CAUTION\*\*\***

This goal has been designed to be used for the game of soccer only. Goal posts must be anchored AT ALL TIMES and shall be secured against overturning. Do not climb on the net or goal framework at any time! All fastenings must be checked to insure they are fully tightened before and after each use of this product. Goal posts not in use must be disassembled and properly stored in a safe, secure area (See included Guidelines for Moveable Soccer Goal Safety.). Assembled goal posts should not be left unattended. Remove nets when goals are not in use. Do not use this equipment during the threat of high winds. Goal posts should be checked for safety before and after each use.

All warning and safety labels included with this product must be visible at all times.

Any modifications to this or any Kwik Goal product will void any and all warranties.



**IMPORTANT GOAL SAFETY INSTRUCTIONS**  
**READ CAREFULLY**

1. Check for structural integrity and proper connecting hardware before every use. Replace damaged or missing parts or fasteners immediately.
2. Safety/Warning labels must be clearly visible.
3. Securely anchor moveable soccer goals at ALL times.
4. Always instruct players, managers, coaches, trainers, teachers, maintenance workers and all other personnel who might come in contact with the goal, on the safe handling of and potential dangers associated with moveable soccer goals.
5. Always exercise extreme caution when moving goals and provide adequate manpower to move goals of varied sizes and weights. Moveable soccer goals should only be moved by authorized personnel.
6. NEVER allow anyone to climb on the net or goal framework.
7. Moveable soccer goals should only be used on LEVEL fields, NEVER on a slope or hill area.
8. Remove nets when goals are not in use.
9. Most of the tip-over injuries occurred when goals were unattended. Anchor or chain one goal to another or to nearby fence posts, dugouts, or any other similar sturdy fixture when not in use. If this is not practical, store moveable soccer goals in a place where children cannot have access to them.
10. Fully disassemble goals for seasonal storage.

## Hardware

Note: Hardware may be packaged separately in one or more boxes. Open all packages before beginning assembly.

5/16" x 1" Hex Bolt (Part# TZ330)	(16)
5/16" Flat Washer (Part# TZ4)	(16)
5/16" Lock Nut (Part# TZ5)	(16)
1/2" Lock Nut (Part# TZ349)	(4)

3. Apply rubber pads to swivel wheel mounting brackets at the center of location shown.

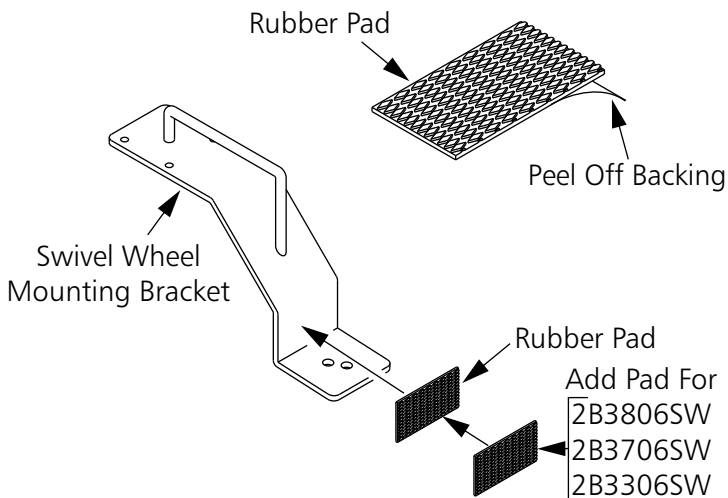

5. Attach mounting bracket pin to swivel wheel bracket. To tighten lock nut, insert a phillips screwdriver in hole on mounting bracket pin. Orient hole to bracket as shown.

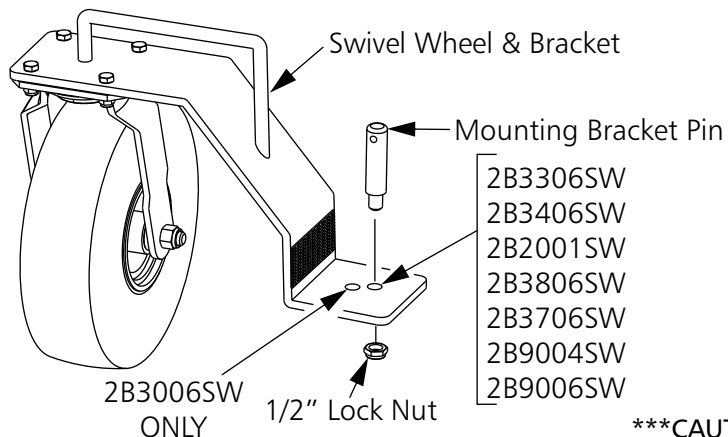

## Assembly Tools

1/2" & 3/4"  
Wrenches

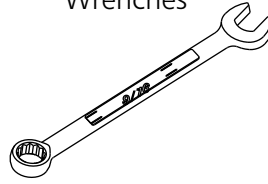

Ratchet with  
1/2" & 3/4"  
Sockets

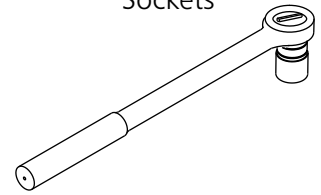

AND

Phillips Screwdriver

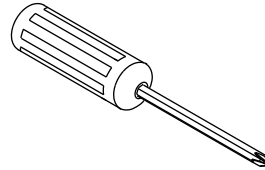

4. Attach swivel wheel brackets to swivel wheels.

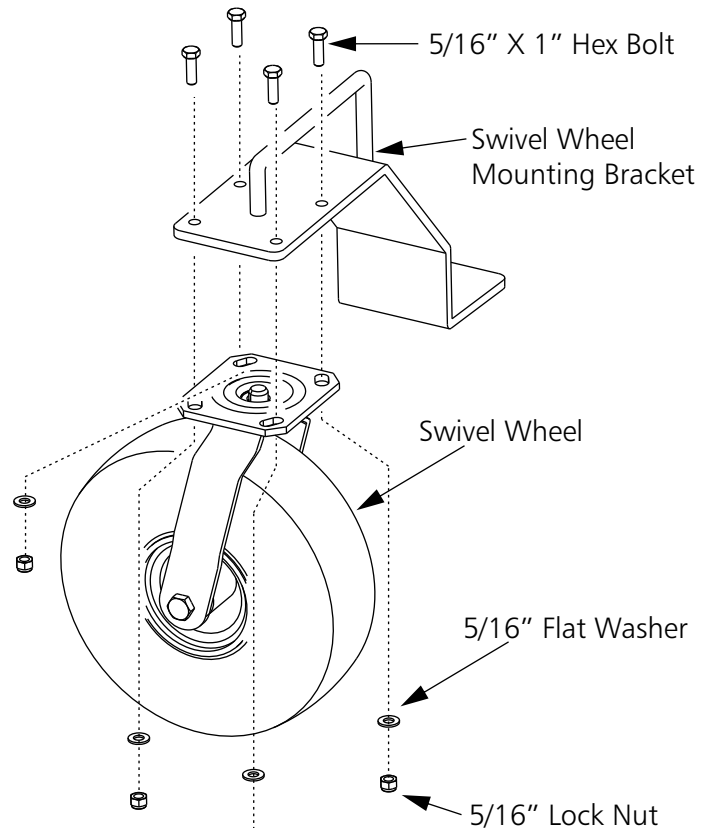

\*\*\*CAUTION\*\*\*

This goal has been designed to be used for the game of soccer only. Goal posts must be anchored AT ALL TIMES and shall be secured against overturning. Do not climb on the net or goal framework at any time! All fastenings must be checked to insure they are fully tightened before and after each use of this product. Goal posts not in use must be disassembled and properly stored in a safe, secure area (See included Guidelines for Moveable Soccer Goal Safety.). Assembled goal posts should not be left unattended. Remove nets when goals are not in use. Do not use this equipment during the threat of high winds. Goal posts should be checked for safety before and after each use.

All warning and safety labels included with this product must be visible at all times.

Any modifications to this or any Kwik Goal product will void any and all warranties.

6. Attach swivel wheel assembly on the outside of goal frame by lifting goal frame at wheel locations and insert mounting bracket pin into base bushing. Never install pin into anchor hole.

**Note:** Attach one wheel at a time and secure in place (See step 7 & 8) before attaching remaining wheels.

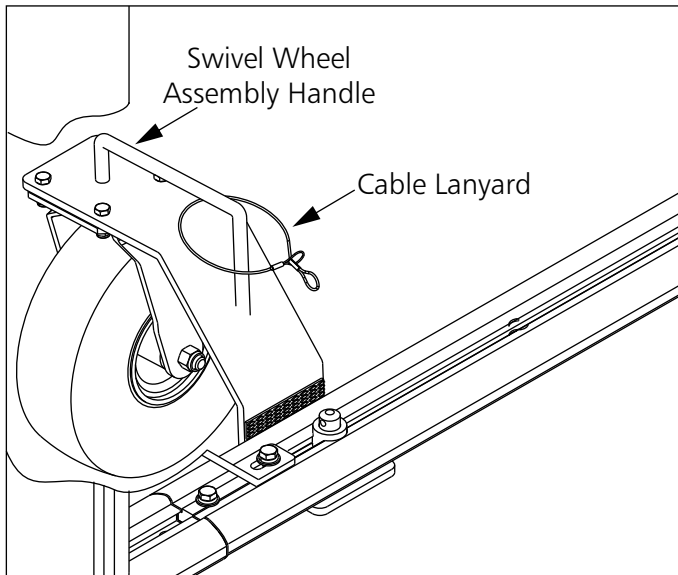
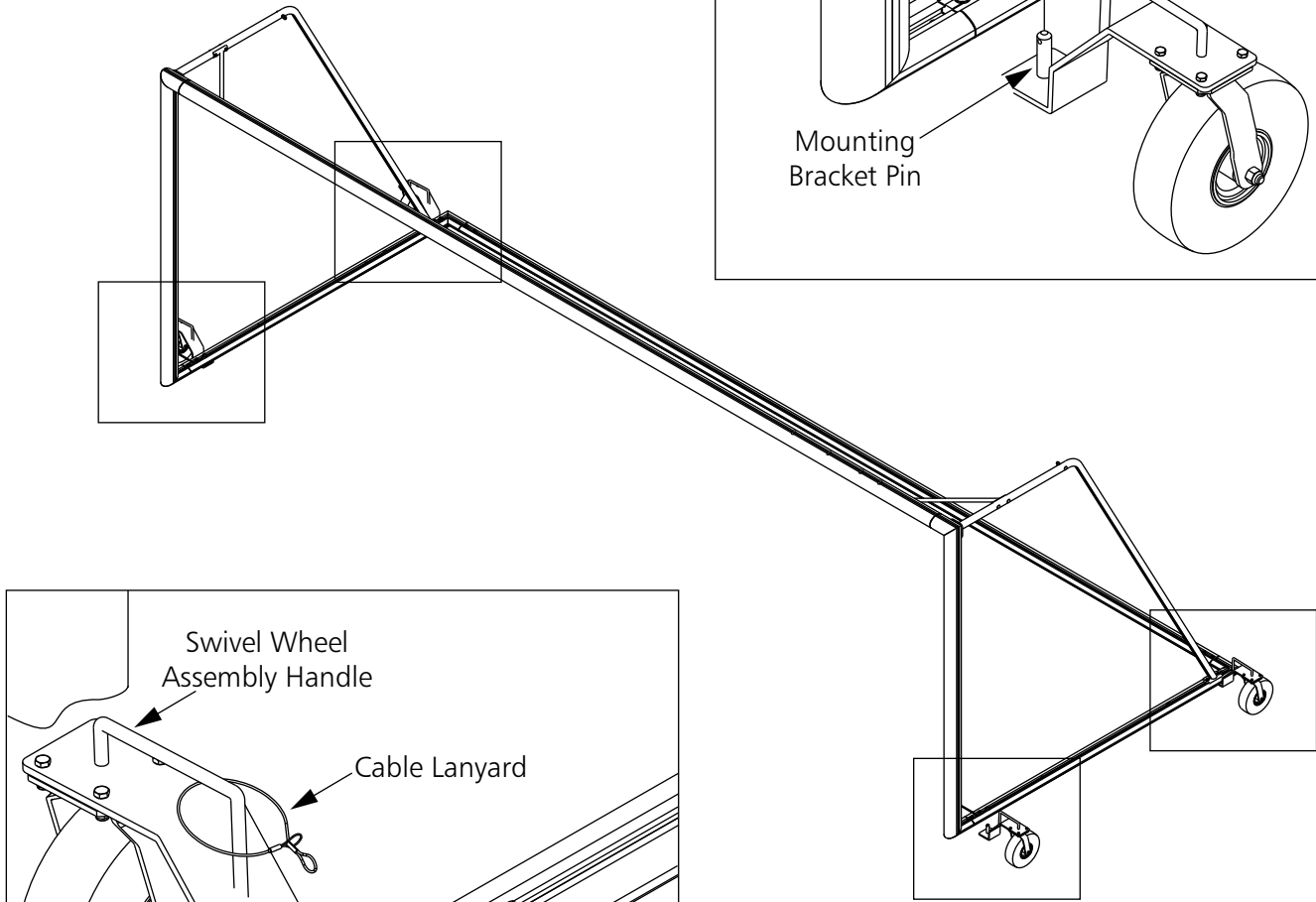
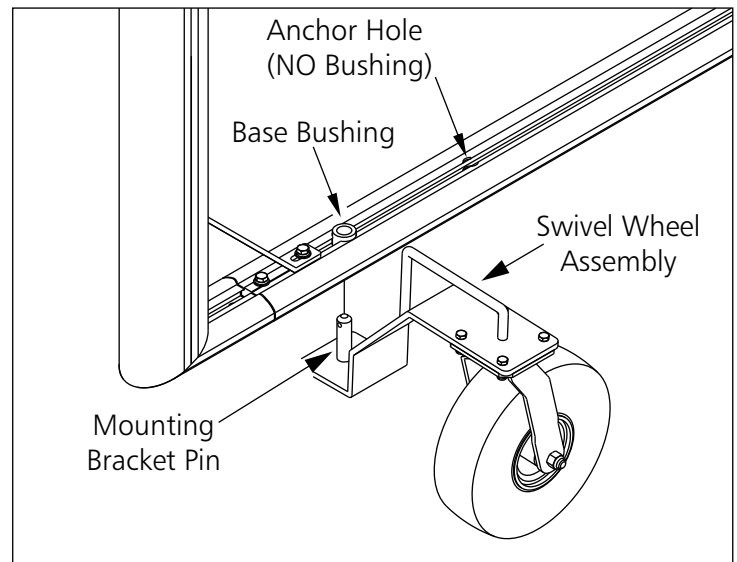

7. Loop cable lanyard around handle on swivel wheel assembly.

**\*\*\*CAUTION\*\*\***

This goal has been designed to be used for the game of soccer only. Goal posts must be anchored AT ALL TIMES and shall be secured against overturning. Do not climb on the net or goal framework at any time! All fastenings must be checked to insure they are fully tightened before and after each use of this product. Goal posts not in use must be disassembled and properly stored in a safe, secure area (See included Guidelines for Moveable Soccer Goal Safety.). Assembled goal posts should not be left unattended. Remove nets when goals are not in use. Do not use this equipment during the threat of high winds. Goal posts should be checked for safety before and after each use. All warning and safety labels included with this product must be visible at all times. Any modifications to this or any Kwik Goal product will void any and all warranties.

8. Attach hairpin cotter to cable lanyard and secure swivel wheel to goal frame with hairpin cotter as shown.

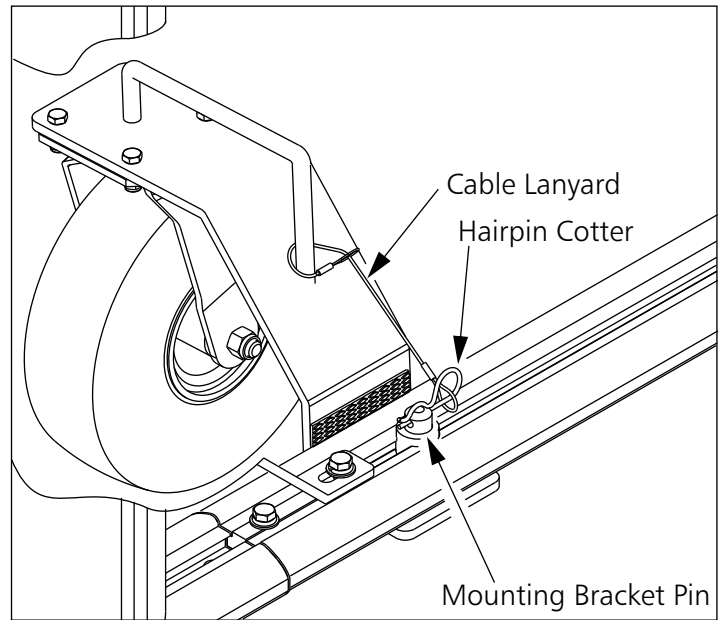
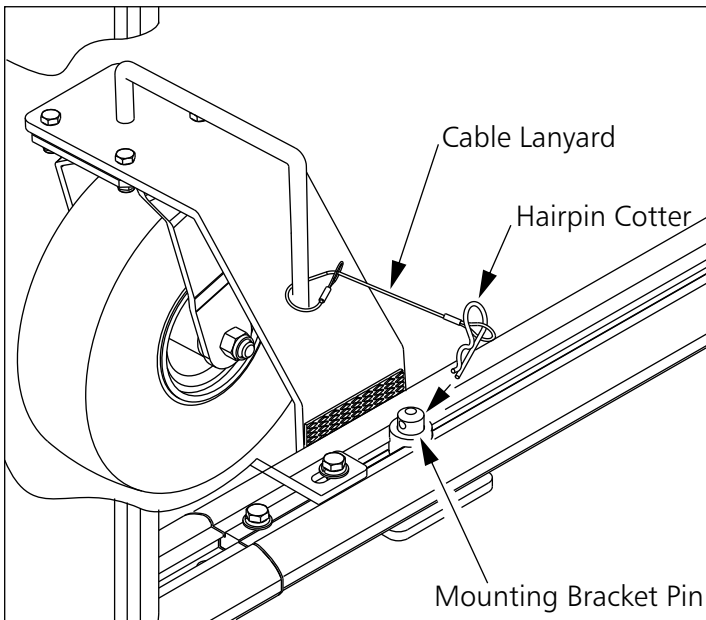

9. All 4 swivel wheel assemblies must be secured to goal frame before attempting to move goal. A minimum of 2 people are needed to move one goal.

**WHEELS MUST BE REMOVED**

**GOAL MUST BE ANCHORED AT ALL TIMES**

**DO NOT PLAY GOAL WITH WHEELS INSTALLED**

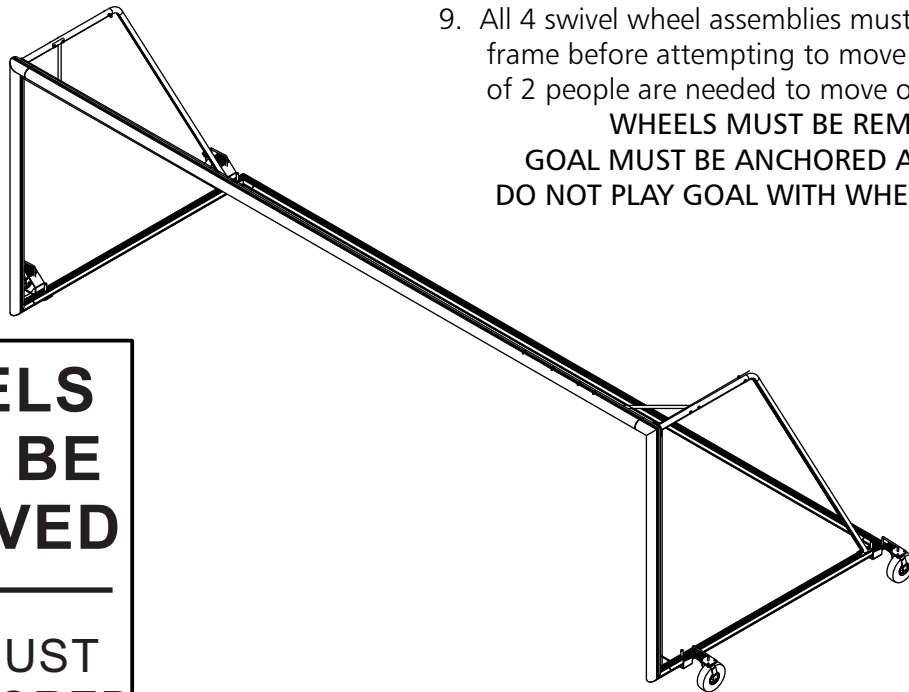

**WHEELS  
MUST BE  
REMOVED**

**GOAL MUST  
BE ANCHORED  
AT ALL TIMES**

10. Grease wheels and casters as needed to keep them spinning freely.

Go to [kwikgoal.com](http://kwikgoal.com) for additional product information.

**\*\*\*CAUTION\*\*\***

This goal has been designed to be used for the game of soccer only. Goal posts must be anchored AT ALL TIMES and shall be secured against overturning. Do not climb on the net or goal framework at any time! All fastenings must be checked to insure they are fully tightened before and after each use of this product. Goal posts not in use must be disassembled and properly stored in a safe, secure area (See included Guidelines for Moveable Soccer Goal Safety.). Assembled goal posts should not be left unattended. Remove nets when goals are not in use. Do not use this equipment during the threat of high winds. Goal posts should be checked for safety before and after each use.

All warning and safety labels included with this product must be visible at all times.

Any modifications to this or any Kwik Goal product will void any and all warranties.