

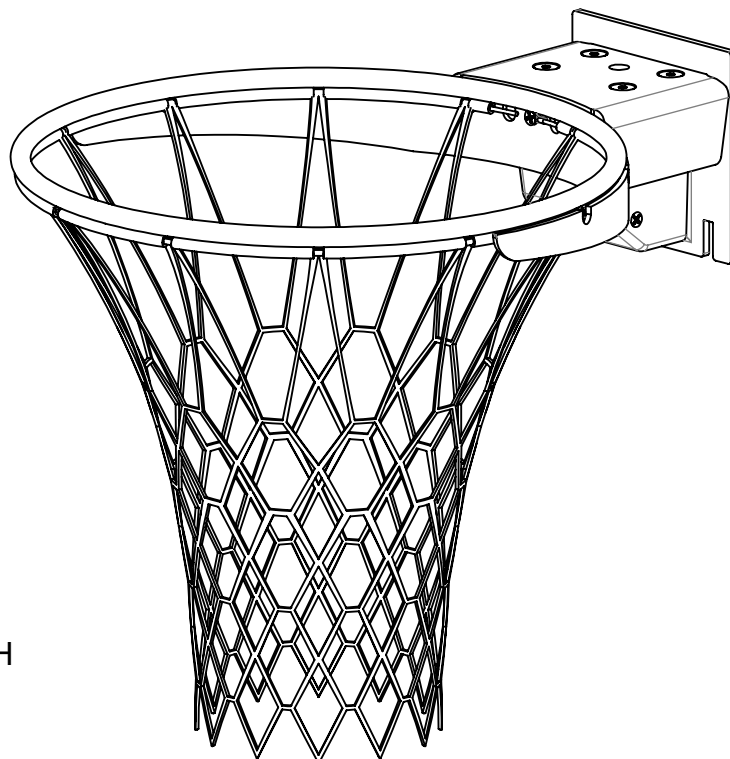

www.porterathletic.com
888-277-7778

280180

PORTER TFX 180° BREAKAWAY AND FLEX GOAL GOAL INSTALLATION AND ADJUSTMENT INSTRUCTIONS



TOOLS NEEDED:

- 5/16" HEX KEY
- 5/32" HEX KEY
- SOCKET WRENCH
- 1" SOCKET
- #2 PHILLIPS SCREWDRIVER
- ONE OF THE FOLLOWING:
 - 9/16" SOCKET
 - 9/16" CRESCENT WRENCH
 - ADJUSTABLE CRESCENT WRENCH

THIS GOAL UTILIZES BOTH BREAKAWAY AND FLEX FEATURES IN A FULL 180° TO DELIVER TOP PERFORMANCE FOR EVERY LEVEL OF BASKETBALL. FOLLOW THE INSTRUCTIONS PROVIDED IN THIS MANUAL TO ADJUST THE BREAKAWAY FORCE (WHICH IS THE AMOUNT OF FORCE REQUIRED TO MAKE THE RIM START TO FLEX) OR THE RIGIDITY OF THE RIM (AS CAN BE TESTED WITH PORTER'S FAIR-COURT SYSTEM® AND IS REQUIRED FOR NCAA DIVISION 1 LEVEL OF PLAY).

INSTALLATION

MOUNTING HARDWARE IS PROVIDED WITH THE GOAL. DUE TO THE GOAL'S UNIQUELY DESIGNED MOUNTING PLATE, MOUNTING HARDWARE CAN BE LOOSELY INSTALLED PRIOR TO MOUNTING OF THE GOAL TO SPEED UP THE INSTALLATION PROCESS. ONCE THE GOAL IS MOUNTED, ENSURE ALL HARDWARE IS SECURELY TIGHTENED DOWN BEFORE THE GOAL IS USED. FOLLOW THE MOUNTING DIAGRAM SHOWN ON THE NEXT PAGE.

PORTER TFX 180° BREAKAWAY AND FLEX GOAL GOAL INSTALLATION AND ADJUSTMENT INSTRUCTIONS

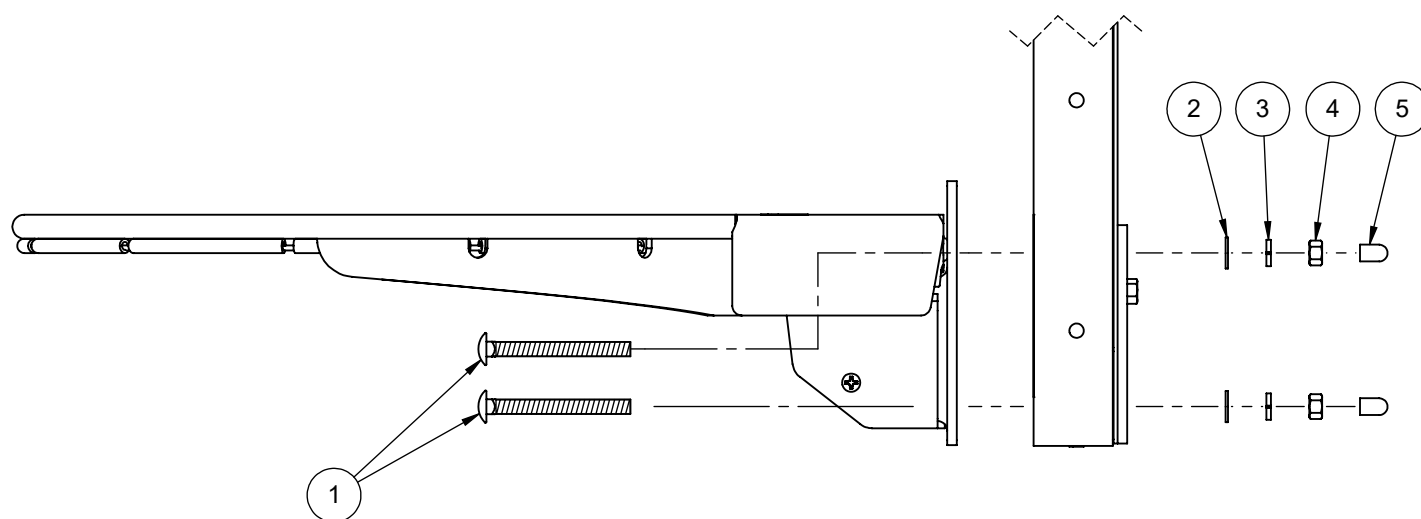

ITEM NO.	PART NUMBER	DESCRIPTION	QTY.
1	HDWE020790E0	CARRIAGE BOLT; 3/8"-16 X 3-3/4"; ZINC; GRADE 5	4
2	HDWE050040E0	FLAT WASHER; 3/8"; ZINC; USS	4
3	HDWE040020E0	LOCK WASHER; 3/8"; ZINC	4
4	HDWE030020E0	HEX NUT; 3/8"-16; ZINC	4
5	PCAP00040002	THREAD CAP; 3/8" X 1/2" LG	4

NOTE: IT IS RECOMMENDED THAT YOU DO NOT REMOVE THE (4) RIM ATTACHMENT BOLTS WHICH CONNECT THE RIM TO THE GOAL MECHANISM. IF REMOVAL AND REPLACEMENT IS NECESSARY, APPLY 242 BLUE LOCTITE TO THE BOLTS BEFORE REINSTALLING THEM.

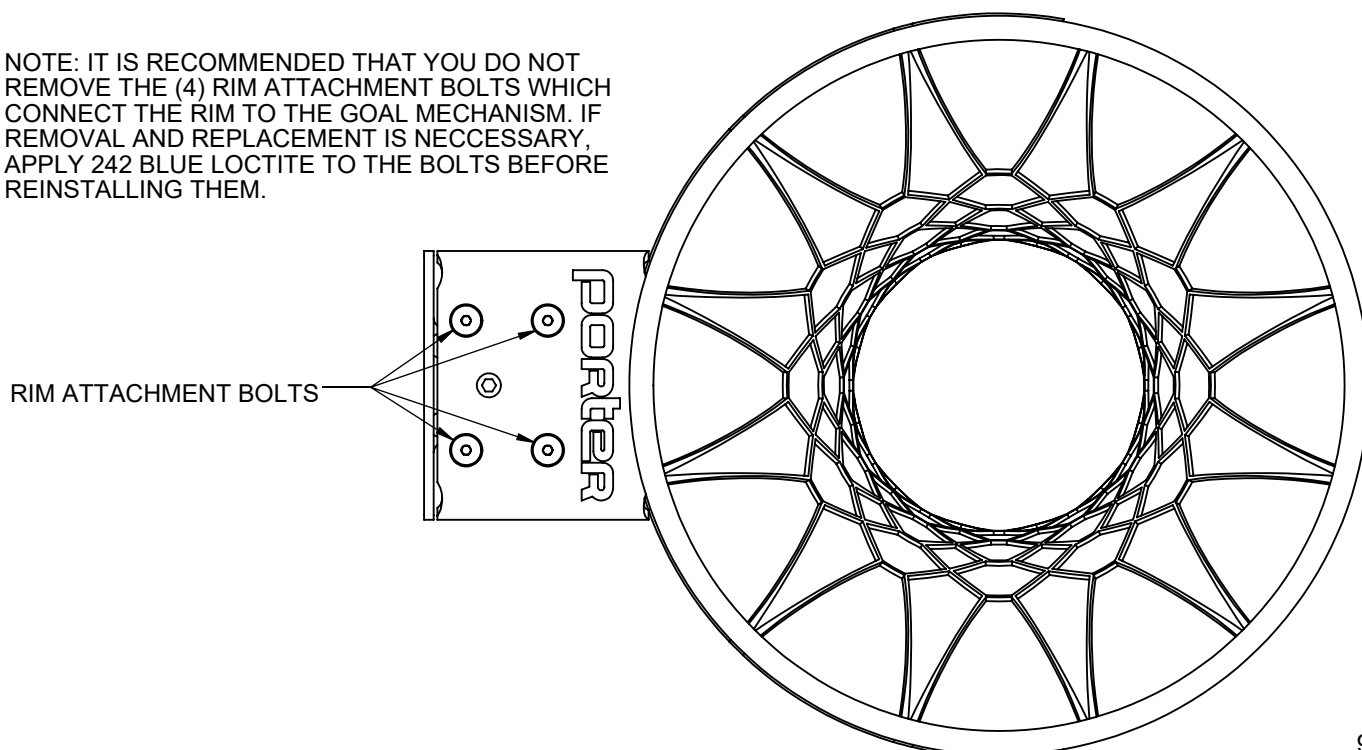



www.porterathletic.com
888-277-7778

280180

PORTER TFX 180° BREAKAWAY AND FLEX GOAL GOAL INSTALLATION AND ADJUSTMENT INSTRUCTIONS

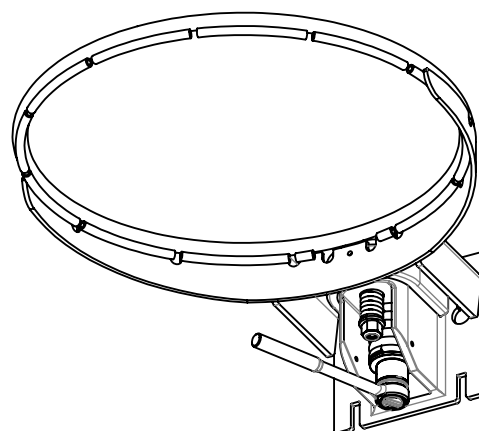
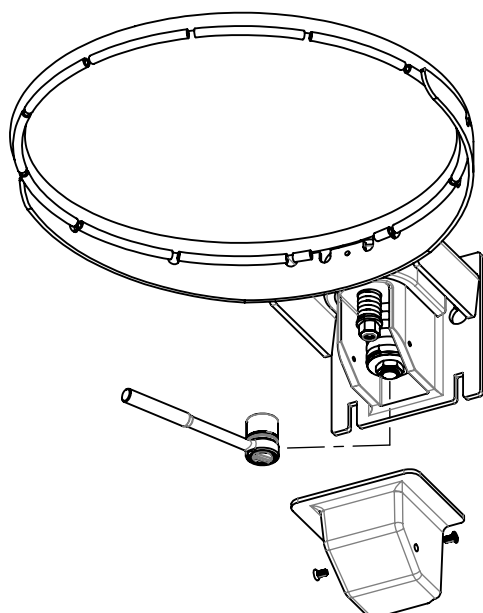

RIGIDITY ADJUSTMENT

TO ADJUST THE GOAL RIGIDITY, FIRST USE A #2 PHILLIPS HEAD SCREWDRIVER TO REMOVE THE RUBBER COVER ON THE BOTTOM OF THE GOAL TO EXPOSE THE GOAL'S SPRING MECHANISMS. PLACE A SOCKET WRENCH WITH A 1" SOCKET ONTO THE REAR, THIN NUT UNDERNEATH THE RED SPRING. FROM ABOVE THE GOAL, PLACE A 5/16" ALLEN WRENCH THROUGH THE OPEN HOLE ON TOP OF THE GOAL PLATE UNTIL IT FITS INTO THE SOCKET HEAD BOLT. TIGHTEN OR LOOSEN THE NUT (COMPRESSING OR RELAXING THE RED SPRING) TO ADJUST THE RIGIDITY READING OF THE GOAL. ONCE COMPLETE, REPLACE THE RUBBER COVER AND THE COVER BOLTS.

WARNINGS: THE THIN NUT MUST MAINTAIN ALL THREADS FULLY ENGAGED ON THE LARGE BOLT; FAILURE TO DO SO COULD RESULT IN FAILURE OF THE GOAL AND SEVERE INJURIES COULD OCCUR. ALSO, DO NOT MAKE ADJUSTMENTS TO THE NUT UNDER THE GOLD SPRING.

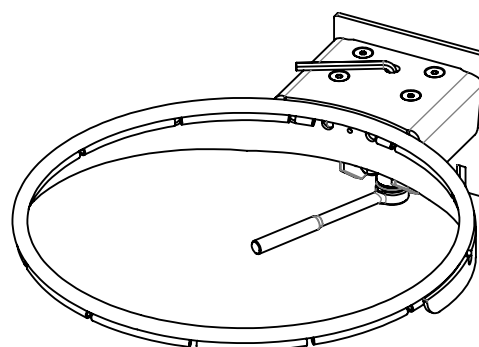
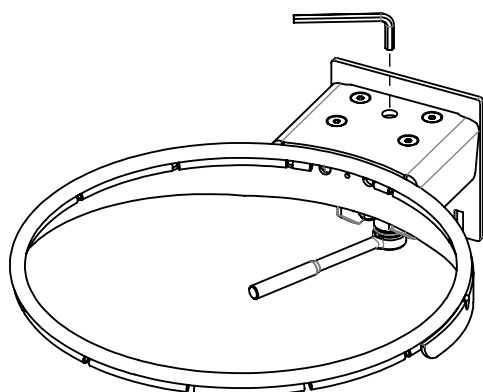

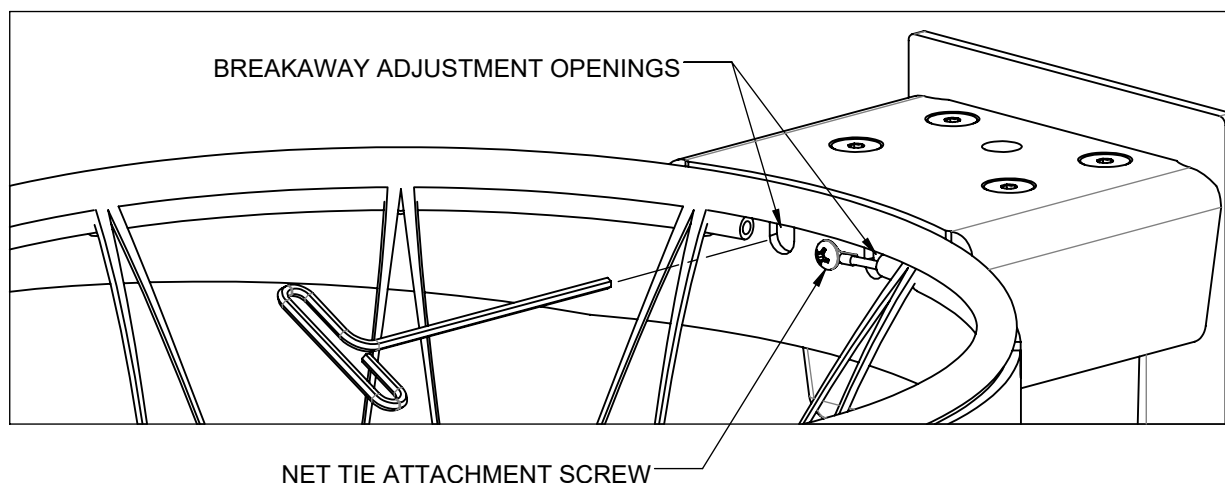

BREAKAWAY ADJUSTMENT

NO PARTS NEED TO BE REMOVED FROM THE GOAL IN ORDER TO ADJUST THE BREAKAWAY FORCE OF THE GOAL. SIMPLY INSERT A 5/32" ALLEN WRENCH INTO THE OPENINGS ON EITHER SIDE OF THE NET TIE CORD ATTACHMENT SCREW UNTIL IT FITS INTO THE SOCKET HEAD SET SCREWS INSIDE THE GOAL. TIGHTEN THE SET SCREWS (TURNING THE ALLEN WRENCH CLOCKWISE) TO INCREASE THE BREAKAWAY FORCE OF THE GOAL; LIKEWISE, LOOSENING THE SET SCREWS (TURNING COUNTERCLOCKWISE) WILL DECREASE THE BREAKAWAY FORCE OF THE GOAL.

NOTE: NFHS AND NCAA RULES DO NOT REQUIRE A BREAKAWAY GOAL, SO THE BREAKAWAY FORCE SETTING FOR THESE COMPETITIONS IS PERSONAL PREFERENCE. FIBA INTERNATIONAL RULES REQUIRE A BREAKAWAY FORCE BETWEEN 180LBS TO 230LBS, WHILE THE NBA SPECIFIES A BREAKAWAY FORCE OF 200LBS. RULE SPECIFICATIONS LISTED HEREIN ARE ACCURATE AT THE TIME OF WRITING OF THESE INSTRUCTIONS.

NOTE: DUE TO THE HIGH PRESSURES EXERTED BY THE BREAKAWAY MECHANISM, IT MAY BE DIFFICULT TO MAKE CHANGES TO THE RIGIDITY OF THE GOAL. IF CHANGES TO THE RIGIDITY ARE DESIRED, THE BREAKAWAY FORCE SETTING MAY NEED TO BE LOWERED PRIOR TO MAKING ADJUSTMENTS FOR THE GOAL RIGIDITY.

WARNING: GOING ABOVE A BREAKAWAY FORCE OF 230LBS CAN CAUSE DAMAGE TO THE GOAL AND RESULT IN THE BREAKAWAY AND/OR FLEX FEATURES OF THE GOAL TO NO LONGER FUNCTION PROPERLY.

⚠ WARNING: This product can expose you to Titanium Dioxide, which is known to the State of California to cause cancer. For more information go to www.p65warnings.ca.gov.