

FIRST TEAM SPORTS, INC

Champ III Basketball System - Product Specification

1. **VERTICAL POLE** - Vertical pole shall be one-piece 4" square (sectional posts not considered equal) with a minimum 11 gauge wall thickness and allow for burying 36" in concrete. Posts with thinner wall thickness are not considered equal. Posts intended to be buried less than 36" are not considered equal. Pole shall have a watertight vinyl cap to seal out moisture.

2. **EXTENSION ARMS** - Adjustable extension arms shall be constructed of 1 1/2" x 1 1/2" tubing. Extension shall allow for a minimum 18" from front of post to face of backboard with rim at 10' playing height. Pole structure design shall allow for rim height to be adjusted in six inch increments from 10' down to 7 1/2' by using a pole or broom handle to release an adjustment mechanism located in the extension assembly. Two springs mounted in the extension assembly shall be included to counteract the weight of the backboard and rim making one-person adjustments easy. Pole design shall permit the rim to be mounted directly to the extension arm through the backboard so as to reduce stress on the backboard.

3. **BACKBOARD** - Constructed of 1/2" thick acrylic with bright white screening. The framework shall be constructed from clear anodized aluminum "L" type extrusions. Overall backboard size shall be approximately 54" wide and 36" high.

4. **RIM** - Standard rim shall be of a flexible type so as to absorb the stress of player contact. Spring action shall be provided by a heavy duty compression wire spring. A steel coverplate must enclose entire internal mechanism. All structural components shall be built of no less than 3/16" steel. Rim shall be of institutional quality with an official 5/8" diameter high strength steel ring supported by a 3/16" brace supporting 60% of the ring. Rim shall be punched to mount either a 3"x 4" or 5"x 5" hole pattern. Orange powdercoated finish.

5. **WARRANTY** - Pole, backboard, and standard rim shall carry Lifetime Limited Warranty. Entire system weight shall be approximately 160#.

**FIRST TEAM SPORTS, INC.
902 COREY ROAD
HUTCHINSON, KS 67501
TOLL FREE: 888-884-6677**

FIRST TEAM SPORTS INC.
HUTCHINSON, KS 67501

1-800-649-3688
www.firstteaminc.com

CHAMP III

PRODUCT SUBMITTAL

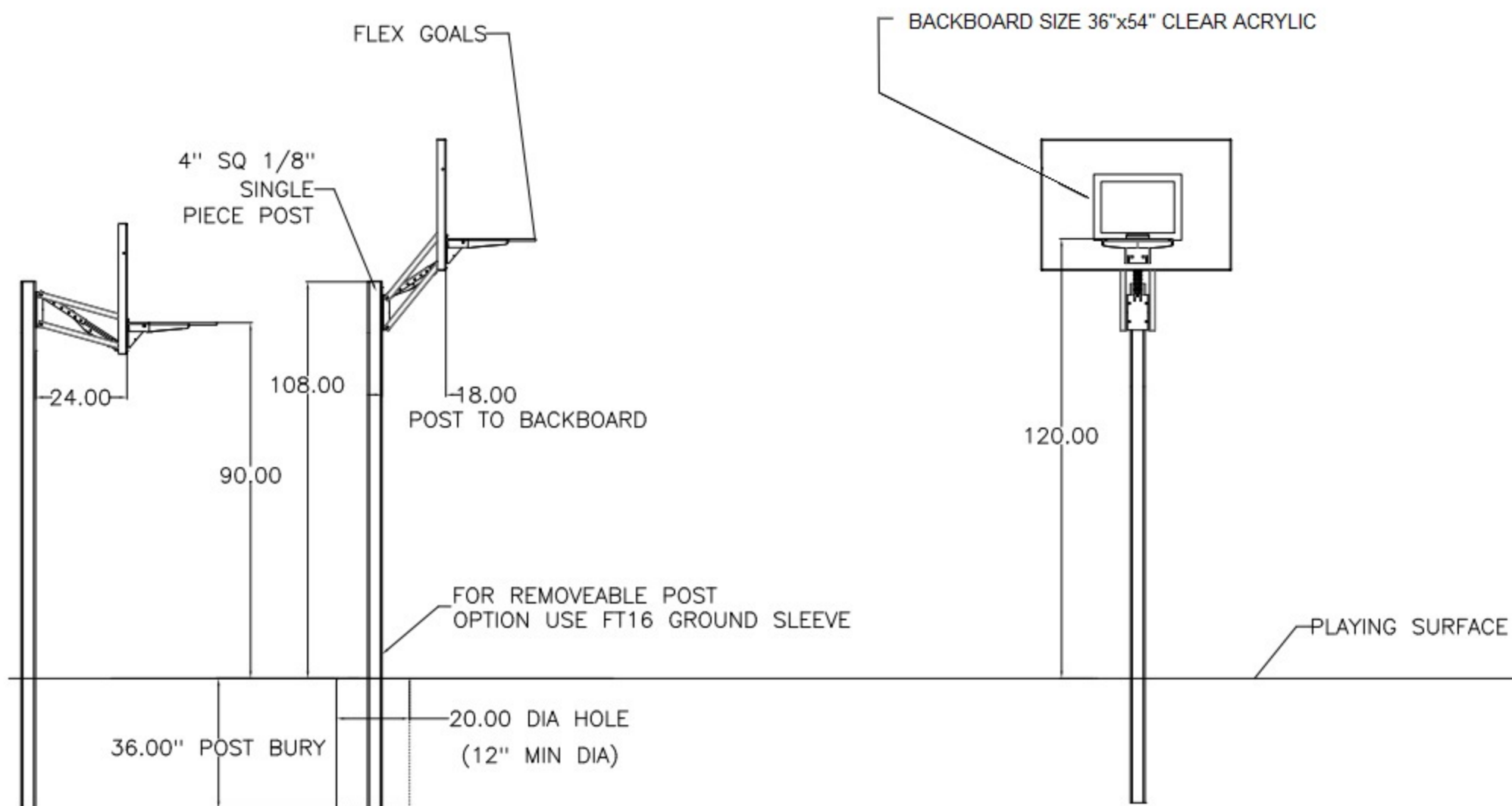

Champ Turbo Basketball System

1. **VERTICAL POLE** - Vertical pole shall be one-piece 4" square (sectional posts not considered equal) with a minimum 11 gauge wall thickness and allow for burying 36" in concrete. Posts with thinner wall thickness are not considered equal. Posts intended to be buried less than 36" are not considered equal. Pole shall have a watertight vinyl cap to seal out moisture.
2. **EXTENSION ARMS** - Adjustable extension arms shall be constructed of 1 1/2" x 1 1/2" tubing. Extension shall allow for a minimum 18" from front of post to face of backboard with rim at 10' playing height. Pole structure design shall allow for rim height to be adjusted in six inch increments from 10' down to 7 1/2' by using a pole or broom handle to release an adjustment mechanism located in the extension assembly. Two springs mounted in the extension assembly shall be included to counteract the weight of the backboard and rim making one-person adjustments easy. Pole design shall permit the rim to be mounted directly to the extension arm through the backboard so as to reduce stress on the backboard.
3. **BACKBOARD** – Constructed of 1/4" thick clear tempered glass with bright white ceramic markings fired into the glass. The framework shall be constructed from clear anodized aluminum "L" type extrusions. Overall backboard size shall be approximately 54" wide and 36" high.
4. **RIM** - Standard rim shall be of a flexible type so as to absorb the stress of player contact. Spring action shall be provided by a heavy duty compression wire spring. A steel coverplate must enclose entire internal mechanism. All structural components shall be built of no less than 3/16" steel. Rim shall be of institutional quality with an official 5/8" diameter high strength steel ring supported by a 3/16" brace supporting 60% of the ring. Rim shall be punched to mount either a 3"x 4" or 5"x 5" hole pattern. Orange powdercoated finish.
5. **WARRANTY** - Pole, backboard, and standard rim shall carry Lifetime Superior Warranty. Entire system weight shall be approximately 170#.

Champ Nitro Basketball System

1. **VERTICAL POLE** - Vertical pole shall be one-piece 4" square (sectional posts not considered equal) with a minimum 11 gauge wall thickness and allow for burying 36" in concrete. Posts with thinner wall thickness are not considered equal. Posts intended to be buried less than 36" are not considered equal. Pole shall have a watertight vinyl cap to seal out moisture.
2. **EXTENSION ARMS** - Adjustable extension arms shall be constructed of 1 1/2" x 1 1/2" tubing. Extension shall allow for a minimum 18" from front of post to face of backboard with rim at 10' playing height. Pole structure design shall allow for rim height to be adjusted in six inch increments from 10' down to 7 1/2' by using a pole or broom handle to release an adjustment mechanism located in the extension assembly. Two springs mounted in the extension assembly shall be included to counteract the weight of the backboard and rim making one-person adjustments easy. Pole design shall permit the rim to be mounted directly to the extension arm through the backboard so as to reduce stress on the backboard.
3. **BACKBOARD** – Constructed of 1/4" thick clear tempered glass with bright white ceramic markings fired into the glass. The framework shall be constructed from clear anodized aluminum "L" type extrusions. Overall backboard size shall be approximately 60" wide and 36" high.
4. **RIM** - Standard rim shall be of a flexible type so as to absorb the stress of player contact. Spring action shall be provided by a heavy duty compression wire spring. A steel coverplate must enclose entire internal mechanism. All structural components shall be built of no less than 3/16" steel. Rim shall be of institutional quality with an official 5/8" diameter high strength steel ring supported by a 3/16" brace supporting 60% of the ring. Rim shall be punched to mount either a 3"x 4" or 5"x 5" hole pattern. Orange powdercoated finish.
5. **WARRANTY** - Pole, backboard, and standard rim shall carry Lifetime Superior Warranty. Entire system weight shall be approximately 170#.

FIRST TEAM SPORTS INC.
HUTCHINSON, KS 67501

1-800-649-3688
www.firstteaminc.com

CHAMP NITRO

PRODUCT SUBMITTAL

