



ASSEMBLY INSTRUCTIONS FOR 9B1902 SHADE SHELTER

THIS UNIT MUST BE ASSEMBLED BY A MINIMUM OF TWO QUALIFIED PERSONS.

1. Unpack all parts and check for damage that may have occurred during shipping. If damage has occurred, notify Kwik Goal immediately. Lay out all parts. Remove all cardboard and packaging immediately. Wet or damp packaging may damage contents.
2. Read through entire instruction before beginning assembly and installation.

NOTE: Components may be packaged in one or more additional boxes.

Parts

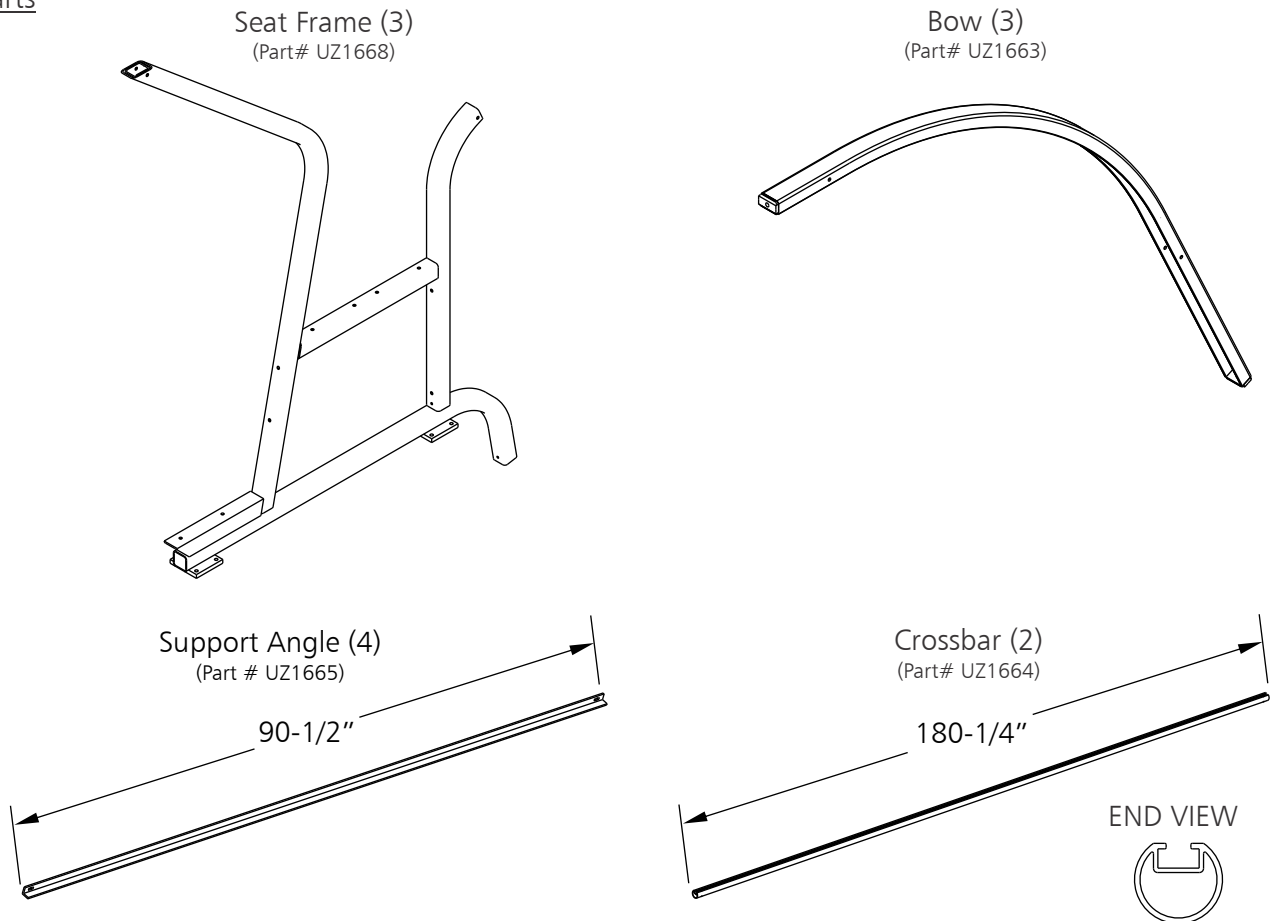

THIS UNIT MUST BE ANCHORED ACCORDING TO THESE INSTRUCTIONS AT ALL TIMES

⚠ WARNING THIS EQUIPMENT MUST BE STORED IN A SECURED, SHELTERED AREA WHEN NOT IN USE OR IN THE THREAT OF HIGH WINDS. ANY WEATHER DAMAGE TO THIS EQUIPMENT WILL NOT BE COVERED UNDER KWIK GOAL'S PRODUCT GUARANTEE. DO NOT LEAVE THIS EQUIPMENT UNATTENDED.



⚠ WARNING

IMPORTANT SAFETY INSTRUCTIONS

READ CAREFULLY

1. All Kwik Goal shelters must be moved by qualified personnel who are experienced in moving field equipment.
2. A minimum of two qualified, experienced people are required to move shelter.
3. Do not attempt to lift or move shelter in windy conditions.
4. Shelters must not be left unattended and unsecured.
5. Shelter must be on level, flat ground at all times.
6. Use extreme caution when pushing shelter. Excessive force can overturn shelter. Always push at lowest point on shelter frame possible.
7. Do not push shelter directly from the front to rear or rear to front. Push from end to end.

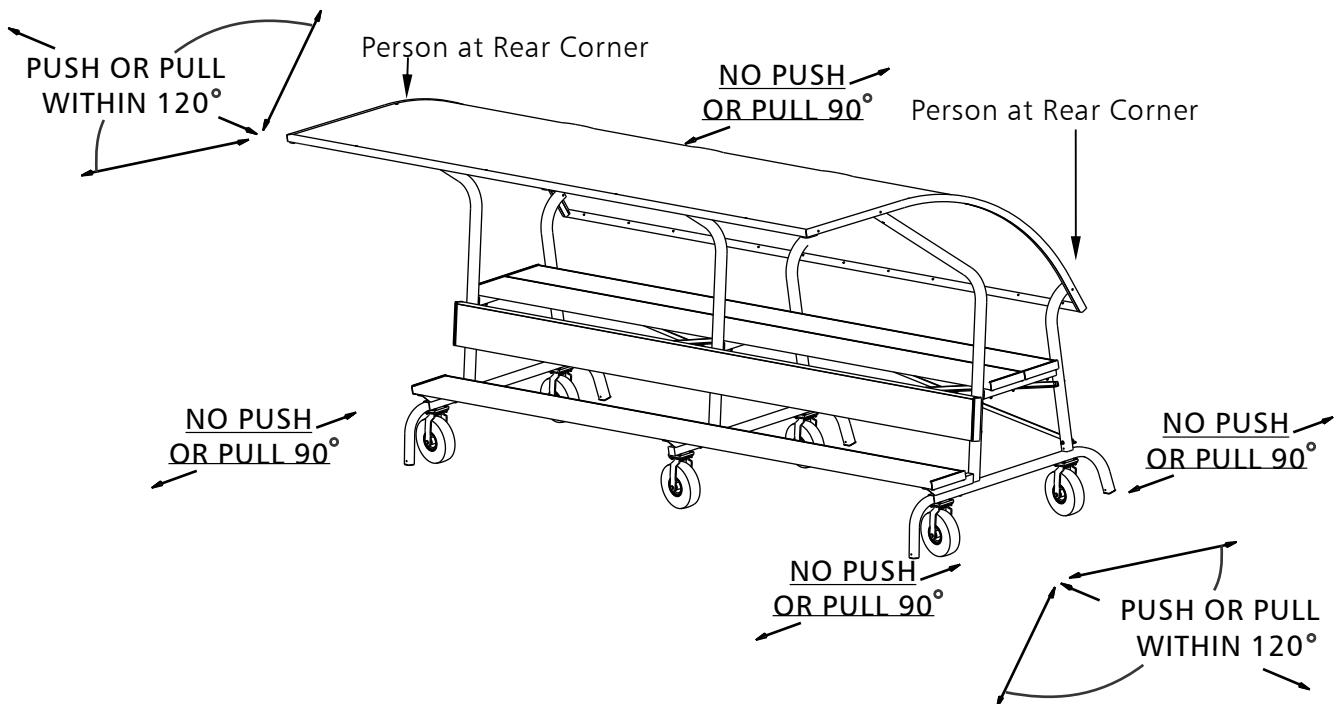

NEVER LEAVE SHELTERS UNATTENDED AND UNSECURED

Parts Continued

Plank (4)
(Part# UZ468 Plain)
(Part # UZ1118 Color)

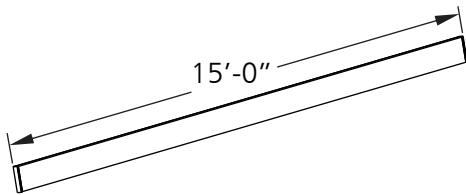

Bungees (34)
(Part# 10B3501 PK 30)

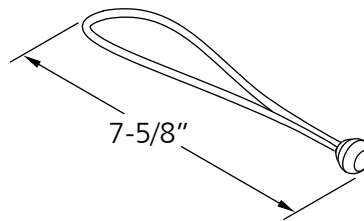

Plank Hold Down
(See Bench Hdw)
(Part # UZ475)

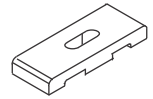

Cover (1)
(Part # VZ863)

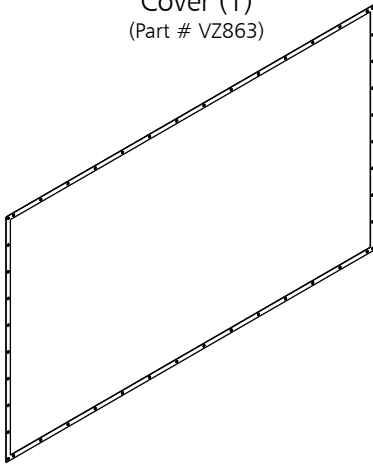

Swivel Wheel (4)
(Part# VZ629)

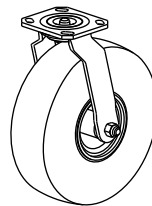

Swivel Wheel w/ Brake (2)
(Part# VZ747)

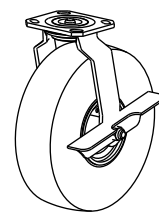

Kwik Fill Anchor Bag (4)
(Part# 10B5909)

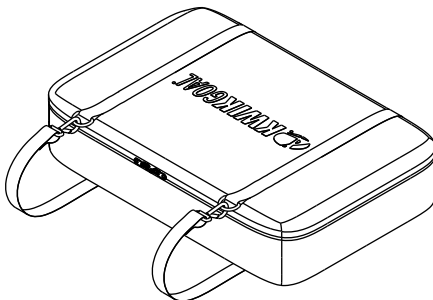

Cover Clip (14)
(Part# JZ240-14)



Crossbar Cap
(See Top Hdw)
(Part # VZ676)



Ground Anchor (4)
w/hardware
(Part# 10B103 Set of 4)

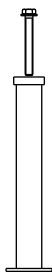

Anchor Plate and Chain (4)
(Part# UZ846)

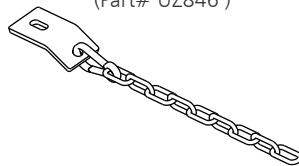

Stabilizer Bar (2)
(Part # UZ1428)

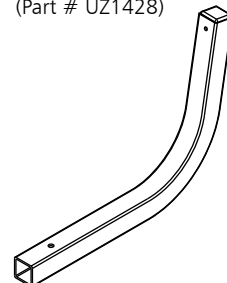

THIS UNIT MUST BE ANCHORED ACCORDING TO THESE INSTRUCTIONS AT ALL TIMES

⚠ WARNING

THIS EQUIPMENT MUST BE STORED IN A SECURED, SHELTERED AREA WHEN NOT IN USE OR IN THE THREAT OF HIGH WINDS. ANY WEATHER DAMAGE TO THIS EQUIPMENT WILL NOT BE COVERED UNDER KWIK GOAL'S PRODUCT GUARANTEE. DO NOT LEAVE THIS EQUIPMENT UNATTENDED.

Parts Continued

Note: Hardware is packed separately in one or more boxes. Open all boxes and layout all sealed hardware packs before beginning assembly.

Anchor Hdw (Part# JZ269)

3/8" X 2-1/2" Eye Bolt (Part# TZ421)	(4)
3/8" Lock Nut (Part# TZ197)	(4)
3/8" Flat Washer (Part# TZ189)	(4)

Shelter Hdw (Part# JZ177)

5/16" X 1-1/4" Hex Bolt (Part# TZ311)	(24)
5/16" X 2-3/4" Carriage Bolt (Part# TZ191)	(4)
5/16" X 3" Carriage Bolt (Part# TZ172)	(2)
5/16" Lock Nut (Part# TZ5)	(30)
5/16" Flat Washer (Part# TZ4)	(30)

Bench Hdw (Part# JZ178)

5/16" X 3" Carriage Bolt (Part# TZ172)	(18)
5/16" Lock Nut (Part# TZ5)	(24)
5/16" Flat Washer (Part# TZ4)	(24)
5/16" X 1-1/4" Carriage Bolt (Part# TZ350)	(6)
Bench Hold Down (Part# UZ475)	(24)

Top Hdw (Part# JZ266)

5/16" Flat Washer (Part# TZ4)	(12)
5/16" Lock Nut (Part# TZ321)	(6)
5/16" X 3" Hex Bolt (Part# TZ183)	(6)
3/8" Square Nut (Part# TZ247)	(6)
3/8" x 7/8" Hex Bolt (Part# TZ249)	(6)
3/8" Flat Washer (Part# TZ60)	(6)
3/8" Lock Washer (Part# TZ65)	(6)
Crossbar Cap (Part# VZ676)	(4)

Assembly Tools

1/2", 9/16", & 3/4" Wrench

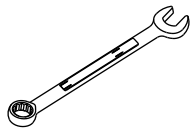

Ratchet with
1/2", 9/16", & 3/4" Socket

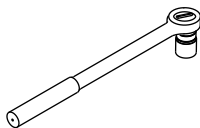

THIS UNIT MUST BE ANCHORED ACCORDING TO THESE INSTRUCTIONS AT ALL TIMES

⚠ WARNING THIS EQUIPMENT MUST BE STORED IN A SECURED, SHELTERED AREA WHEN NOT IN USE OR IN THE THREAT OF HIGH WINDS. ANY WEATHER DAMAGE TO THIS EQUIPMENT WILL NOT BE COVERED UNDER KWIK GOAL'S PRODUCT GUARANTEE. DO NOT LEAVE THIS EQUIPMENT UNATTENDED.

3. Hardware for steps 3 through 10 is in the Shelter Hdw and Bench Hdw packs.
Attach plank hold downs to seat frame and hand tighten nut on carriage bolt at locations shown. Align plank hold down parallel with slot in plank, insert, and turn ninety degrees (quarter turn) to attach plank to seat frame. Center the middle seat frame on plank and tighten nuts just enough to hold the plank against seat frames. Do not tighten at this time.
4. Attach support angles to seat frames using washer and lock nuts. Do not tighten at this time.

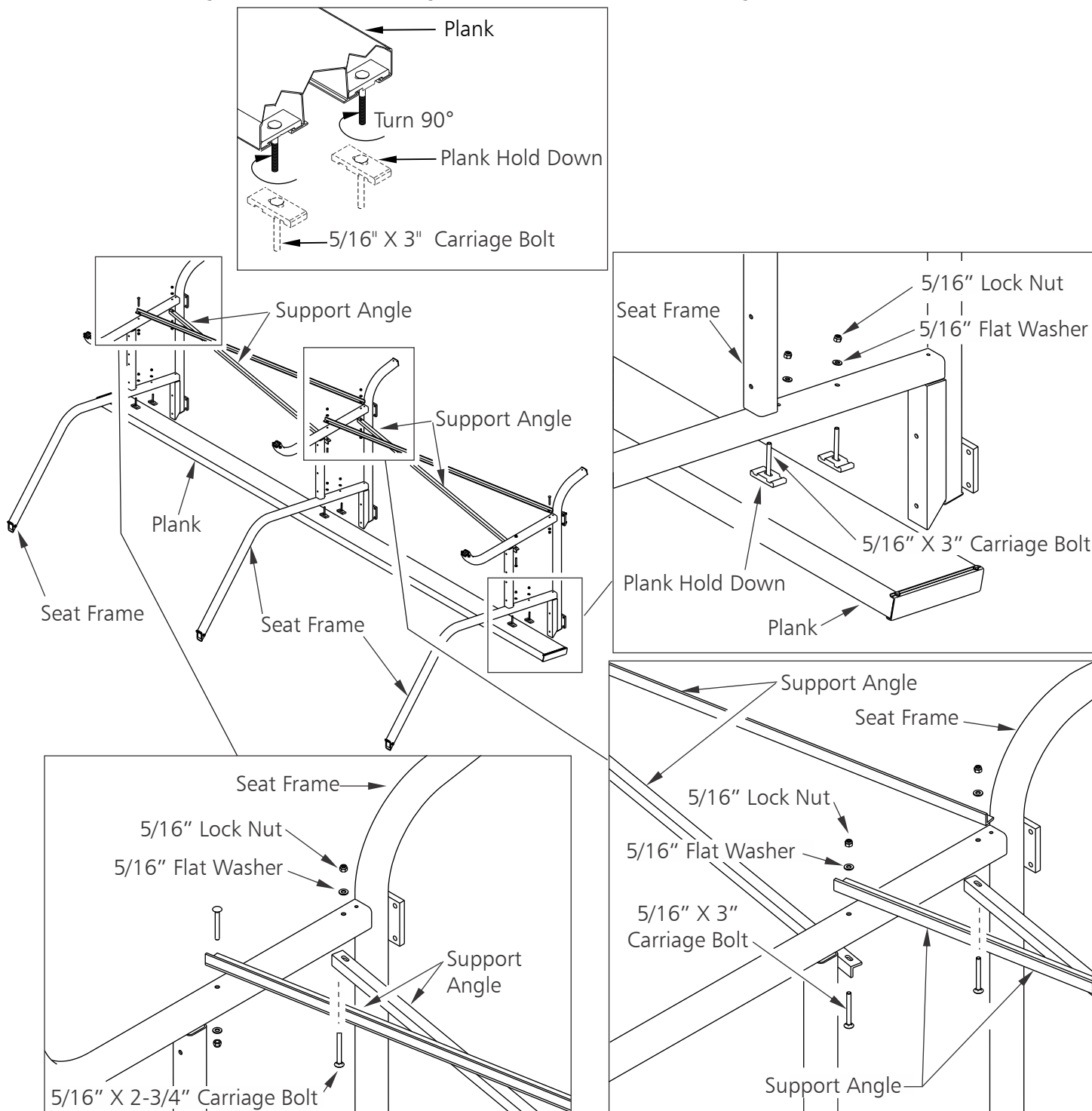

THIS UNIT MUST BE ANCHORED ACCORDING TO THESE INSTRUCTIONS AT ALL TIMES

⚠ WARNING

THIS EQUIPMENT MUST BE STORED IN A SECURED, SHELTERED AREA WHEN NOT IN USE OR IN THE THREAT OF HIGH WINDS. ANY WEATHER DAMAGE TO THIS EQUIPMENT WILL NOT BE COVERED UNDER KWIK GOAL'S PRODUCT GUARANTEE. DO NOT LEAVE THIS EQUIPMENT UNATTENDED.

5. Position plank to extend past end seat frame by 1-1/2". Be sure seat frame is square with plank and tighten both plank bolts.
6. Position center seat frame at 89-1/2" from end seat frame (secured in step 5), square seat frame with planks and tighten both plank bolts.
7. Position loose end seat frame at 89-1/2" from center seat frame, square seat frame to plank and tighten both plank bolts.
8. Confirm 89-1/2" measurements from center to end seat frames and tighten all six seat frame brace bolts

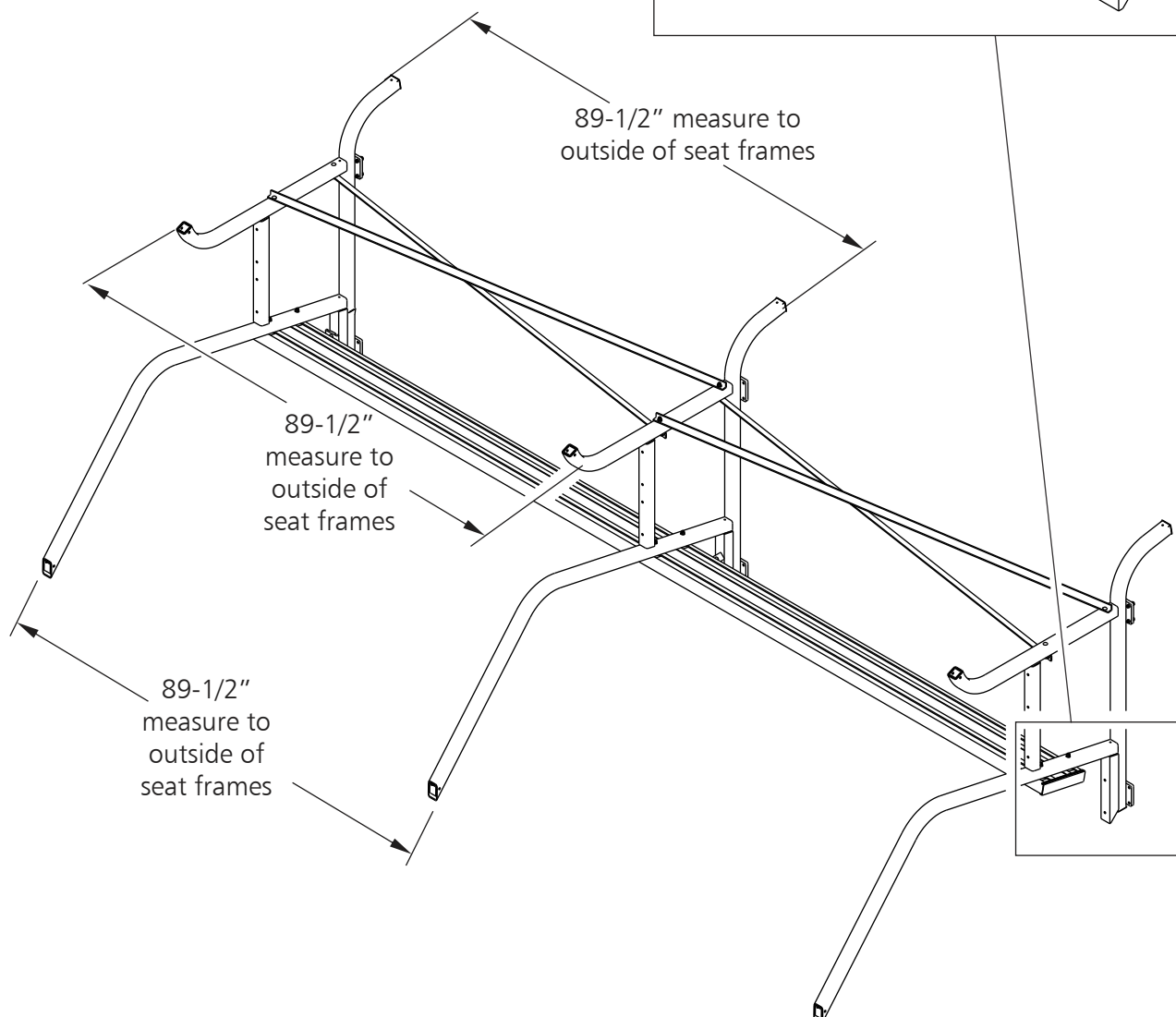
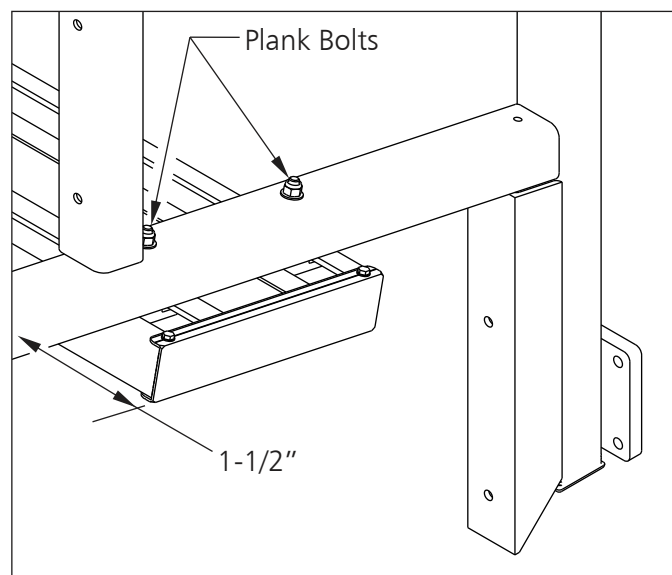

THIS UNIT MUST BE ANCHORED ACCORDING TO THESE INSTRUCTIONS AT ALL TIMES

⚠ WARNING

THIS EQUIPMENT MUST BE STORED IN A SECURED, SHELTERED AREA WHEN NOT IN USE OR IN THE THREAT OF HIGH WINDS. ANY WEATHER DAMAGE TO THIS EQUIPMENT WILL NOT BE COVERED UNDER KWIK GOAL'S PRODUCT GUARANTEE. DO NOT LEAVE THIS EQUIPMENT UNATTENDED.

9. Attach swivel wheel assemblies to each of the three seat frames as shown.

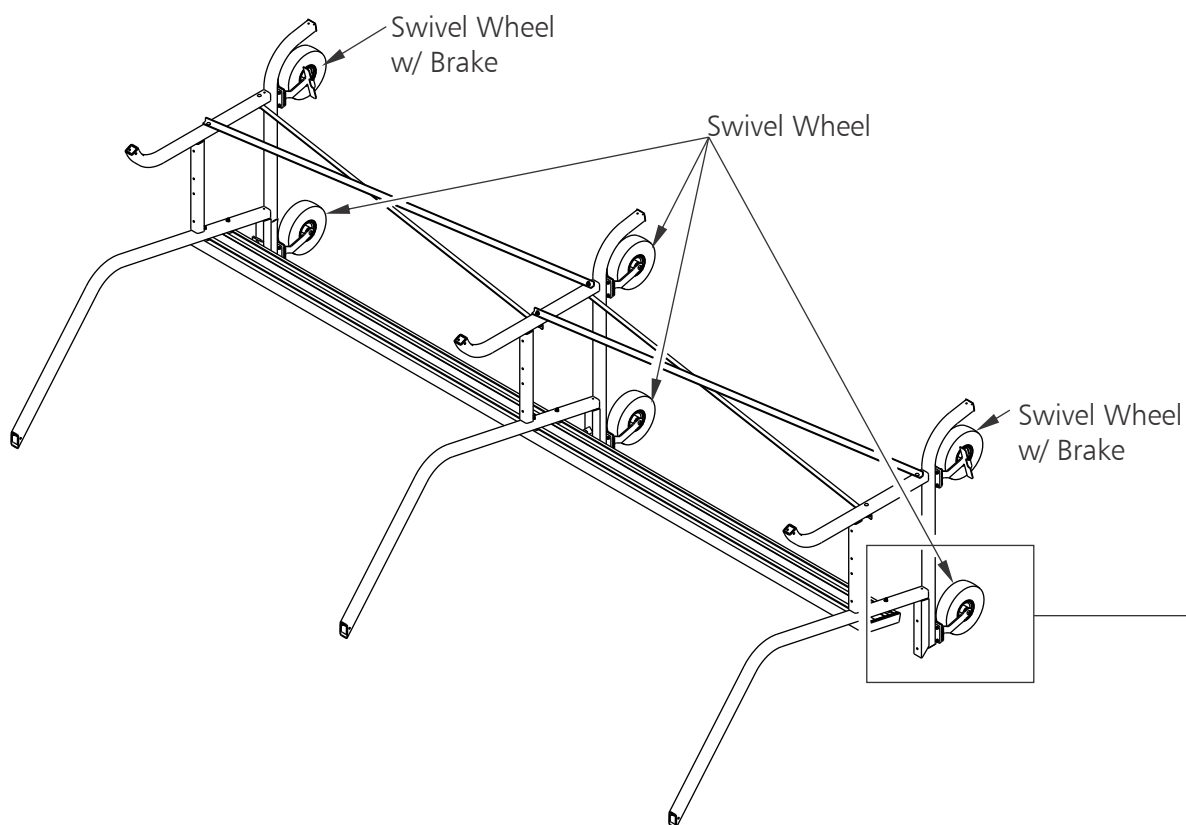
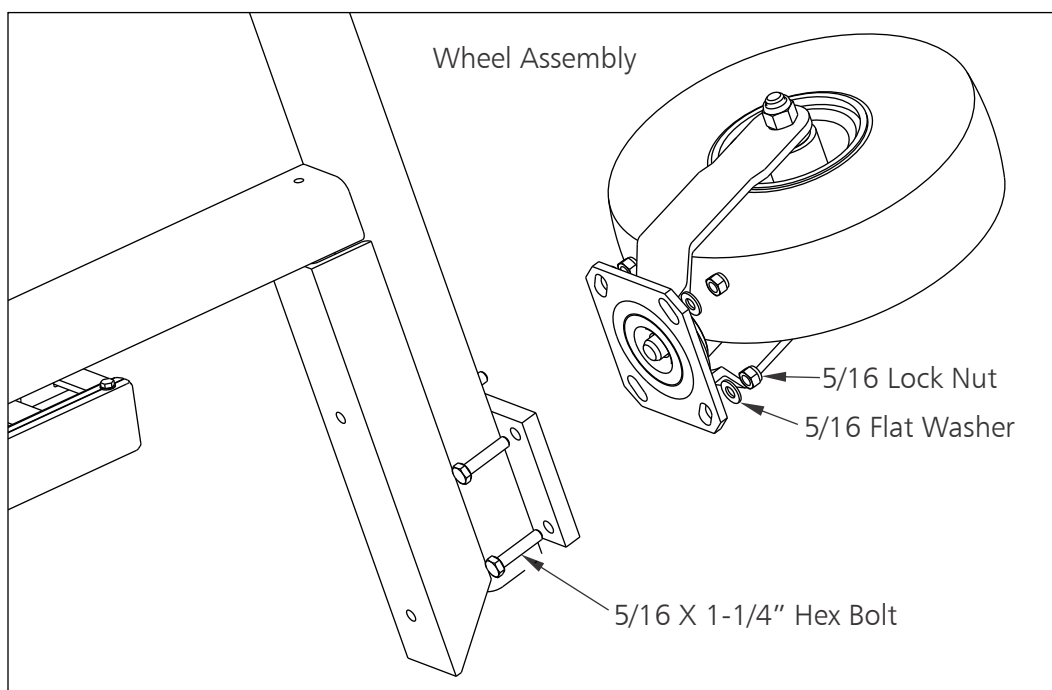

THIS UNIT MUST BE ANCHORED ACCORDING TO THESE INSTRUCTIONS AT ALL TIMES

⚠ WARNING

THIS EQUIPMENT MUST BE STORED IN A SECURED, SHELTERED AREA WHEN NOT IN USE OR IN THE THREAT OF HIGH WINDS. ANY WEATHER DAMAGE TO THIS EQUIPMENT WILL NOT BE COVERED UNDER KWIK GOAL'S PRODUCT GUARANTEE. DO NOT LEAVE THIS EQUIPMENT UNATTENDED.

10. Refer to step 3 for assembling the shelf planks to the seat frames. Tighten all shelf plank bolts. Turn shelter to the upright position.

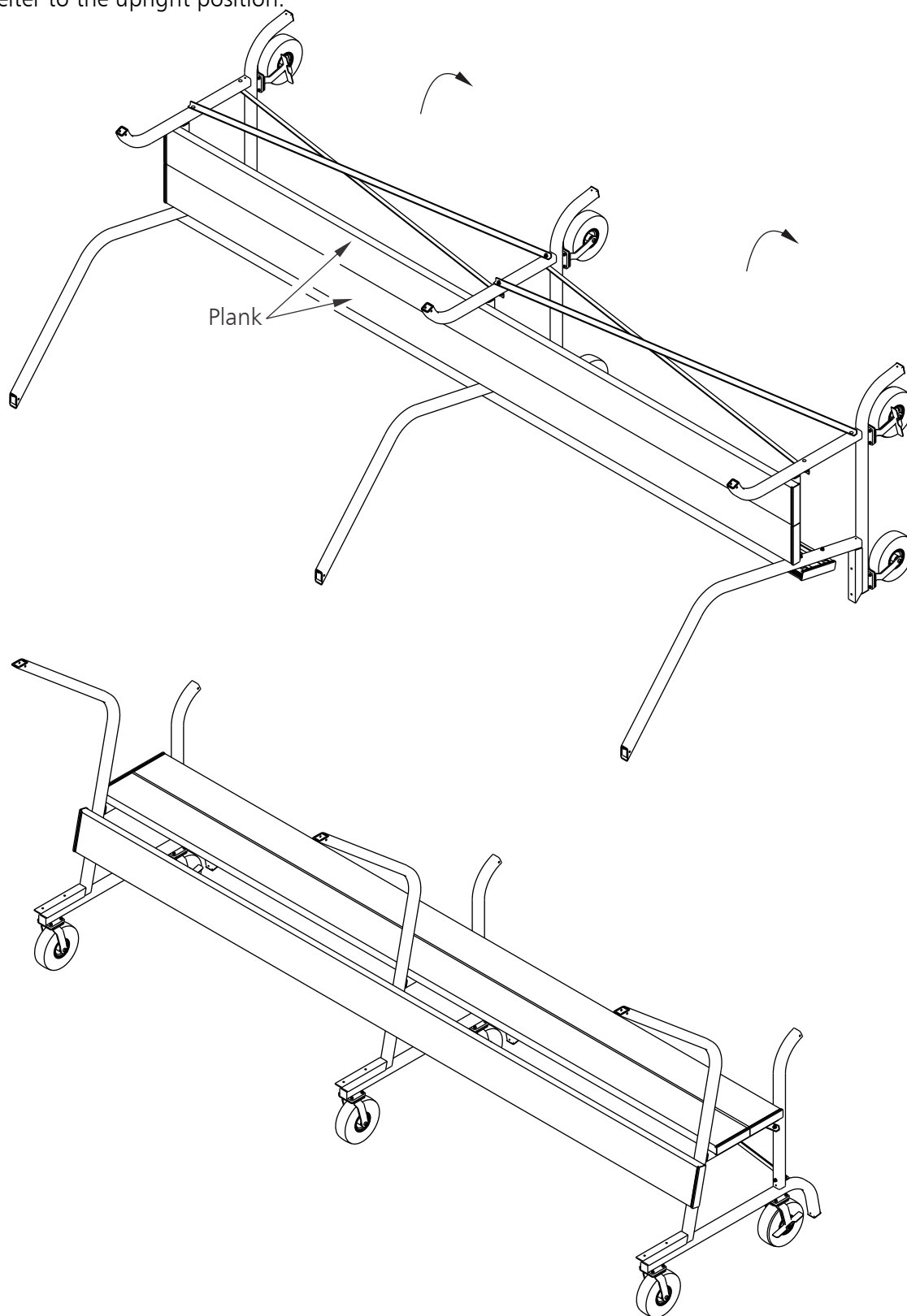

THIS UNIT MUST BE ANCHORED ACCORDING TO THESE INSTRUCTIONS AT ALL TIMES

⚠ WARNING THIS EQUIPMENT MUST BE STORED IN A SECURED, SHELTERED AREA WHEN NOT IN USE OR IN THE THREAT OF HIGH WINDS. ANY WEATHER DAMAGE TO THIS EQUIPMENT WILL NOT BE COVERED UNDER KWIK GOAL'S PRODUCT GUARANTEE. DO NOT LEAVE THIS EQUIPMENT UNATTENDED.

11. Hardware for steps 11 through 13 is in the **Top Hdw** pack.
Attach 3 bows to seat frames as shown. Note: Do not over tighten bolts.

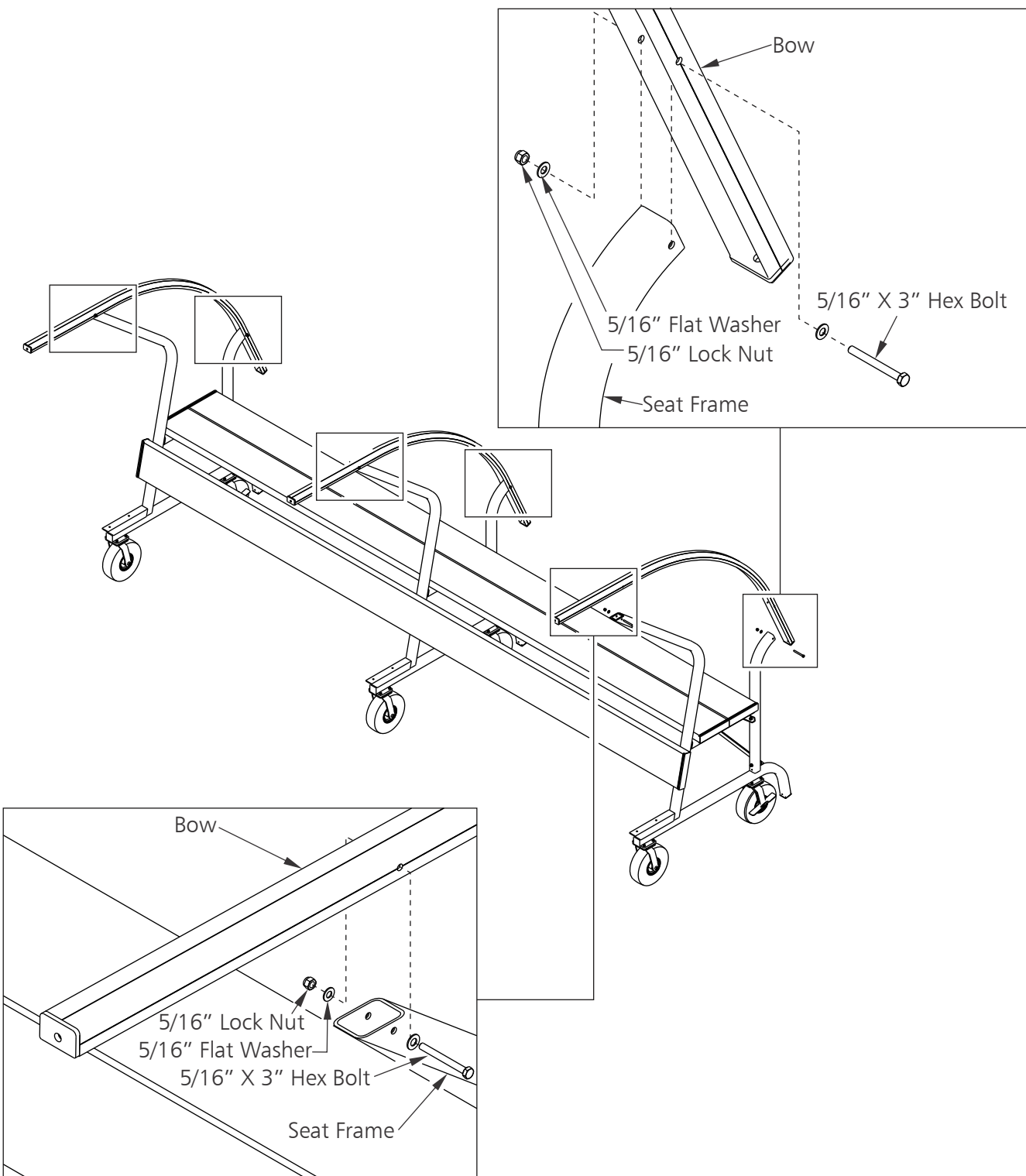

THIS UNIT MUST BE ANCHORED ACCORDING TO THESE INSTRUCTIONS AT ALL TIMES

⚠ WARNING THIS EQUIPMENT MUST BE STORED IN A SECURED, SHELTERED AREA WHEN NOT IN USE OR IN THE THREAT OF HIGH WINDS. ANY WEATHER DAMAGE TO THIS EQUIPMENT WILL NOT BE COVERED UNDER KWIK GOAL'S PRODUCT GUARANTEE. DO NOT LEAVE THIS EQUIPMENT UNATTENDED.

12. Attach crossbars to bows, making sure Kwik Goal is at the correct orientation as shown. Note: Do not over tighten bolts.

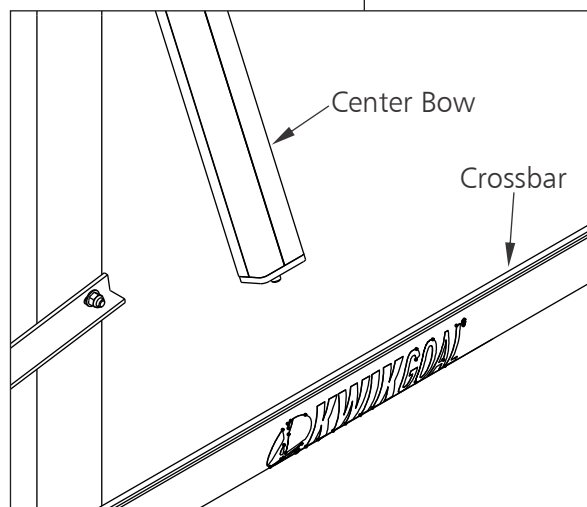
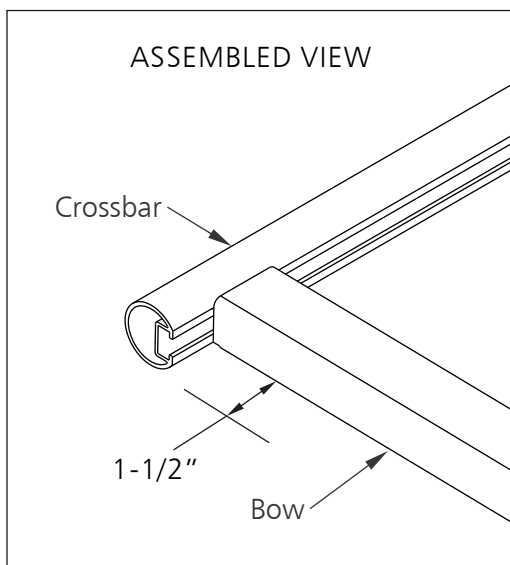
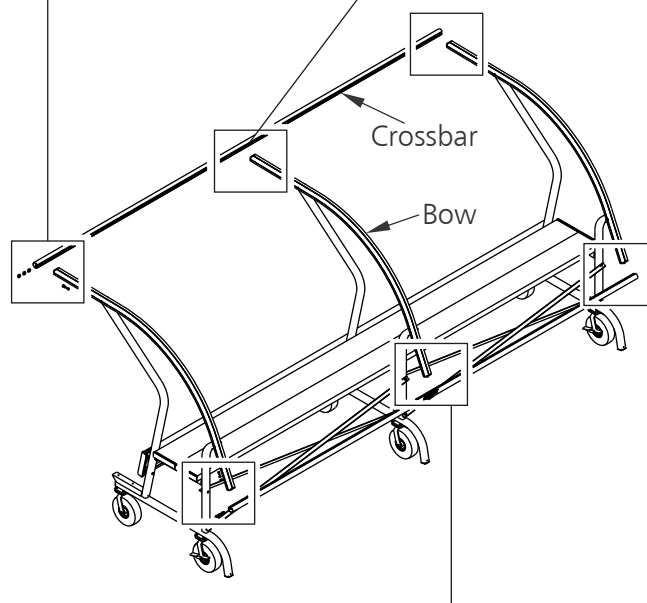
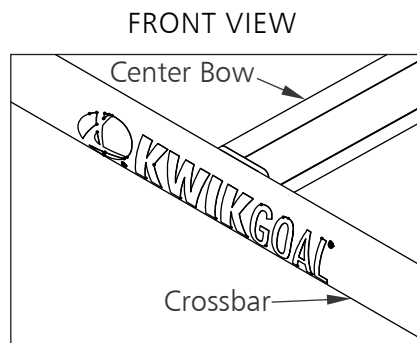
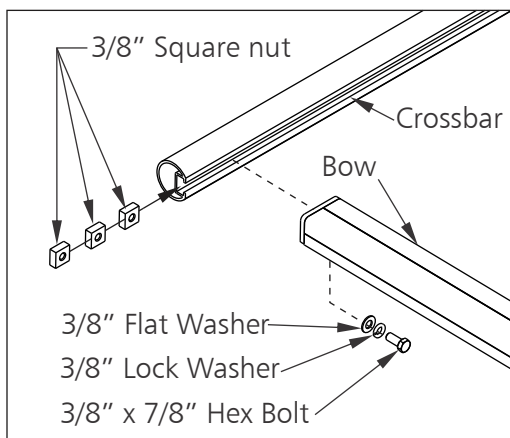

13. Position crossbars 1-1/2" from bow and tighten bolts.

THIS UNIT MUST BE ANCHORED ACCORDING TO THESE INSTRUCTIONS AT ALL TIMES

⚠ WARNING

THIS EQUIPMENT MUST BE STORED IN A SECURED, SHELTERED AREA WHEN NOT IN USE OR IN THE THREAT OF HIGH WINDS. ANY WEATHER DAMAGE TO THIS EQUIPMENT WILL NOT BE COVERED UNDER KWIK GOAL'S PRODUCT GUARANTEE. DO NOT LEAVE THIS EQUIPMENT UNATTENDED.

14. When the crossbars are fastened to the bows turn the shelter so the top crossbar is down as shown.

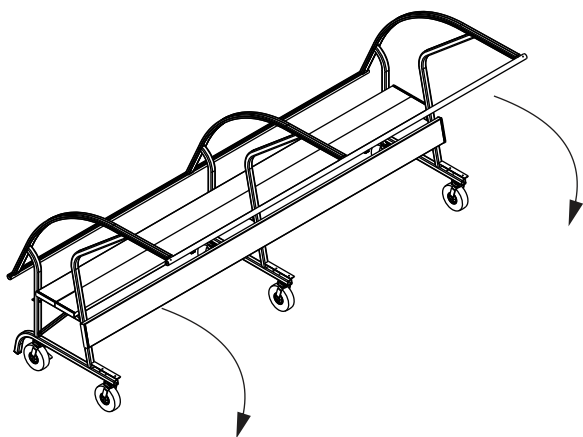

15. Lay out cover along top crossbar with hem edge up. Making sure cover is evenly spaced between left and right bows, attach cover to top crossbar with cover clips as shown.

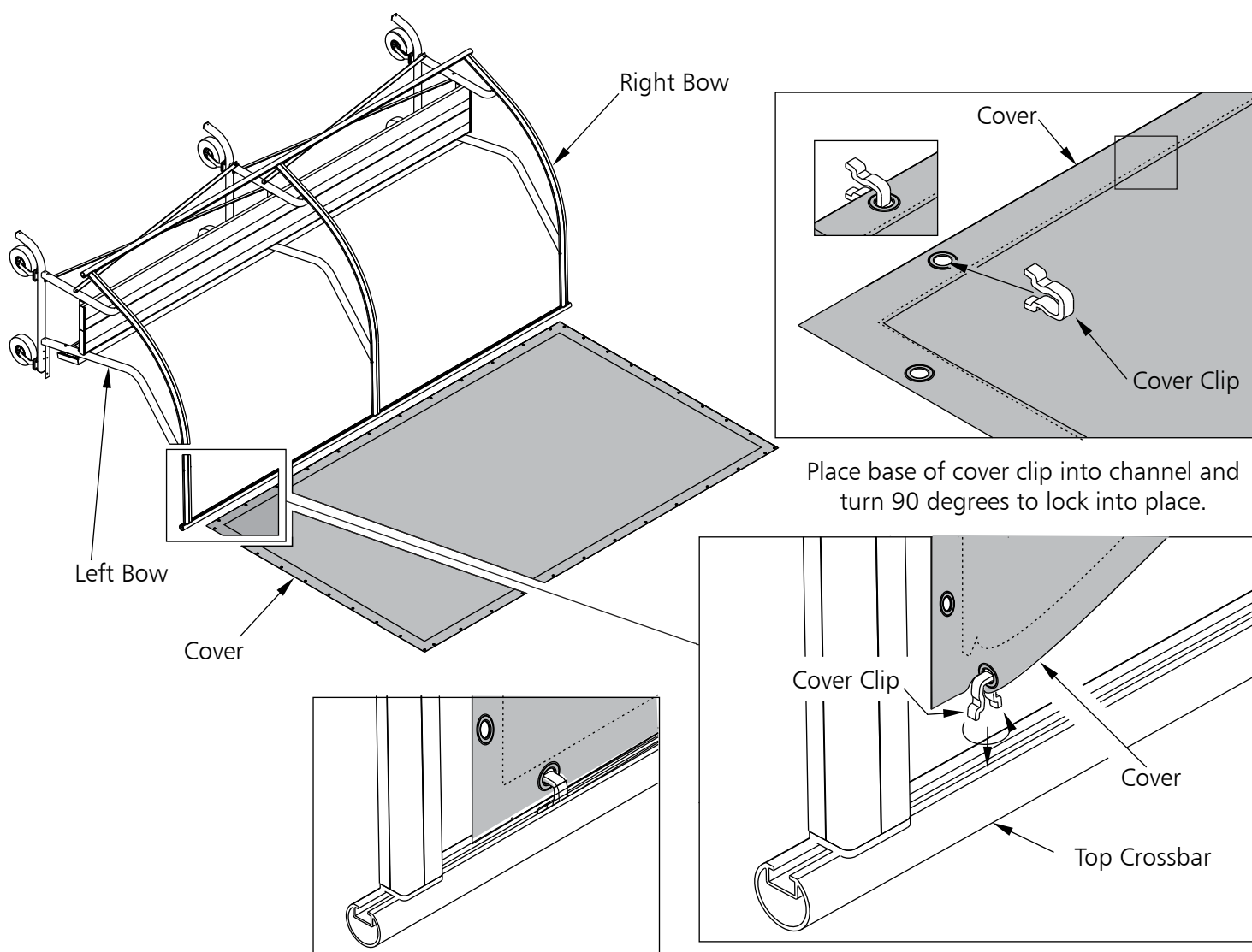

THIS UNIT MUST BE ANCHORED ACCORDING TO THESE INSTRUCTIONS AT ALL TIMES

⚠ WARNING THIS EQUIPMENT MUST BE STORED IN A SECURED, SHELTERED AREA WHEN NOT IN USE OR IN THE THREAT OF HIGH WINDS. ANY WEATHER DAMAGE TO THIS EQUIPMENT WILL NOT BE COVERED UNDER KWIK GOAL'S PRODUCT GUARANTEE. DO NOT LEAVE THIS EQUIPMENT UNATTENDED.

16. Attach cover to left bow at grommet with bungee as shown. Repeat steps 15 & 16 to attach right side of cover to shelter frame. **Note: For a clean look keep bungee ball on the inside of cover**

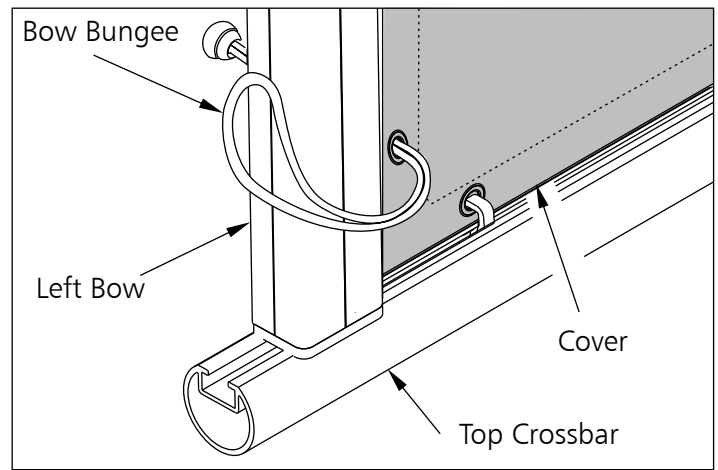

17. Pull cover over bows, starting at each corner, attach cover to bottom crossbar, left and right bows with bungees as shown. Complete cover attachment by installing a bungee in each grommet at bottom crossbar and left and right bows.

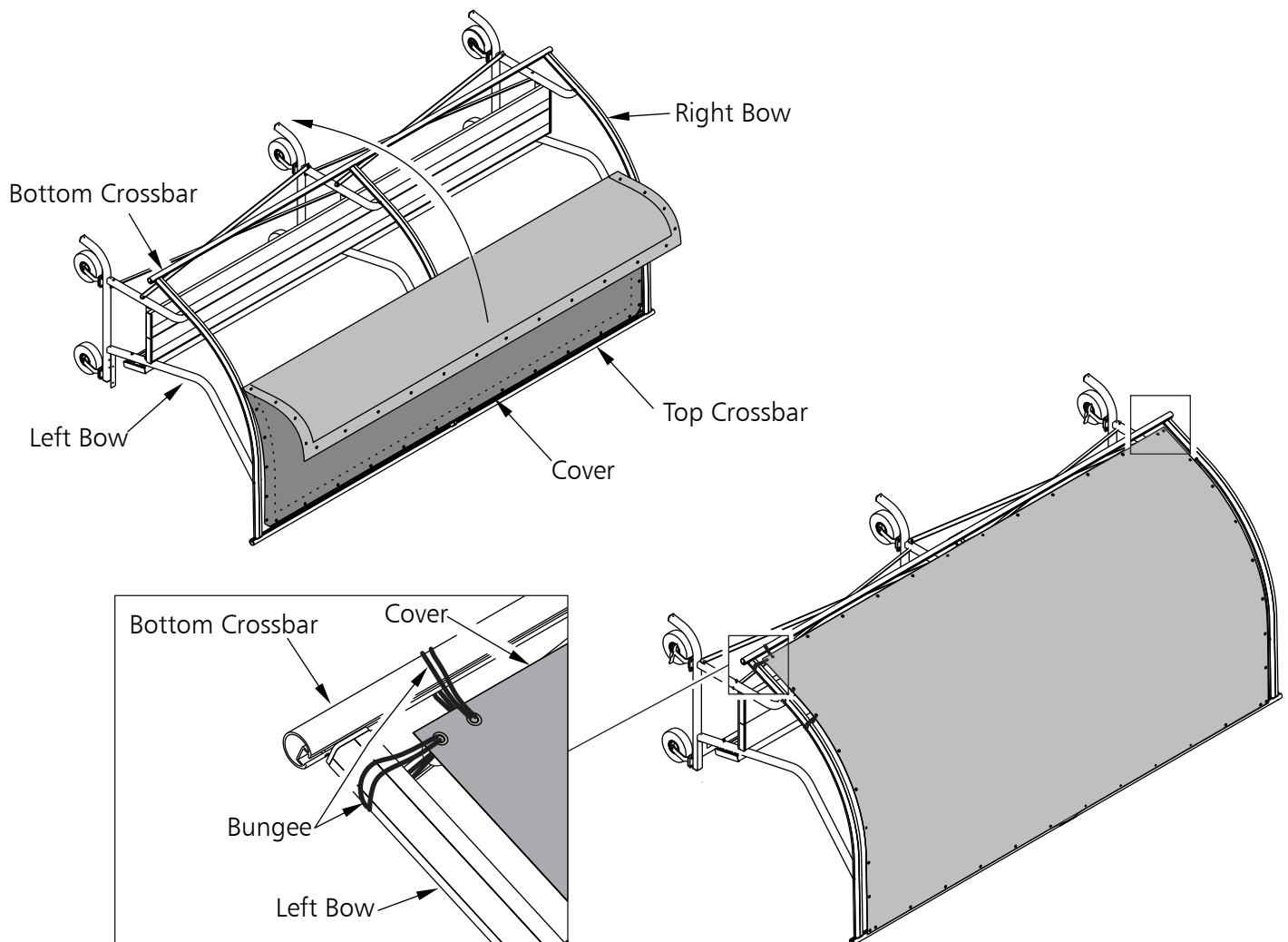

THIS UNIT MUST BE ANCHORED ACCORDING TO THESE INSTRUCTIONS AT ALL TIMES

⚠ WARNING

THIS EQUIPMENT MUST BE STORED IN A SECURED, SHELTERED AREA WHEN NOT IN USE OR IN THE THREAT OF HIGH WINDS. ANY WEATHER DAMAGE TO THIS EQUIPMENT WILL NOT BE COVERED UNDER KWIK GOAL'S PRODUCT GUARANTEE. DO NOT LEAVE THIS EQUIPMENT UNATTENDED.

18. Hardware for this step is in the **Top Hdw** pack.

After cover is completely attached, turn shelter up on wheels and engage brakes on swivel wheels w/brake. Place crossbar caps on each end of crossbars.

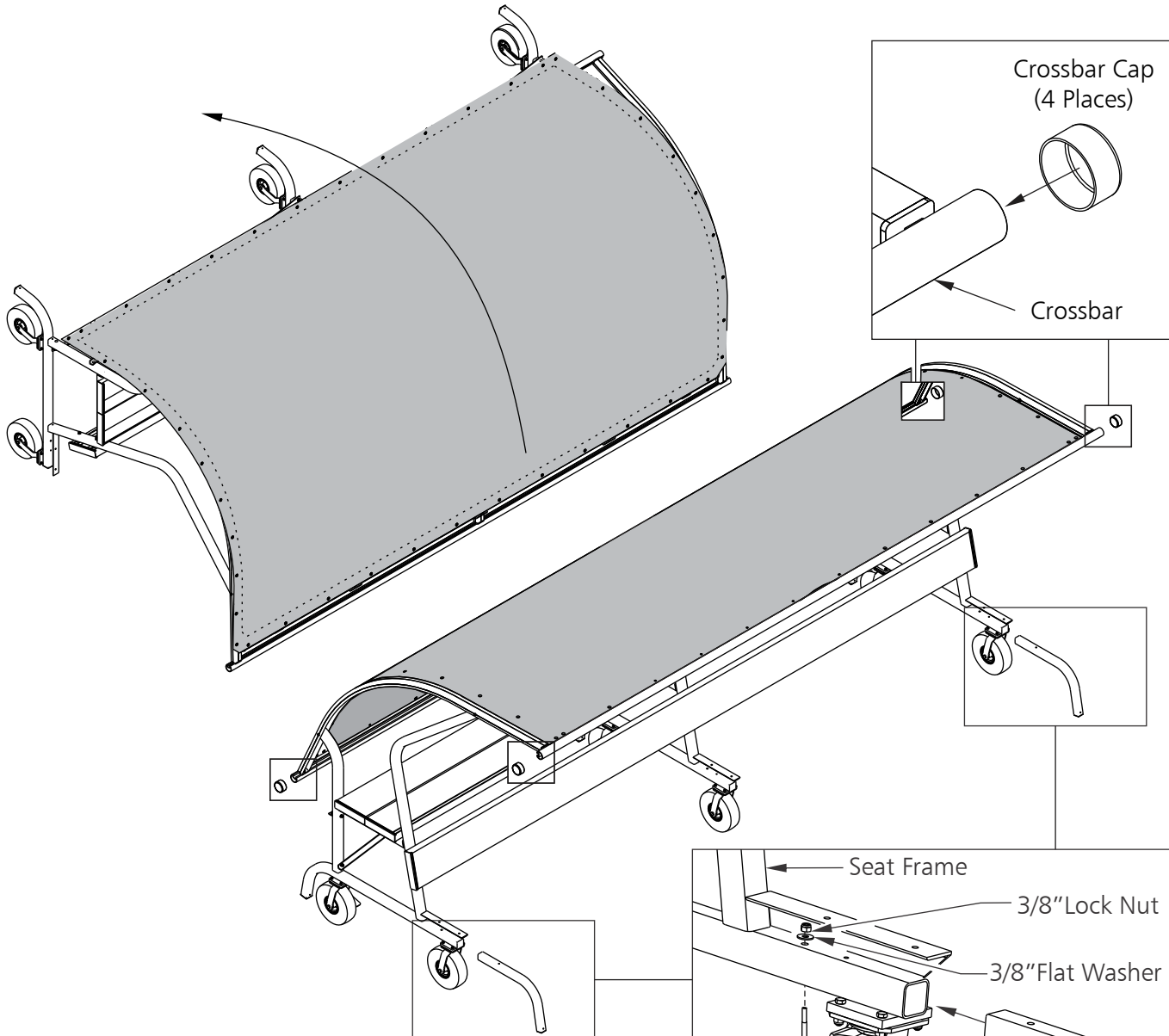

19. Hardware for step 19 and 20 is in the **Anchor Hdw** pack.

Attach stabilizer bars to both end seat frames as shown.

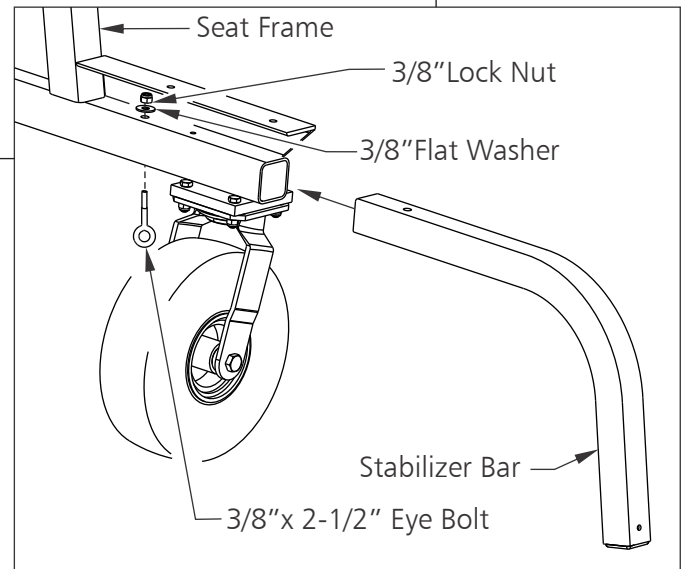

THIS UNIT MUST BE ANCHORED ACCORDING TO THESE INSTRUCTIONS AT ALL TIMES

⚠ WARNING

THIS EQUIPMENT MUST BE STORED IN A SECURED, SHELTERED AREA WHEN NOT IN USE OR IN THE THREAT OF HIGH WINDS. ANY WEATHER DAMAGE TO THIS EQUIPMENT WILL NOT BE COVERED UNDER KWIK GOAL'S PRODUCT GUARANTEE. DO NOT LEAVE THIS EQUIPMENT UNATTENDED.

20. Attach remaining eye bolts to assembled shelter frames at back of shelter.

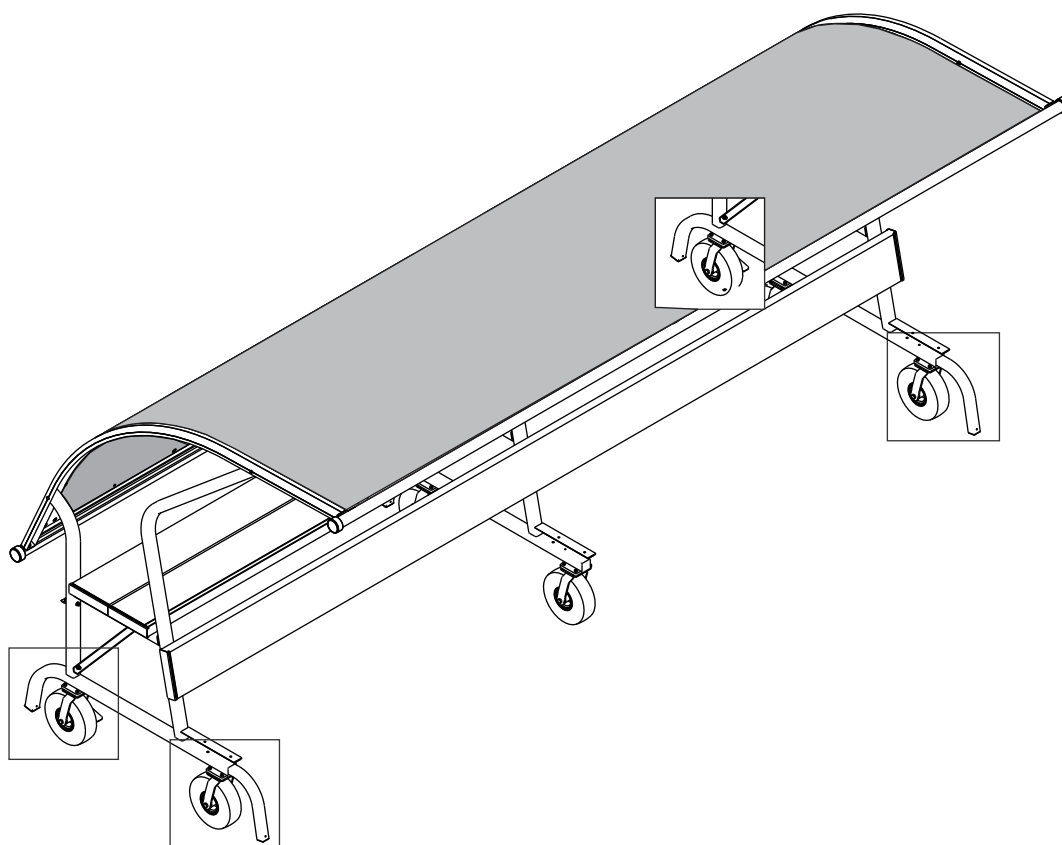
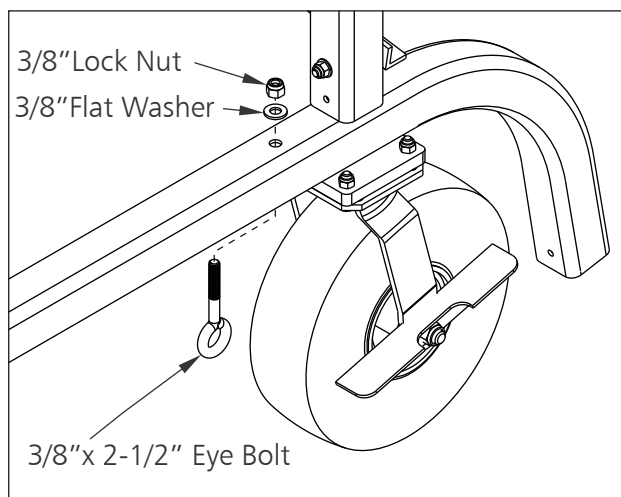

THIS UNIT MUST BE ANCHORED ACCORDING TO THESE INSTRUCTIONS AT ALL TIMES

⚠ WARNING THIS EQUIPMENT MUST BE STORED IN A SECURED, SHELTERED AREA WHEN NOT IN USE OR IN THE THREAT OF HIGH WINDS. ANY WEATHER DAMAGE TO THIS EQUIPMENT WILL NOT BE COVERED UNDER KWIK GOAL'S PRODUCT GUARANTEE. DO NOT LEAVE THIS EQUIPMENT UNATTENDED.

21. Hardware for this step is in the **Bench Hdw** pack.
Attach remaining plank to all three seat frames. (Refer to step 5)

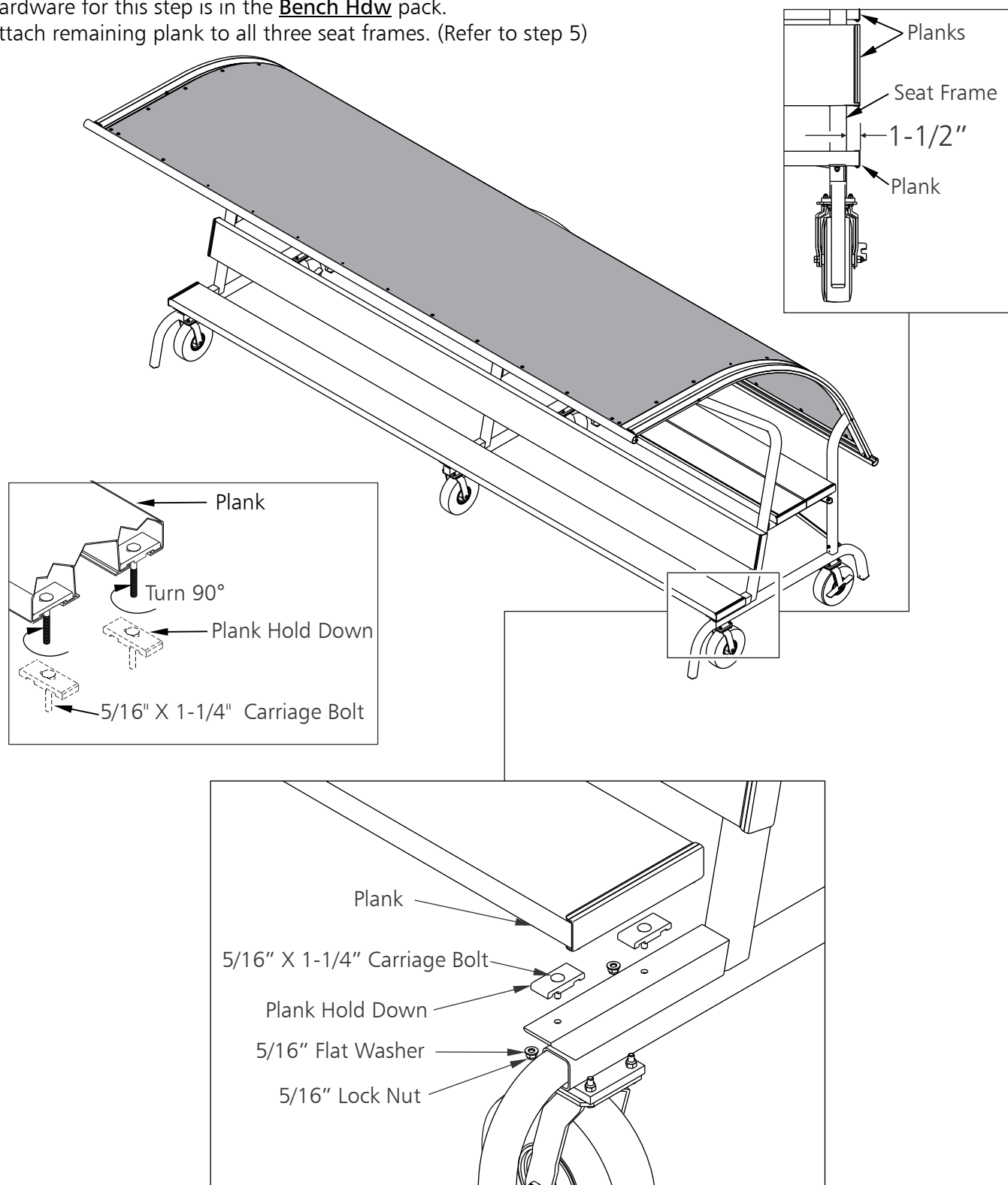

THIS UNIT MUST BE ANCHORED ACCORDING TO THESE INSTRUCTIONS AT ALL TIMES

⚠ WARNING

THIS EQUIPMENT MUST BE STORED IN A SECURED, SHELTERED AREA WHEN NOT IN USE OR IN THE THREAT OF HIGH WINDS. ANY WEATHER DAMAGE TO THIS EQUIPMENT WILL NOT BE COVERED UNDER KWIK GOAL'S PRODUCT GUARANTEE. DO NOT LEAVE THIS EQUIPMENT UNATTENDED.

22. Permanent ground anchors must be used at all times.

Dig four holes according to the layout below.

Note: Areas subject to heavy frost may require depths as deep as 36". Prepare holes and add drain stone as shown. Install anchor in each hole and fill hole with concrete. Allow concrete to cure before attaching shelter to anchors.

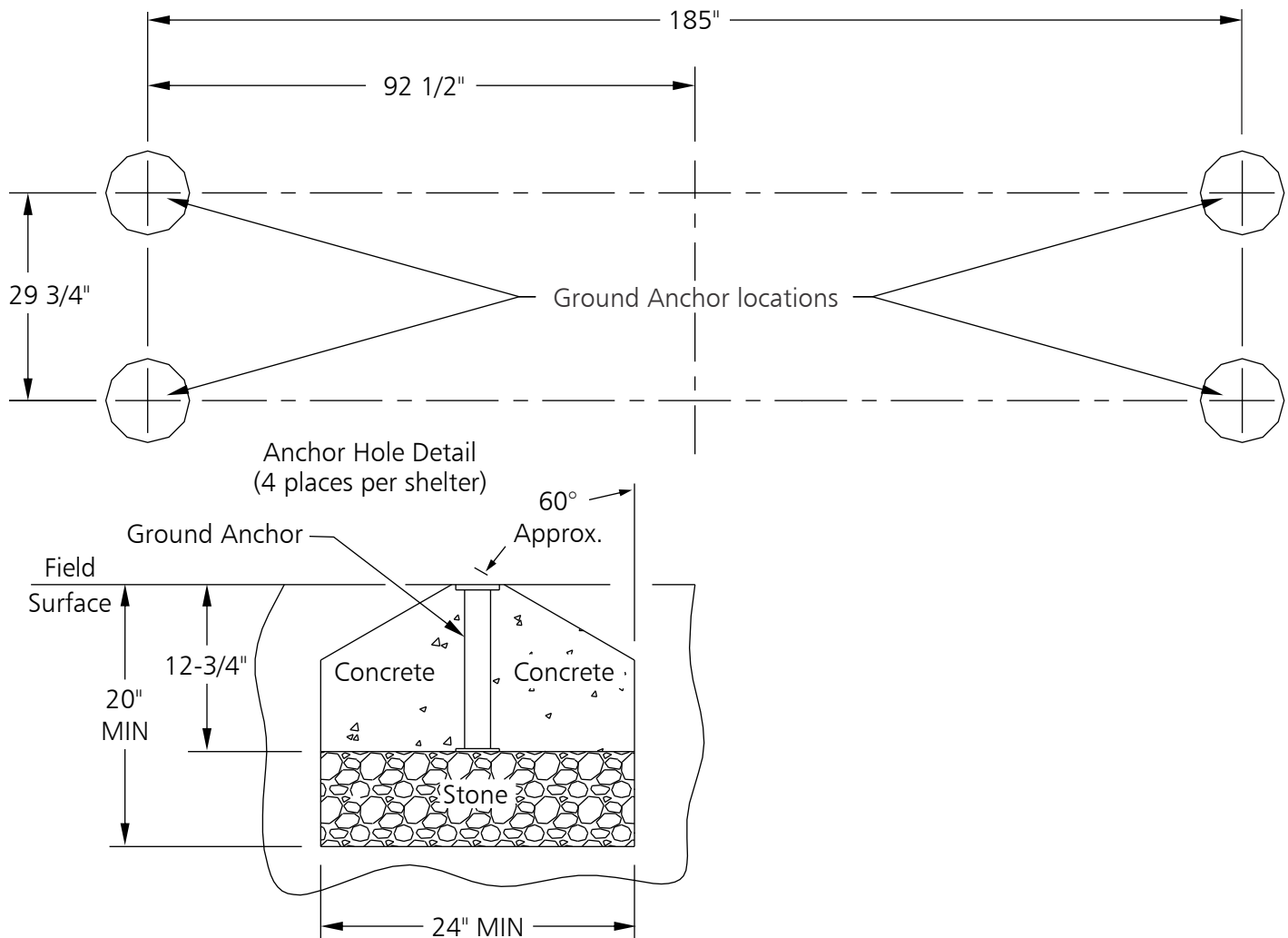

THIS UNIT MUST BE ANCHORED ACCORDING TO THESE INSTRUCTIONS AT ALL TIMES

⚠ WARNING

THIS EQUIPMENT MUST BE STORED IN A SECURED, SHELTERED AREA WHEN NOT IN USE OR IN THE THREAT OF HIGH WINDS. ANY WEATHER DAMAGE TO THIS EQUIPMENT WILL NOT BE COVERED UNDER KWIK GOAL'S PRODUCT GUARANTEE. DO NOT LEAVE THIS EQUIPMENT UNATTENDED.

23. Remove anchor plates from chains and attach chain to eye bolts at all 4 locations shown.

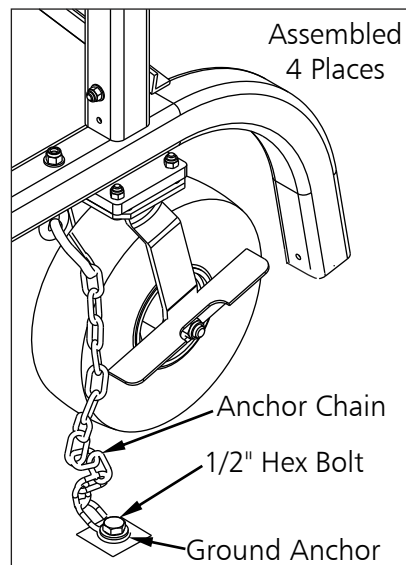
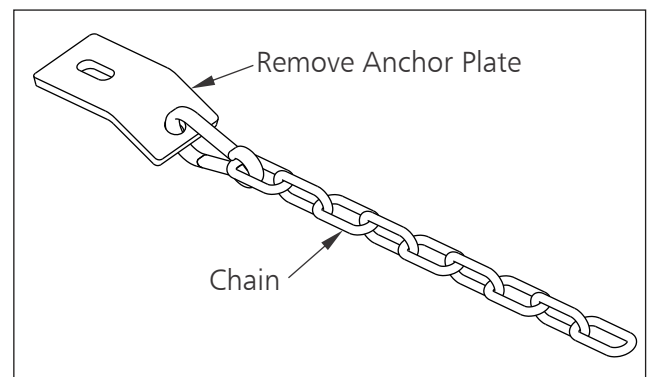
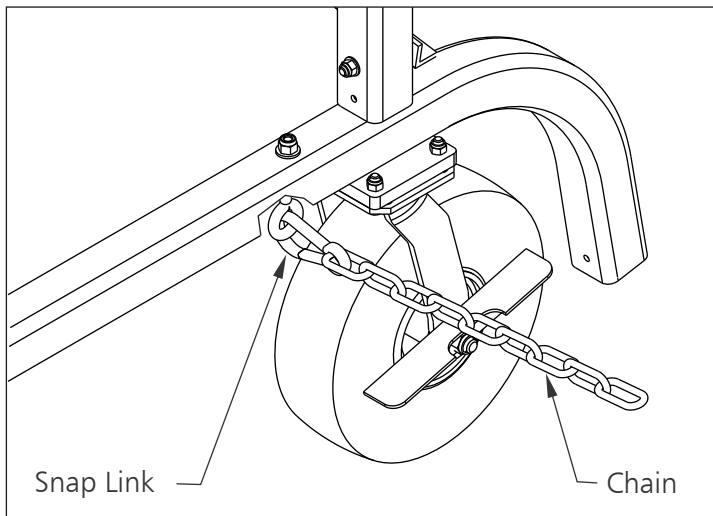
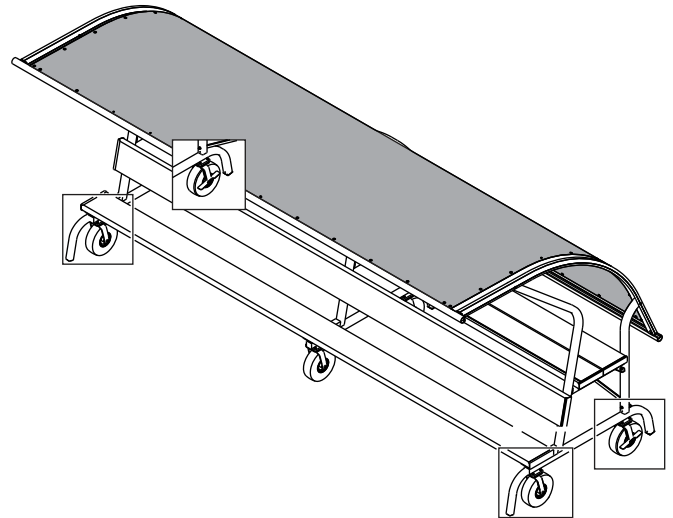

THIS UNIT MUST BE ANCHORED ACCORDING TO THESE INSTRUCTIONS AT ALL TIMES

⚠WARNING THIS EQUIPMENT MUST BE STORED IN A SECURED, SHELTERED AREA WHEN NOT IN USE OR IN THE THREAT OF HIGH WINDS. ANY WEATHER DAMAGE TO THIS EQUIPMENT WILL NOT BE COVERED UNDER KWIK GOAL'S PRODUCT GUARANTEE. DO NOT LEAVE THIS EQUIPMENT UNATTENDED.

24. The ground anchor and chain leash system supplied is the recommended and the safest method of anchoring your shelter. However, anchor bags may be used as a temporary anchoring system. To ensure the anchor bags remain on the base of your shelter, you must attach them as shown in figure below.

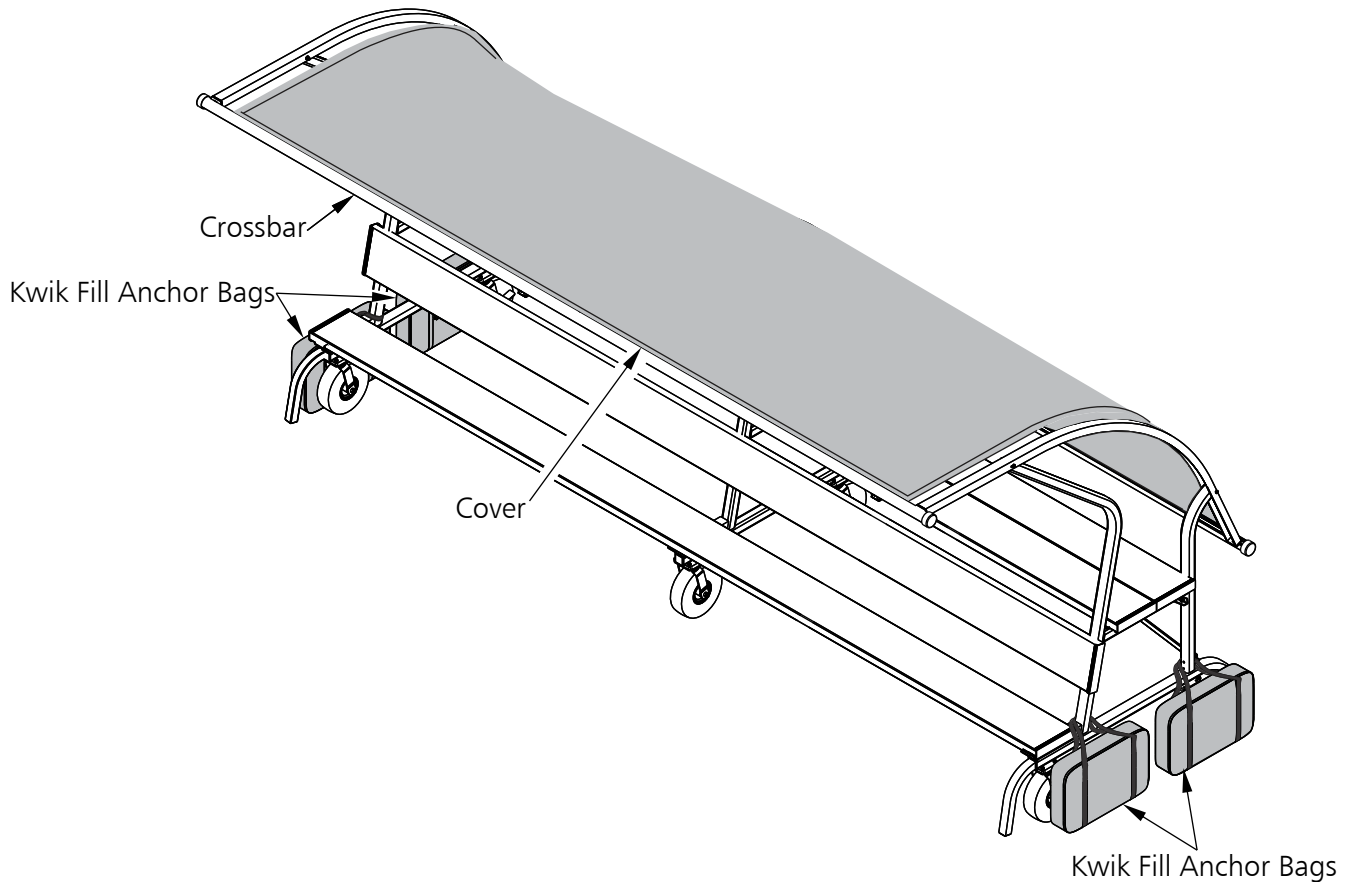

25. Disengage brakes on swivel wheels w/ brakes and move to desired location. To hold shelter in place, fill all four Kwik fill anchor bags according to instructions. Attach Kwik fill anchor bags to shelter at locations shown. Also engage brakes on swivel wheels w/brakes.

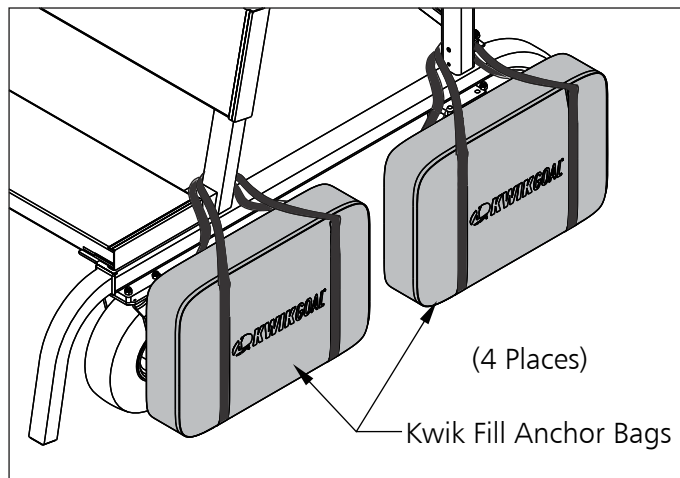

THIS UNIT MUST BE ANCHORED ACCORDING TO THESE INSTRUCTIONS AT ALL TIMES

⚠ WARNING THIS EQUIPMENT MUST BE STORED IN A SECURED, SHELTERED AREA WHEN NOT IN USE OR IN THE THREAT OF HIGH WINDS. ANY WEATHER DAMAGE TO THIS EQUIPMENT WILL NOT BE COVERED UNDER KWIK GOAL'S PRODUCT GUARANTEE. DO NOT LEAVE THIS EQUIPMENT UNATTENDED.

26. When not in use the shade cover must be removed or rolled up from the rear crossbar and secured to the top crossbar. Note: Bungees can be used to secure the cover to the top crossbar.

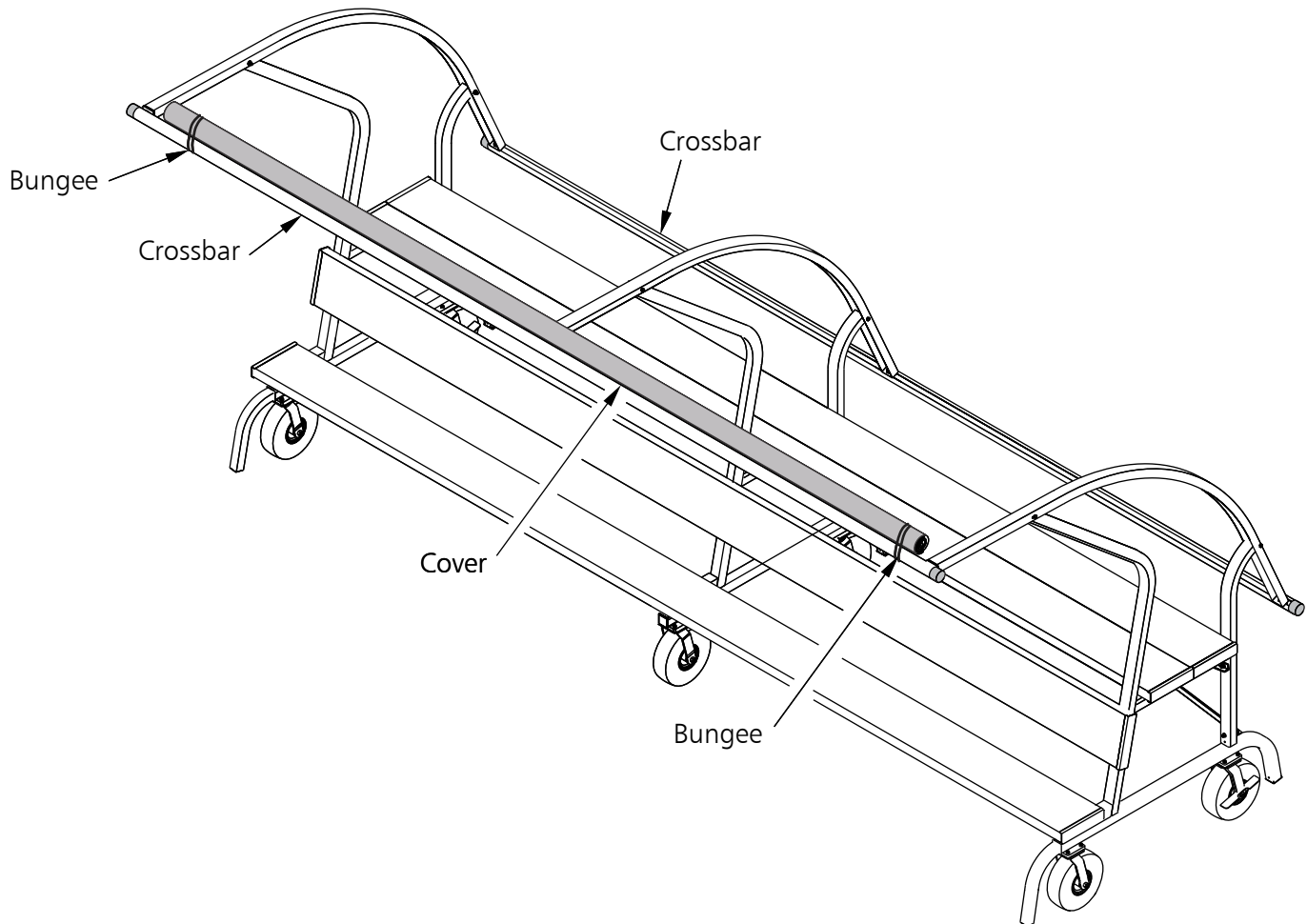

Go to kwikgoal.com for additional product information.

THIS UNIT MUST BE ANCHORED ACCORDING TO THESE INSTRUCTIONS AT ALL TIMES

⚠ WARNING THIS EQUIPMENT MUST BE STORED IN A SECURED, SHELTERED AREA WHEN NOT IN USE OR IN THE THREAT OF HIGH WINDS. ANY WEATHER DAMAGE TO THIS EQUIPMENT WILL NOT BE COVERED UNDER KWIK GOAL'S PRODUCT GUARANTEE. DO NOT LEAVE THIS EQUIPMENT UNATTENDED.