

740140 - STEEPLE CHASE BARRIER SET INSTRUCTIONS

The 740140 Steeple Chase Barrier Set consists of four height adjustable barriers, one 5 meter wide beam and three 4 meter wide beams.

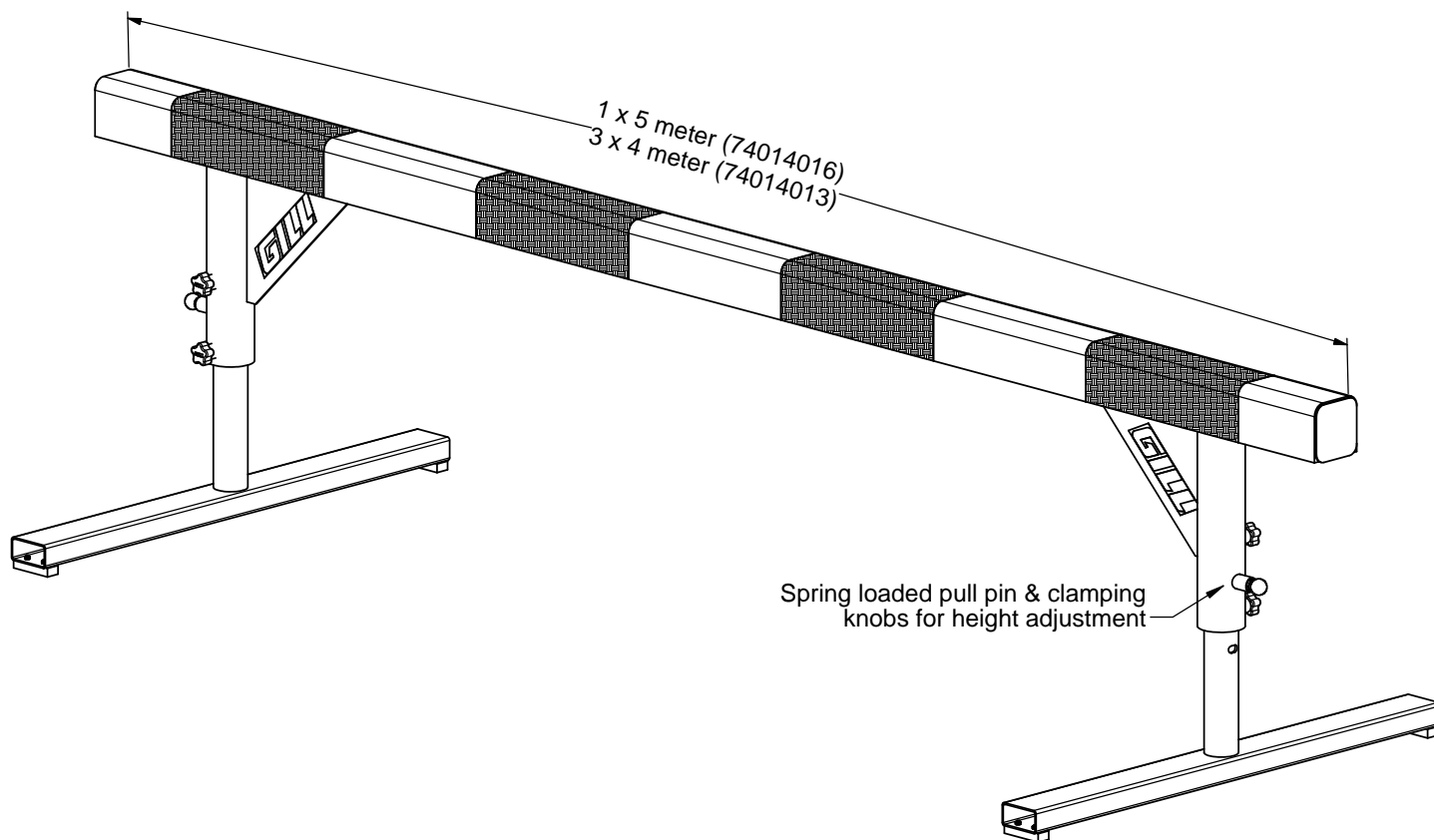

Each barrier adjusts to three heights; 30, 33, and 36 inches. The beam is locked in position with a stainless steel spring loaded pull pin and clamping knobs.

The beams are constructed of 4 inch square 11 gauge steel tube, covered on three sides with 1/2 inch thick Vultrak track surface.

The leg assemblies are fabricated from 2-1/2" and 3-1/2" Sch 40 steel pipe with spring assist. The legs are painted with powder coat for a durable finish.

NCAA compliant and IAAF certified.



www.gillathletics.com
800-637-3090

740140 - STEEPLE CHASE BARRIER SET INSTRUCTIONS

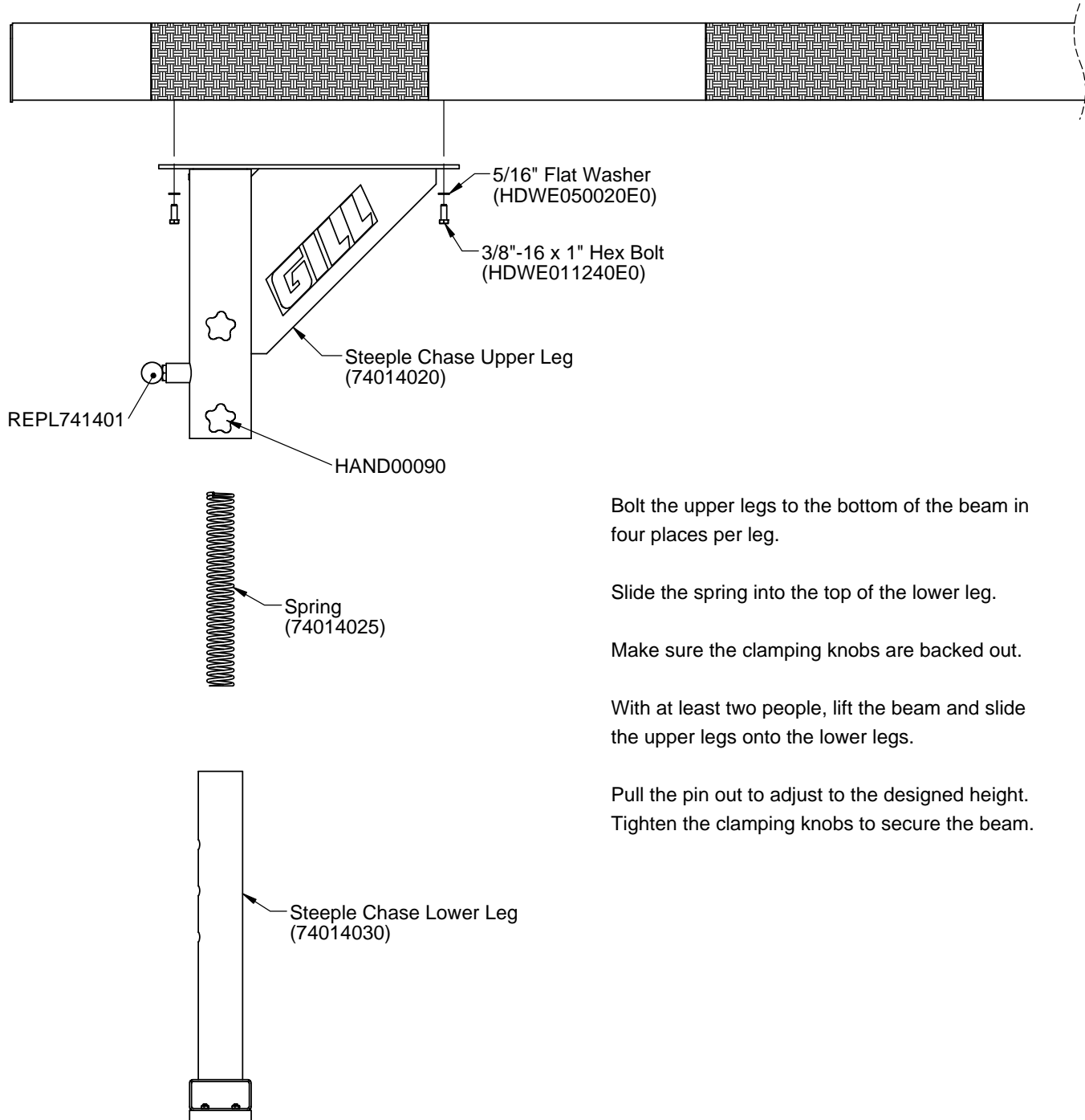

Bolt the upper legs to the bottom of the beam in four places per leg.

Slide the spring into the top of the lower leg.

Make sure the clamping knobs are backed out.

With at least two people, lift the beam and slide the upper legs onto the lower legs.

Pull the pin out to adjust to the designed height.
Tighten the clamping knobs to secure the beam.

THIS WARNING IS GIVEN IN COMPLIANCE
WITH CALIFORNIA'S PROPOSITION 65:

WARNING

This product contains chemicals known to the
State of California to cause cancer, birth defects
or other reproductive harm.

740140 - STEEPLE CHASE BARRIER SET INSTRUCTIONS

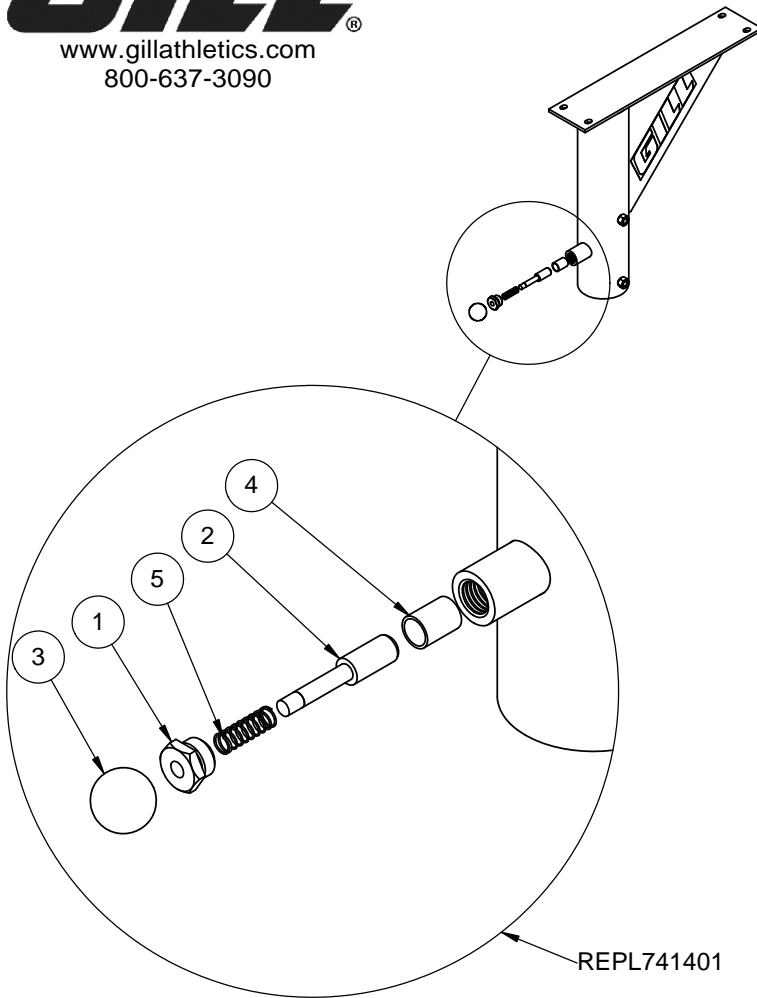

ITEM NO.	PART NUMBER	Description
1	7401402003	Pull Pin Collar Cap
2	7401402004	Pull Pin Stud
3	HAND00088	Ball Knob
4	BUSH00088	Shaft Bushing
5	SPNG00041	Spring

1. Press the bushing (BUSH00088) into the pull pin collar so that it is flush with the inside wall of the pipe.
2. Slide the spring (SPNG00041) onto the shaft of the pull pin stud (7401402004). Then slide the pull pin collar cap (7401402003) onto the pull pin stud. Next screw the knob (HAND00088) onto the pull pin stud and Loc-Tite the threads.
3. Screw the pull pin collar cap into the pin collar. Make sure to Loc-Tite the threads.

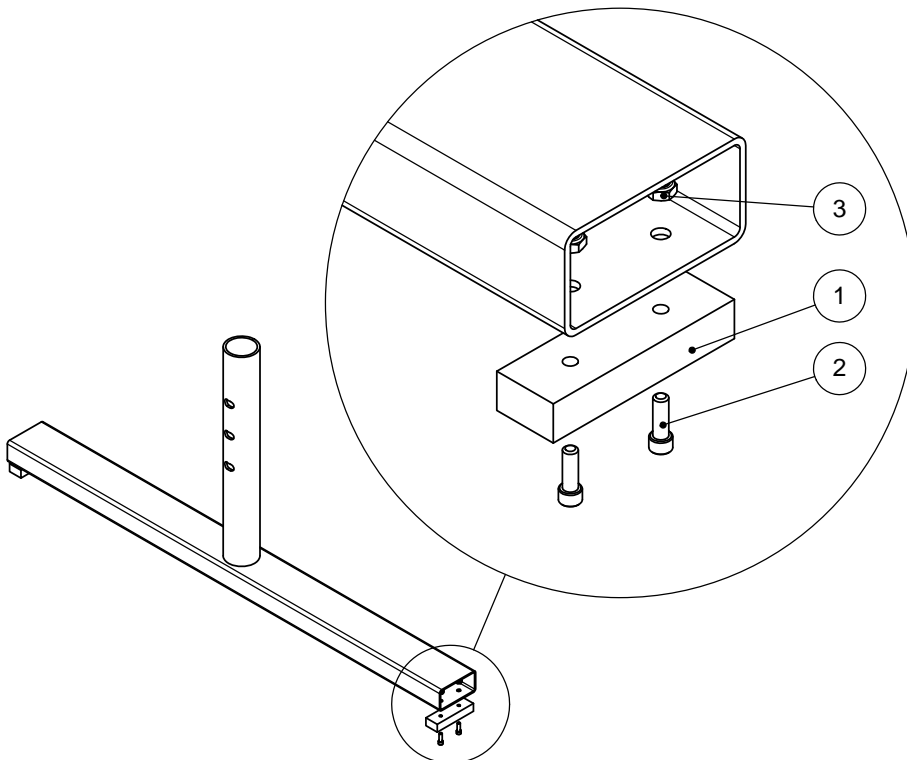

ITEM NO.	PART NUMBER	Description
1	FEET00002000	Rubber Foot
2	HDWE06016000	Cap Screw
3	M1274	Hex Nut