



Folding Chair Rolling Rack

Model #CHC100 Assembly Instructions





Included Parts

<u>DESCRIPTION</u>	<u>QTY.</u>	<u>PART ID</u>
Bottom Tube -	2x -	A
Caster -	4x -	B
M8 x 55 Bolt -	16x -	C
8mm Washer -	32x -	D
M8 Nut -	16x -	E
M10 x 85 HHCS Bolt -	16x -	F
10mm Washer -	52x -	G
M10 Nut -	26x -	H
Bottom Cross Beam -	1x -	I
Bracket -	2x -	J
Upright Tube -	2x -	K
M10 x 60 HHCS Bolt -	10x -	L
Cross Beam -	2x -	M
Extension Tube -	24x -	N

Tools Needed

16mm Wrench and Socket
13mm Wrench and Socket

Step 1

Assemble Feet to Bottom of Cross Beams

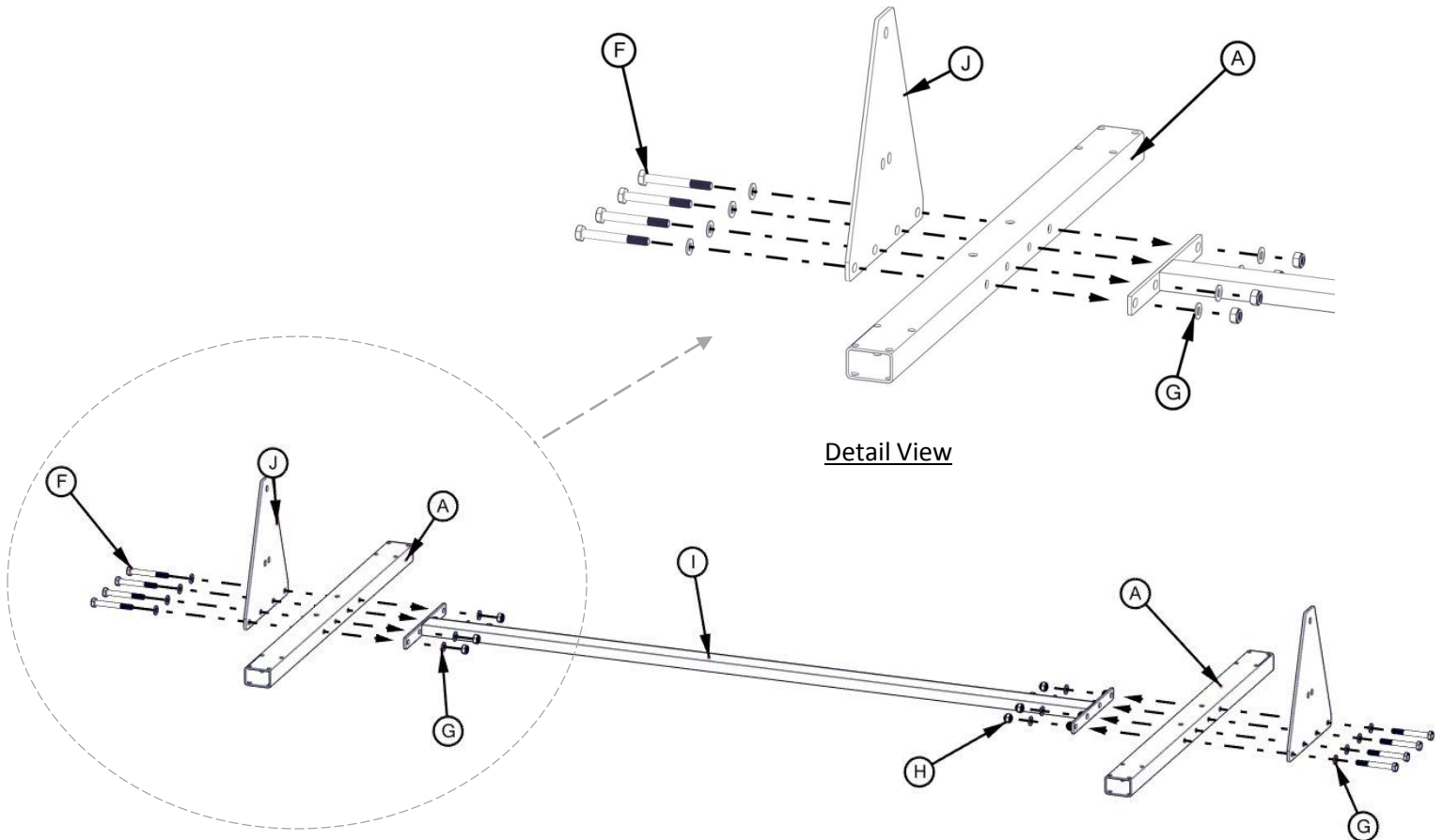

- A) (1x) Bottom Tube
- F) (8x) M10 x 85 HHCS Bolt
- G) (16x) 10mm Washer
- H) (8x) M10 Nut
- I) (1x) Bottom Cross Beam
- J) (2x) Bracket

Step 2

Attach Upright Tubes

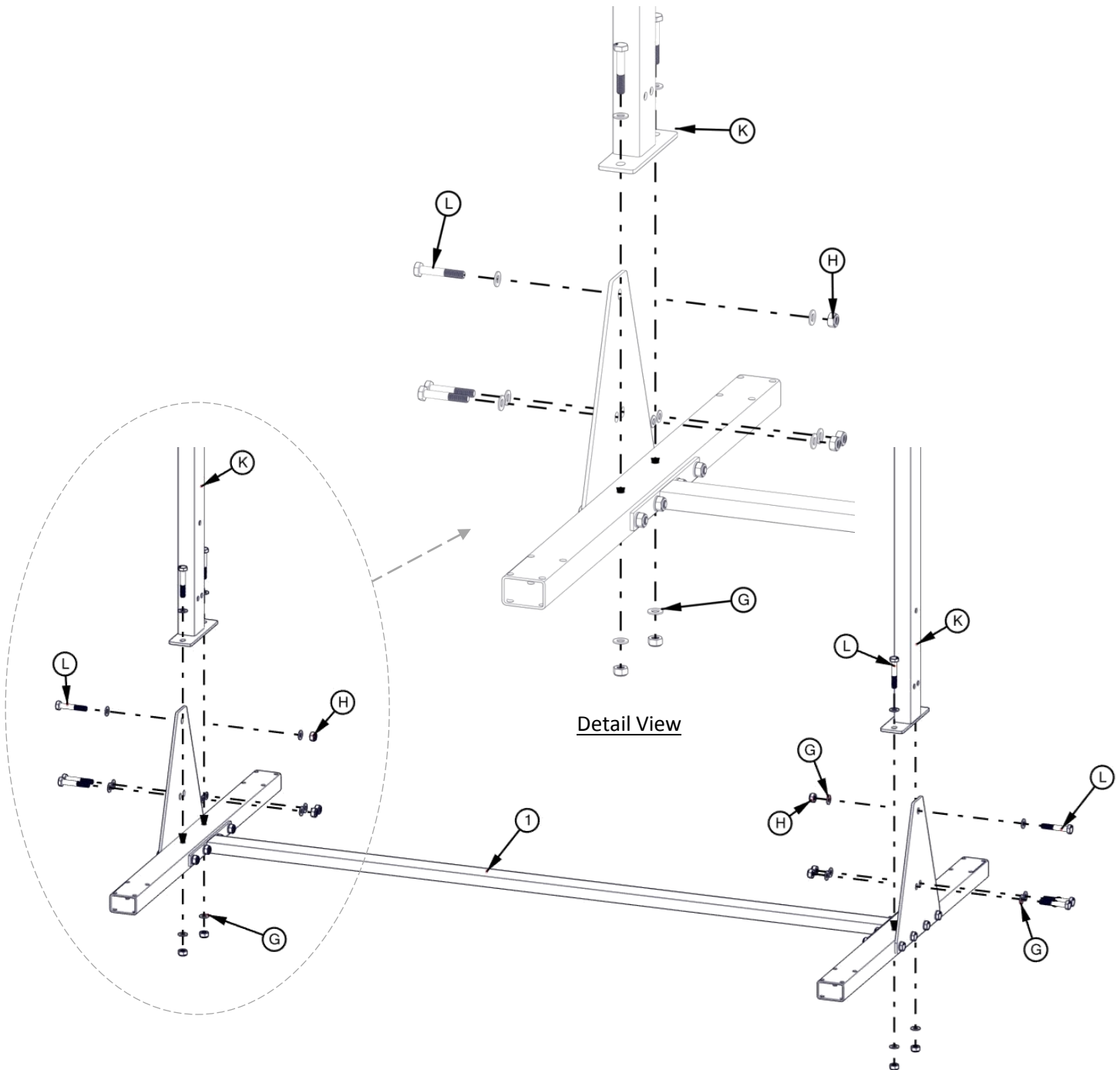

- 1) (1x) Step #1 Assembly
- G) (20x) 10mm Washer
- H) (10x) M10 Nut

- K) (2x) Upright Tube
- L) (10x) M10 x 60 HHCS Bolt



Step 3

Add Cross Beams, Repeat for 2nd Beam

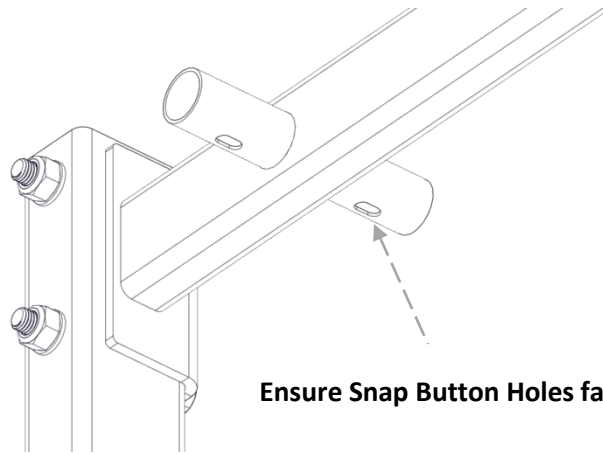

Ensure Snap Button Holes face down.

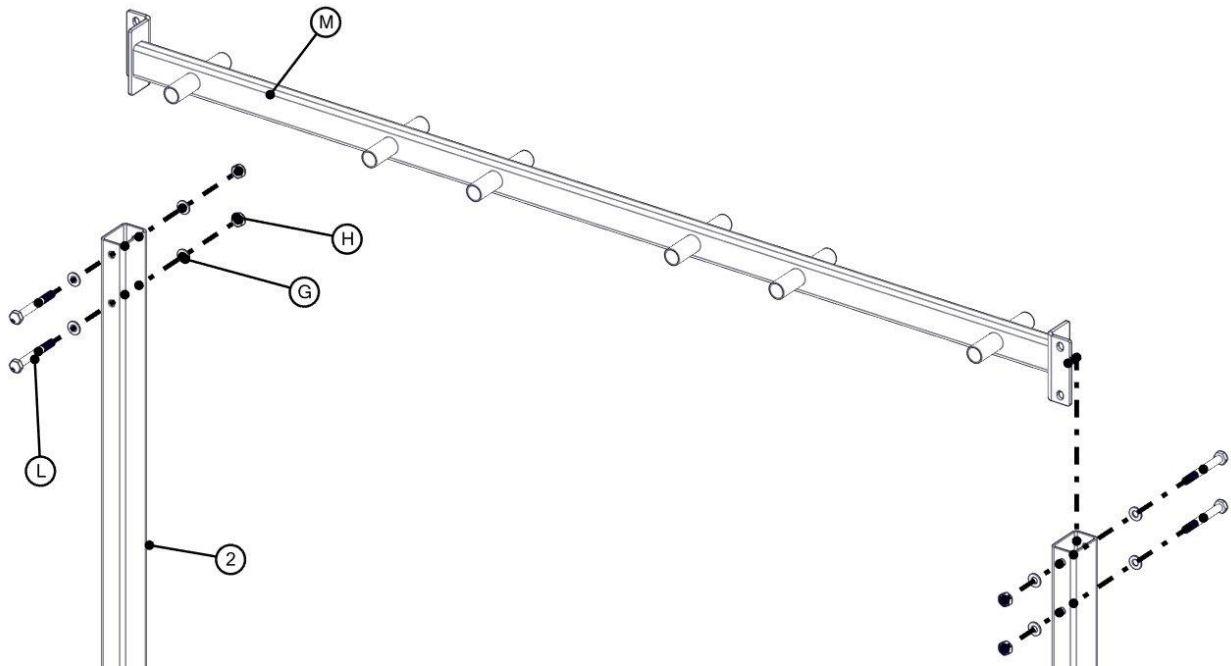

- 2) (1x) Step #2 Assembly
- G) (8x) 10mm Washer
- H) (4x) M10 Nut

- L) (4x) M10 x 85 HHCS Bolt
- M) (1x) Cross Beam

Step 4

Repeat Step to Construct 2nd Foot

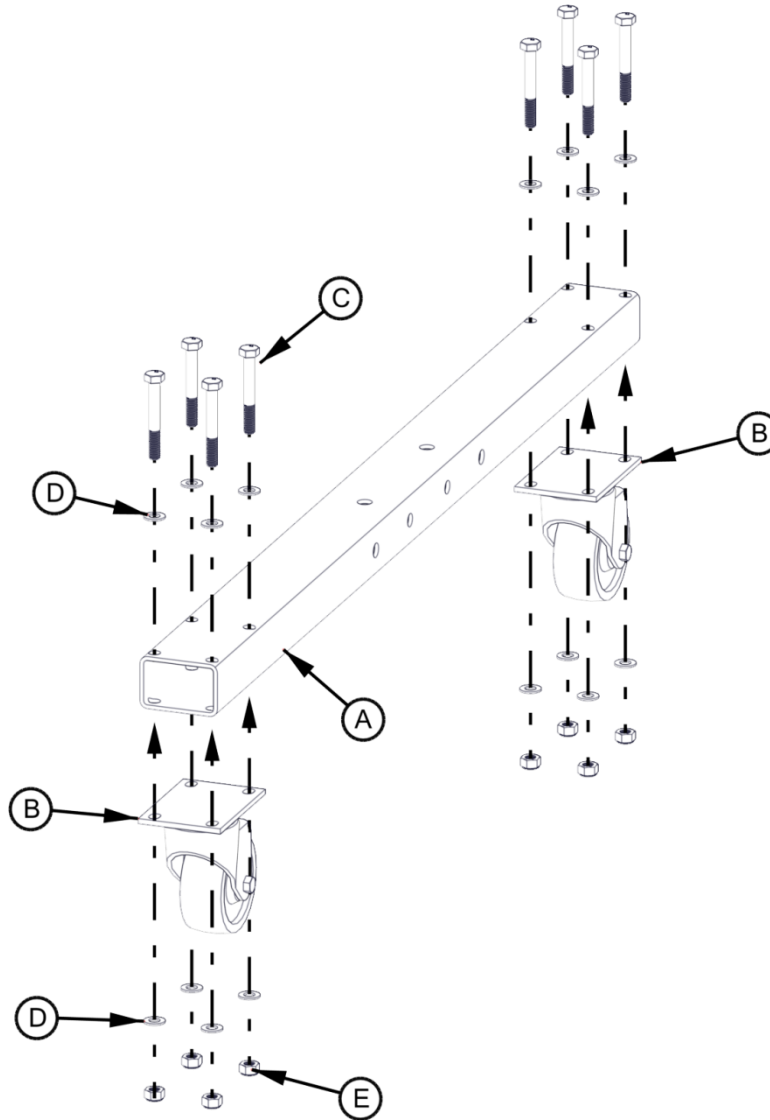

- A) (1x) Bottom Tube
- B) (2x) Caster
- C) (8x) M8 x 55 HHCS Bolt

- D) (16x) 8mm Washer
- E) (8x) M8 Nut



Step 5

Add Rack Bars; Repeat 12 places

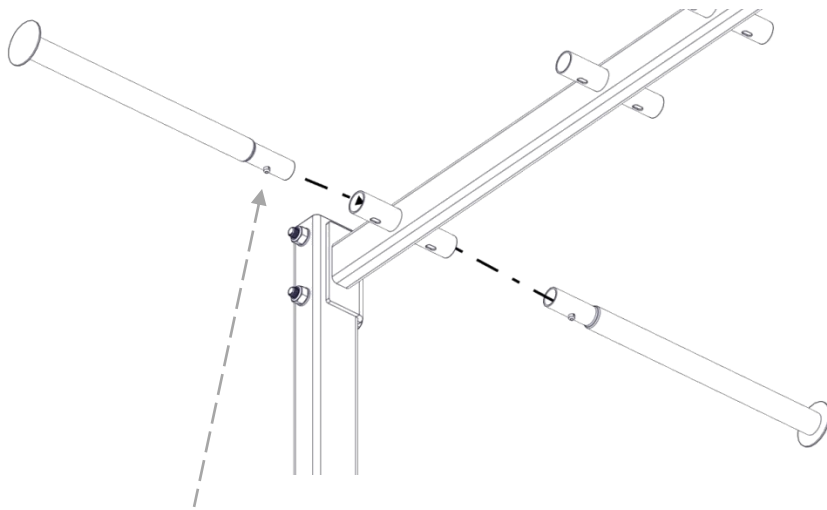

Ensure Snap Buttons face down.

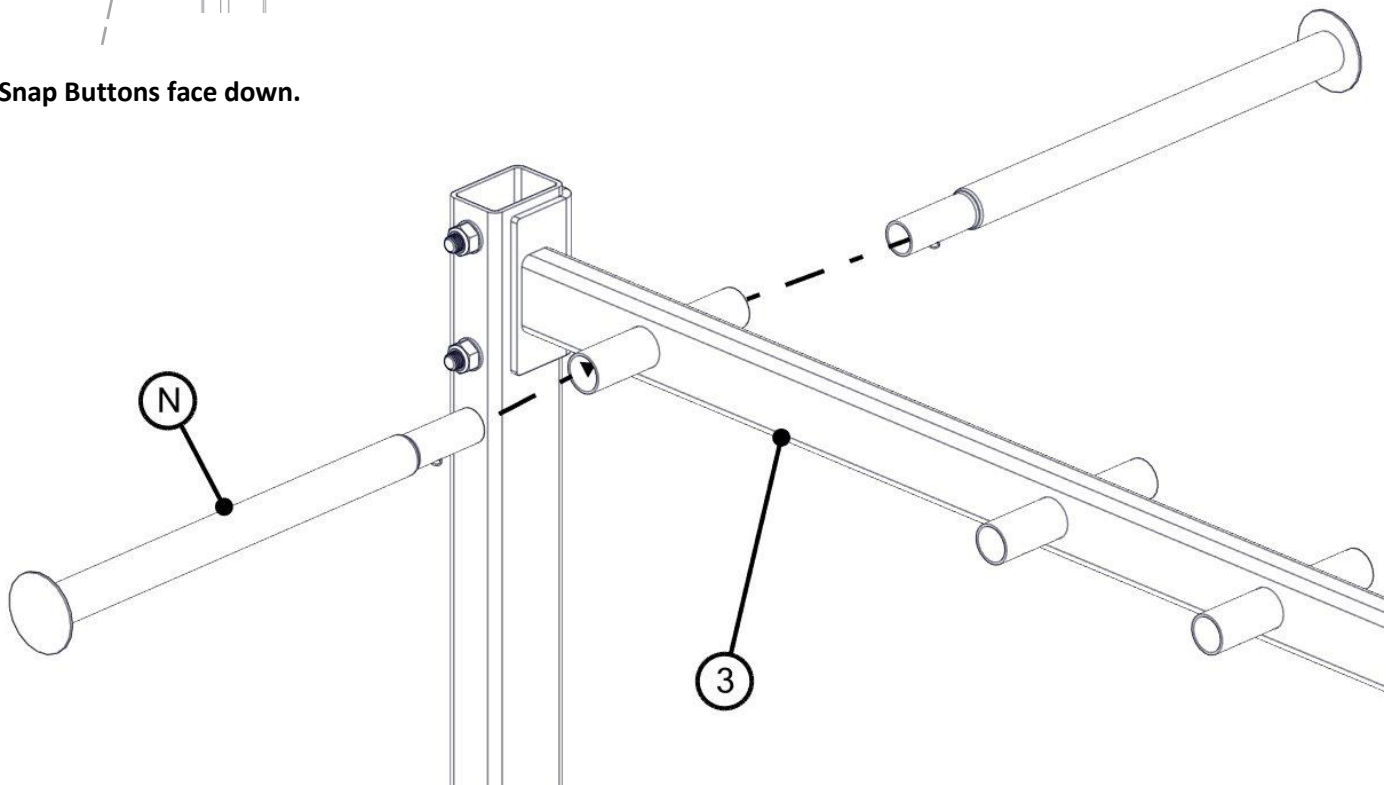

3) (1x) Step #3 Assembly

N) (2x) Extension Tube



Step 6

Check Assembly

