



## ASSEMBLY INSTRUCTIONS FOR 9B53 PORTABLE ONLY SHELTER FRAME

**\*THIS UNIT MUST BE ASSEMBLED BY A MINIMUM OF TWO QUALIFIED PERSONS\***

**NOTICE** Sunlight reflecting off polycarbonate panels can contribute to increased temperatures of surrounding objects. In certain situations, these increased temperatures can damage some artificial turf surfaces. Kwik Goal is not responsible for any damage to artificial turf.

1. Unpack all parts and check for damage that may have occurred during shipping. If damage has occurred, notify Kwik Goal immediately. Lay out all parts. Remove all cardboard and packaging immediately. Wet or damp packaging may damage contents.
2. Read through entire instruction before beginning assembly and installation.

**NOTE:** Components may be packaged in one or more additional boxes.

### Parts

Crossbar  
(Part# SEE TABLE)

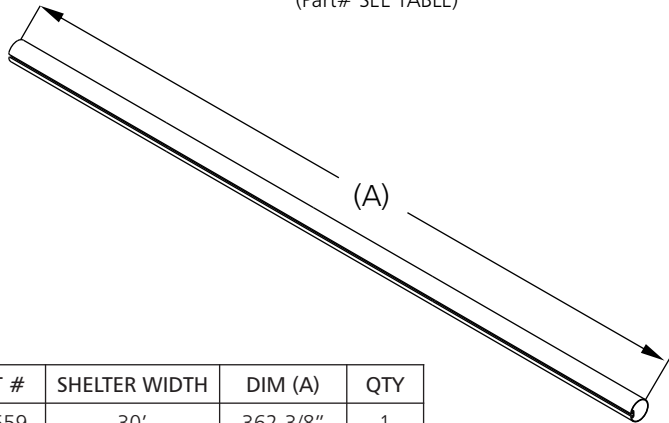

PART #	SHELTER WIDTH	DIM (A)	QTY
UZ1559	30'	362-3/8"	1
UZ1116	24'	287-3/4"	1
UZ1433	21'	250-7/16"	1
UZ1434	18'	213-1/8"	2
UZ1435	15'	175-13/16"	2
UZ1436	12'	138-1/2"	2
UZ1114	9'	101-3/16"	2

Bottom Crossbar  
(Part# SEE TABLE)

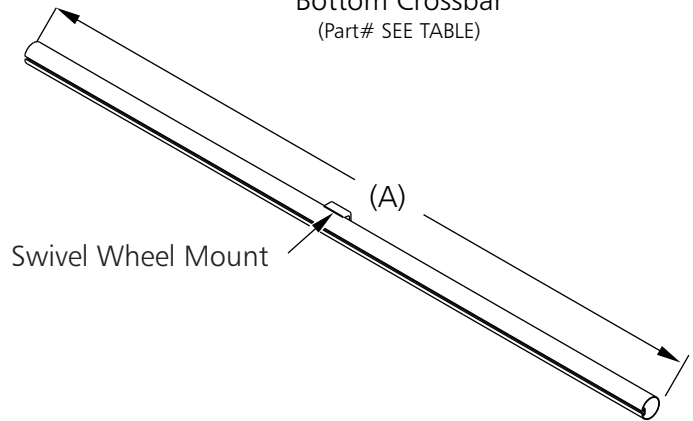

PART #	SHELTER WIDTH	DIM (A)	QTY
UZ1577	30'	362-3/8"	1
UZ1444	24'	287-3/4"	1
UZ1443	21'	250-7/16"	1

**THIS UNIT MUST BE ANCHORED ACCORDING TO THESE INSTRUCTIONS AT ALL TIMES**

### **⚠WARNING**

THIS EQUIPMENT MUST BE STORED IN A SECURED, SHELTERED AREA WHEN NOT IN USE OR IN THE THREAT OF HIGH WINDS. ANY WEATHER DAMAGE TO THIS EQUIPMENT WILL NOT BE COVERED UNDER KWIK GOAL'S PRODUCT GUARANTEE. DO NOT LEAVE THIS EQUIPMENT UNATTENDED.



## **⚠ WARNING**

## **IMPORTANT SAFETY INSTRUCTIONS**

### **READ CAREFULLY**

1. Lifting and moving heavy field equipment can be dangerous if not done properly. All Kwik Goal shelters must be moved by qualified personnel who are experienced in moving large, heavy field equipment.
2. A minimum of four qualified, experienced people are required to move shelter.
3. Do not attempt to lift or move shelter in windy conditions.
4. Shelters must not be left unattended and unsecured.
5. Shelter must be on level, flat ground at all times.
6. Use extreme caution when pushing shelter. Excessive force can overturn shelter. Always push at lowest point on shelter frame possible.
7. Do not push shelter directly from the front to rear or rear to front. Push from end to end.

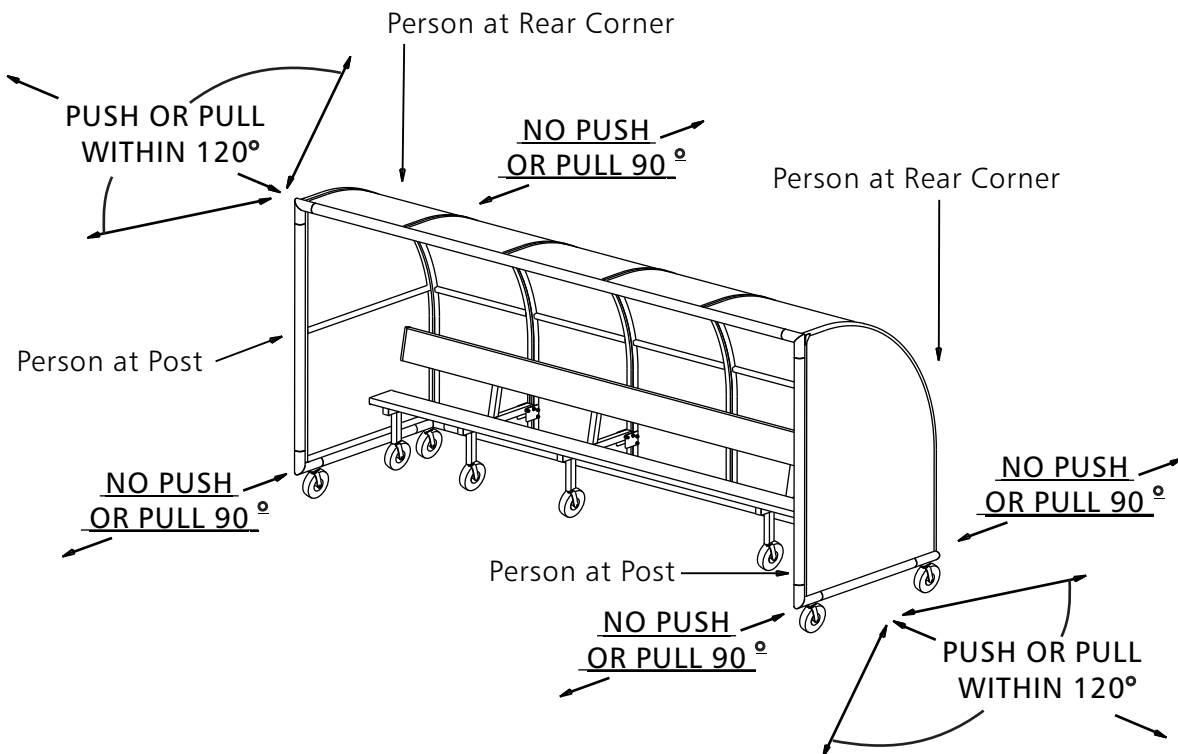

**NEVER LEAVE SHELTERS UNATTENDED AND UNSECURED**

## Parts Continued

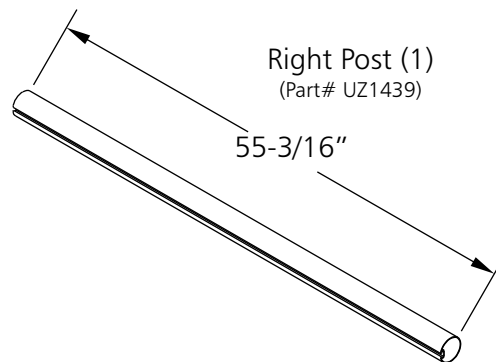
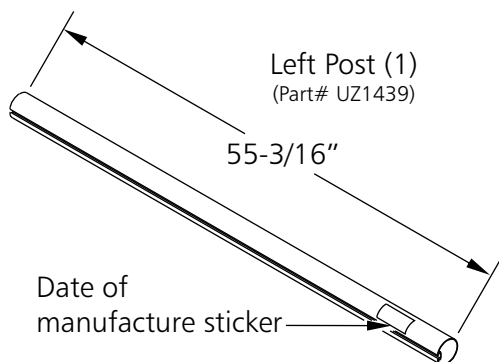

Crossbar Corner (2)  
(Part# UZ1211)

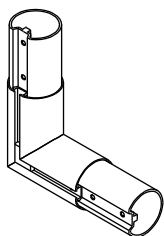

Post Corner (2)  
(Part# UZ1442)

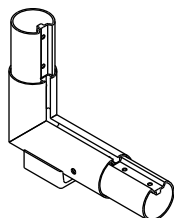

Left Base (1)  
(Part# UZ1441)

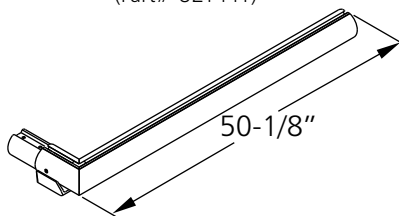

Right Base (1)  
(Part# UZ1440)

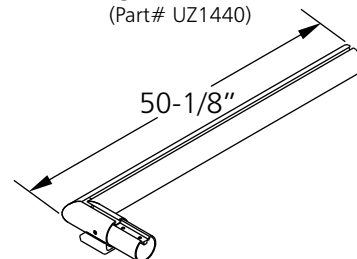

Center Panel (SEE TABLE)  
(Part# UZ1445)

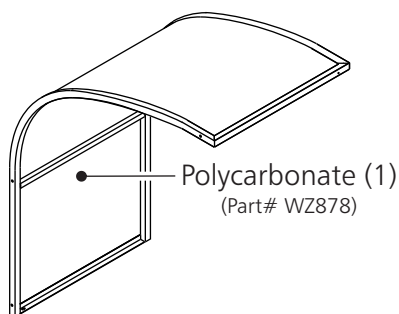

SHELTER WIDTH	QTY
30'	10
24'	8
21'	7
18'	6
15'	5
12'	4
9'	3

Left Panel (1)  
(Part# UZ1447)

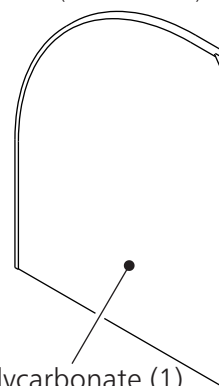

Right Panel (1)  
(Part# UZ1446)

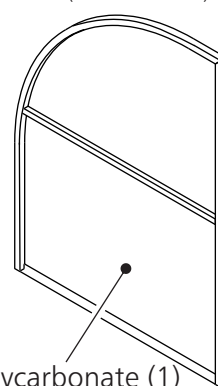

Swivel Wheel (SEE TABLE)  
(Part# VZ629)

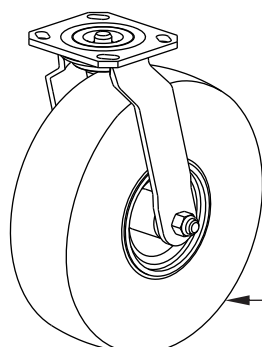

SHELTER WIDTH	QTY
30'	3
24'	3
21'	3
18'	2
15'	2
12'	2
9'	2

Swivel Wheel w/ Brake (2)  
(Part# VZ747)

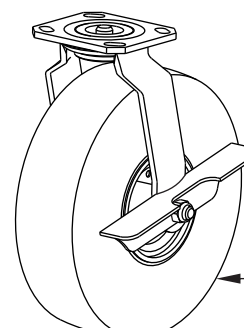

**THIS UNIT MUST BE ANCHORED ACCORDING TO THESE INSTRUCTIONS AT ALL TIMES**

### **▲WARNING**

THIS EQUIPMENT MUST BE STORED IN A SECURED, SHELTERED AREA WHEN NOT IN USE OR IN THE THREAT OF HIGH WINDS. ANY WEATHER DAMAGE TO THIS EQUIPMENT WILL NOT BE COVERED UNDER KWIK GOAL'S PRODUCT GUARANTEE. DO NOT LEAVE THIS EQUIPMENT UNATTENDED.

Note: Hardware is packed separately in one or more boxes.  
Open all boxes and layout all sealed hardware packs  
before beginning assembly.

#### Frame Hdw (Part# JZ190)

3/8" X 1" Socket Head (Part# TZ323)	(20)
3/8" Lock Washer (Part# TZ65)	(20)
5/16" X 1" Hex Bolt (Part# TZ330)	(20)
5/16" Flat Washer (Part# TZ4)	(20)
5/16" Lock Washer (Part# TZ174)	(20)

#### Anchor Hdw (Part# JZ217)

7/16" Flat Washer (Part# TZ171)	(8)
7/16" X 5" Hex Bolt (Part# TZ307)	(4)
7/16" Lock Nut (Part# TZ47)	(4)
1/4" X 12 1/2" Chain (Part# VZ564-12)	(4)
1/4" X 3 1/2" Chain (Part# VZ564-3)	(4)
7/16" Snap Link (Part# VZ737)	(4)

#### Quantity per shelter length

#### Panel Hdw (Part# JZ199, JZ202)

	<u>9ft</u>	<u>12ft</u>	<u>15ft</u>	<u>18ft</u>	<u>21ft</u>	<u>24ft</u>	<u>30ft</u>
3/8" X 7/8" Hex Bolt (Part# TZ249)	(5)	(6)	(7)	(8)	(9)	(10)	(12)
3/8" X 2-1/4" Hex Bolt (Part# TZ305)	(7)	(8)	(9)	(10)	(11)	(12)	(14)
3/8" Square Nut (Part# TZ247)	(12)	(14)	(16)	(18)	(20)	(22)	(26)
3/8" Lock Washer (Part# TZ65)	(32)	(34)	(36)	(38)	(40)	(42)	(46)
3/8" Flat Washer (Part# TZ60)	(12)	(14)	(16)	(18)	(20)	(22)	(26)
5/16" X 3-3/4" Hex Bolt (Part# TZ264)	(6)	(9)	(12)	(15)	(18)	(21)	(27)
5/16" Lock Nut (Part# TZ5)	(12)	(15)	(18)	(21)	(24)	(27)	(33)
5/16" Flat Washer (Part# TZ4)	(18)	(24)	(30)	(36)	(42)	(48)	(60)

#### Parts

Snap Link (See Anchor Hdw)  
(Part# VZ737)

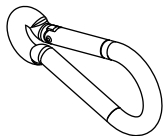

Ground Anchor (4)  
(Part# 10B103 Pack of 4)

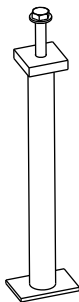

12 1/2"L  
Chain (See Anchor Hdw)  
(Part# VZ564-12)

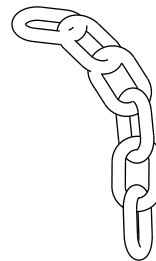

3 1/2"L  
Chain (See Anchor Hdw)  
(Part# VZ564-3)

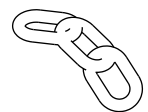

#### Assembly Tools

1/2", 5/8", 9/16", 3/4"  
Wrenches

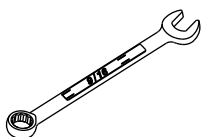

Ratchet with  
1/2", 5/8", 9/16", 3/4" Sockets

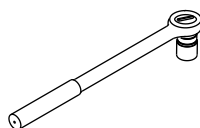

5/16" Hex wrench



Polyurethane Sealant  
(Part# VZ837)



**THIS UNIT MUST BE ANCHORED ACCORDING TO THESE INSTRUCTIONS AT ALL TIMES**

#### **▲WARNING**

THIS EQUIPMENT MUST BE STORED IN A SECURED, SHELTERED AREA WHEN NOT IN USE OR IN THE THREAT OF HIGH WINDS. ANY WEATHER DAMAGE TO THIS EQUIPMENT WILL NOT BE COVERED UNDER KWIK GOAL'S PRODUCT GUARANTEE. DO NOT LEAVE THIS EQUIPMENT UNATTENDED.

3. Hardware for this step is in **Frame Hdw** & **Panel Hdw** packs.

Assemble crossbar, bases, and post corners. Press joints together firmly before tightening bolts.

**NOTE: Square nuts will float loose in channels until used later.**

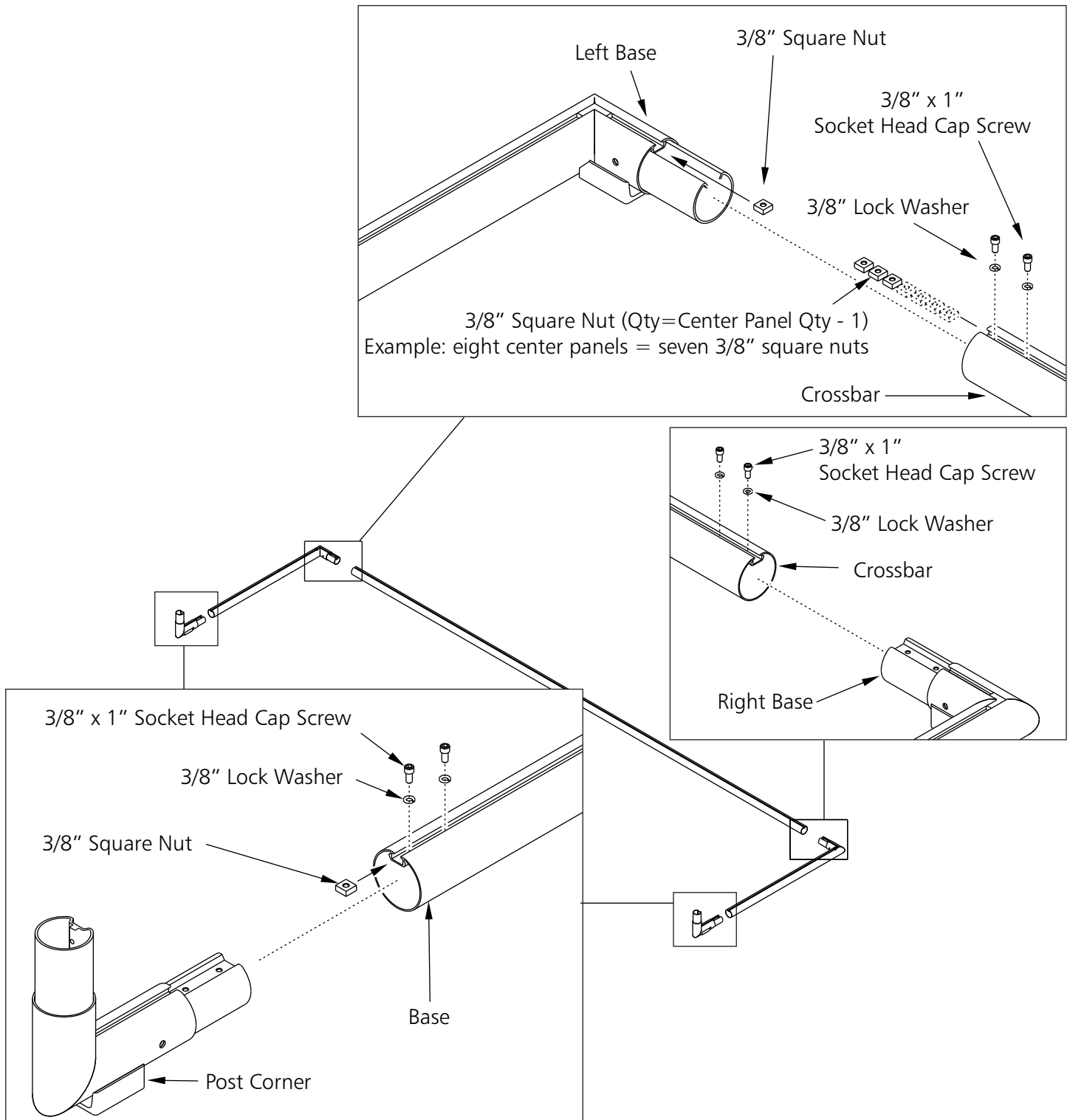

**THIS UNIT MUST BE ANCHORED ACCORDING TO THESE INSTRUCTIONS AT ALL TIMES**

**⚠ WARNING**

THIS EQUIPMENT MUST BE STORED IN A SECURED, SHELTERED AREA WHEN NOT IN USE OR IN THE THREAT OF HIGH WINDS. ANY WEATHER DAMAGE TO THIS EQUIPMENT WILL NOT BE COVERED UNDER KWIK GOAL'S PRODUCT GUARANTEE. DO NOT LEAVE THIS EQUIPMENT UNATTENDED.

4. Hardware for this step is in **Frame Hdw** & **Panel Hdw** packs.

Assemble crossbar, posts, and crossbar corners. Press joints together firmly before tightening bolts.

**NOTE:** Square nuts will float loose in channels until used later.

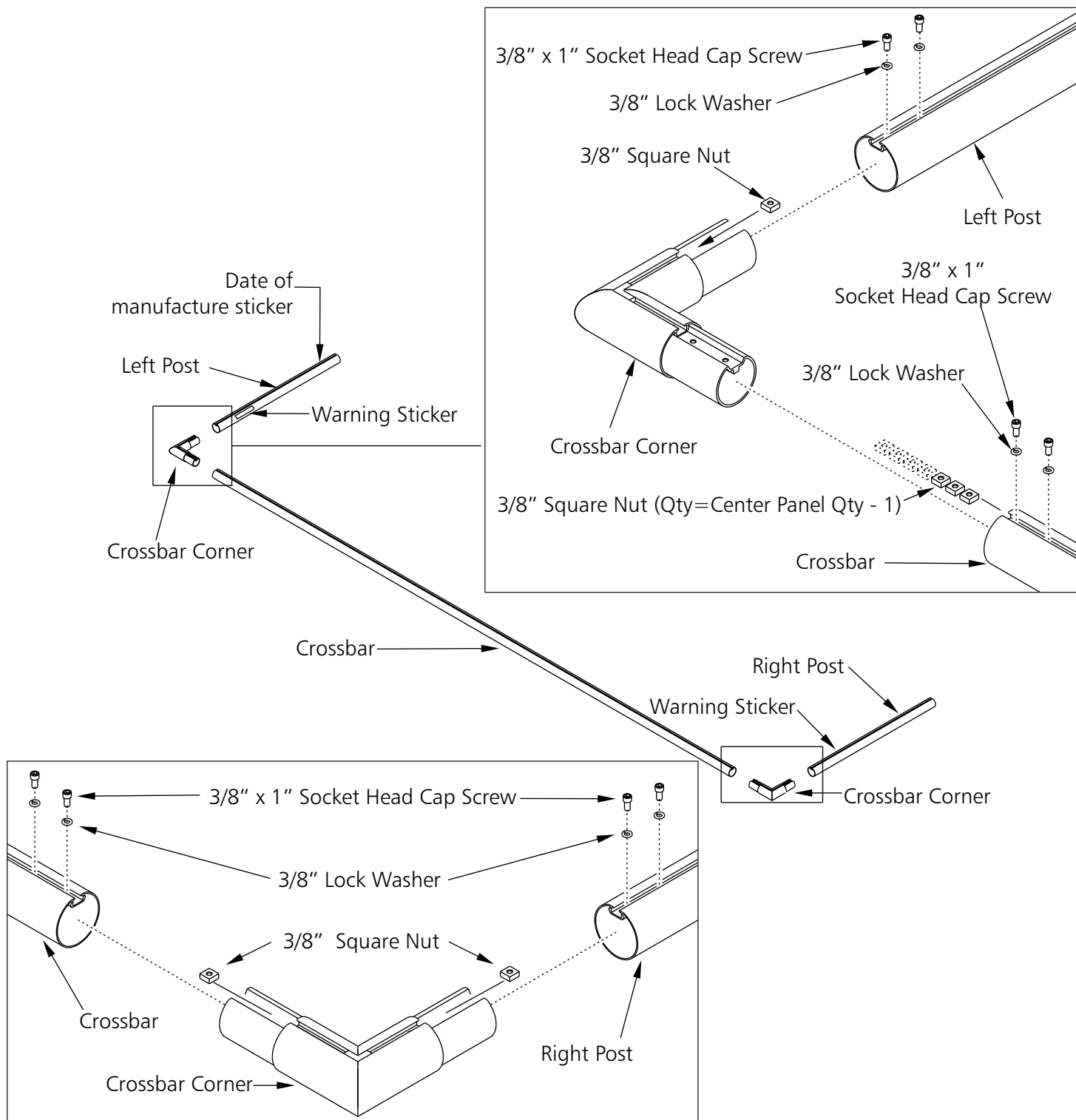

**THIS UNIT MUST BE ANCHORED ACCORDING TO THESE INSTRUCTIONS AT ALL TIMES**

**⚠ WARNING**

THIS EQUIPMENT MUST BE STORED IN A SECURED, SHELTERED AREA WHEN NOT IN USE OR IN THE THREAT OF HIGH WINDS. ANY WEATHER DAMAGE TO THIS EQUIPMENT WILL NOT BE COVERED UNDER KWIK GOAL'S PRODUCT GUARANTEE. DO NOT LEAVE THIS EQUIPMENT UNATTENDED.

5. Hardware for this step is in **Frame Hdw** & **Panel Hdw** packs.

Insert one 3/8" square nut in each side of assembled base corner. Connect assembled base and post as shown. Press joints together firmly before tightening bolts.

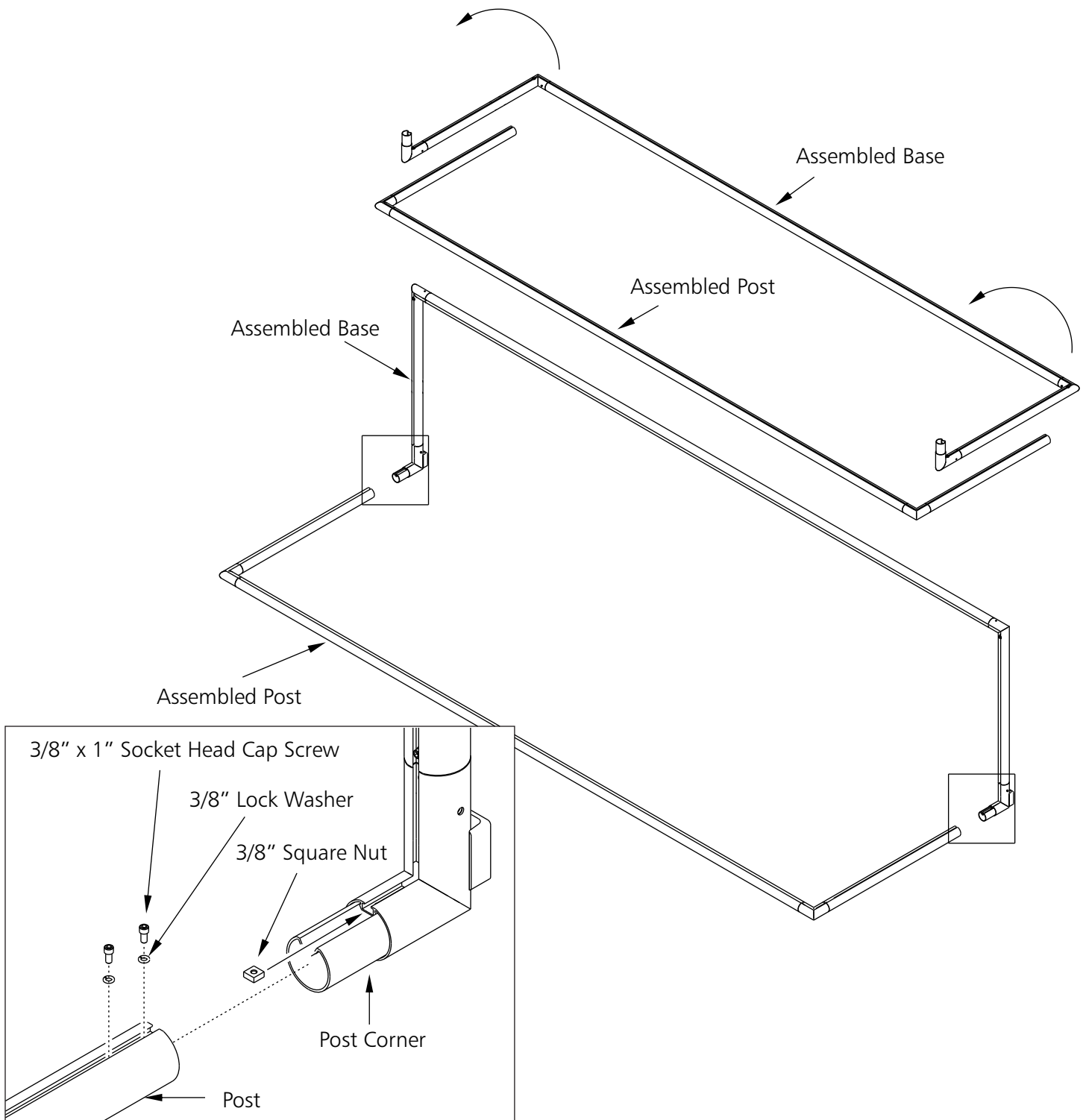

**THIS UNIT MUST BE ANCHORED ACCORDING TO THESE INSTRUCTIONS AT ALL TIMES**

**⚠WARNING**

THIS EQUIPMENT MUST BE STORED IN A SECURED, SHELTERED AREA WHEN NOT IN USE OR IN THE THREAT OF HIGH WINDS. ANY WEATHER DAMAGE TO THIS EQUIPMENT WILL NOT BE COVERED UNDER KWIK GOAL'S PRODUCT GUARANTEE. DO NOT LEAVE THIS EQUIPMENT UNATTENDED.

6. Hardware for this step is in **Panel Hdw** packs.  
Attach right and left panels to assembled frame as shown.  
**Do NOT tighten bolts at this time.**

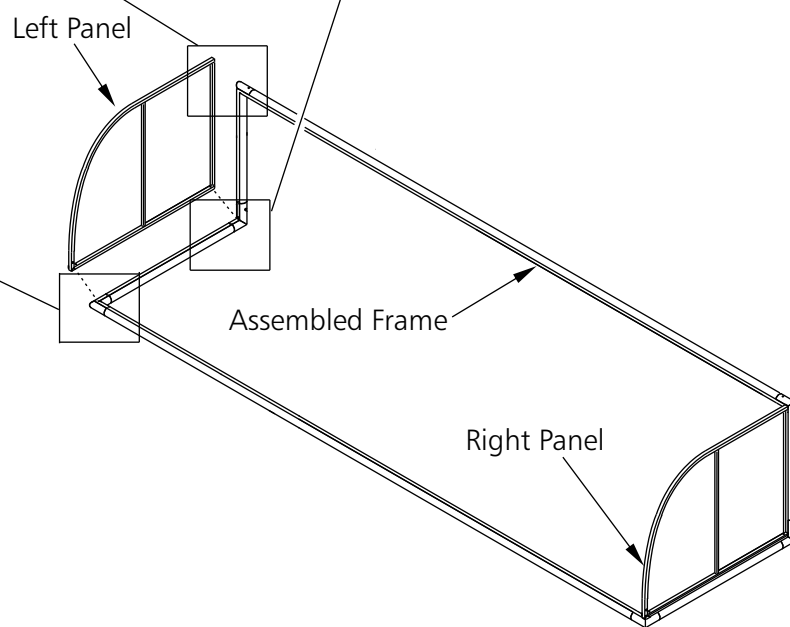
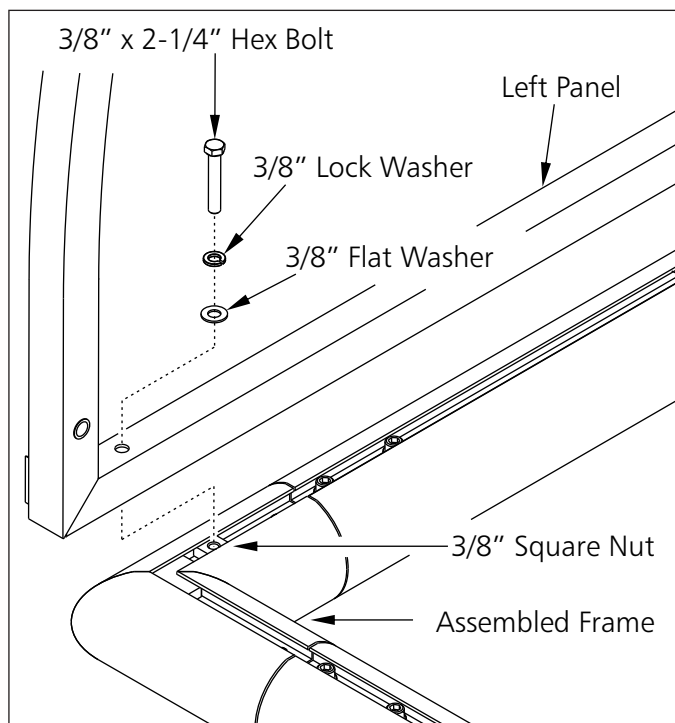
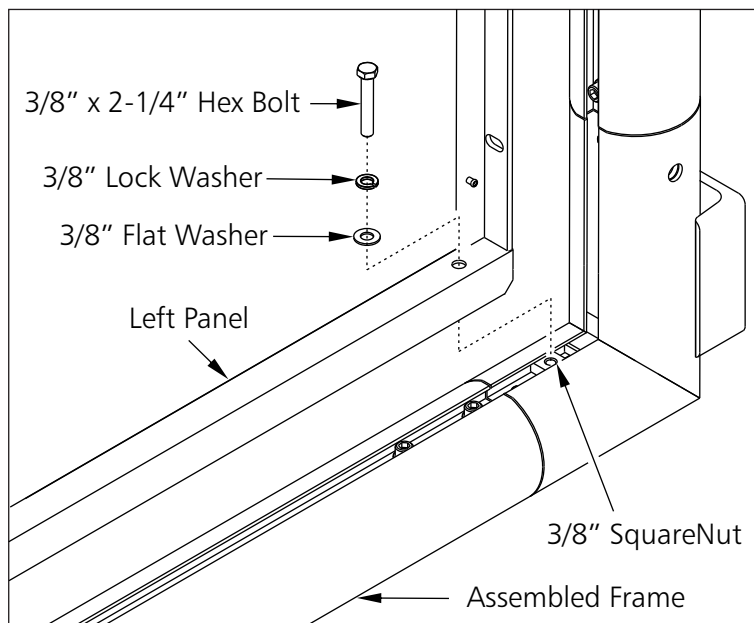
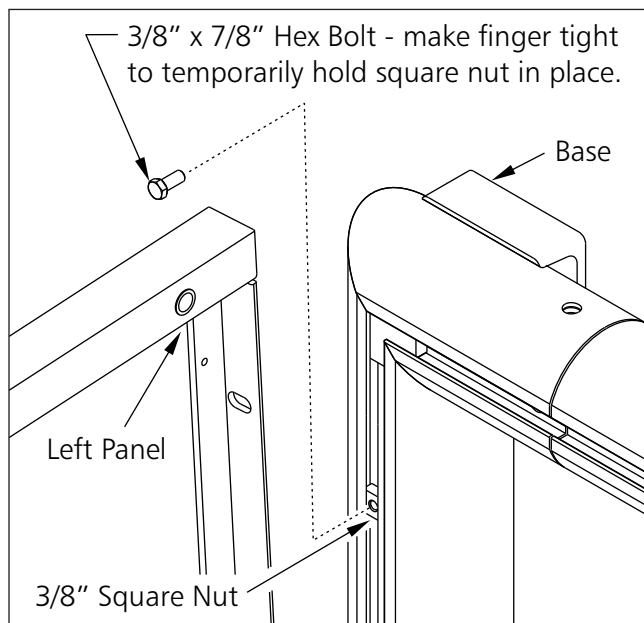

**THIS UNIT MUST BE ANCHORED ACCORDING TO THESE INSTRUCTIONS AT ALL TIMES**

**▲WARNING**

THIS EQUIPMENT MUST BE STORED IN A SECURED, SHELTERED AREA WHEN NOT IN USE OR IN THE THREAT OF HIGH WINDS. ANY WEATHER DAMAGE TO THIS EQUIPMENT WILL NOT BE COVERED UNDER KWIK GOAL'S PRODUCT GUARANTEE. DO NOT LEAVE THIS EQUIPMENT UNATTENDED.



7. Install swivel wheels - 10" diameter tires. Note suggested location of brakes as shown below.

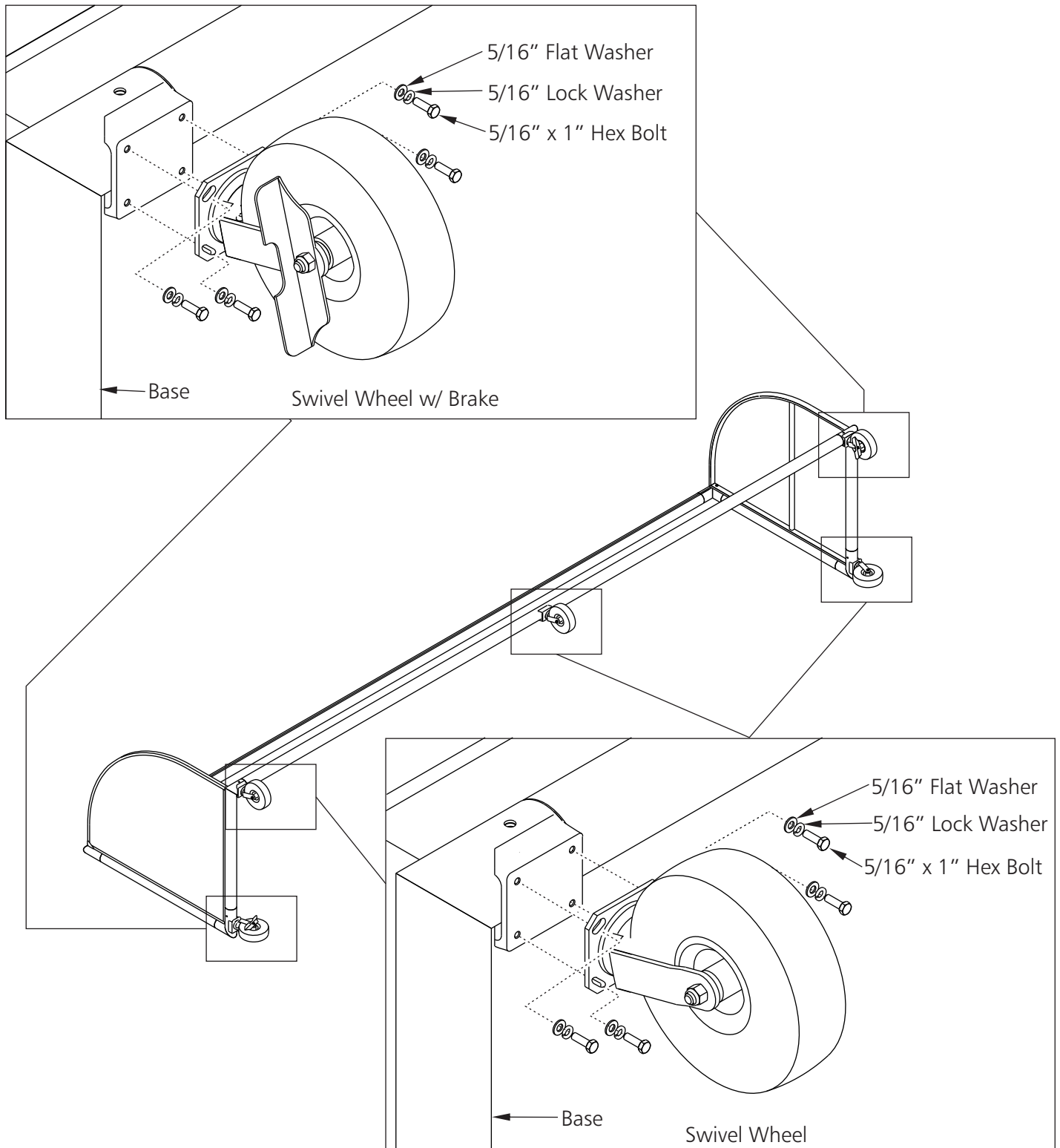

**THIS UNIT MUST BE ANCHORED ACCORDING TO THESE INSTRUCTIONS AT ALL TIMES**

**▲WARNING**

THIS EQUIPMENT MUST BE STORED IN A SECURED, SHELTERED AREA WHEN NOT IN USE OR IN THE THREAT OF HIGH WINDS. ANY WEATHER DAMAGE TO THIS EQUIPMENT WILL NOT BE COVERED UNDER KWIK GOAL'S PRODUCT GUARANTEE. DO NOT LEAVE THIS EQUIPMENT UNATTENDED.

8. Turn shelter frame onto base and remove temporary 3/8" X 7/8" bolt then connect bottom of right and left panel as shown.  
**Do NOT tighten bolts at this time.**

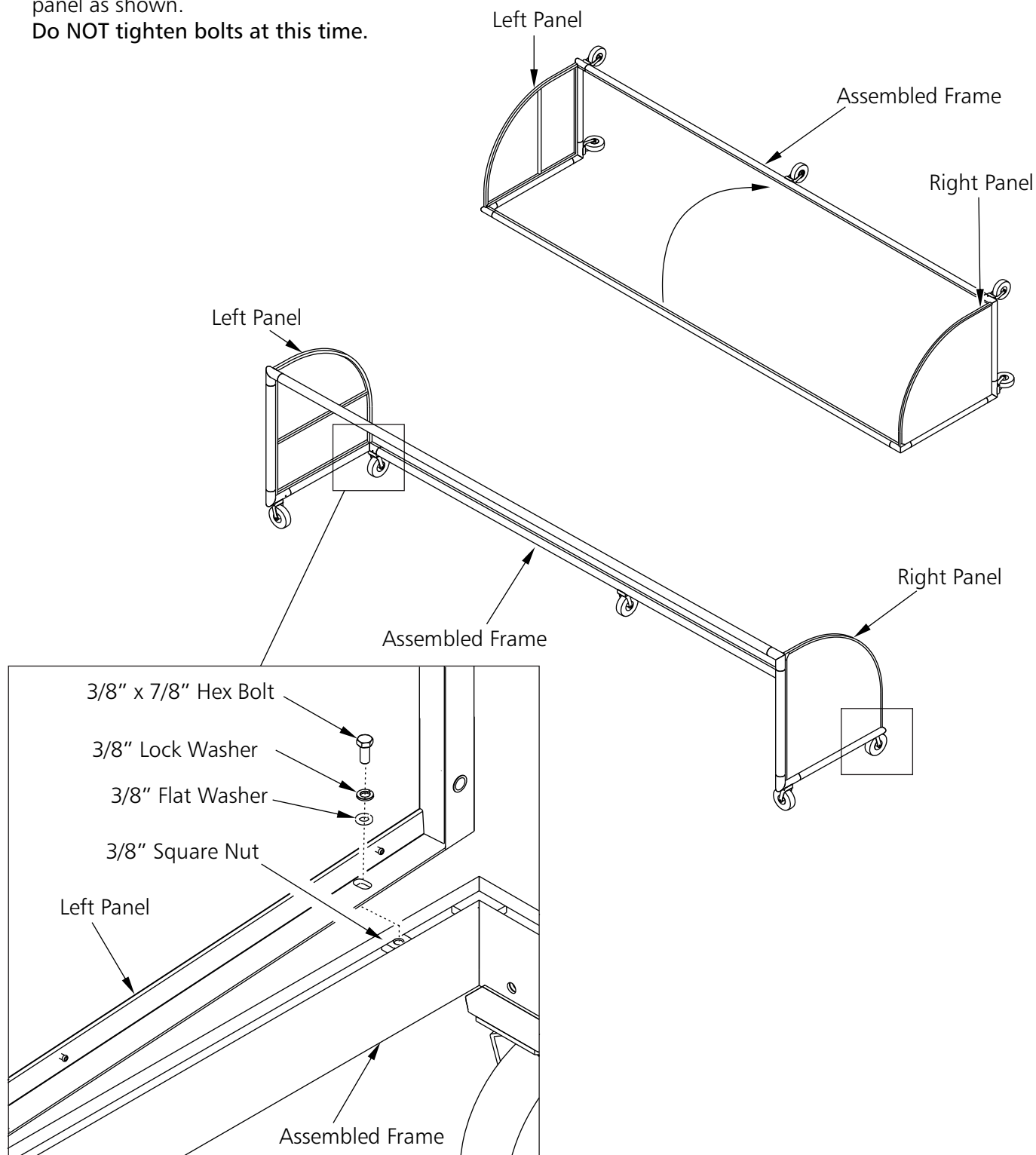

**THIS UNIT MUST BE ANCHORED ACCORDING TO THESE INSTRUCTIONS AT ALL TIMES**

**▲WARNING**

THIS EQUIPMENT MUST BE STORED IN A SECURED, SHELTERED AREA WHEN NOT IN USE OR IN THE THREAT OF HIGH WINDS. ANY WEATHER DAMAGE TO THIS EQUIPMENT WILL NOT BE COVERED UNDER KWIK GOAL'S PRODUCT GUARANTEE. DO NOT LEAVE THIS EQUIPMENT UNATTENDED.

9. Hardware for this step is in **Panel Hdw** packs.

Insert double end studs into left panel. Move unneeded square nuts in top and bottom crossbars away from left side at least one center panel width.

**Do NOT tighten bolts at this time.**

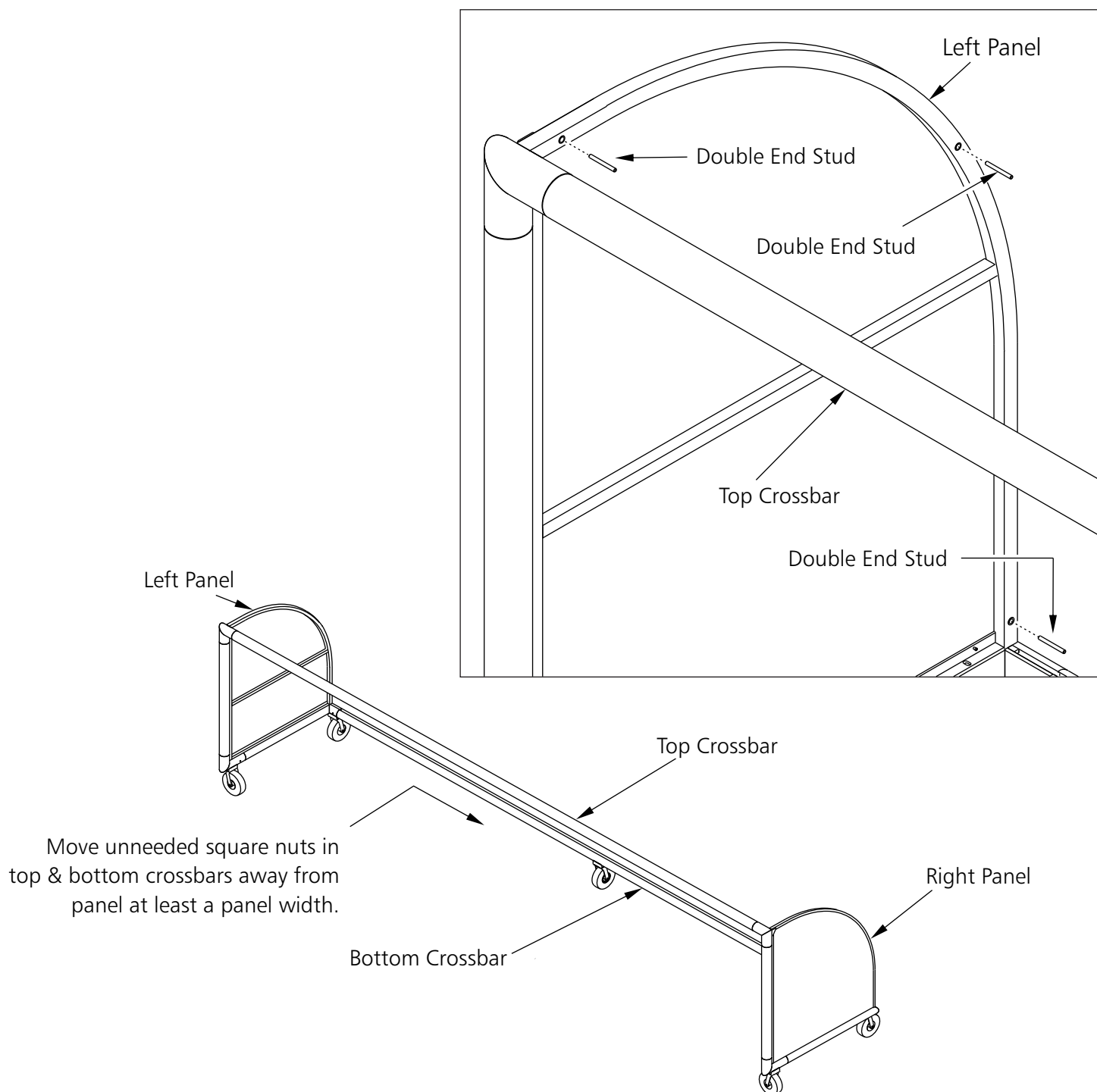

**THIS UNIT MUST BE ANCHORED ACCORDING TO THESE INSTRUCTIONS AT ALL TIMES**

**▲WARNING**

THIS EQUIPMENT MUST BE STORED IN A SECURED, SHELTERED AREA WHEN NOT IN USE OR IN THE THREAT OF HIGH WINDS. ANY WEATHER DAMAGE TO THIS EQUIPMENT WILL NOT BE COVERED UNDER KWIK GOAL'S PRODUCT GUARANTEE. DO NOT LEAVE THIS EQUIPMENT UNATTENDED.

10. Hardware for this step is in **Panel Hdw** packs.

Line up square nut with holes in center panel and attach center panel to shelter frame. Slide center panel to mate with left panel lining up double end studs, as shown. Repeat steps 9 & 10 to attach center panel to the right side.

**Do NOT tighten bolts at this time.**

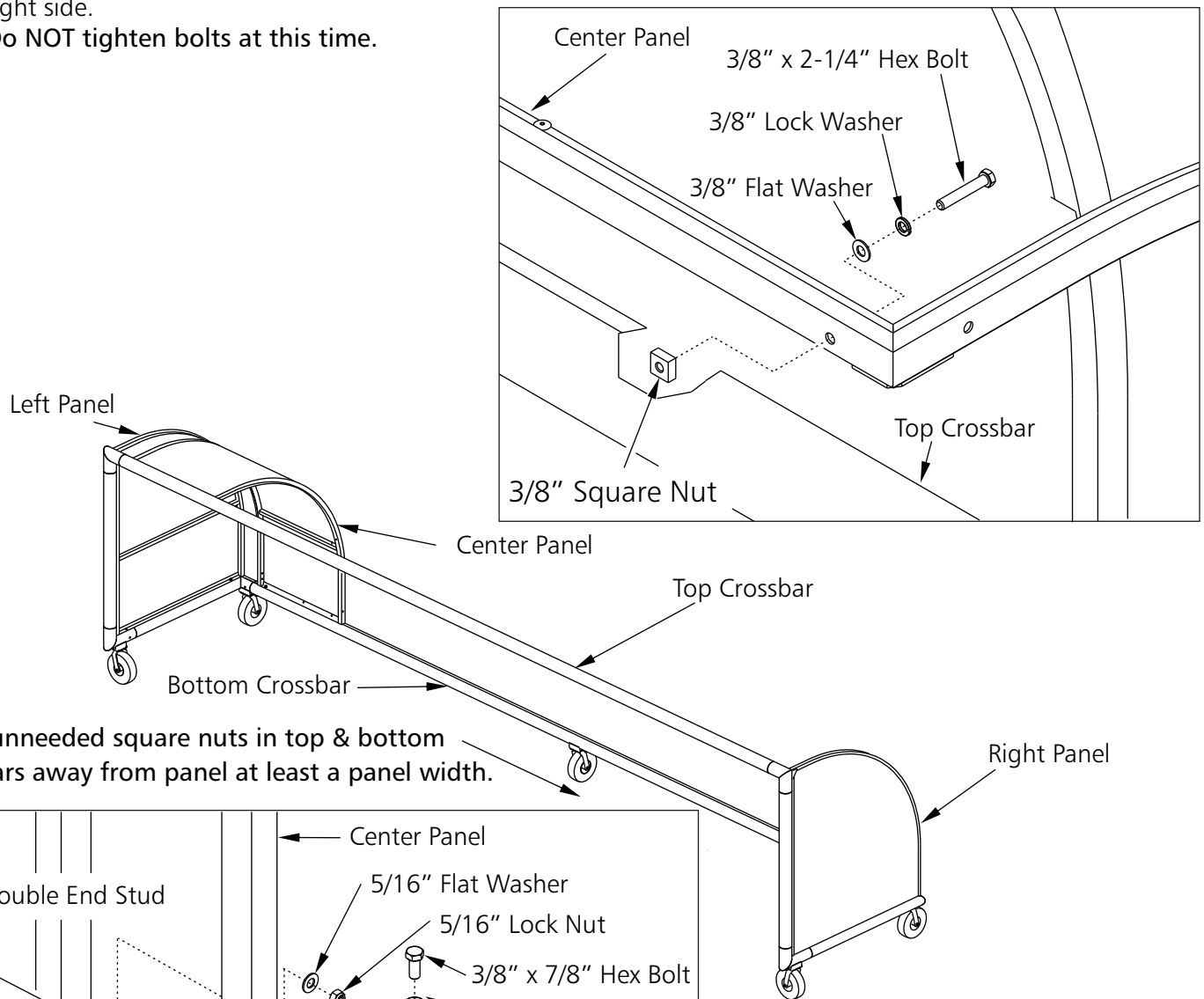

Move unneeded square nuts in top & bottom crossbars away from panel at least a panel width.

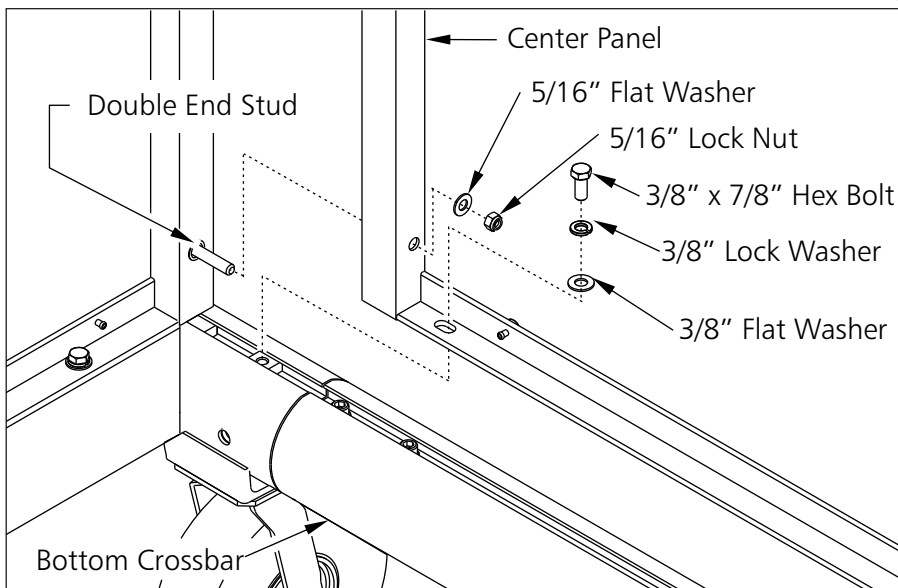

**THIS UNIT MUST BE ANCHORED ACCORDING TO THESE INSTRUCTIONS AT ALL TIMES**

**⚠ WARNING**

THIS EQUIPMENT MUST BE STORED IN A SECURED, SHELTERED AREA WHEN NOT IN USE OR IN THE THREAT OF HIGH WINDS. ANY WEATHER DAMAGE TO THIS EQUIPMENT WILL NOT BE COVERED UNDER KWIK GOAL'S PRODUCT GUARANTEE. DO NOT LEAVE THIS EQUIPMENT UNATTENDED.

11. Hardware for this step is in **Panel Hdw** packs.

Repeat step 10 to attach center panels to crossbars then connect center panels together until the only 1 center panel is left. Remember to move unneeded square nuts on top and bottom crossbars out from under the center panel being attached before bolting center panel in place.

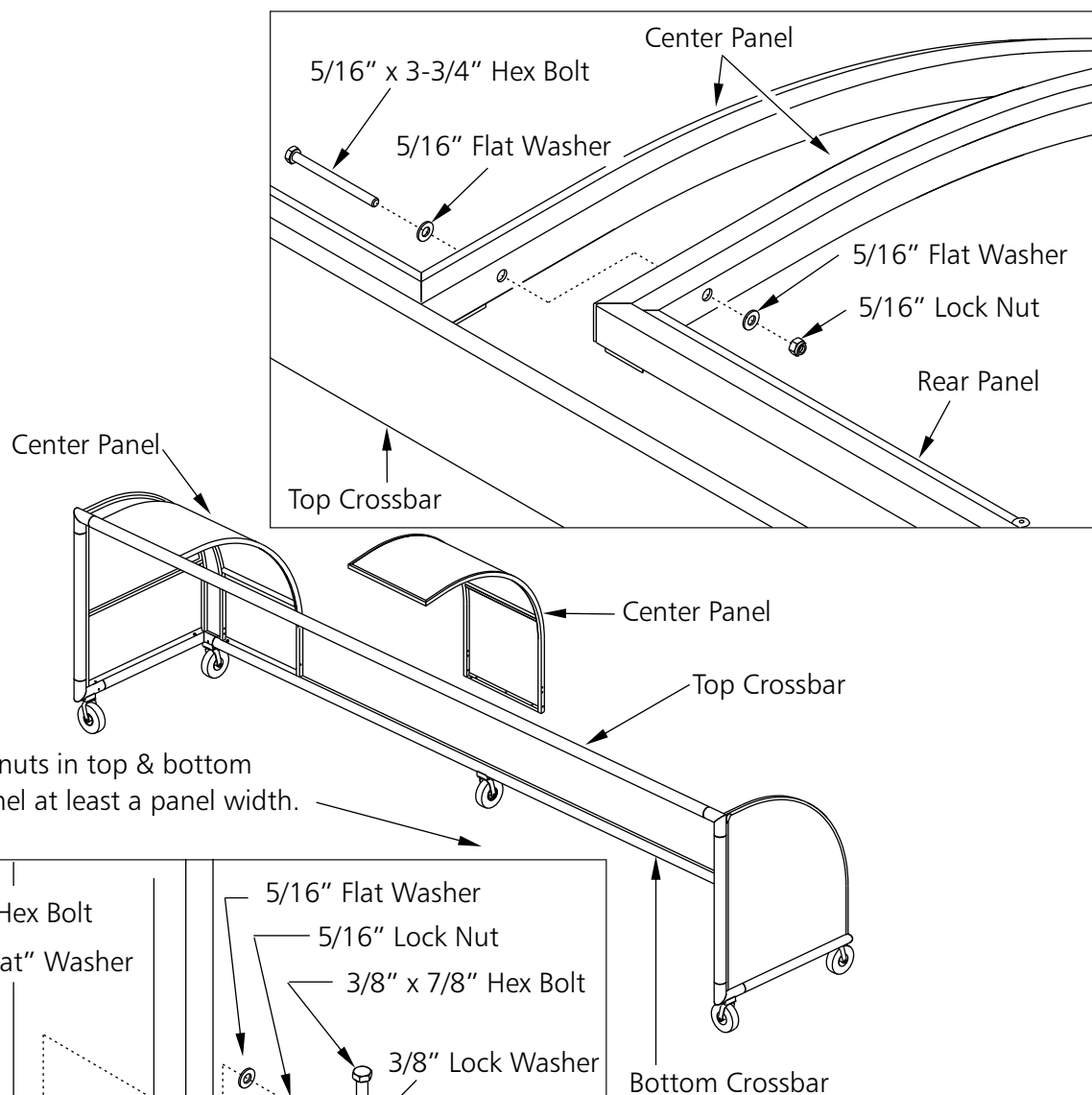

Move unneeded square nuts in top & bottom crossbars away from panel at least a panel width.

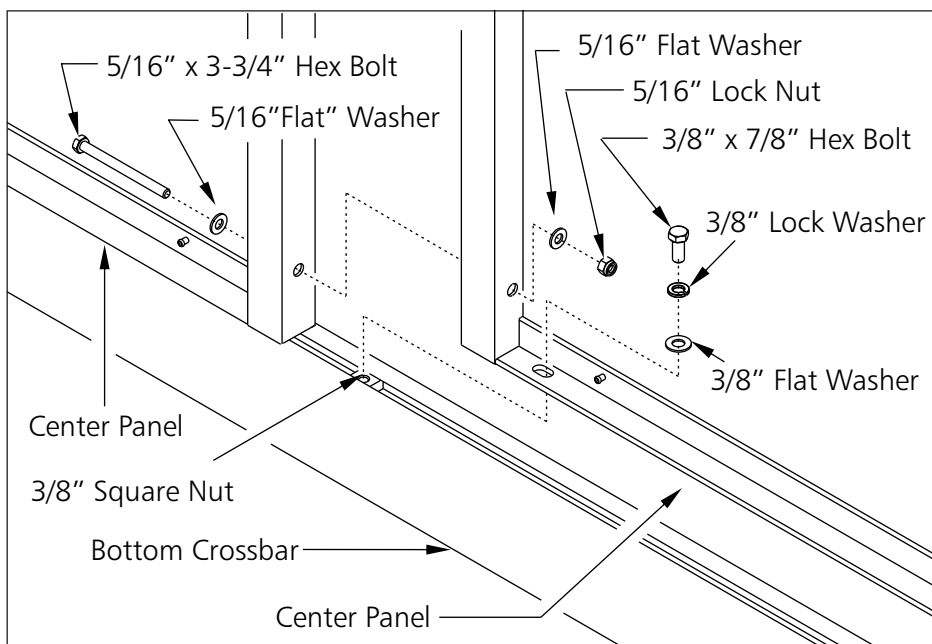

**THIS UNIT MUST BE ANCHORED ACCORDING TO THESE INSTRUCTIONS AT ALL TIMES**

**⚠ WARNING**

THIS EQUIPMENT MUST BE STORED IN A SECURED, SHELTERED AREA WHEN NOT IN USE OR IN THE THREAT OF HIGH WINDS. ANY WEATHER DAMAGE TO THIS EQUIPMENT WILL NOT BE COVERED UNDER KWIK GOAL'S PRODUCT GUARANTEE. DO NOT LEAVE THIS EQUIPMENT UNATTENDED.

12. If installing Bench or Molded Seating, skip to step 13.

If installing Luxury Seating, tighten all panel joint bolts. Begin at center joint and work outward. Tighten 3 bolts per joint. Tighten 3 panel frame bolts on each of the left and right end panels. Tighten panel to frame bolts at top and bottom of each center panel.

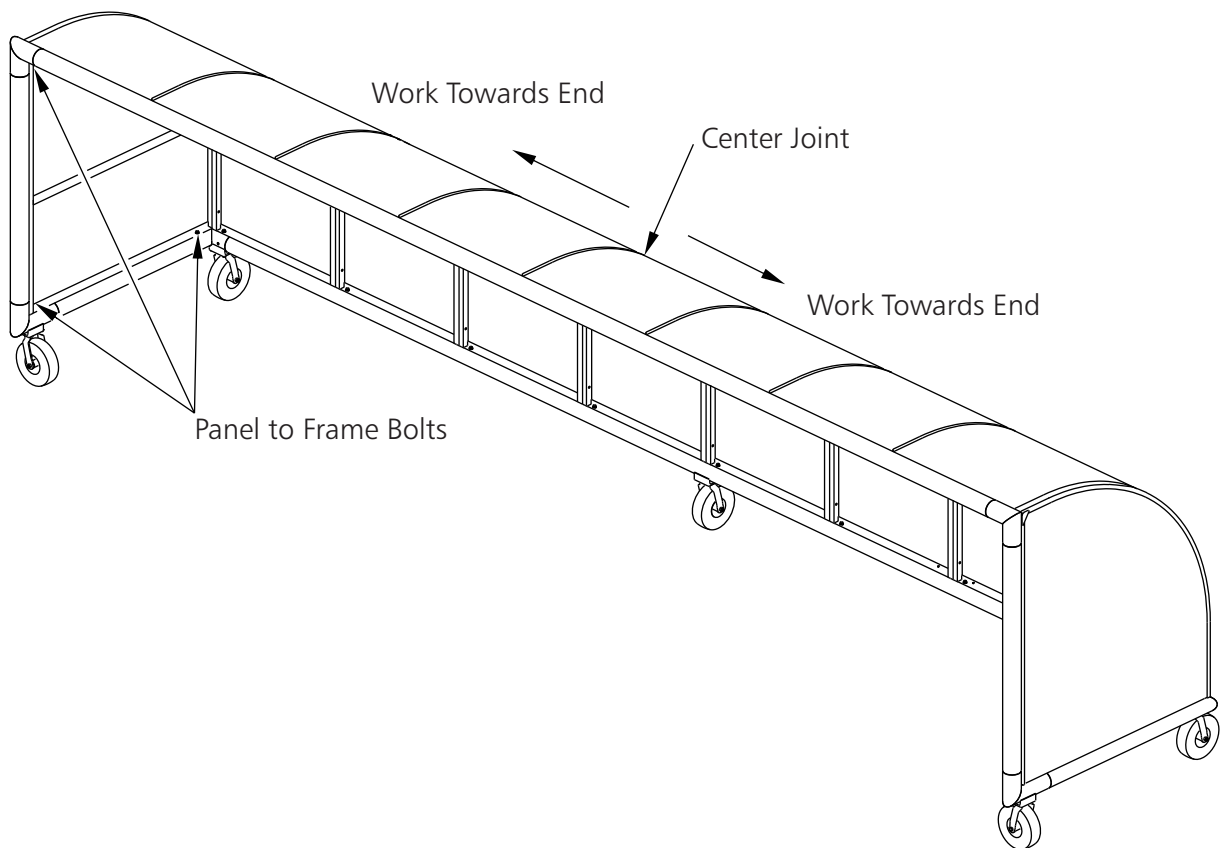

**THIS UNIT MUST BE ANCHORED ACCORDING TO THESE INSTRUCTIONS AT ALL TIMES**

**▲WARNING**

THIS EQUIPMENT MUST BE STORED IN A SECURED, SHELTERED AREA WHEN NOT IN USE OR IN THE THREAT OF HIGH WINDS. ANY WEATHER DAMAGE TO THIS EQUIPMENT WILL NOT BE COVERED UNDER KWIK GOAL'S PRODUCT GUARANTEE. DO NOT LEAVE THIS EQUIPMENT UNATTENDED.

13. Hardware for this steps 13 and 14 is in **Anchor Hdw** pack.

Attach anchor chain to shelter frame, 2 in the front on the outside and 2 on the inside at the back as shown.

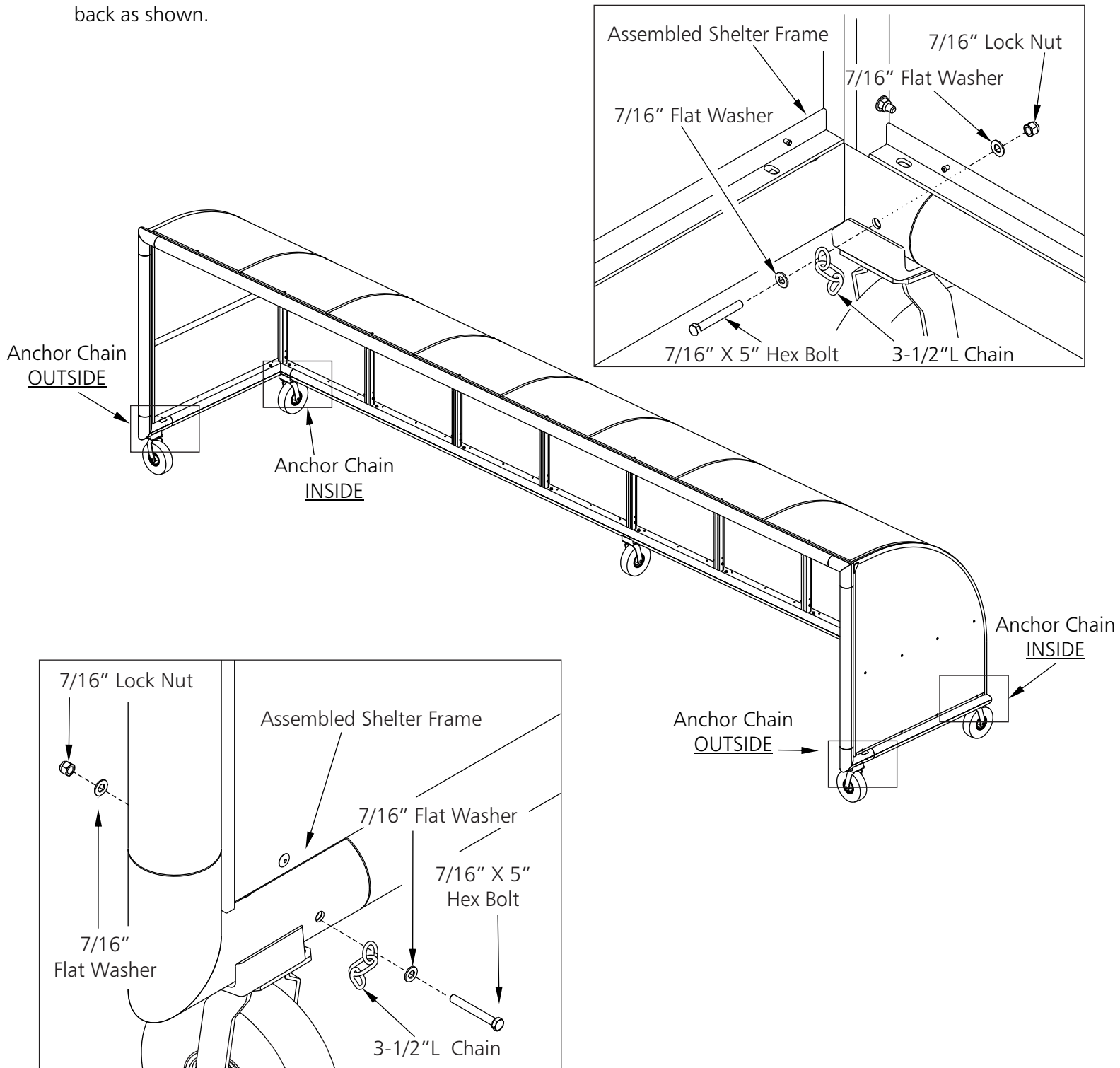

**THIS UNIT MUST BE ANCHORED ACCORDING TO THESE INSTRUCTIONS AT ALL TIMES**

**▲WARNING**

THIS EQUIPMENT MUST BE STORED IN A SECURED, SHELTERED AREA WHEN NOT IN USE OR IN THE THREAT OF HIGH WINDS. ANY WEATHER DAMAGE TO THIS EQUIPMENT WILL NOT BE COVERED UNDER KWIK GOAL'S PRODUCT GUARANTEE. DO NOT LEAVE THIS EQUIPMENT UNATTENDED.

14. Permanent ground anchors must be used at all times. Dig four holes according to the layout below. Note: areas subject to heavy frost may require depths as deep as 36". Prepare hole and add drain stone as shown. Install anchor in each hole and fill hole with concrete. Allow concrete to cure before attaching shelter to anchors. Use snap links to connect anchors chains. Upon completion of shelter frame, refer to seating instructions to complete your seating shelter.

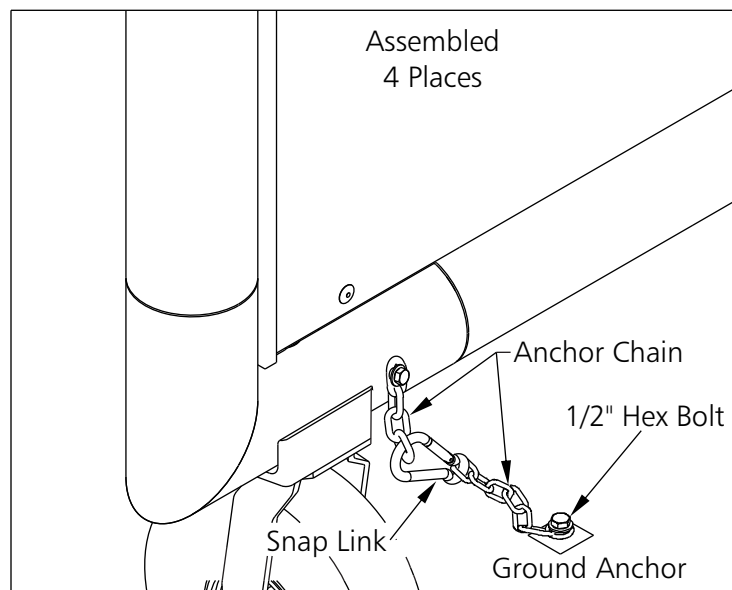
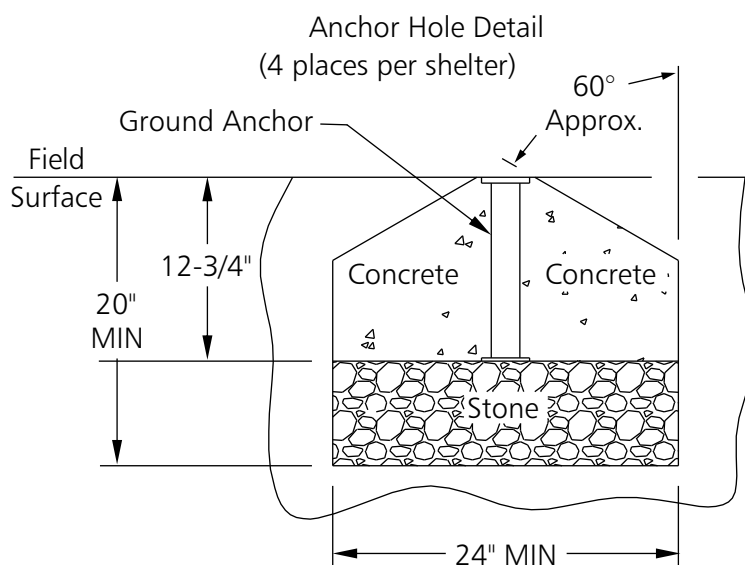
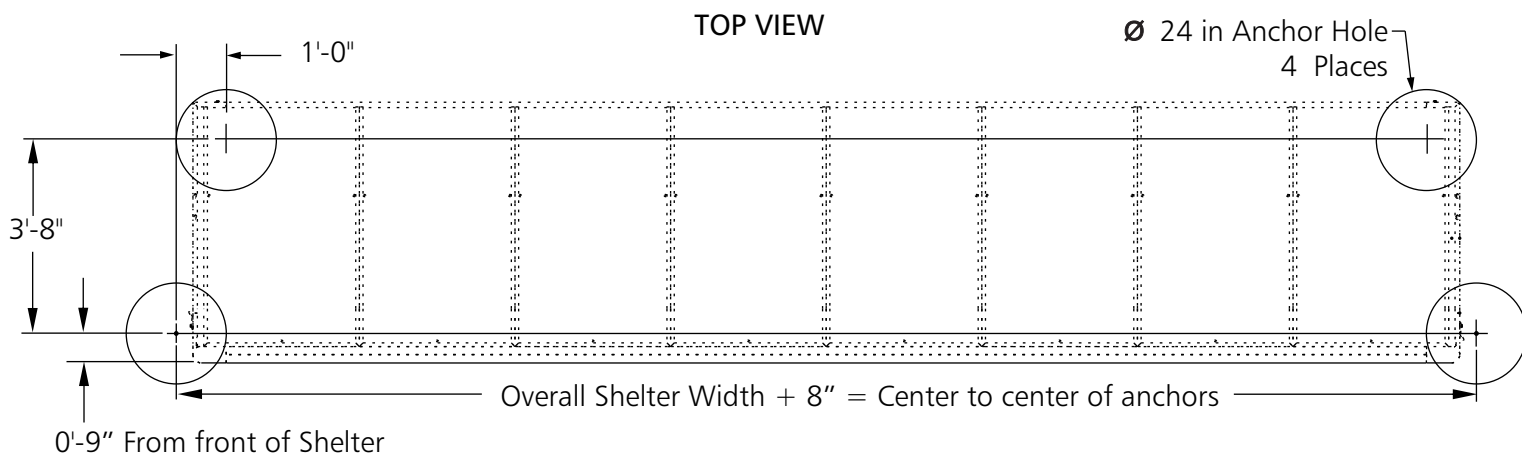
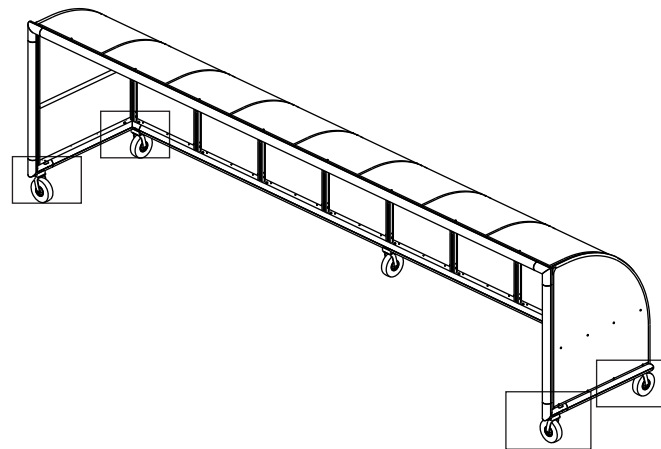

**THIS UNIT MUST BE ANCHORED ACCORDING TO THESE INSTRUCTIONS AT ALL TIMES**

**▲WARNING**

THIS EQUIPMENT MUST BE STORED IN A SECURED, SHELTERED AREA WHEN NOT IN USE OR IN THE THREAT OF HIGH WINDS. ANY WEATHER DAMAGE TO THIS EQUIPMENT WILL NOT BE COVERED UNDER KWIK GOAL'S PRODUCT GUARANTEE. DO NOT LEAVE THIS EQUIPMENT UNATTENDED.



15. If desired, panel joints may be sealed with a small bead of urethane sealant. Seal across crossbar to panel joint, then panel to panel joints.

**NOTE:** Panel to panel joints should only be sealed between crossbar and lower brace of panels.  
Sealant below lower brace line is not necessary.

Prevent sealant material from contacting polycarbonate.

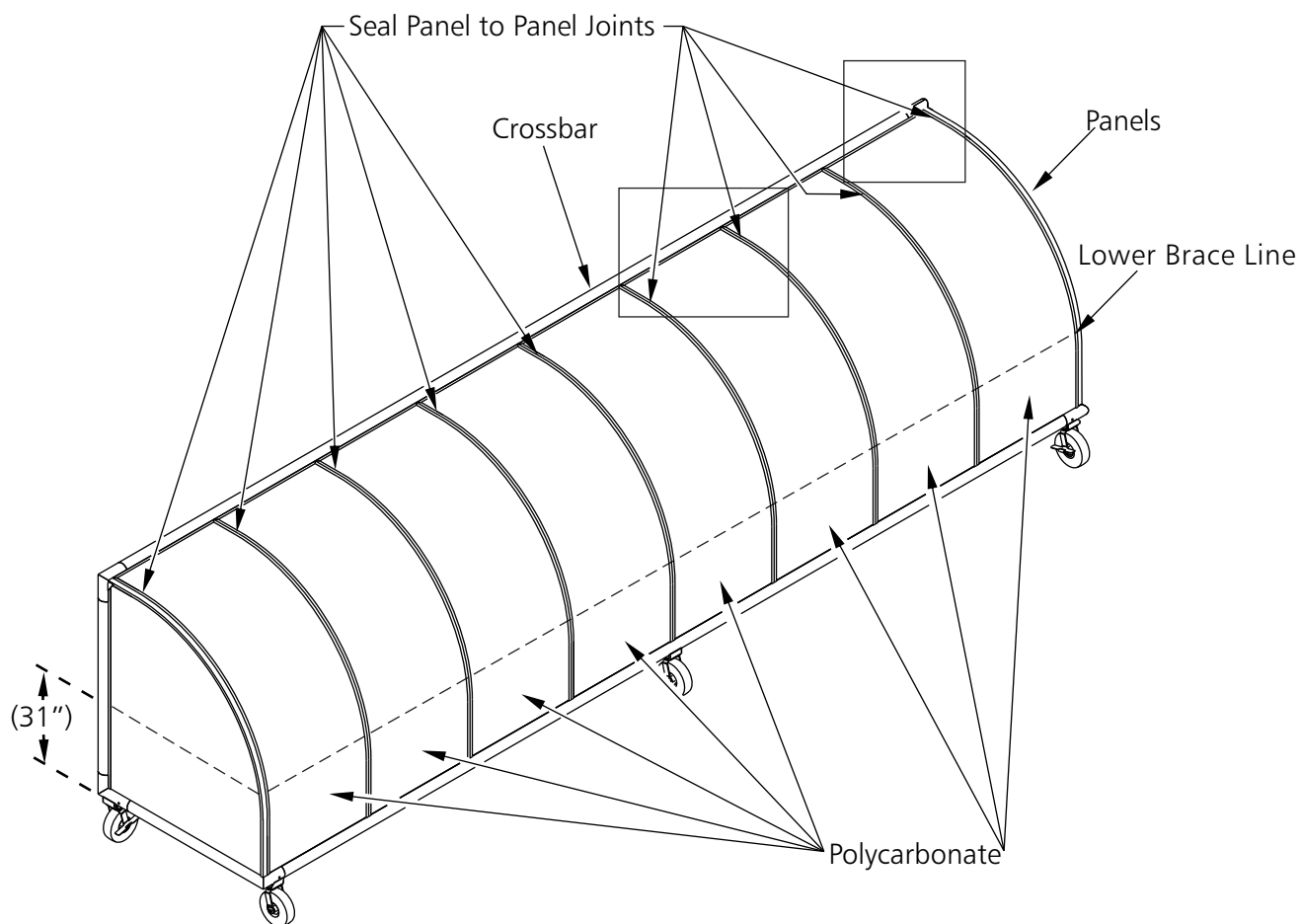
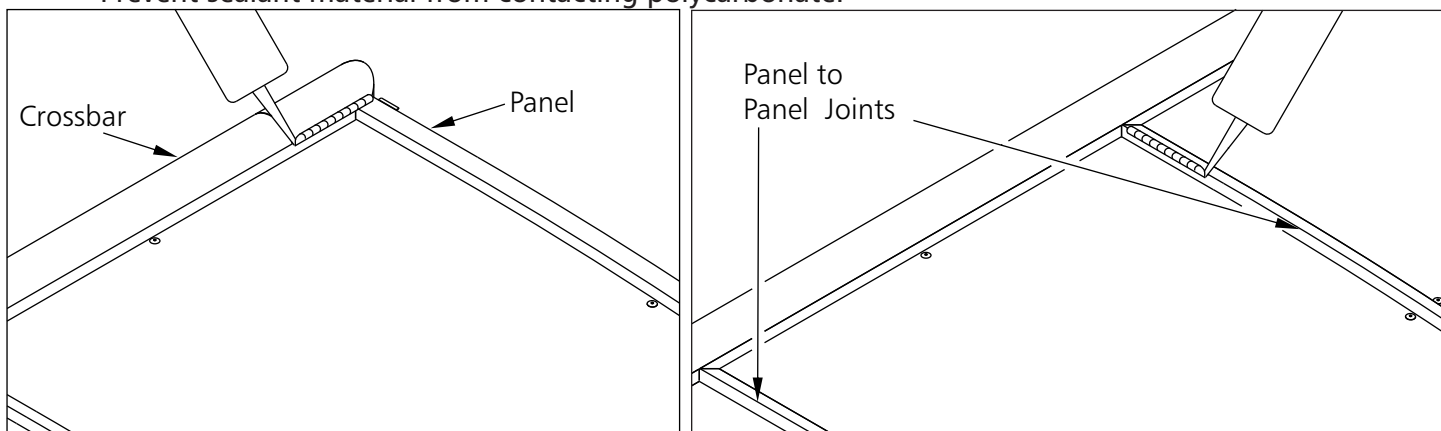

Go to [kwikgoal.com](http://kwikgoal.com) for additional product information.

**THIS UNIT MUST BE ANCHORED ACCORDING TO THESE INSTRUCTIONS AT ALL TIMES**

**⚠ WARNING**

THIS EQUIPMENT MUST BE STORED IN A SECURED, SHELTERED AREA WHEN NOT IN USE OR IN THE THREAT OF HIGH WINDS. ANY WEATHER DAMAGE TO THIS EQUIPMENT WILL NOT BE COVERED UNDER KWIK GOAL'S PRODUCT GUARANTEE. DO NOT LEAVE THIS EQUIPMENT UNATTENDED.



## ASSEMBLY INSTRUCTIONS FOR BENCH SEATS FOR 9B531 PORTABLE ONLY SHELTER

**\*THIS UNIT MUST BE ASSEMBLED BY A MINIMUM OF TWO QUALIFIED PERSONS\***  
**PORTABLE SHELTERS MUST BE STORED IN A SECURE AREA WHEN NOT IN USE.**

1. Unpack all parts and check for damage that may have occurred during shipping. If damage has occurred, notify Kwik Goal immediately. Lay out all parts. Remove all cardboard and packaging immediately. Wet or damp packaging may damage contents.
2. Refer to 9B53 instructions to assemble shelter frame prior to beginning seat assembly.
3. Read through entire instruction before beginning assembly and installation.

**NOTE: Components may be packaged in one or more additional boxes.**

### Parts

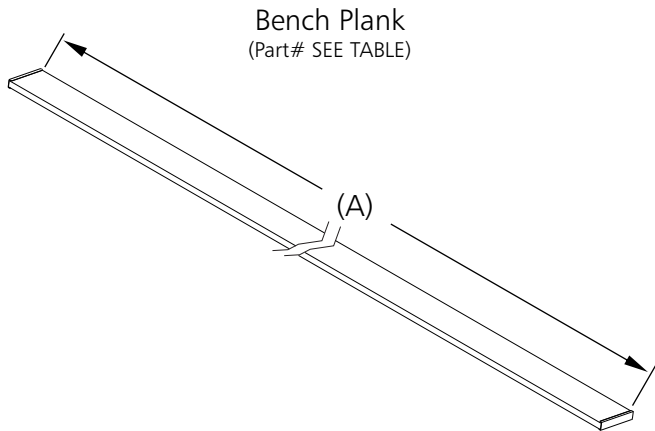

### Seat Frame (SEE TABLE) (Part# UZ1448)

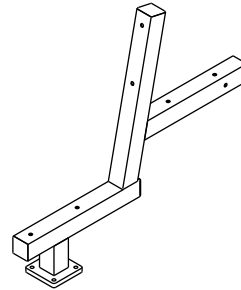

MODEL#	QTY
9B5310	6
9B5318	4
9B5317	4
9B5316	3
9B5315	3
9B5314	2
9B5313	2

MODEL#	DIM (A)	ANODIZED PART #	POWDER COATED PART #	QTY
9B5310	180"	UZ468	UZ1118	6
9B5318	288"	UZ1209	UZ1490	3
9B5317	252"	UZ763	UZ1119	3
9B5316	216"	UZ1459	UZ1502	3
9B5315	180"	UZ468	UZ1118	3
9B5314	144"	UZ1460	UZ1503	3
9B5313	108"	UZ1115	UZ1491	3

### Seat Swivel Wheel (SEE TABLE) (Part# VZ688)



MODEL#	QTY
9B5310	10
9B5318	6
9B5317	6
9B5316	5
9B5315	5
9B5314	4
9B5313	4

**THIS UNIT MUST BE ANCHORED ACCORDING TO THESE INSTRUCTIONS AT ALL TIMES**

### **⚠WARNING**

**THIS EQUIPMENT MUST BE STORED IN A SECURED, SHELTERED AREA WHEN NOT IN USE OR IN THE THREAT OF HIGH WINDS. ANY WEATHER DAMAGE TO THIS EQUIPMENT WILL NOT BE COVERED UNDER KWIK GOAL'S PRODUCT GUARANTEE. DO NOT LEAVE THIS EQUIPMENT UNATTENDED.**



## **⚠ WARNING**

## **IMPORTANT SAFETY INSTRUCTIONS**

### **READ CAREFULLY**

1. Lifting and moving heavy field equipment can be dangerous if not done properly. All Kwik Goal shelters must be moved by qualified personnel who are experienced in moving large, heavy field equipment.
2. A minimum of four qualified, experienced people are required to move shelter.
3. Do not attempt to lift or move shelter in windy conditions.
4. Shelters must not be left unattended and unsecured.
5. Shelter must be on level, flat ground at all times.
6. Use extreme caution when pushing shelter. Excessive force can overturn shelter. Always push at lowest point on shelter frame possible.
7. Do not push shelter directly from the front to rear or rear to front. Push from end to end.

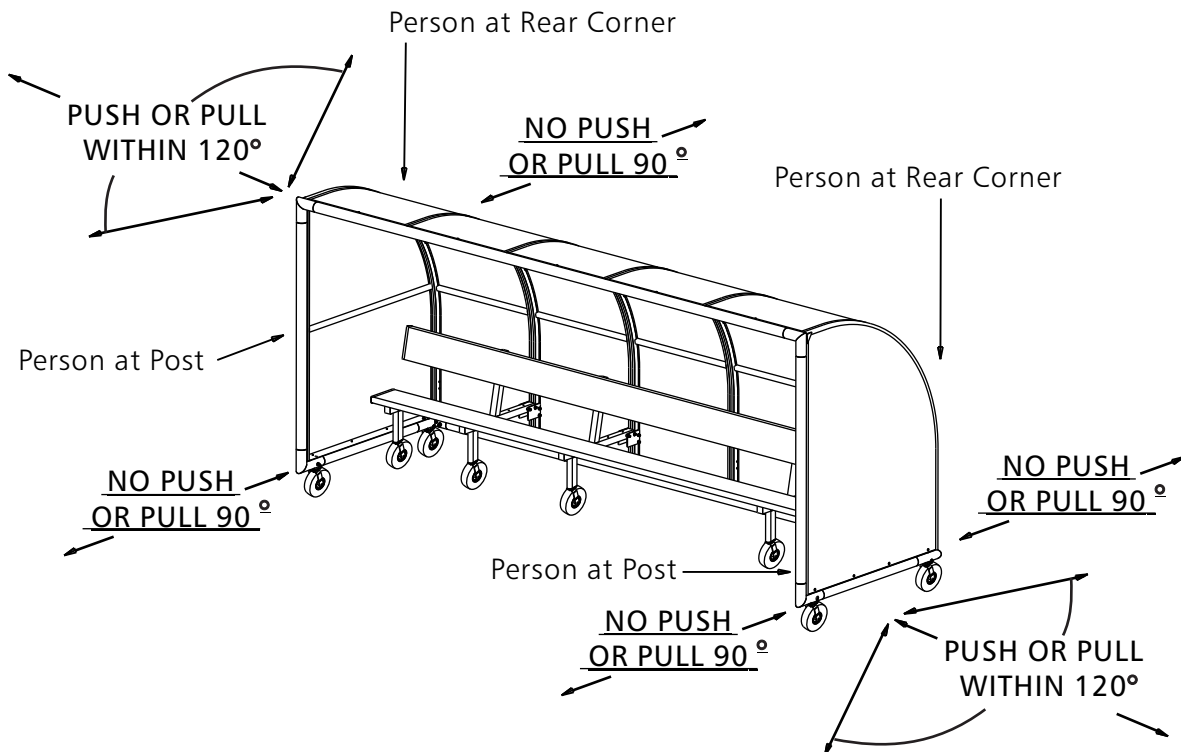

Parts Continued

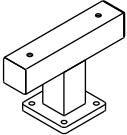

Seat Support (Part# UZ1449)		
MODEL#	QTY	
9B5310	4	
9B5318	2	
9B5317	2	
9B5316	2	
9B5315	2	
9B5314	2	
9B5313	2	

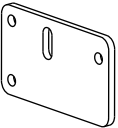

Seat Frame Plate (SEE TABLE) (Part# UZ1107)		
MODEL#	QTY	
9B5310	12	
9B5318	8	
9B5317	8	
9B5316	6	
9B5315	6	
9B5314	4	
9B5313	4	

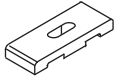

Plank Hold Down (SEE TABLE) (Part# UZ475)		
MODEL#	QTY	
9B5310	44	
9B5318	28	
9B5317	28	
9B5316	22	
9B5315	22	
9B5314	16	
9B5313	16	

3/8" Seat Frame Spacers (SEE TABLE)  
(Part# TZ308)



MODEL#	QTY
9B5310	24
9B5318	16
9B5317	16
9B5316	12
9B5315	12
9B5314	8
9B5313	8

Assembly Tools

Wrenches  
1/2" & 9/16"



Ratchet with Socket  
1/2" & 9/16"

AND

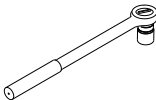

Hardware needed per Model	9B5313	9B5314	9B5315	9B5316	9B5317	9B5318	9B5310
5/16" X 1-1/4" Hex Bolt (Part# TZ311)	(16)	(16)	(20)	(20)	(24)	(24)	(40)
5/16" X 3" Carriage Bolt (Part# TZ172)	(16)	(16)	(22)	(22)	(28)	(28)	(44)
5/16" Flat Washer (Part# TZ4)	(32)	(32)	(42)	(42)	(52)	(52)	(84)
5/16" Lock Nut (Part# TZ5)	(32)	(32)	(42)	(42)	(52)	(52)	(84)
3/8" X 4-1/4" Hex Bolt (Part# TZ303)	(8)	(8)	(12)	(12)	(16)	(16)	(24)
3/8" Flat Washer (Part# TZ60)	(16)	(16)	(24)	(24)	(32)	(32)	(48)
3/8" Lock Nut (Part# TZ197)	(8)	(8)	(12)	(12)	(16)	(16)	(24)

4. Attach seat swivel wheels to seat frames and seat supports.

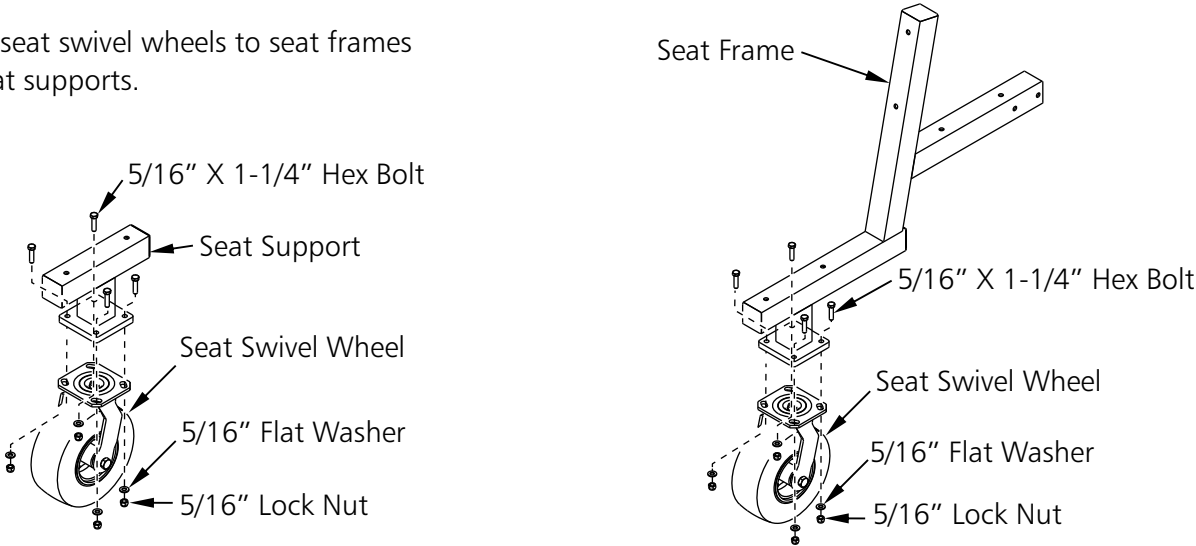

**THIS UNIT MUST BE ANCHORED ACCORDING TO THESE INSTRUCTIONS AT ALL TIMES**

**⚠WARNING**

THIS EQUIPMENT MUST BE STORED IN A SECURED, SHELTERED AREA WHEN NOT IN USE OR IN THE THREAT OF HIGH WINDS. ANY WEATHER DAMAGE TO THIS EQUIPMENT WILL NOT BE COVERED UNDER KWIK GOAL'S PRODUCT GUARANTEE. DO NOT LEAVE THIS EQUIPMENT UNATTENDED.

5. **9B5310** - skip to step 12, for all other models continue to step 6.

6. Start at each end and attach seat frame plates to assembled shelter panels as shown. Attach remaining seat frame plates to assembled shelter panels at needed locations, do not exceed two panels between seat frame plates. Do not tighten bolts at this time.

NOTE: It may be necessary to loosen panel bolts to allow frame plate bolts to be inserted.

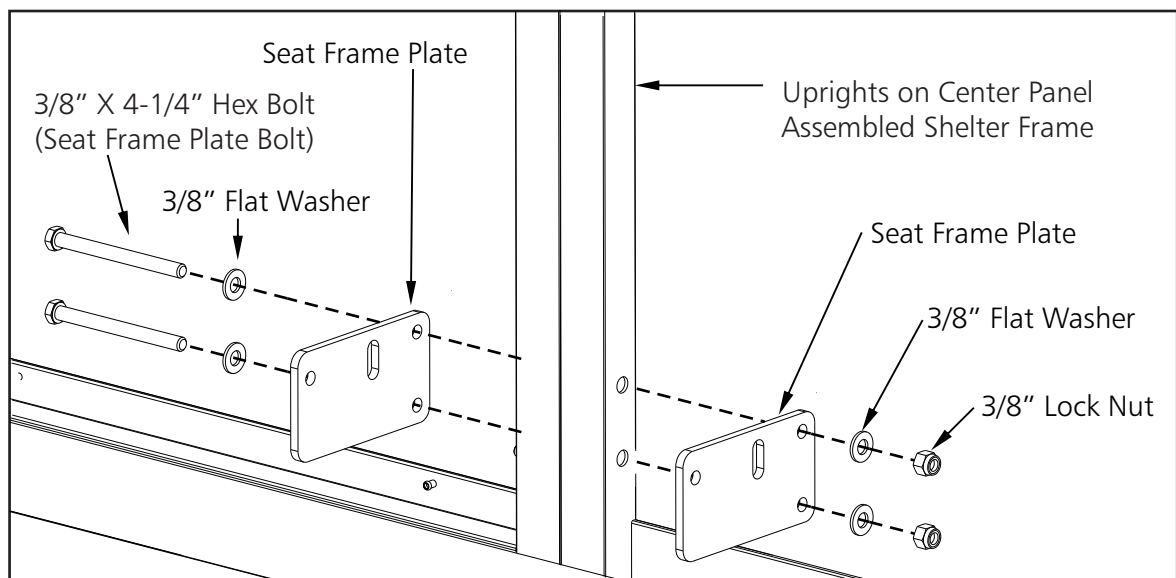
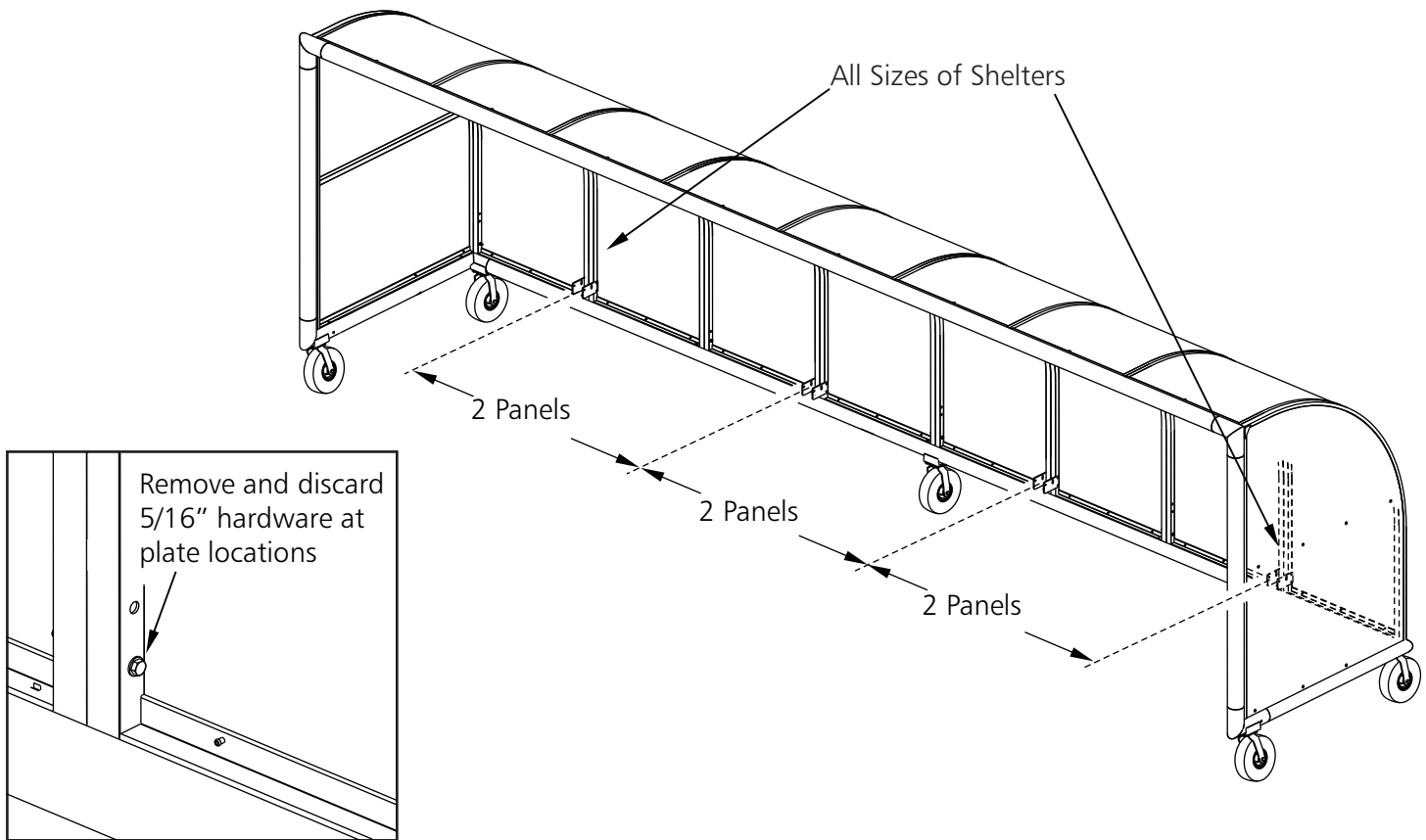

**THIS UNIT MUST BE ANCHORED ACCORDING TO THESE INSTRUCTIONS AT ALL TIMES**

**⚠ WARNING**

THIS EQUIPMENT MUST BE STORED IN A SECURED, SHELTERED AREA WHEN NOT IN USE OR IN THE THREAT OF HIGH WINDS. ANY WEATHER DAMAGE TO THIS EQUIPMENT WILL NOT BE COVERED UNDER KWIK GOAL'S PRODUCT GUARANTEE. DO NOT LEAVE THIS EQUIPMENT UNATTENDED.

7. Attach seat frames at seat frame plate locations, do not overtighten bolts.

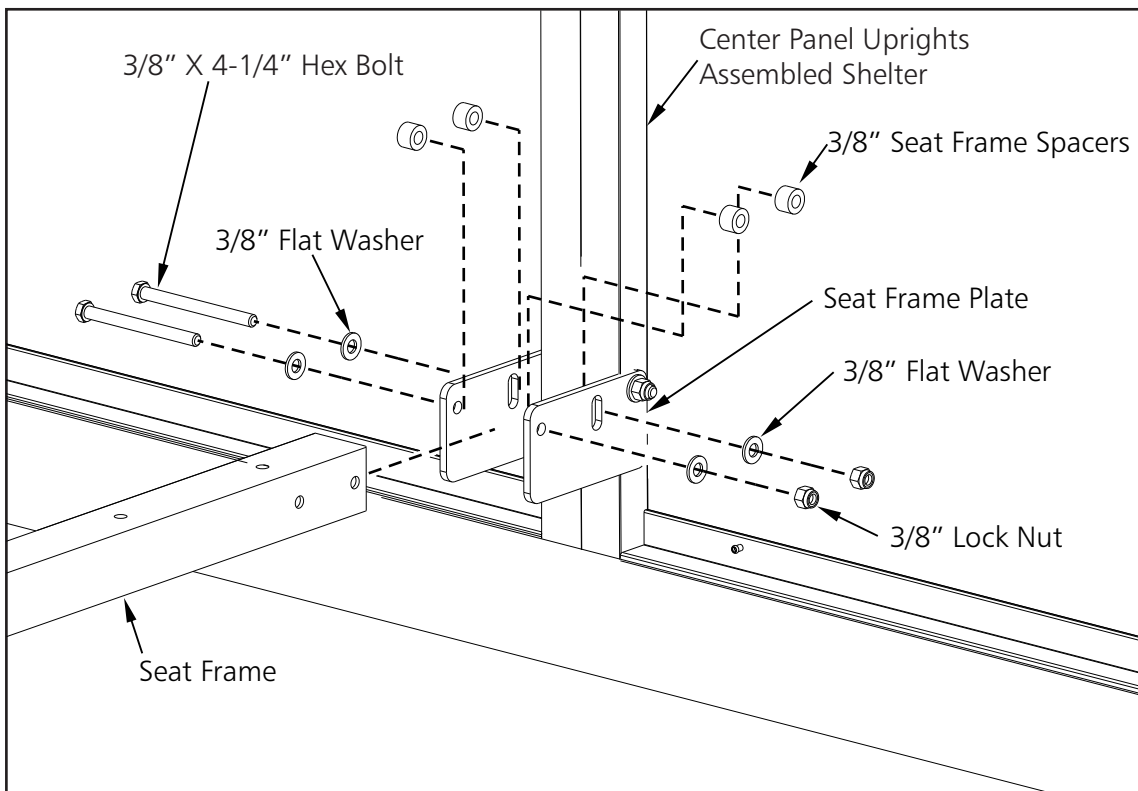
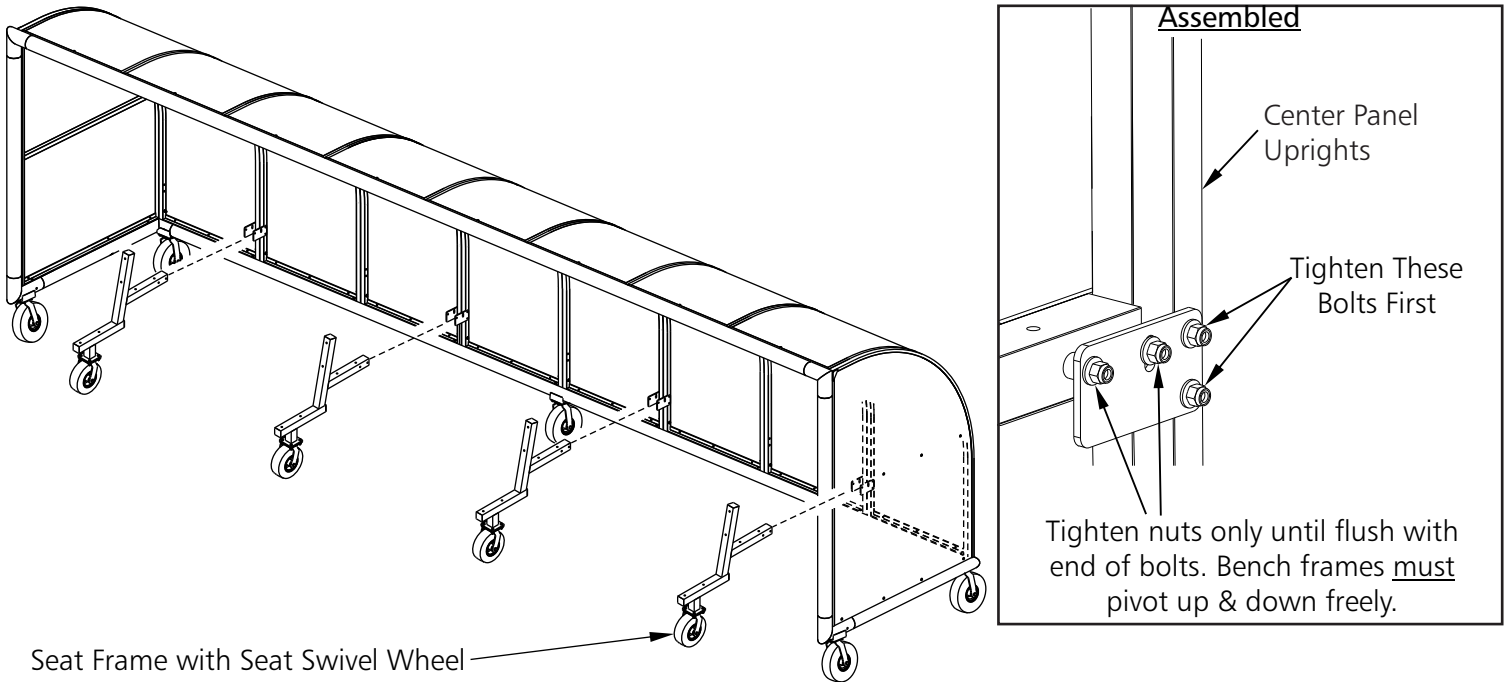

**THIS UNIT MUST BE ANCHORED ACCORDING TO THESE INSTRUCTIONS AT ALL TIMES**

**⚠ WARNING**

THIS EQUIPMENT MUST BE STORED IN A SECURED, SHELTERED AREA WHEN NOT IN USE OR IN THE THREAT OF HIGH WINDS. ANY WEATHER DAMAGE TO THIS EQUIPMENT WILL NOT BE COVERED UNDER KWIK GOAL'S PRODUCT GUARANTEE. DO NOT LEAVE THIS EQUIPMENT UNATTENDED.

8. Tighten all panel joint bolts. Begin at center joint and work outward. Tighten 3 bolts per joint. Tighten 3 panel frame bolts on each of the left and right end panels. Tighten panel to frame bolts at top and bottom of each center panel.

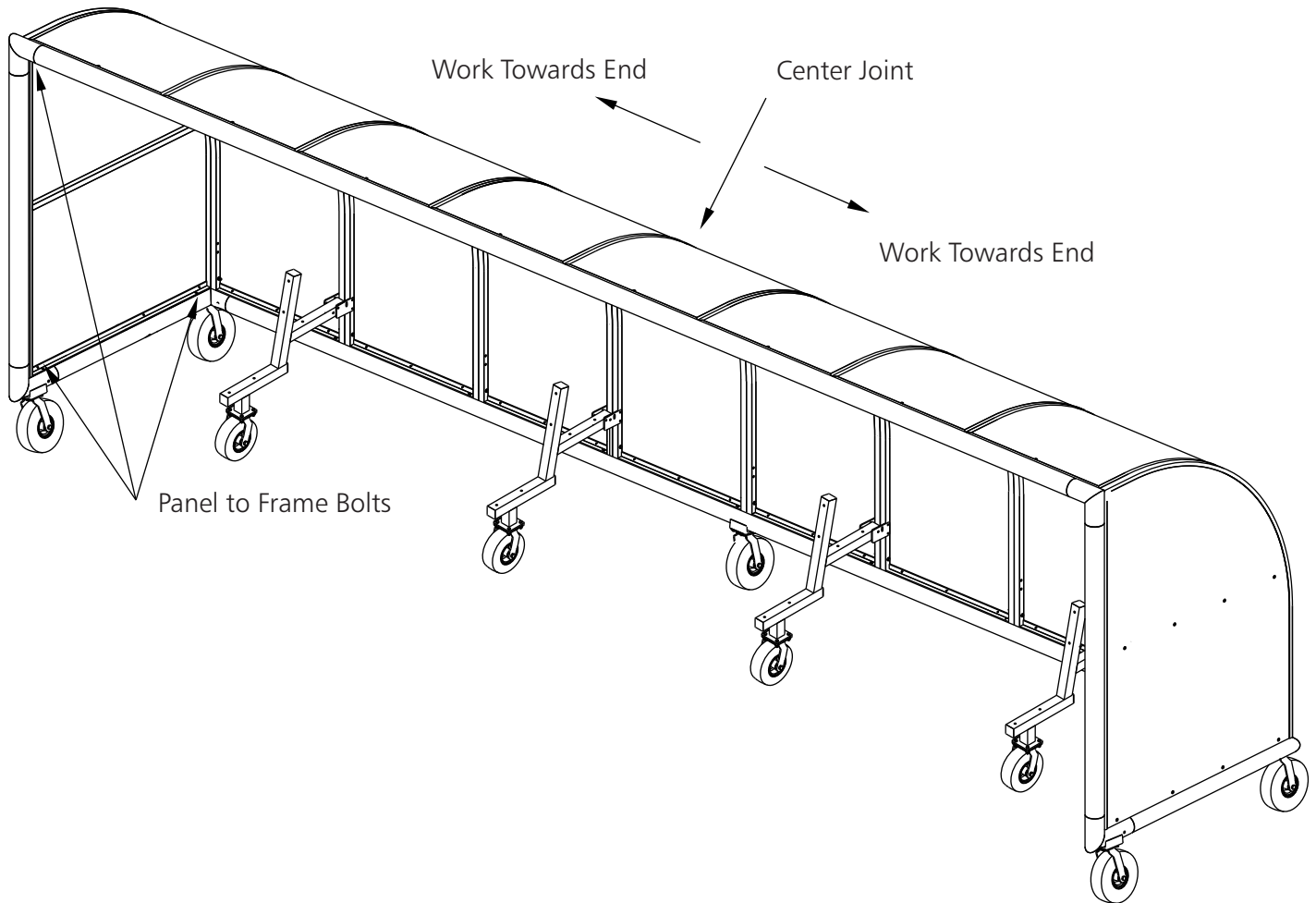

**THIS UNIT MUST BE ANCHORED ACCORDING TO THESE INSTRUCTIONS AT ALL TIMES**

**▲WARNING**

THIS EQUIPMENT MUST BE STORED IN A SECURED, SHELTERED AREA WHEN NOT IN USE OR IN THE THREAT OF HIGH WINDS. ANY WEATHER DAMAGE TO THIS EQUIPMENT WILL NOT BE COVERED UNDER KWIK GOAL'S PRODUCT GUARANTEE. DO NOT LEAVE THIS EQUIPMENT UNATTENDED.

9. Center the first bench plank at location shown. Attach bench plank to each seat frame. Align bench hold down parallel with slot in bench plank, insert, and turn ninety degrees (quarter turn) to attach bench plank to seat frame.

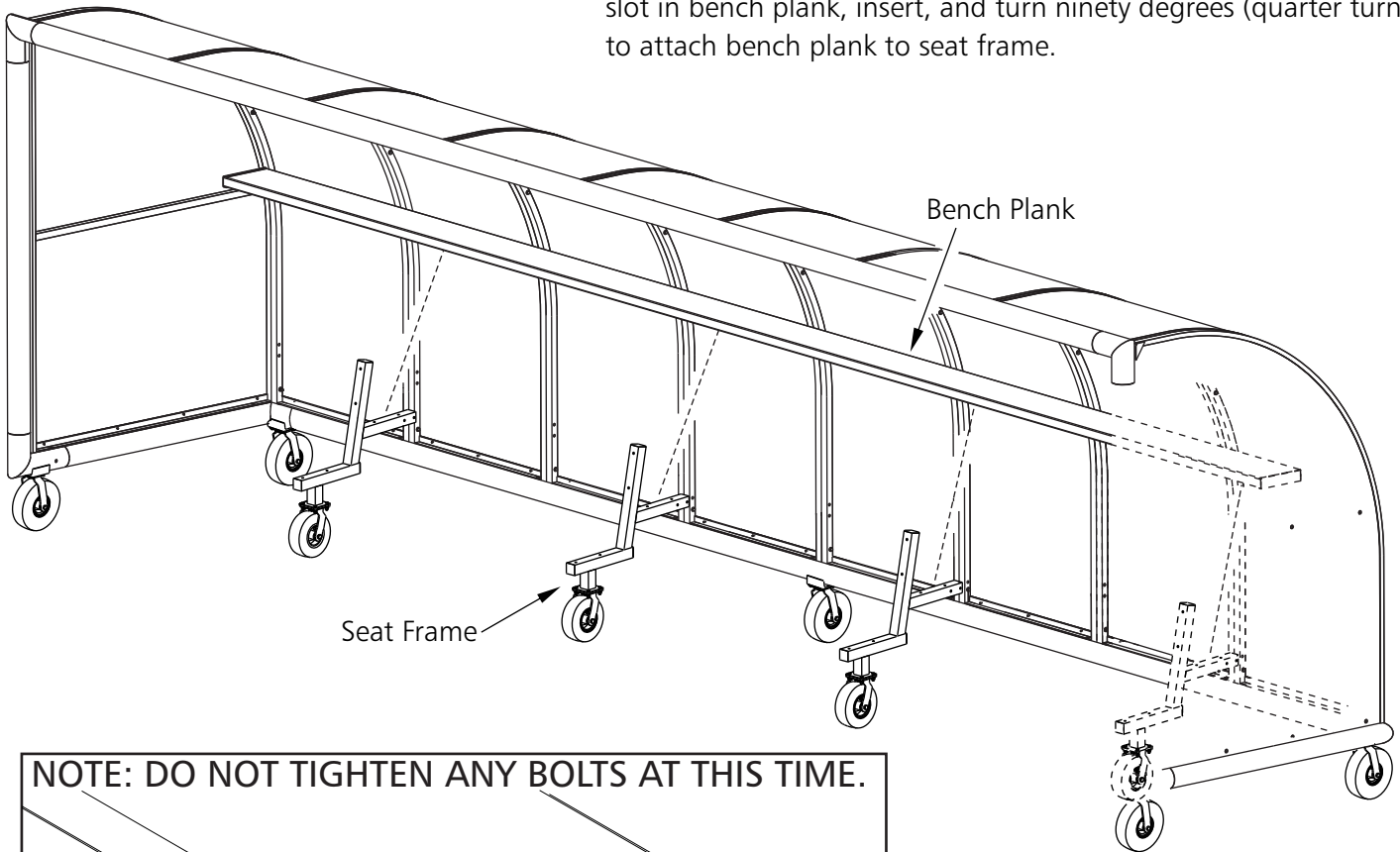

**NOTE: DO NOT TIGHTEN ANY BOLTS AT THIS TIME.**

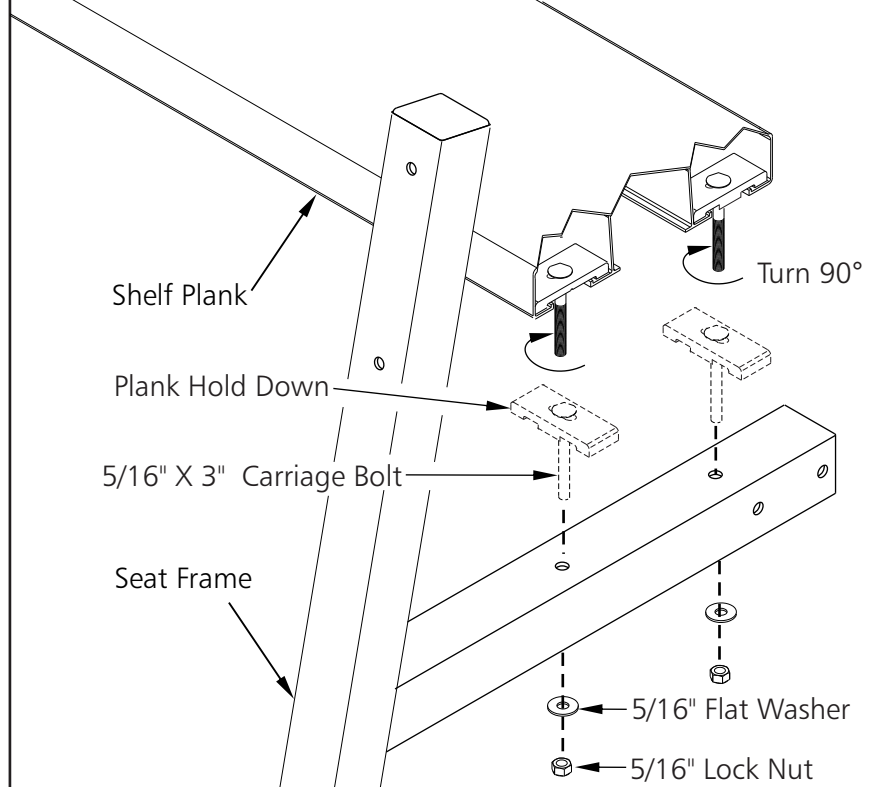

**THIS UNIT MUST BE ANCHORED ACCORDING TO THESE INSTRUCTIONS AT ALL TIMES**

**⚠WARNING**

THIS EQUIPMENT MUST BE STORED IN A SECURED, SHELTERED AREA WHEN NOT IN USE OR IN THE THREAT OF HIGH WINDS. ANY WEATHER DAMAGE TO THIS EQUIPMENT WILL NOT BE COVERED UNDER KWIK GOAL'S PRODUCT GUARANTEE. DO NOT LEAVE THIS EQUIPMENT UNATTENDED.



10. Center and attach second bench plank to seat frames, also attach seat support to second bench plank at locations shown.

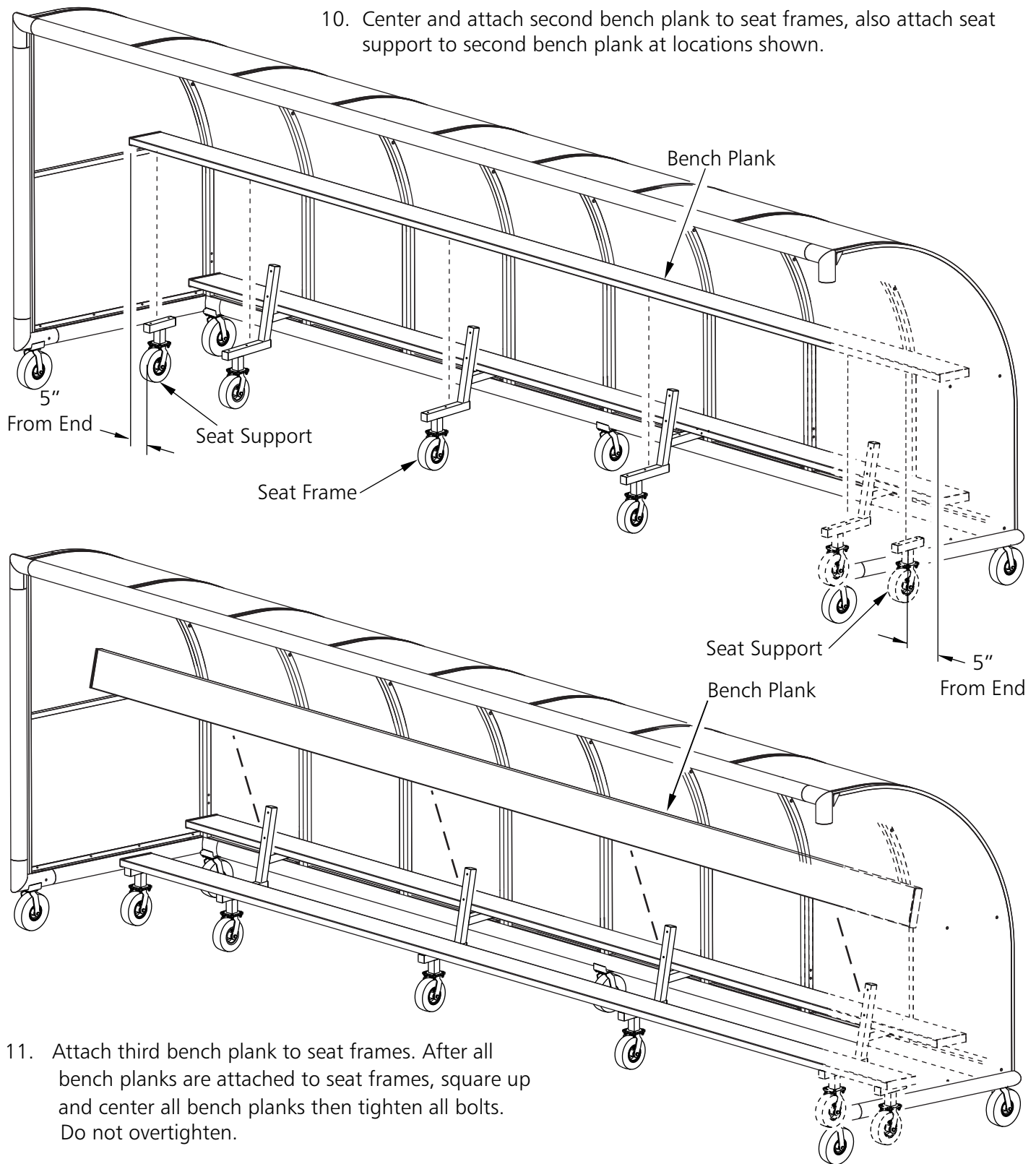

11. Attach third bench plank to seat frames. After all bench planks are attached to seat frames, square up and center all bench planks then tighten all bolts. Do not overtighten.

**THIS UNIT MUST BE ANCHORED ACCORDING TO THESE INSTRUCTIONS AT ALL TIMES**

**▲WARNING**

THIS EQUIPMENT MUST BE STORED IN A SECURED, SHELTERED AREA WHEN NOT IN USE OR IN THE THREAT OF HIGH WINDS. ANY WEATHER DAMAGE TO THIS EQUIPMENT WILL NOT BE COVERED UNDER KWIK GOAL'S PRODUCT GUARANTEE. DO NOT LEAVE THIS EQUIPMENT UNATTENDED.

12. Start at each end and attach seat frame plates to assembled shelter panels as shown. Attach remaining seat frame plates to assembled shelter panels at needed locations, do not exceed two panels between seat frame plates. Do not tighten bolts at this time.  
NOTE: It may be necessary to loosen panel bolts to allow frame plate bolts to be inserted.

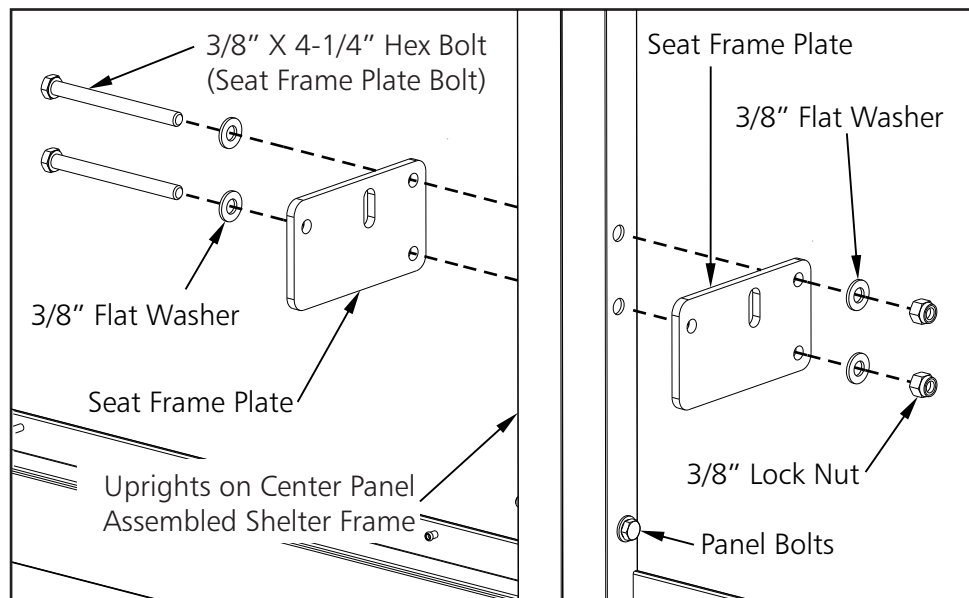
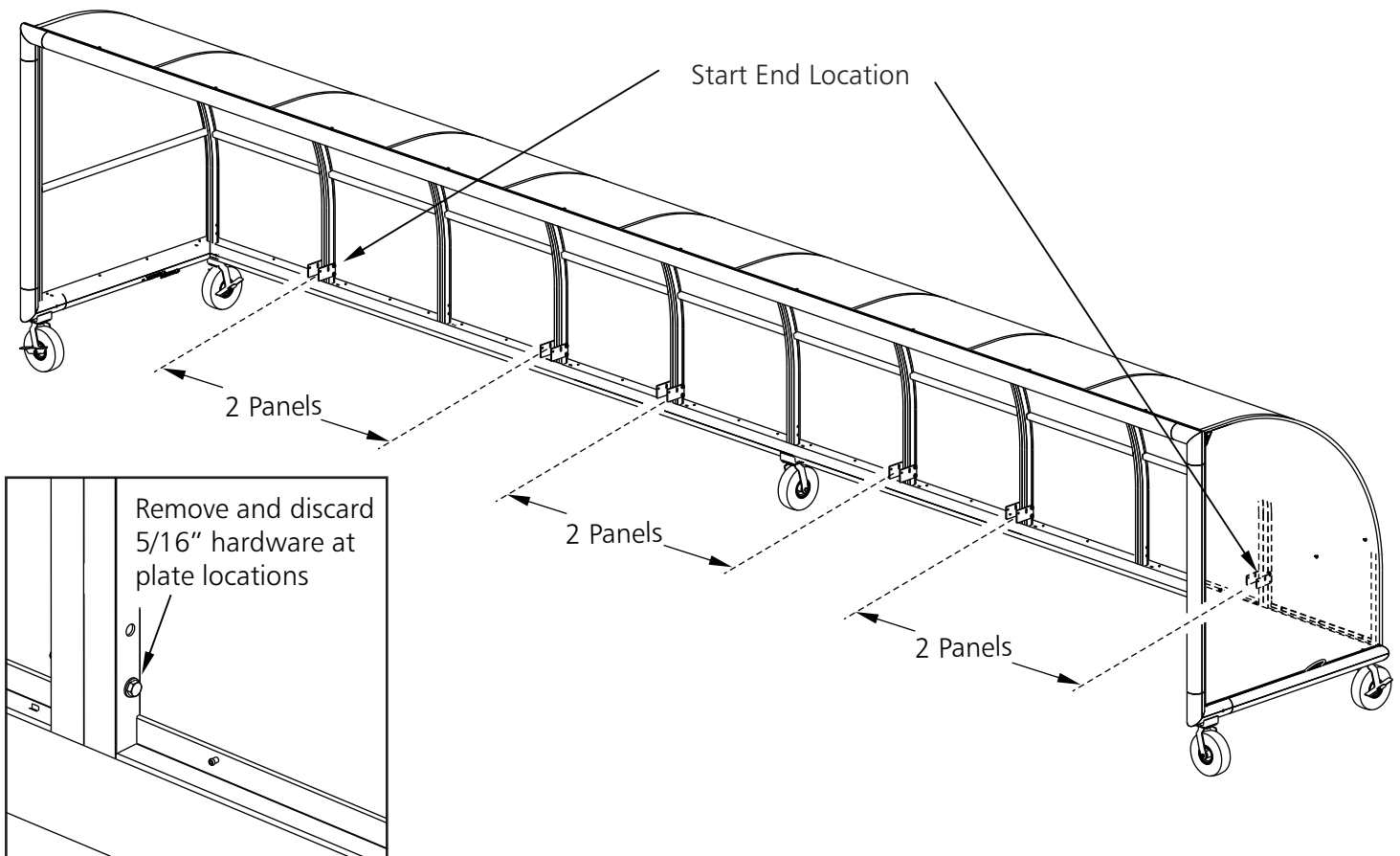

**THIS UNIT MUST BE ANCHORED ACCORDING TO THESE INSTRUCTIONS AT ALL TIMES**

**⚠WARNING**

THIS EQUIPMENT MUST BE STORED IN A SECURED, SHELTERED AREA WHEN NOT IN USE OR IN THE THREAT OF HIGH WINDS. ANY WEATHER DAMAGE TO THIS EQUIPMENT WILL NOT BE COVERED UNDER KWIK GOAL'S PRODUCT GUARANTEE. DO NOT LEAVE THIS EQUIPMENT UNATTENDED.

13. Attach seat frames at seat frame plate locations, do not overtighten bolts.

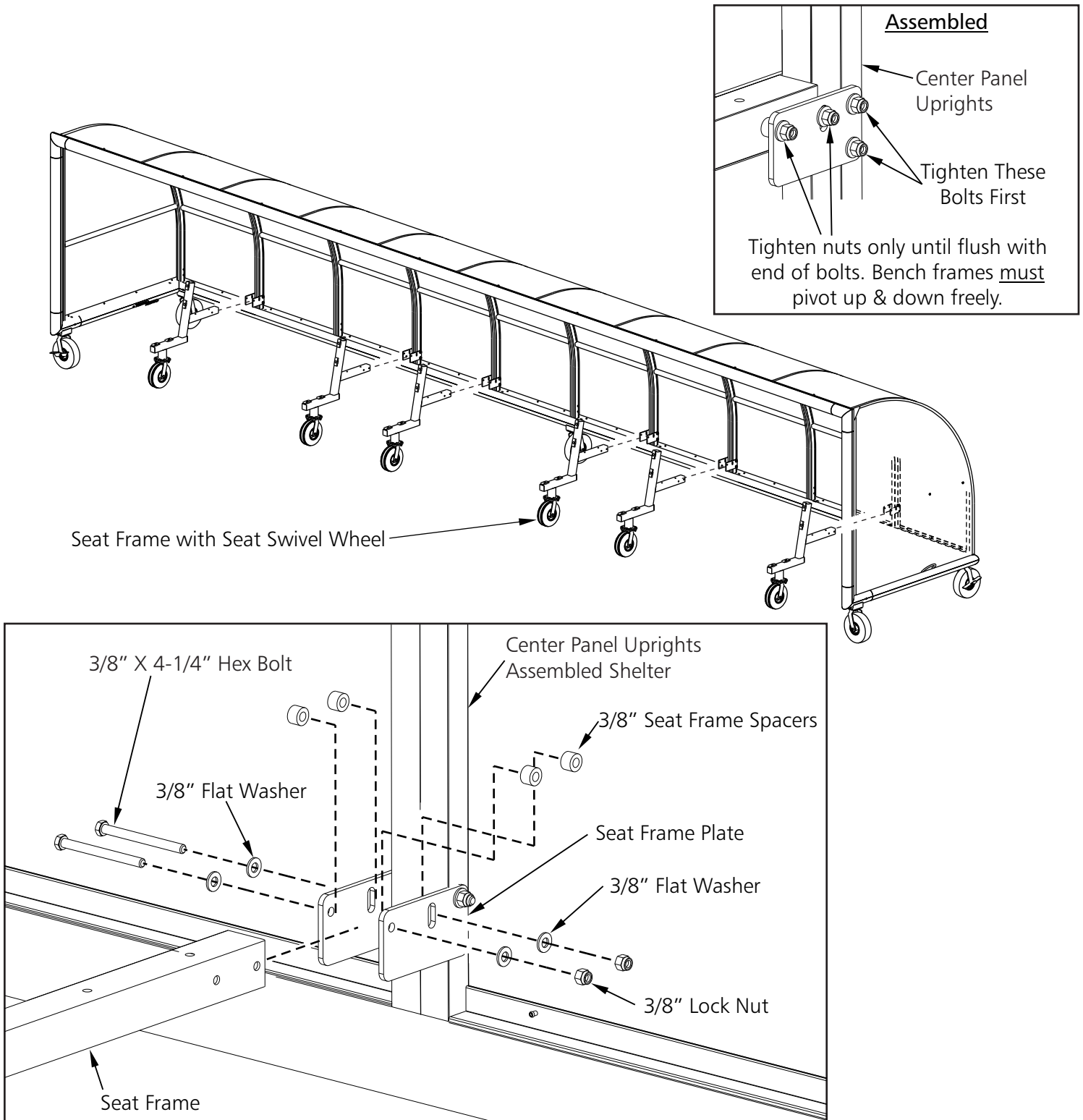

**THIS UNIT MUST BE ANCHORED ACCORDING TO THESE INSTRUCTIONS AT ALL TIMES**

**⚠ WARNING**

THIS EQUIPMENT MUST BE STORED IN A SECURED, SHELTERED AREA WHEN NOT IN USE OR IN THE THREAT OF HIGH WINDS. ANY WEATHER DAMAGE TO THIS EQUIPMENT WILL NOT BE COVERED UNDER KWIK GOAL'S PRODUCT GUARANTEE. DO NOT LEAVE THIS EQUIPMENT UNATTENDED.

14. Tighten all panel joint bolts. Begin at center joint and work outward. Tighten 3 bolts per joint. Tighten 3 panel frame bolts on each of the left and right end panels. Tighten panel to frame bolts at top and bottom of each center panel.

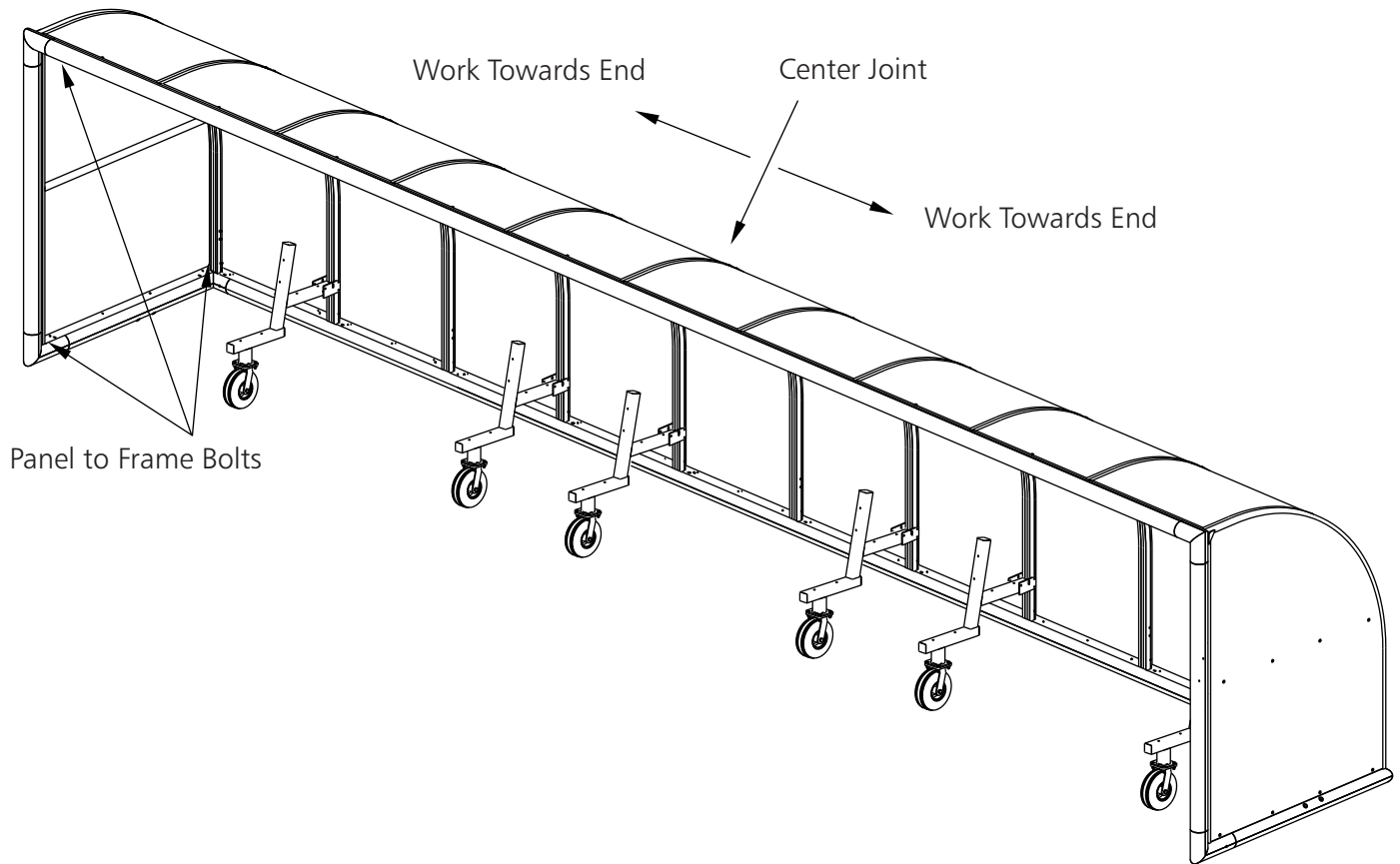

**THIS UNIT MUST BE ANCHORED ACCORDING TO THESE INSTRUCTIONS AT ALL TIMES**

**▲WARNING**

THIS EQUIPMENT MUST BE STORED IN A SECURED, SHELTERED AREA WHEN NOT IN USE OR IN THE THREAT OF HIGH WINDS. ANY WEATHER DAMAGE TO THIS EQUIPMENT WILL NOT BE COVERED UNDER KWIK GOAL'S PRODUCT GUARANTEE. DO NOT LEAVE THIS EQUIPMENT UNATTENDED.

15. Center the first two bench planks between side panels. Leave 5" of space between planks. Attach bench plank to each seat frame. Align bench hold down parallel with slot in bench plank, insert, and turn ninety degrees (quarter turn) to attach bench plank to seat frame.

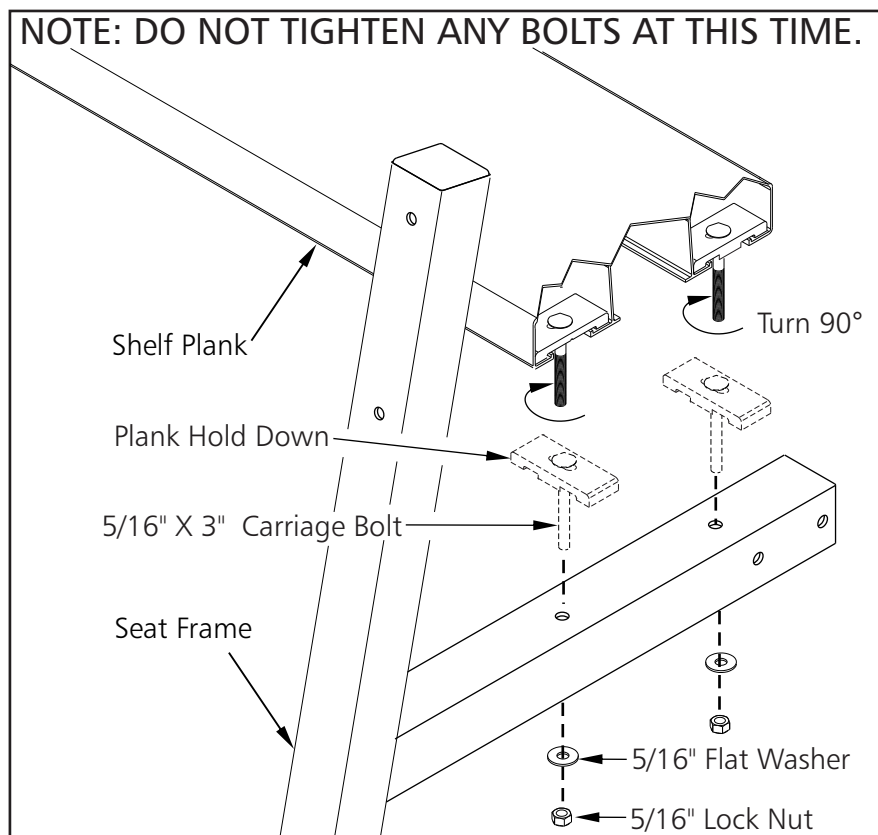
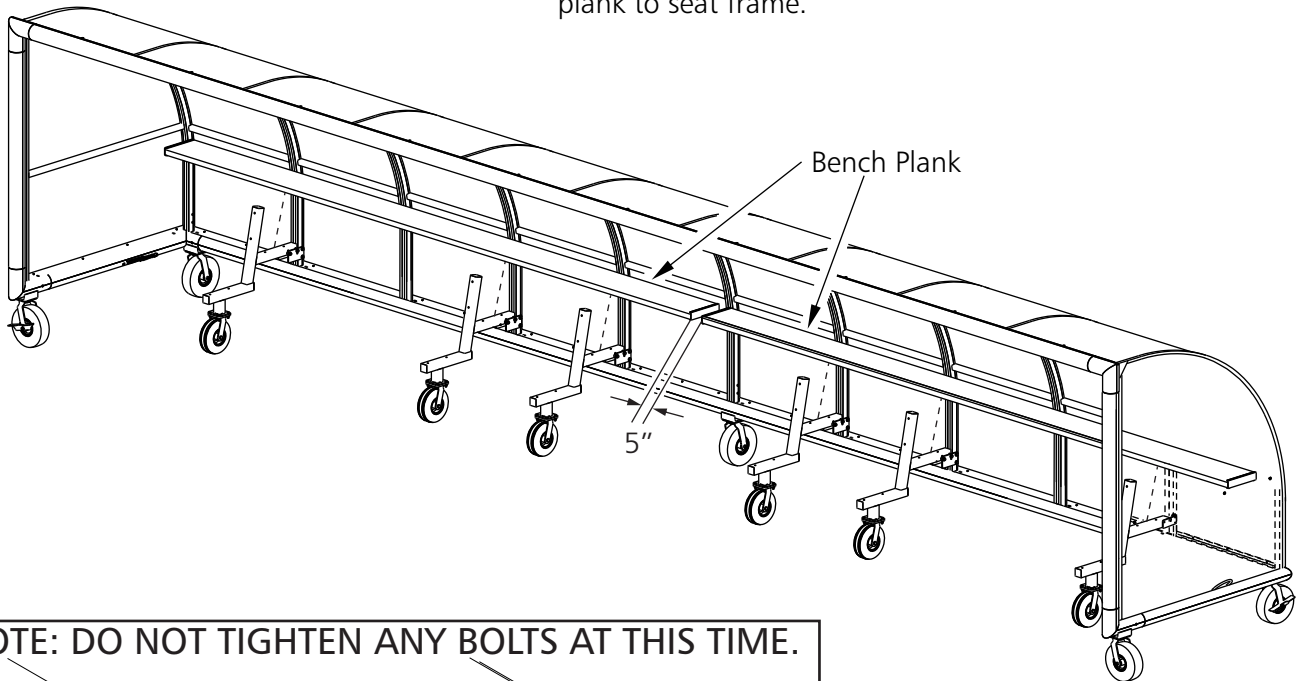

**THIS UNIT MUST BE ANCHORED ACCORDING TO THESE INSTRUCTIONS AT ALL TIMES**

**⚠ WARNING**

THIS EQUIPMENT MUST BE STORED IN A SECURED, SHELTERED AREA WHEN NOT IN USE OR IN THE THREAT OF HIGH WINDS. ANY WEATHER DAMAGE TO THIS EQUIPMENT WILL NOT BE COVERED UNDER KWIK GOAL'S PRODUCT GUARANTEE. DO NOT LEAVE THIS EQUIPMENT UNATTENDED.

16. Center and attach third and fourth bench planks to seat frames. Leave 5" of space between planks. Also attach seat supports to ends of planks.

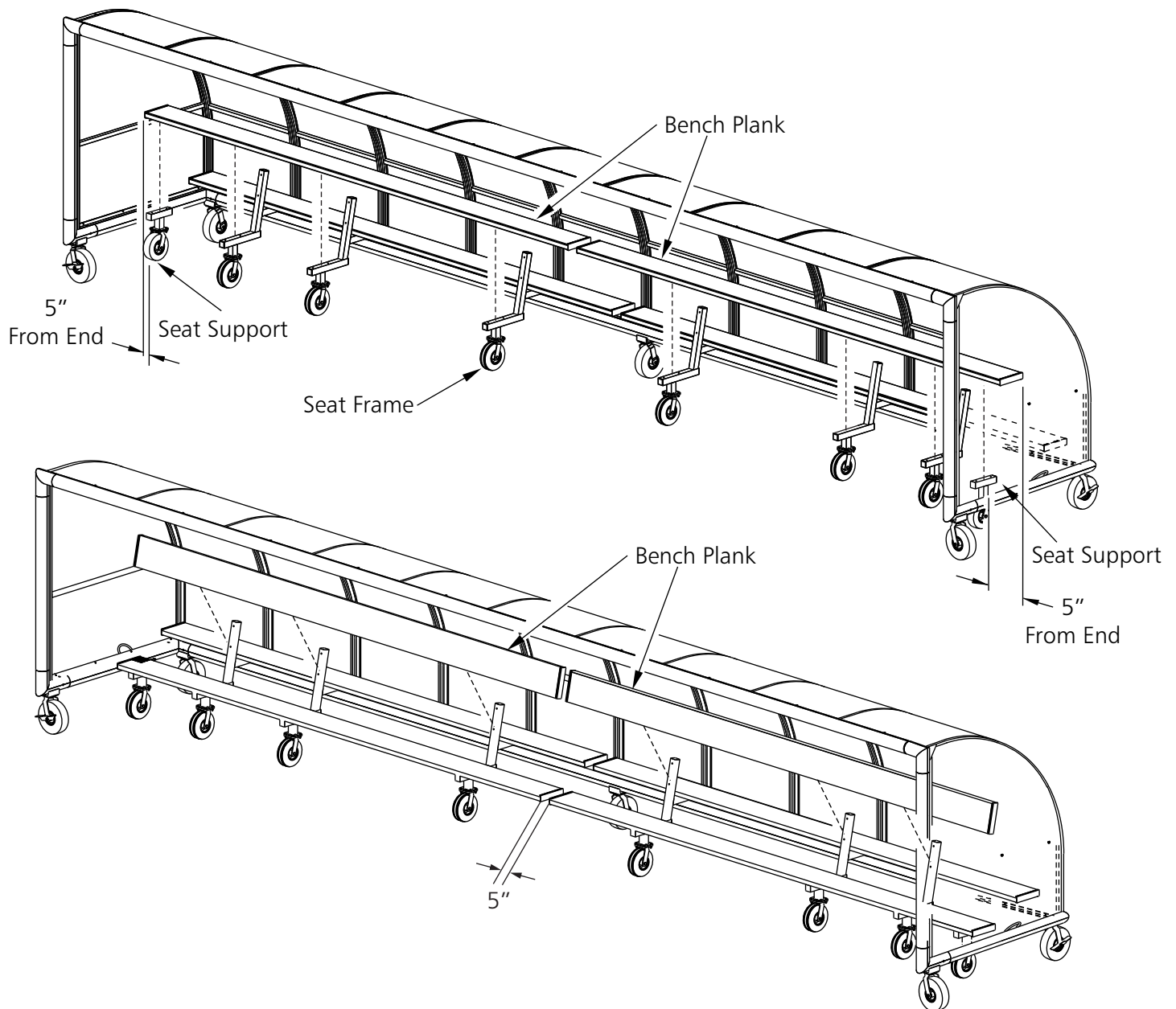

17. Attach fifth and sixth bench planks to seat frames. Leave 5" of space between planks. After all bench planks are attached to seat frames, square up and center all bench planks then tighten all bolts. Do not overtighten.

Go to [kwikgoal.com](http://kwikgoal.com) for additional product information.

**THIS UNIT MUST BE ANCHORED ACCORDING TO THESE INSTRUCTIONS AT ALL TIMES**

**▲WARNING**

THIS EQUIPMENT MUST BE STORED IN A SECURED, SHELTERED AREA WHEN NOT IN USE OR IN THE THREAT OF HIGH WINDS. ANY WEATHER DAMAGE TO THIS EQUIPMENT WILL NOT BE COVERED UNDER KWIK GOAL'S PRODUCT GUARANTEE. DO NOT LEAVE THIS EQUIPMENT UNATTENDED.