



Most Kwik Goal products carry a **Lifetime Guarantee**. For details or claims, visit **kwikgoal.com** or contact customer service at 1-800-531-4252.

ASSEMBLY INSTRUCTIONS FOR 16A3501 V.A.T. BOARD

1. Unpack all parts and check for damage that may have occurred during shipping. Lay out all parts. Remove all cardboard and packaging immediately. Wet or damp packaging may damage contents.
2. Read through entire instruction before beginning assembly and installation.

Parts

Board (1)
(Part# UZ1383)

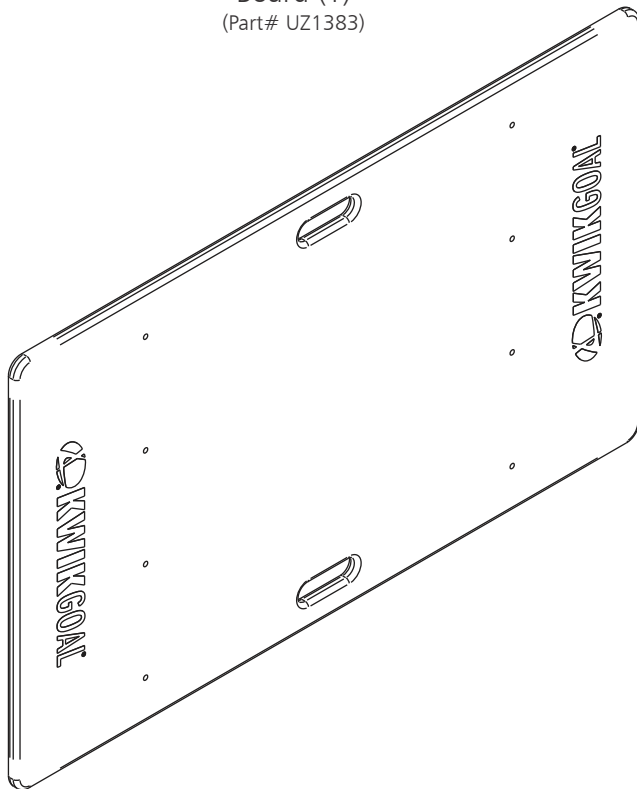

Ground Anchor (2)
(Part# 10B1201 Pack of 4)

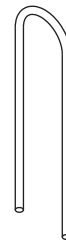

Frame (2)
(Part# UZ1424)

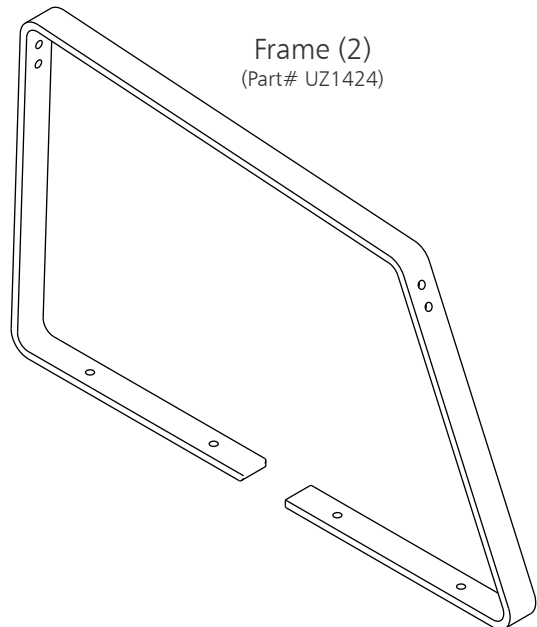

140 Pacific Drive Quakertown, PA 18951
(P) 215-536-2200 / (P) 800-531-4252 / (F) 215-536-4309 / (F) 800-778-8869
Visit our website @ **kwikgoal.com**
© 2014 Kwik Goal Ltd.

Hardware

Note: Hardware may be packaged separately in one or more boxes. Open all packages before beginning assembly.

1/4" Lock Washer (Part# TZ362)	(8)
1/4" Flat Washer (Part# TZ361)	(8)
1/4" Hex Nut (Part# TZ357)	(8)
1/4" X 1-1/2" Sidewalk Bolt (Part# TZ355)	(8)
5/16" Lock Washer (Part# TZ174)	(4)
5/16" X 3/4" Button Head Screw (Part# TZ356)	(4)
Rubber Bumper (Part# VZ658)	(4)

Assembly Tools

7/16" Wrench

#2 Phillips
Screwdriver

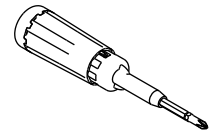
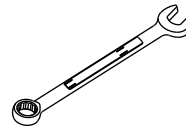

3/16" Hex Wrench

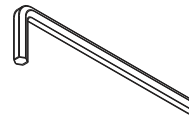

3. Assemble and tighten two rubber bumpers on each frame.

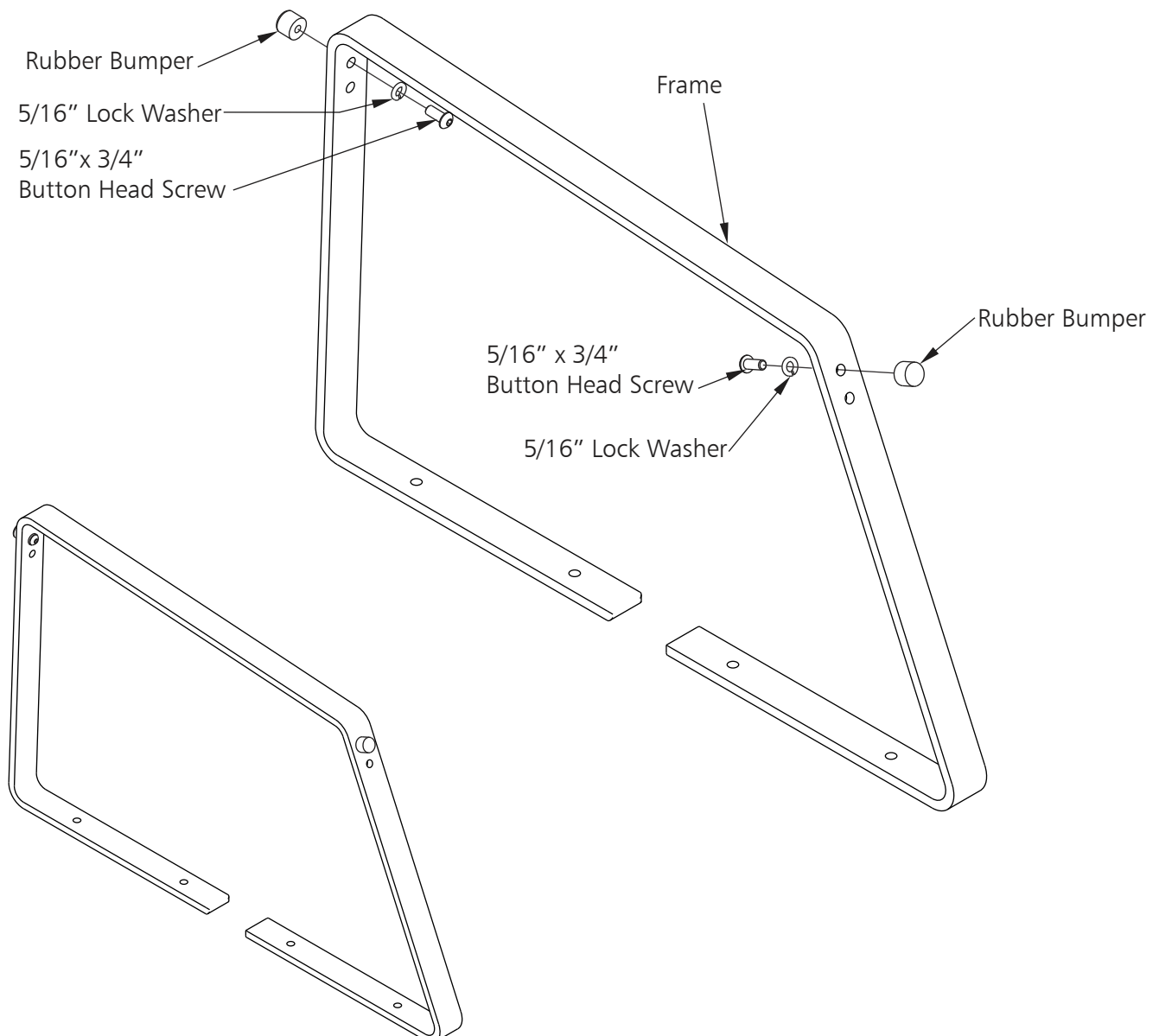

4. Attach assembled frames to board. DO NOT tighten hardware.
5. With assembled V.A.T. Board sitting on hard, flat surface, tighten eight sidewalk bolts (board to frames).

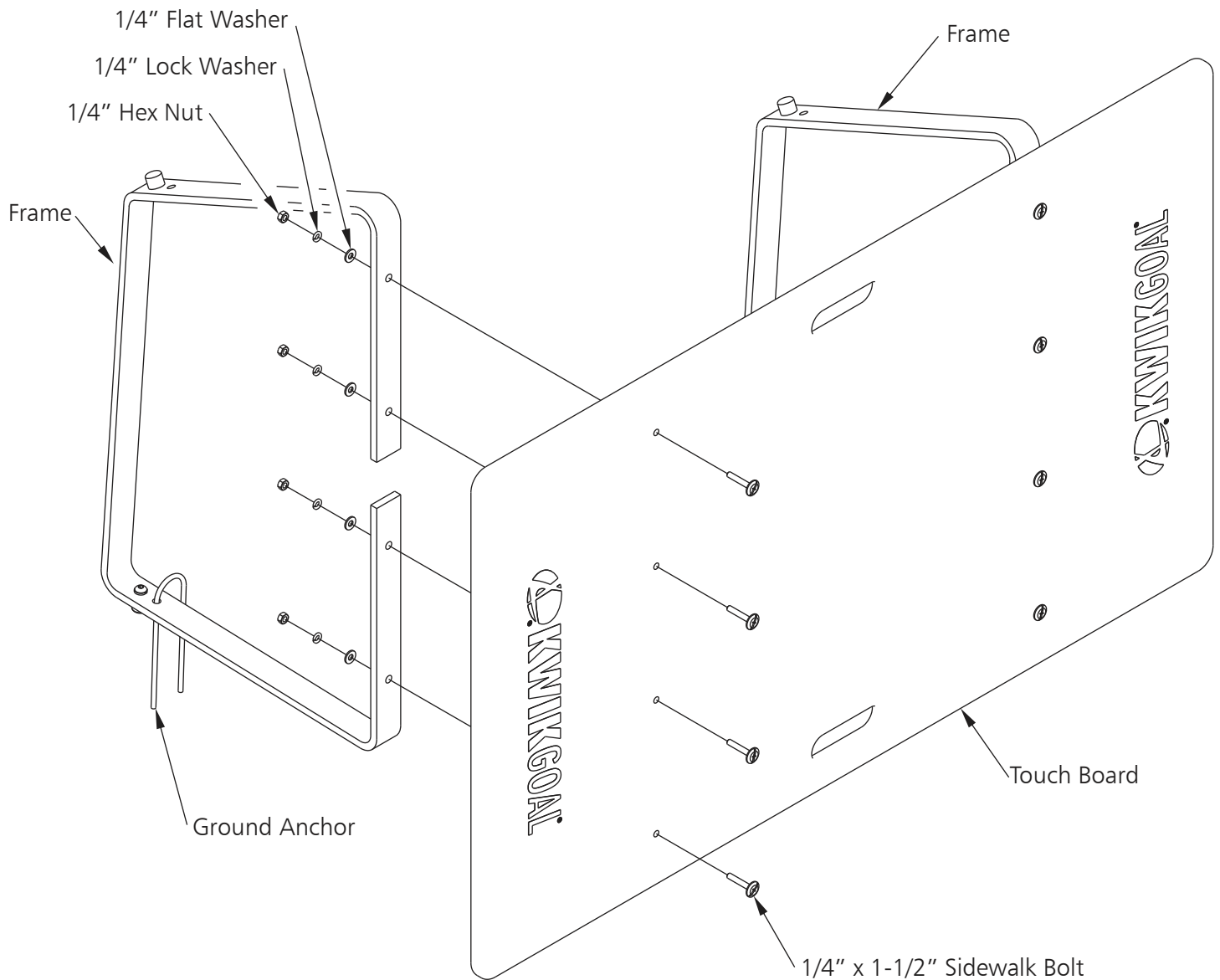

6. Simply turn V.A.T. Board over to change from flat to angled rebounding surface.

Flat Rebounding Surface

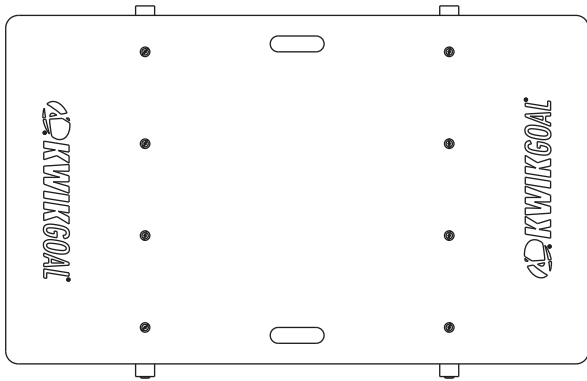

Angled Rebounding Surface

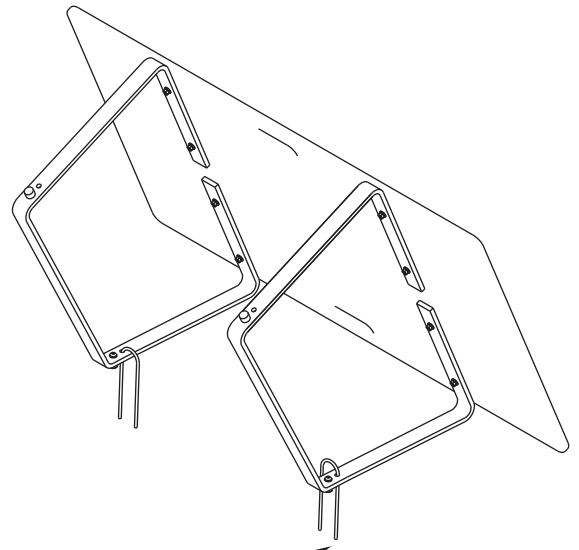
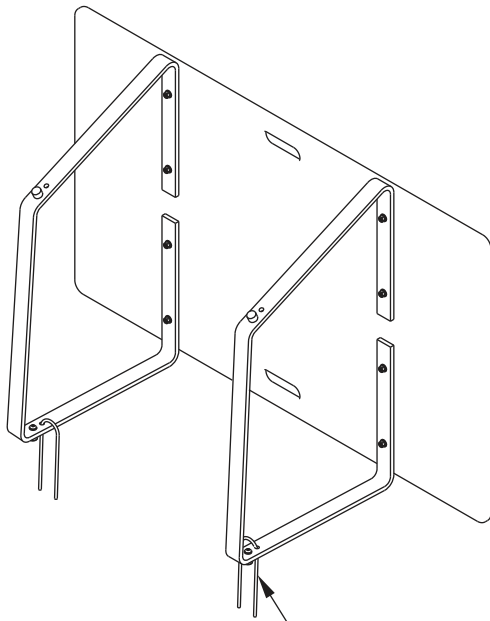
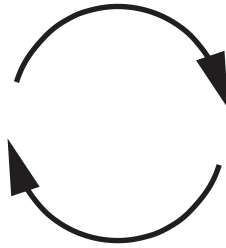
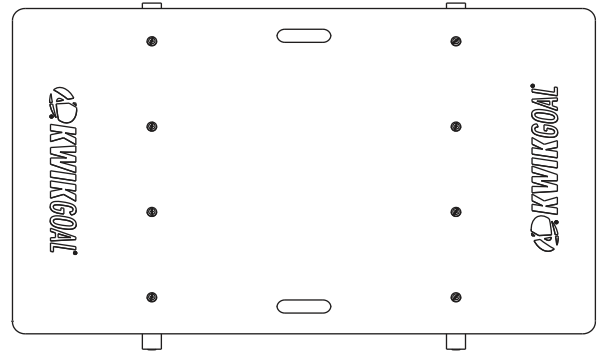

Ground Anchors are supplied to secure the V.A.T. Board to the ground for optimal performance.

To view videos on Kwik Goal product instructions, drills and demos please visit kwikgoal.com/videos.