



ASSEMBLY INSTRUCTIONS FOR ALL 9B55 PORTABLE ONLY SHELTER FRAMES

THIS UNIT MUST BE ASSEMBLED BY A MINIMUM OF TWO QUALIFIED PERSONS

NOTICE Sunlight reflecting off polycarbonate panels can contribute to increased temperatures of surrounding objects. In certain situations, these increased temperatures can damage some artificial turf surfaces. Kwik Goal is not responsible for any damage to artificial turf.

1. Unpack all parts and check for damage that may have occurred during shipping. If damage has occurred, notify Kwik Goal immediately. Lay out all parts. Remove all cardboard and packaging immediately. Wet or damp packaging may damage contents.
2. Read through entire instruction before beginning assembly and installation.

NOTE: Components may be packaged in one or more additional boxes.

Parts

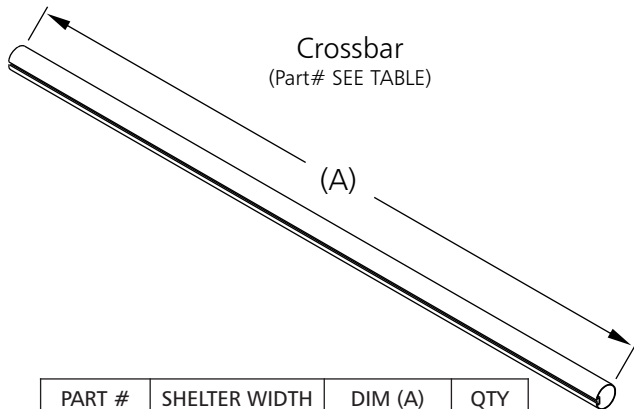

PART #	SHELTER WIDTH	DIM (A)	QTY
UZ1559	30'	362-3/8"	1
UZ1116	24'	287-3/4"	1
UZ1433	21'	250-7/16"	1
UZ1434	18'	213-1/8"	2
UZ1435	15'	175-13/16"	2
UZ1436	12'	138-1/2"	2
UZ1114	9'	101-3/16"	2

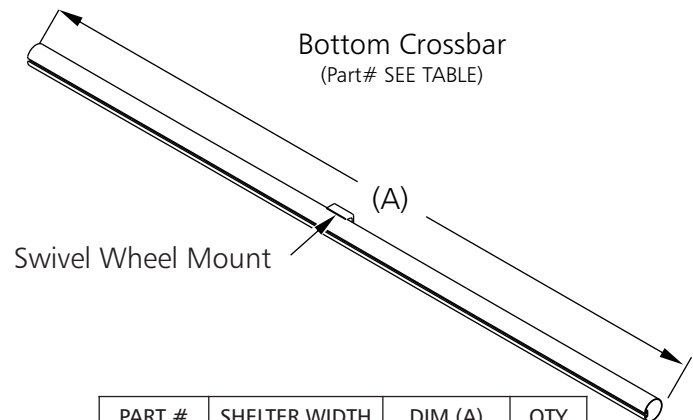

PART #	SHELTER WIDTH	DIM (A)	QTY
UZ1577	30'	362-3/8"	1
UZ1444	24'	287-3/4"	1
UZ1443	21'	250-7/16"	1

THIS UNIT MUST BE ANCHORED ACCORDING TO THESE INSTRUCTIONS AT ALL TIMES

⚠WARNING

THIS EQUIPMENT MUST BE STORED IN A SECURED, SHELTERED AREA WHEN NOT IN USE OR IN THE THREAT OF HIGH WINDS. ANY WEATHER DAMAGE TO THIS EQUIPMENT WILL NOT BE COVERED UNDER KWIK GOAL'S PRODUCT GUARANTEE. DO NOT LEAVE THIS EQUIPMENT UNATTENDED.



⚠ WARNING **IMPORTANT SAFETY INSTRUCTIONS**
READ CAREFULLY

1. Lifting and moving heavy field equipment can be dangerous if not done properly. All Kwik Goal shelters must be moved by qualified personnel who are experienced in moving large, heavy field equipment.
2. A minimum of four qualified, experienced people are required to move shelter.
3. Do not attempt to lift or move shelter in windy conditions.
4. Shelters must not be left unattended and unsecured.
5. Shelter must be on level, flat ground at all times.
6. Use extreme caution when pushing shelter. Excessive force can overturn shelter. Always push at lowest point on shelter frame possible.
7. Do not push shelter directly from the front to rear or rear to front. Push from end to end.

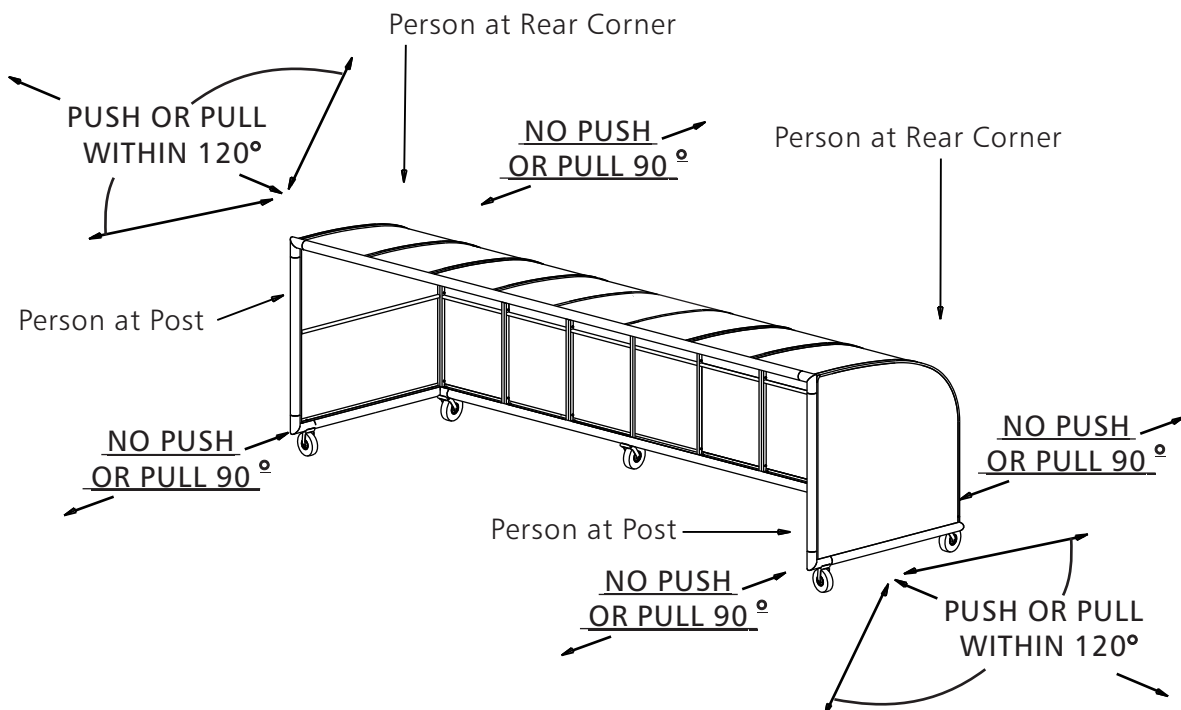

NEVER LEAVE SHELTERS UNATTENDED AND UNSECURED

Parts Continued

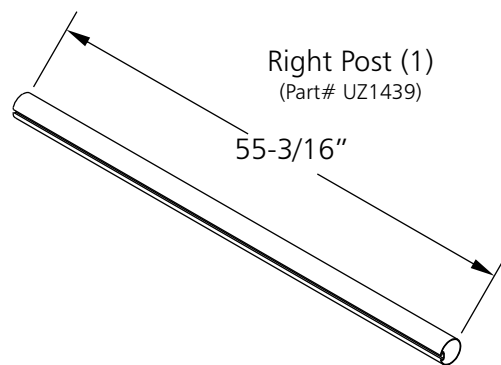
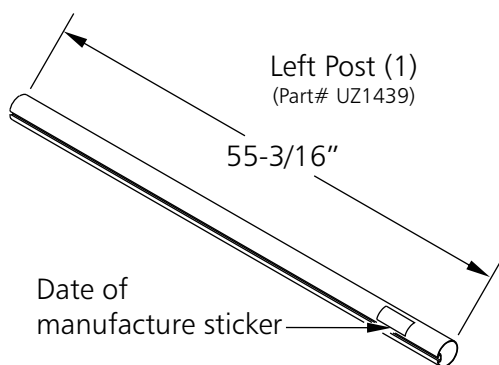

Crossbar Corner (2)
(Part# UZ1211)

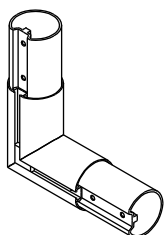

Post Corner (2)
(Part# UZ1442)

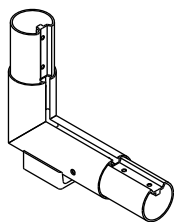

Left Base (1)
(Part# UZ1611)

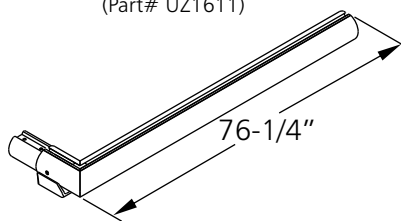

Right Base (1)
(Part# UZ1610)

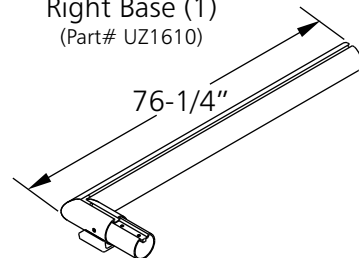

Center Panel (SEE TABLE)
(Part# UZ1612)

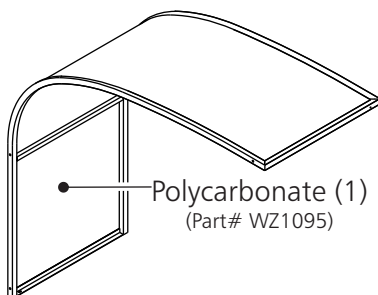

SHELTER WIDTH	QTY
30'	10
24'	8
21'	7
18'	6
15'	5
12'	4
9'	3

Left Panel (1)
(Part# UZ1614)

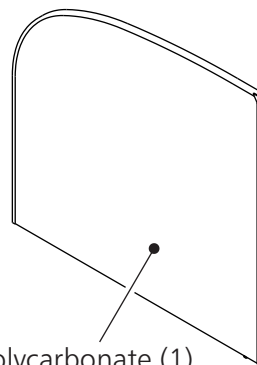

Right Panel (1)
(Part# UZ1613)

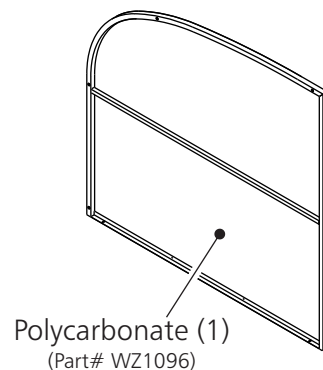

Swivel Wheel (SEE TABLE)
(Part# VZ629)

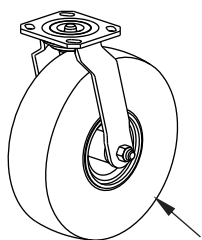

SHELTER WIDTH	QTY
30'	3
24'	3
21'	3
18'	2
15'	2
12'	2
9'	2

Swivel Wheel w/ Brake (2)
(Part# VZ747)

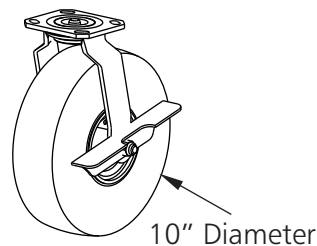

THIS UNIT MUST BE ANCHORED ACCORDING TO THESE INSTRUCTIONS AT ALL TIMES

⚠ WARNING

THIS EQUIPMENT MUST BE STORED IN A SECURED, SHELTERED AREA WHEN NOT IN USE OR IN THE THREAT OF HIGH WINDS. ANY WEATHER DAMAGE TO THIS EQUIPMENT WILL NOT BE COVERED UNDER KWIK GOAL'S PRODUCT GUARANTEE. DO NOT LEAVE THIS EQUIPMENT UNATTENDED.

Note: Hardware is packed separately in one or more boxes.
Open all boxes and layout all sealed hardware packs
before beginning assembly.

Frame Hdw (Part# JZ190)

3/8" X 1" Socket Head (Part# TZ323)	(20)
3/8" Lock Washer (Part# TZ65)	(20)
5/16" Lock Washer (Part# TZ174)	(20)
5/16" x 1" Hex Bolt (Part# TZ330)	(20)
5/16" Flat Washer (Part# TZ4)	(20)

Anchor Hdw (Part# JZ217)

7/16" Flat Washer (Part# TZ171)	(8)
7/16" X 5" Hex Bolt (Part# TZ307)	(4)
7/16" Lock Nut (Part# TZ47)	(4)
1/4" X 12 1/2" Chain (Part# VZ564-12)	(4)
1/4" X 3 1/2" Chain (Part# VZ564-3)	(4)
7/16" Snap Link (Part# VZ737)	(4)

Panel Hdw (Part# JZ202 JZ228)

	<u>9ft</u>	<u>12ft</u>	<u>15ft</u>	<u>18ft</u>	<u>21ft</u>	<u>24ft</u>	<u>30ft</u>
3/8" X 7/8" Hex Bolt (Part# TZ249)	(5)	(6)	(7)	(8)	(9)	(8)	(12)
3/8" X 2-1/4" Hex Bolt (Part# TZ305)	(7)	(8)	(9)	(10)	(11)	(10)	(14)
3/8" Square Nut (Part# TZ247)	(12)	(14)	(16)	(18)	(20)	(18)	(26)
3/8" Lock Washer (Part# TZ65)	(12)	(14)	(16)	(18)	(20)	(18)	(26)
3/8" Flat Washer (Part# TZ60)	(12)	(14)	(16)	(18)	(20)	(18)	(26)
5/16" X 3-3/4" Hex Bolt (Part# TZ264)	(8)	(12)	(16)	(20)	(24)	(15)	(36)
5/16" Lock Nut (Part# TZ5)	(16)	(20)	(24)	(28)	(32)	(21)	(44)
5/16" Flat Washer (Part# TZ4)	(24)	(32)	(40)	(48)	(56)	(36)	(76)
5/16 X 3" Double End Stud (Part# TZ273)	(8)	(8)	(8)	(8)	(8)	(6)	(8)

Snap Link (4)
(Part# VZ737)

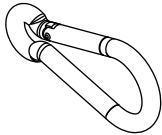

Ground Anchor (4)
(Part# 10B103 Pack of 4)

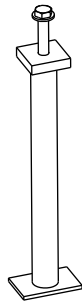

12 1/2" L
Chain (See Anchor Hdw)
(Part# VZ564-12)

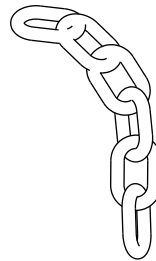

3 1/2" L
Chain (See Anchor Hdw)
(Part# VZ564-3)



Assembly Tools

1/2", 5/8", 9/16", 3/4"
Wrenches

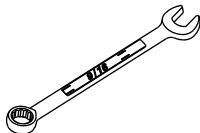

Ratchet with
1/2", 5/8", 9/16", 3/4" Sockets

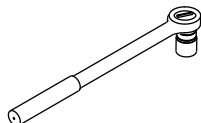

5/16" Hex wrench



Polyurethane Sealant
(Part# VZ837)



THIS UNIT MUST BE ANCHORED ACCORDING TO THESE INSTRUCTIONS AT ALL TIMES

WARNING

THIS EQUIPMENT MUST BE STORED IN A SECURED, SHELTERED AREA WHEN NOT IN USE OR IN THE THREAT OF HIGH WINDS. ANY WEATHER DAMAGE TO THIS EQUIPMENT WILL NOT BE COVERED UNDER KWIK GOAL'S PRODUCT GUARANTEE. DO NOT LEAVE THIS EQUIPMENT UNATTENDED.

3. Hardware for this step is in **Frame Hdw** & **Panel Hdw** packs.

Assemble crossbar, bases, and post corners. Press joints together firmly before tightening bolts.

NOTE: Square nuts will float loose in channels until used later.

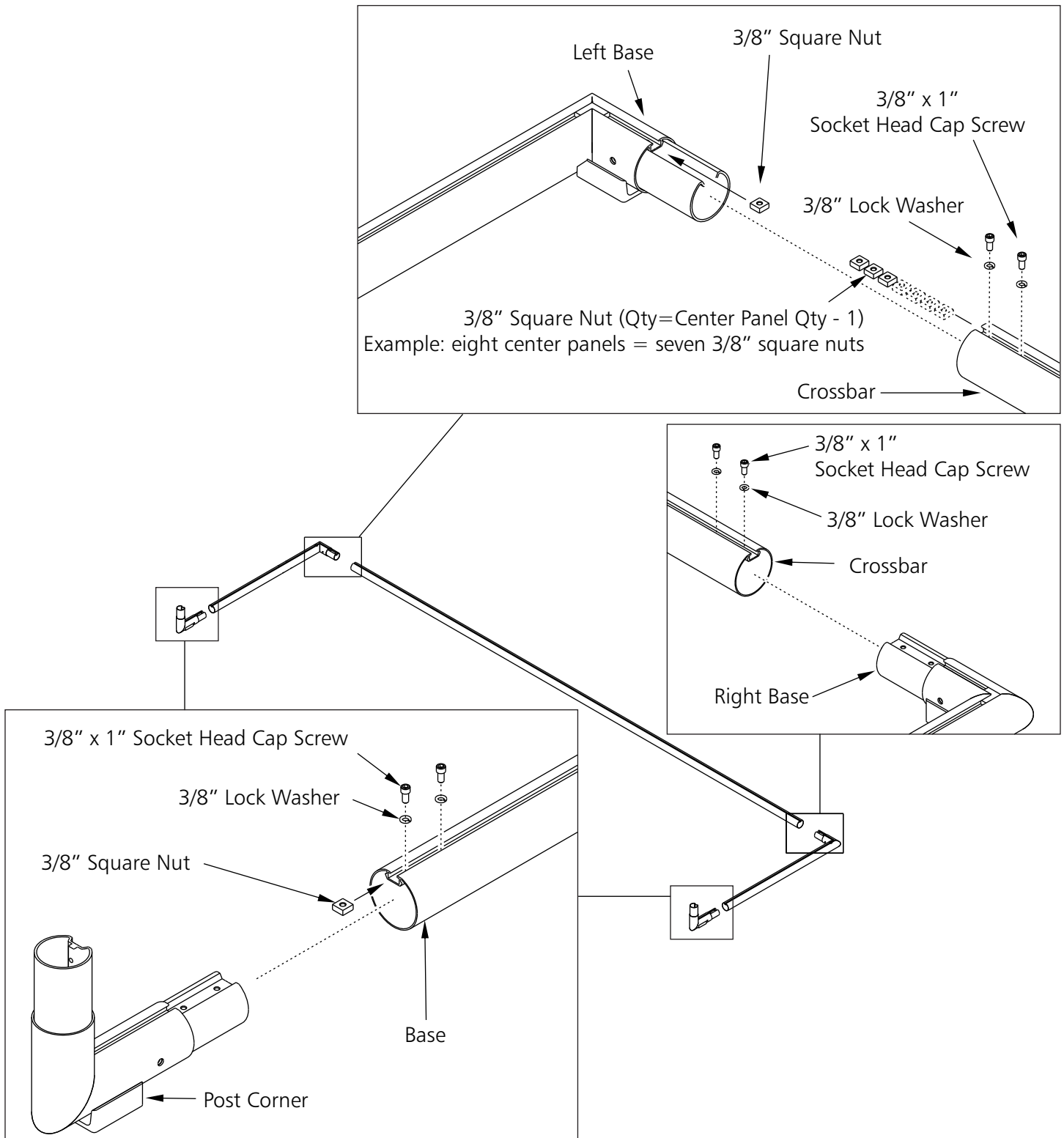

THIS UNIT MUST BE ANCHORED ACCORDING TO THESE INSTRUCTIONS AT ALL TIMES

⚠ WARNING

THIS EQUIPMENT MUST BE STORED IN A SECURED, SHELTERED AREA WHEN NOT IN USE OR IN THE THREAT OF HIGH WINDS. ANY WEATHER DAMAGE TO THIS EQUIPMENT WILL NOT BE COVERED UNDER KWIK GOAL'S PRODUCT GUARANTEE. DO NOT LEAVE THIS EQUIPMENT UNATTENDED.

4. Hardware for this step is in **Frame Hdw** & **Panel Hdw** packs.

Assemble crossbar, posts, and crossbar corners. Press joints together firmly before tightening bolts.

NOTE: Square nuts will float loose in channels until used later.

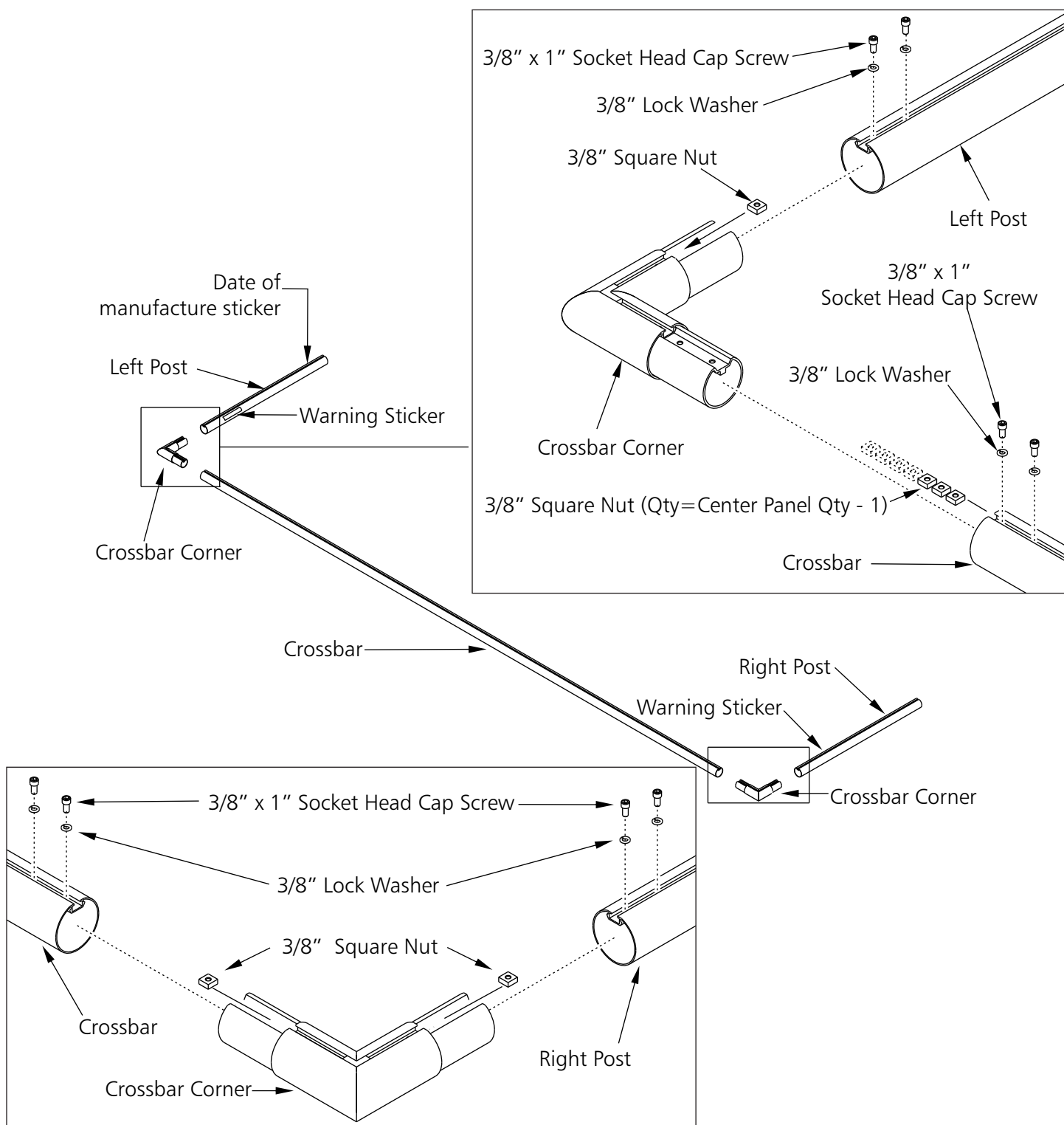

THIS UNIT MUST BE ANCHORED ACCORDING TO THESE INSTRUCTIONS AT ALL TIMES

⚠ WARNING

THIS EQUIPMENT MUST BE STORED IN A SECURED, SHELTERED AREA WHEN NOT IN USE OR IN THE THREAT OF HIGH WINDS. ANY WEATHER DAMAGE TO THIS EQUIPMENT WILL NOT BE COVERED UNDER KWIK GOAL'S PRODUCT GUARANTEE. DO NOT LEAVE THIS EQUIPMENT UNATTENDED.

5. Hardware for this step is in **Frame Hdw** & **Panel Hdw** packs.

Insert one 3/8" square nut in each side of assembled base corner. Connect assembled base and post as shown. Press joints together firmly before tightening bolts.

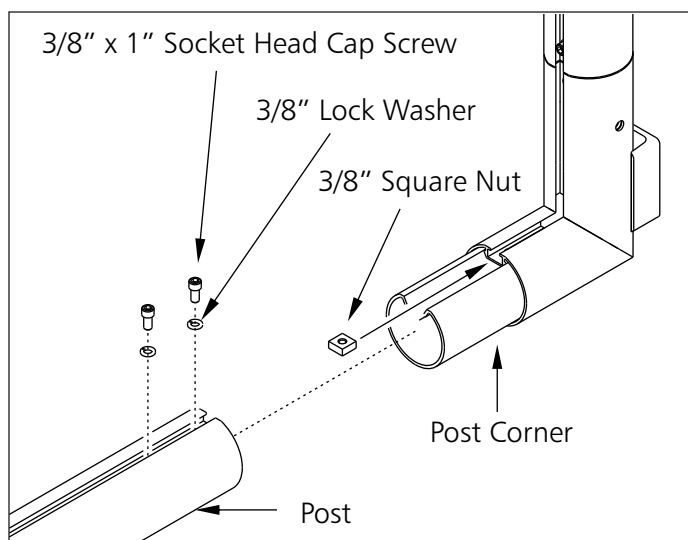
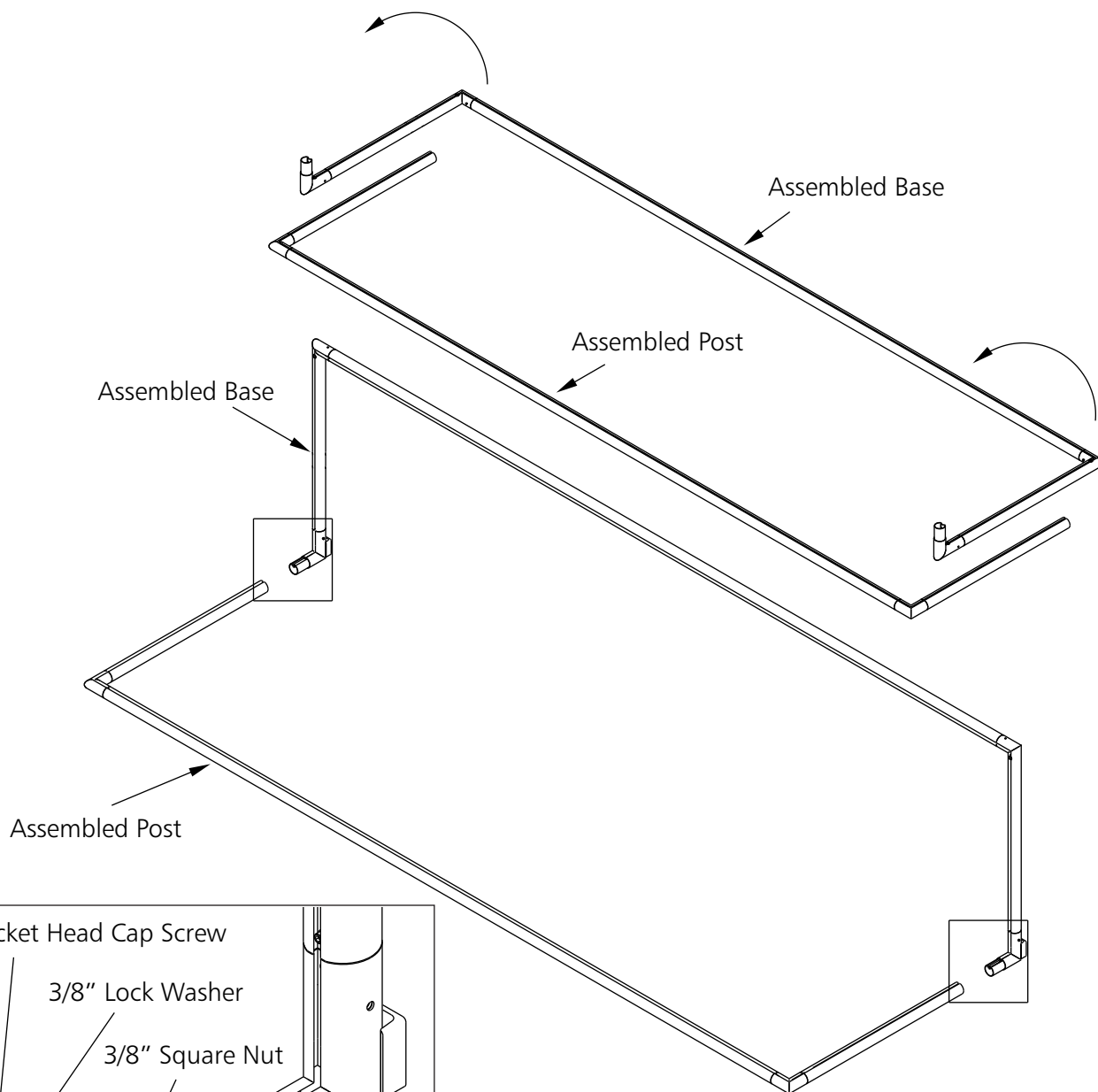

THIS UNIT MUST BE ANCHORED ACCORDING TO THESE INSTRUCTIONS AT ALL TIMES

⚠ WARNING

THIS EQUIPMENT MUST BE STORED IN A SECURED, SHELTERED AREA WHEN NOT IN USE OR IN THE THREAT OF HIGH WINDS. ANY WEATHER DAMAGE TO THIS EQUIPMENT WILL NOT BE COVERED UNDER KWIK GOAL'S PRODUCT GUARANTEE. DO NOT LEAVE THIS EQUIPMENT UNATTENDED.

6. Hardware for this step is in **Panel Hdw** packs.
Attach right and left panels to assembled frame as shown.
Do NOT tighten bolts at this time.

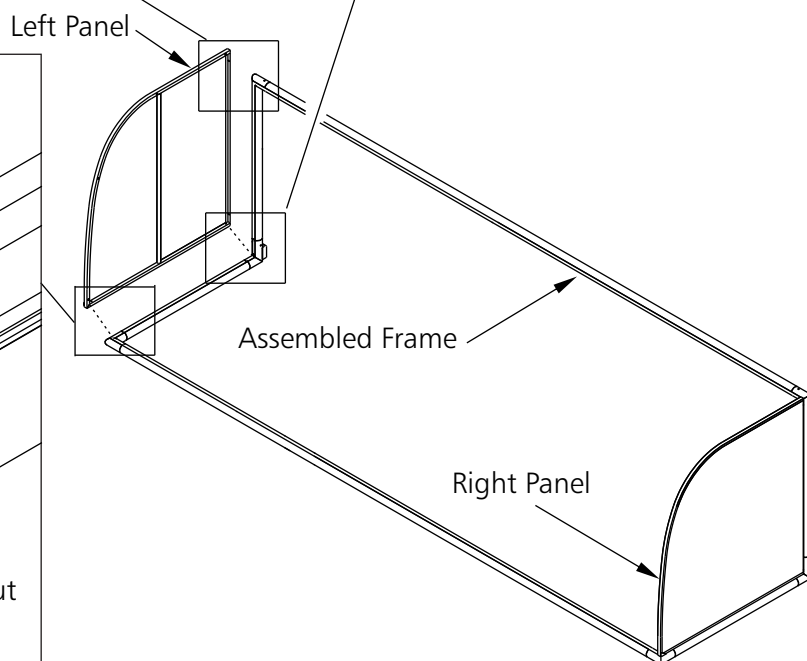
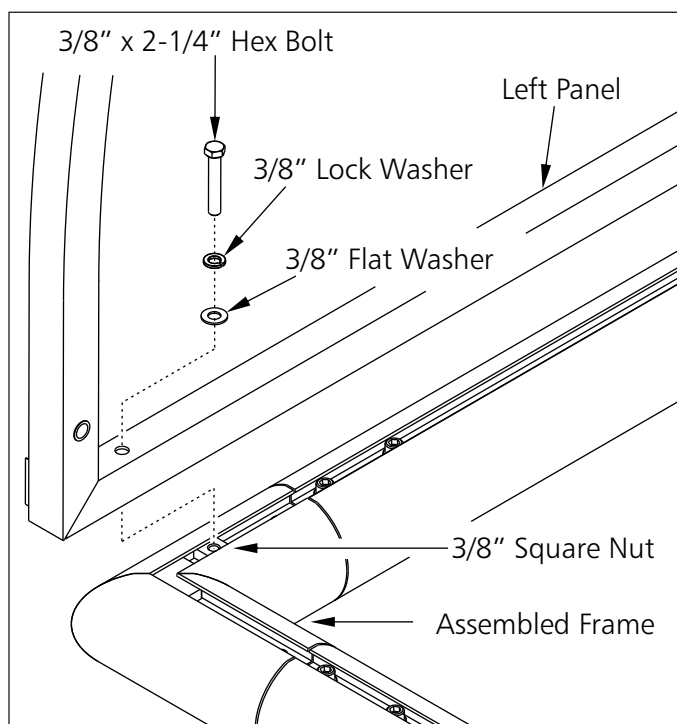
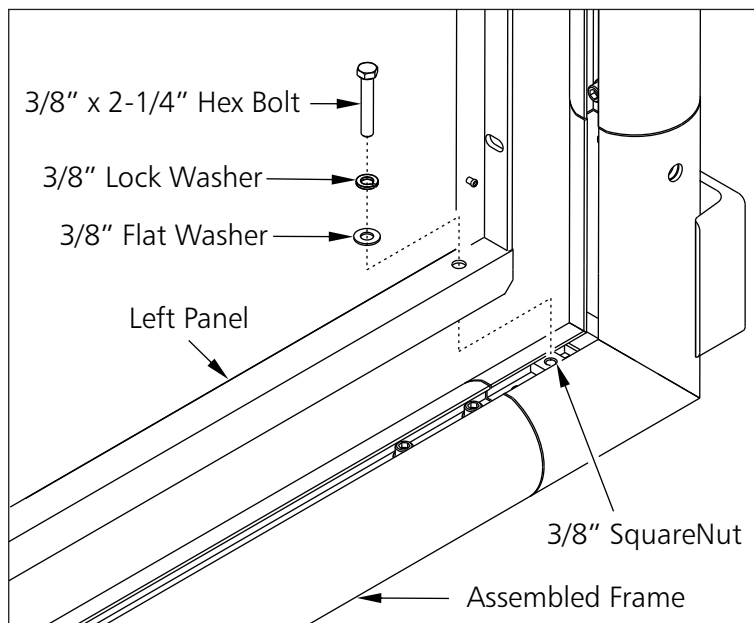
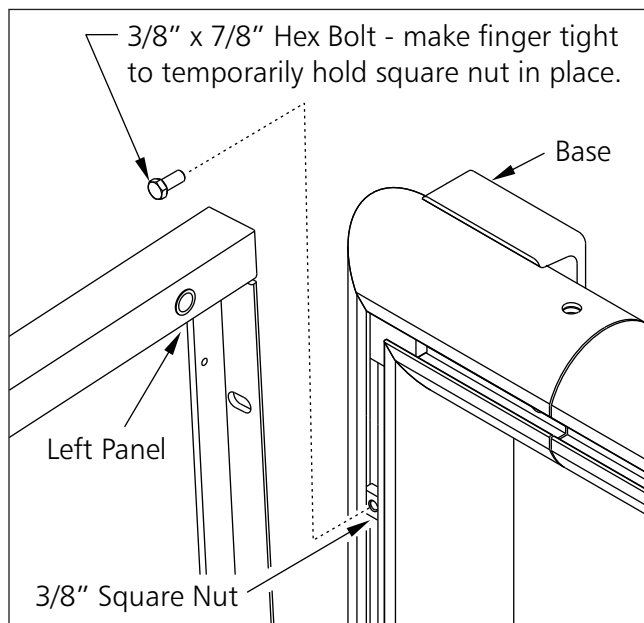

THIS UNIT MUST BE ANCHORED ACCORDING TO THESE INSTRUCTIONS AT ALL TIMES

⚠ WARNING

THIS EQUIPMENT MUST BE STORED IN A SECURED, SHELTERED AREA WHEN NOT IN USE OR IN THE THREAT OF HIGH WINDS. ANY WEATHER DAMAGE TO THIS EQUIPMENT WILL NOT BE COVERED UNDER KWIK GOAL'S PRODUCT GUARANTEE. DO NOT LEAVE THIS EQUIPMENT UNATTENDED.

7. Install swivel wheels - 10" diameter tires. Note suggested location of brakes as shown below.

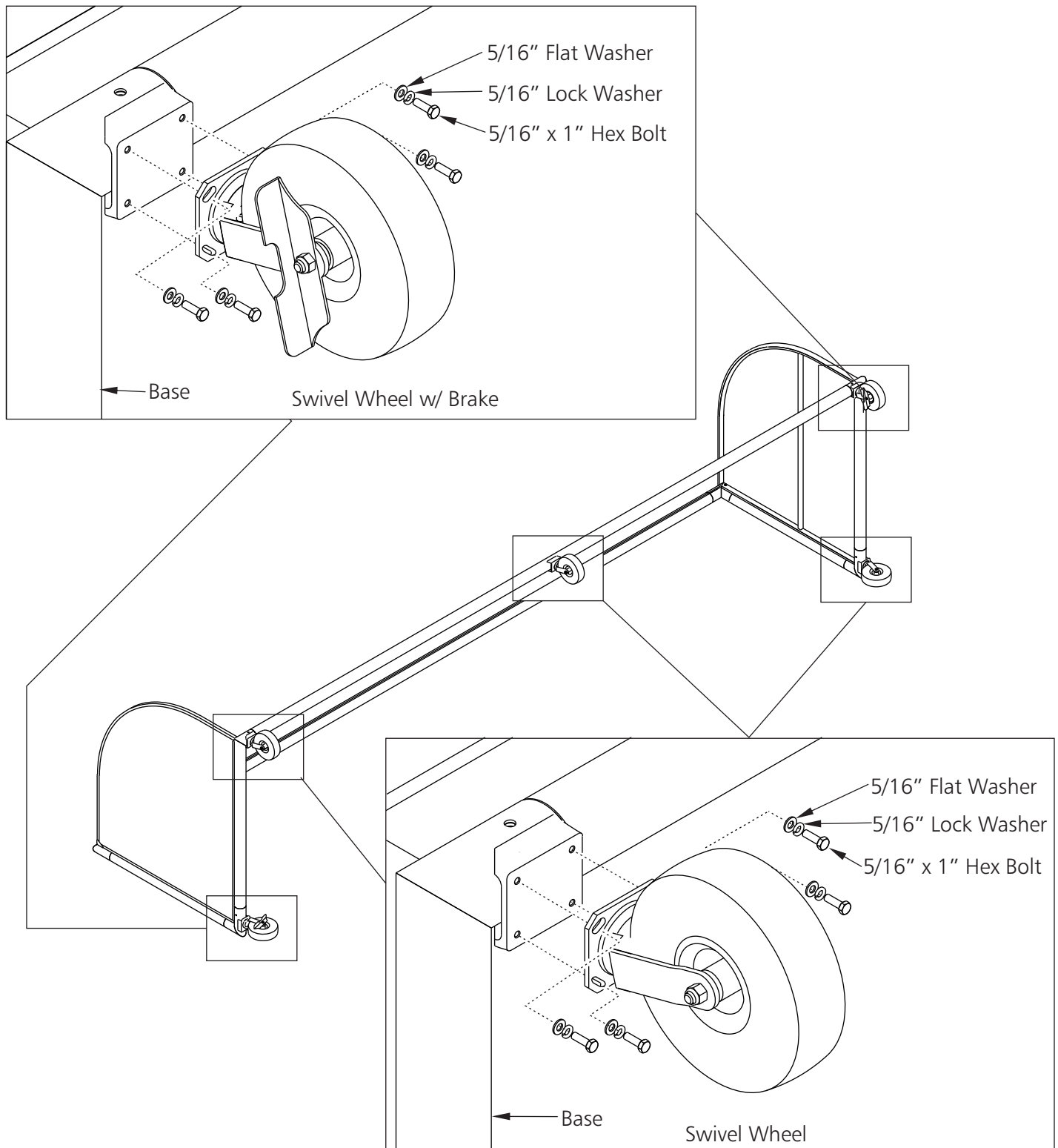

THIS UNIT MUST BE ANCHORED ACCORDING TO THESE INSTRUCTIONS AT ALL TIMES

⚠WARNING

THIS EQUIPMENT MUST BE STORED IN A SECURED, SHELTERED AREA WHEN NOT IN USE OR IN THE THREAT OF HIGH WINDS. ANY WEATHER DAMAGE TO THIS EQUIPMENT WILL NOT BE COVERED UNDER KWIK GOAL'S PRODUCT GUARANTEE. DO NOT LEAVE THIS EQUIPMENT UNATTENDED.

8. Turn shelter frame onto base and remove temporary $\frac{3}{8}$ " X $\frac{7}{8}$ " bolt then connect bottom of right and left panel as shown.
Do NOT tighten bolts at this time.

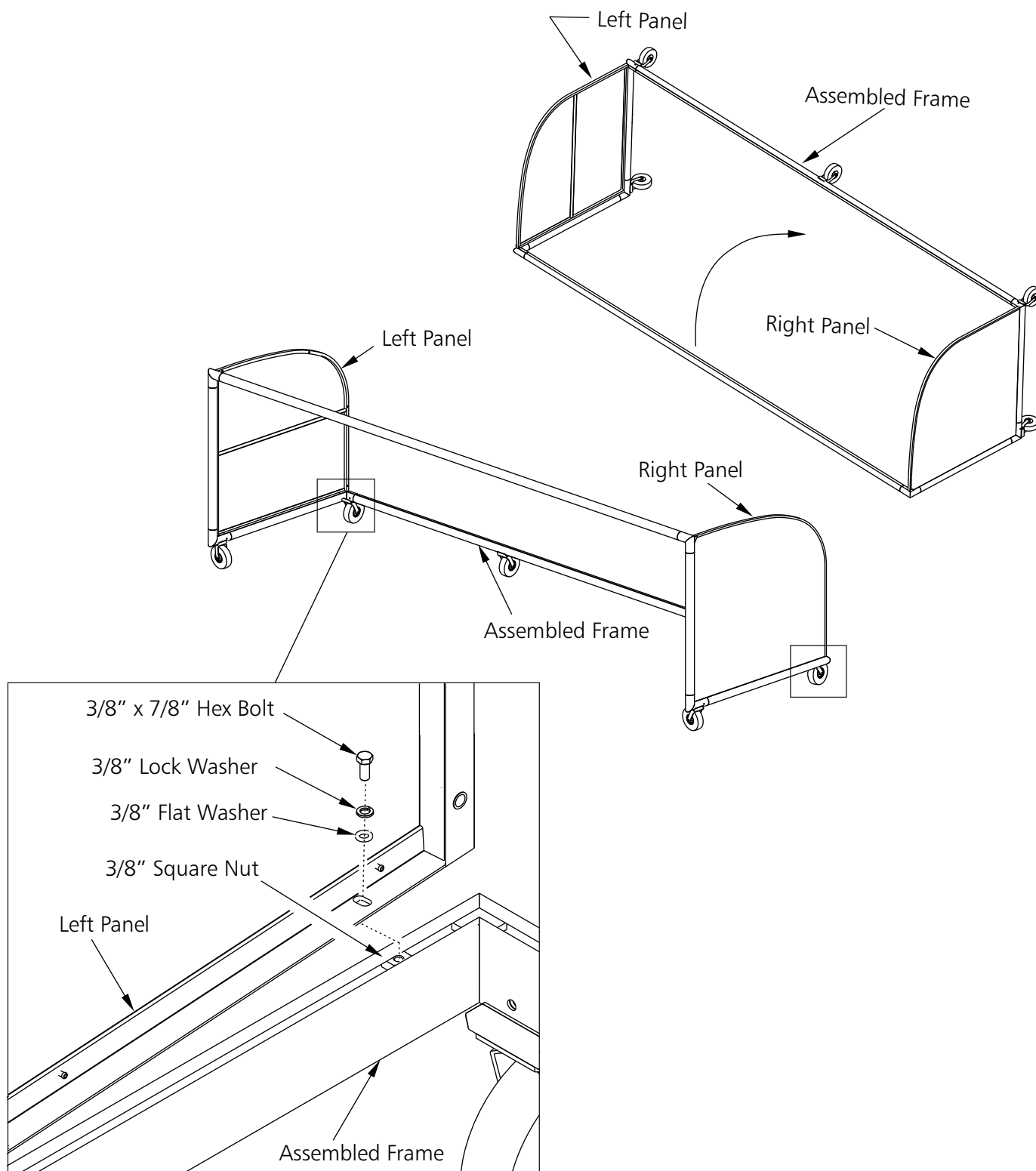

THIS UNIT MUST BE ANCHORED ACCORDING TO THESE INSTRUCTIONS AT ALL TIMES

⚠ WARNING

THIS EQUIPMENT MUST BE STORED IN A SECURED, SHELTERED AREA WHEN NOT IN USE OR IN THE THREAT OF HIGH WINDS. ANY WEATHER DAMAGE TO THIS EQUIPMENT WILL NOT BE COVERED UNDER KWIK GOAL'S PRODUCT GUARANTEE. DO NOT LEAVE THIS EQUIPMENT UNATTENDED.

9. Hardware for this step is in **Panel Hdw** packs.

Insert double end studs into left panel. Move unneeded square nuts in top and bottom crossbars away from left side at least one center panel width.

Do NOT tighten bolts at this time.

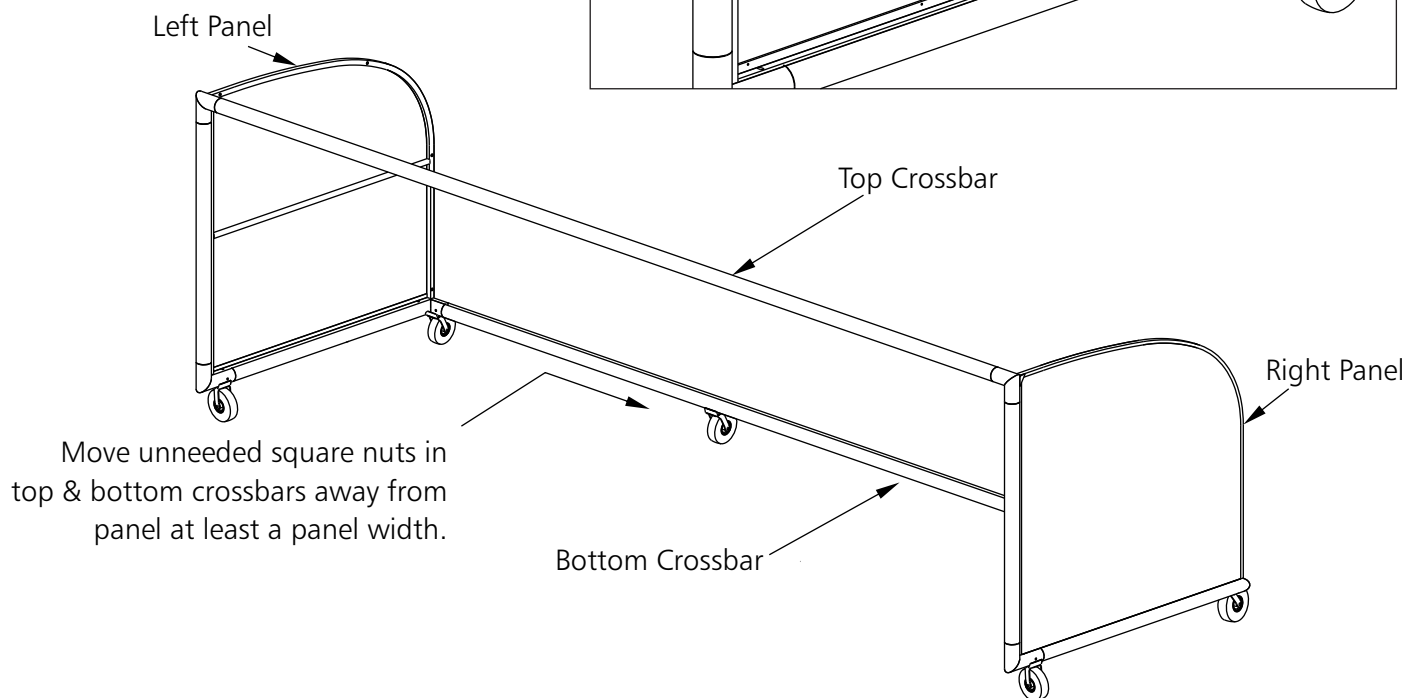
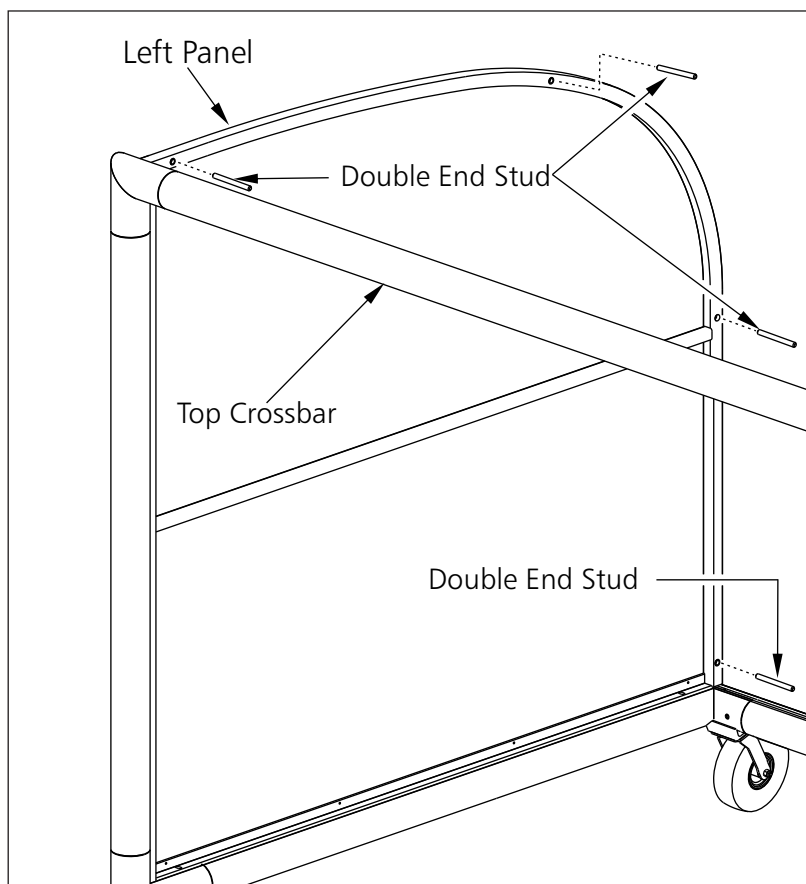

THIS UNIT MUST BE ANCHORED ACCORDING TO THESE INSTRUCTIONS AT ALL TIMES

⚠ WARNING THIS EQUIPMENT MUST BE STORED IN A SECURED, SHELTERED AREA WHEN NOT IN USE OR IN THE THREAT OF HIGH WINDS. ANY WEATHER DAMAGE TO THIS EQUIPMENT WILL NOT BE COVERED UNDER KWIK GOAL'S PRODUCT GUARANTEE. DO NOT LEAVE THIS EQUIPMENT UNATTENDED.

10. Hardware for this step is in **Panel Hdw** packs.

Line up square nut with holes in center panel and attach center panel to shelter frame. Slide center panel to mate with left panel lining up double end studs, as shown. Repeat steps 9 & 10 to attach center panel to the right side.

Do NOT tighten bolts at this time.

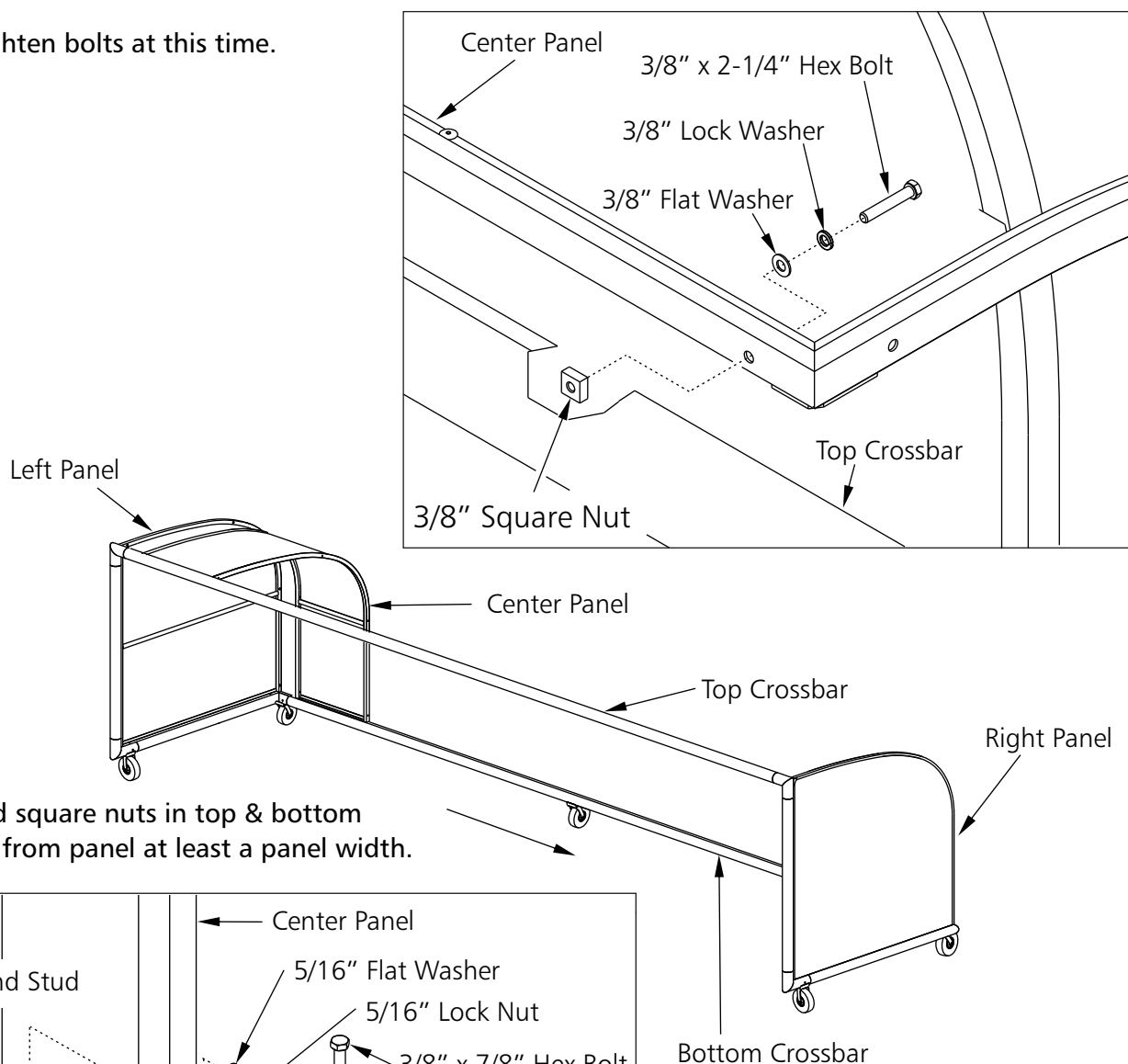

Move unneeded square nuts in top & bottom crossbars away from panel at least a panel width.

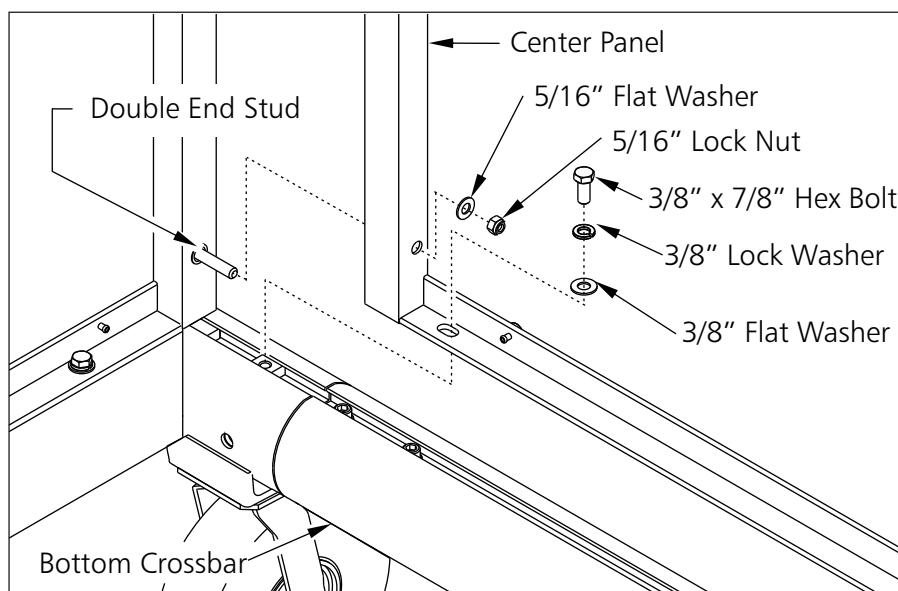

THIS UNIT MUST BE ANCHORED ACCORDING TO THESE INSTRUCTIONS AT ALL TIMES

⚠ WARNING

THIS EQUIPMENT MUST BE STORED IN A SECURED, SHELTERED AREA WHEN NOT IN USE OR IN THE THREAT OF HIGH WINDS. ANY WEATHER DAMAGE TO THIS EQUIPMENT WILL NOT BE COVERED UNDER KWIK GOAL'S PRODUCT GUARANTEE. DO NOT LEAVE THIS EQUIPMENT UNATTENDED.

11. Hardware for this step is in **Panel Hdw** packs.

Repeat step 9 to attach center panels to crossbars then connect center panels together until the only 1 center panel is left. Remember to move unneeded square nuts on top and bottom crossbars out from under the center panel being attached before bolting center panel in place.

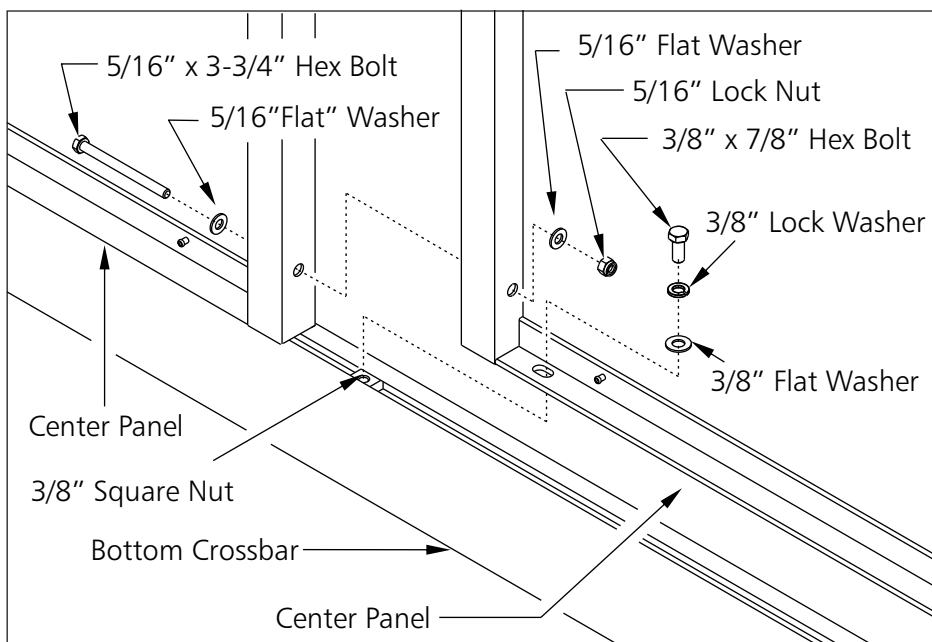
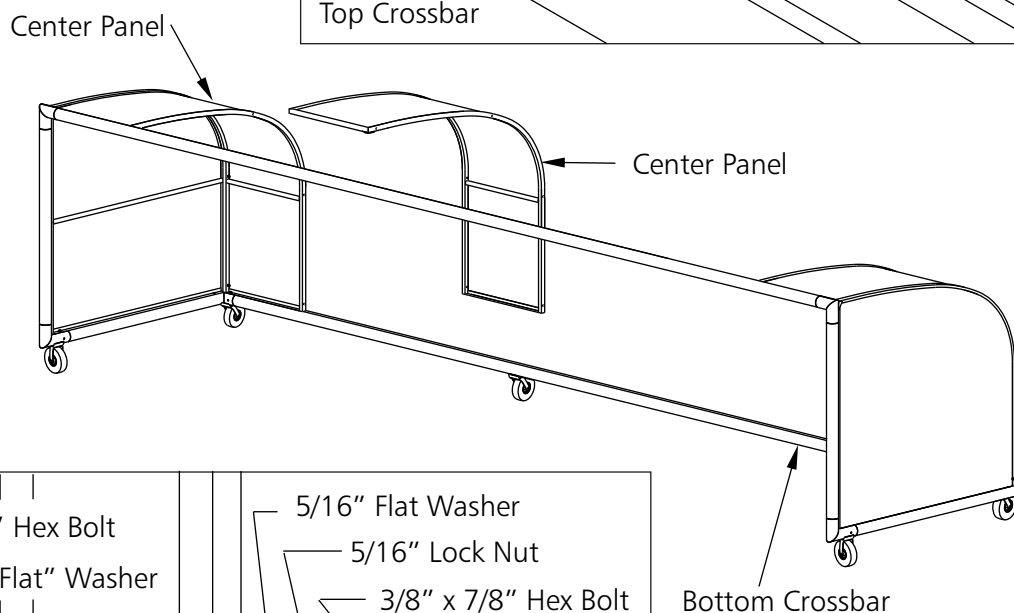
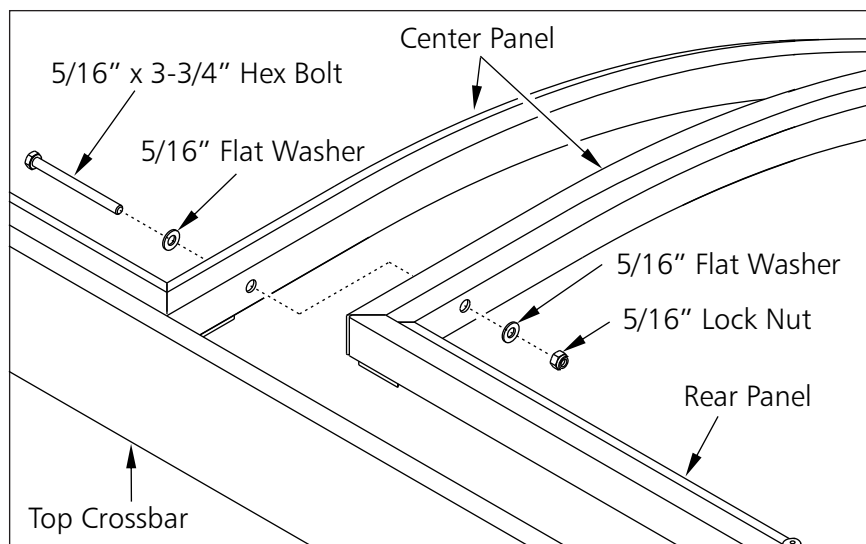

THIS UNIT MUST BE ANCHORED ACCORDING TO THESE INSTRUCTIONS AT ALL TIMES

⚠ WARNING

THIS EQUIPMENT MUST BE STORED IN A SECURED, SHELTERED AREA WHEN NOT IN USE OR IN THE THREAT OF HIGH WINDS. ANY WEATHER DAMAGE TO THIS EQUIPMENT WILL NOT BE COVERED UNDER KWIK GOAL'S PRODUCT GUARANTEE. DO NOT LEAVE THIS EQUIPMENT UNATTENDED.

12. Before installing last center panel, tighten 4 bolts at each center panel joint.
Then tighten 4 lock nuts at left and right end panel joints.
13. Install last center panel to shelter frame. After all bolts are installed, go back and tighten 8 center panel joint bolts on the last panel.

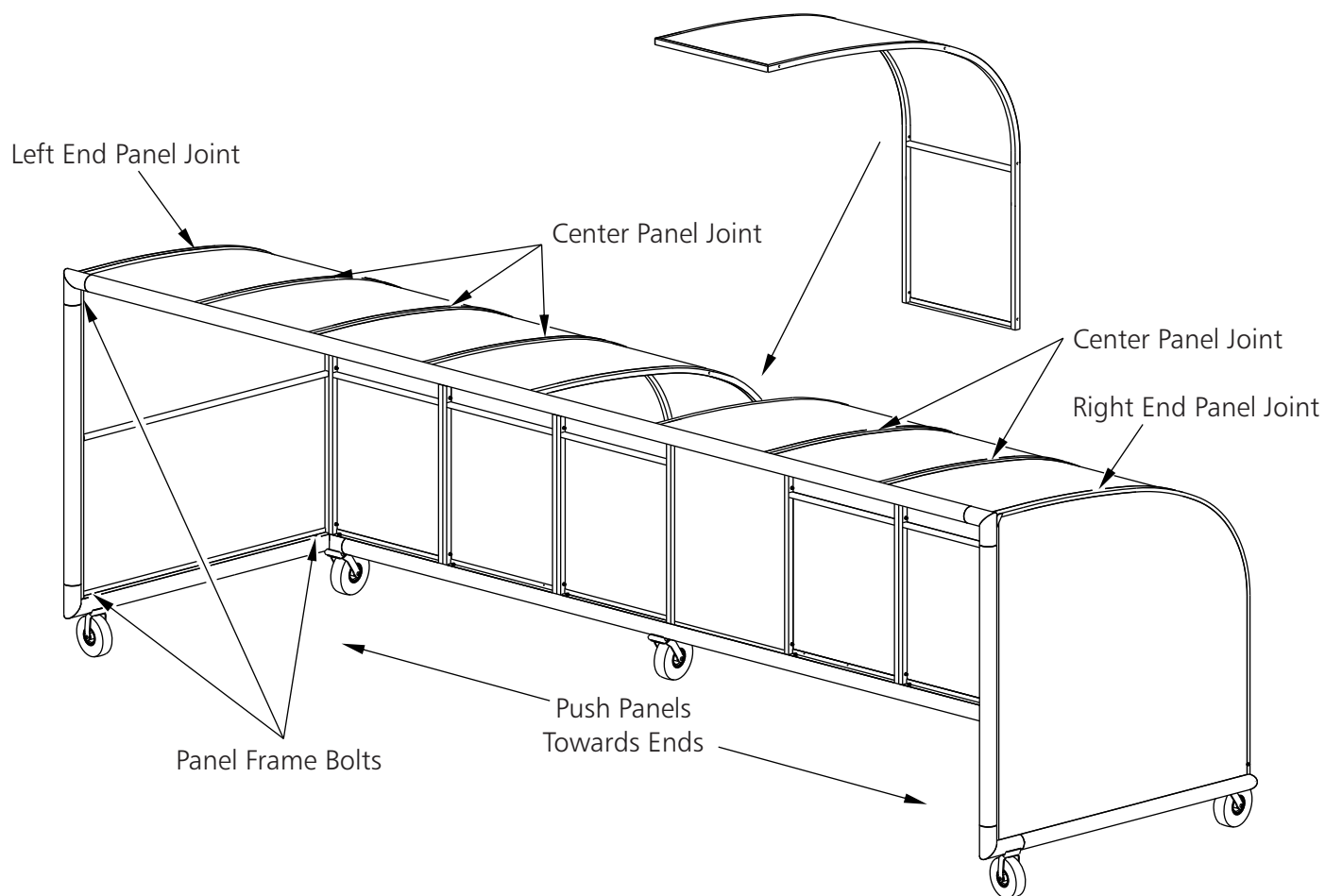

14. Tighten 3 panel frame bolts on each of the left and right end panels.
15. Tighten panel frame bolts on each center panel (1 at top and 1 at bottom on each panel).

THIS UNIT MUST BE ANCHORED ACCORDING TO THESE INSTRUCTIONS AT ALL TIMES

⚠ WARNING

THIS EQUIPMENT MUST BE STORED IN A SECURED, SHELTERED AREA WHEN NOT IN USE OR IN THE THREAT OF HIGH WINDS. ANY WEATHER DAMAGE TO THIS EQUIPMENT WILL NOT BE COVERED UNDER KWIK GOAL'S PRODUCT GUARANTEE. DO NOT LEAVE THIS EQUIPMENT UNATTENDED.

16. Hardware for steps 16 and 17 are in the **Anchor Hdw pack**.

Attach anchor chain to shelter frame, 2 in the front on the outside and 2 on the inside at the back as shown.

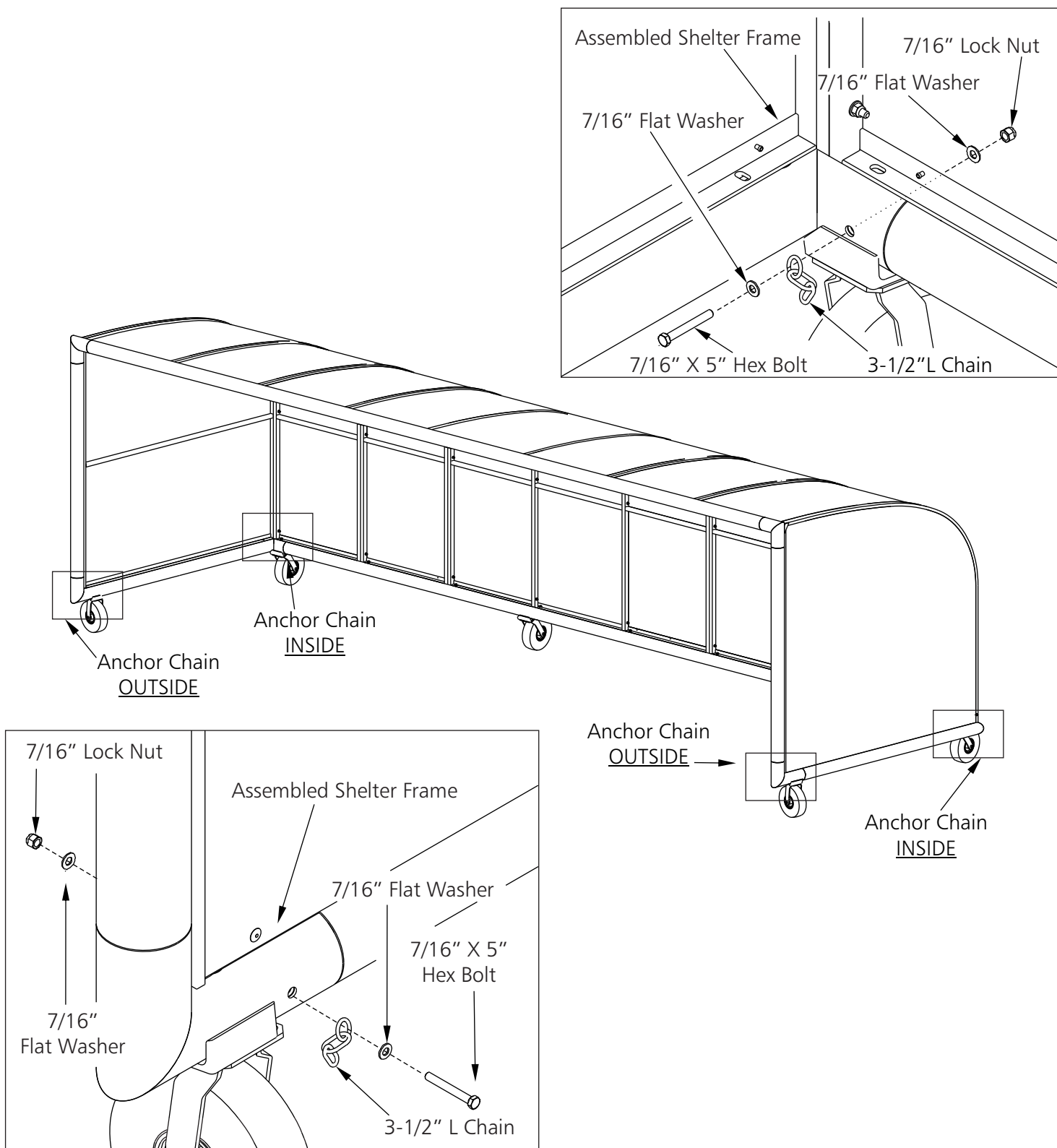

THIS UNIT MUST BE ANCHORED ACCORDING TO THESE INSTRUCTIONS AT ALL TIMES

WARNING

THIS EQUIPMENT MUST BE STORED IN A SECURED, SHELTERED AREA WHEN NOT IN USE OR IN THE THREAT OF HIGH WINDS. ANY WEATHER DAMAGE TO THIS EQUIPMENT WILL NOT BE COVERED UNDER KWIK GOAL'S PRODUCT GUARANTEE. DO NOT LEAVE THIS EQUIPMENT UNATTENDED.

17. Permanent ground anchors must be used at all times. Dig four holes according to the layout below. Note: areas subject to heavy frost may require depths as deep as 36". Prepare hole and add drain stone as shown. Install anchor in each hole and fill hole with concrete. Allow concrete to cure before attaching shelter to anchors. Use snap links to connect shelter to ground anchors.

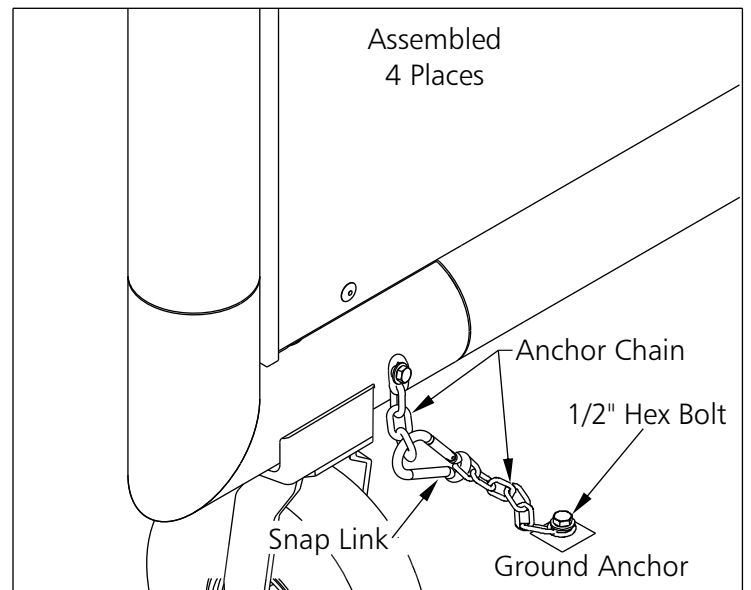
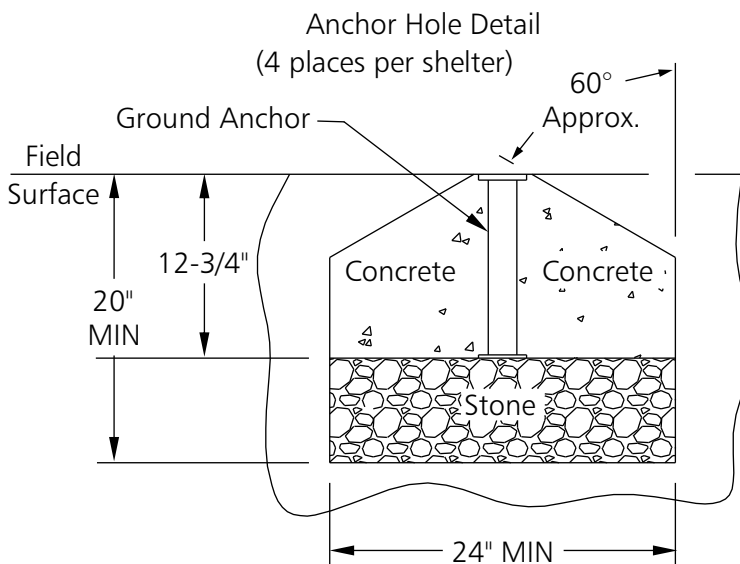
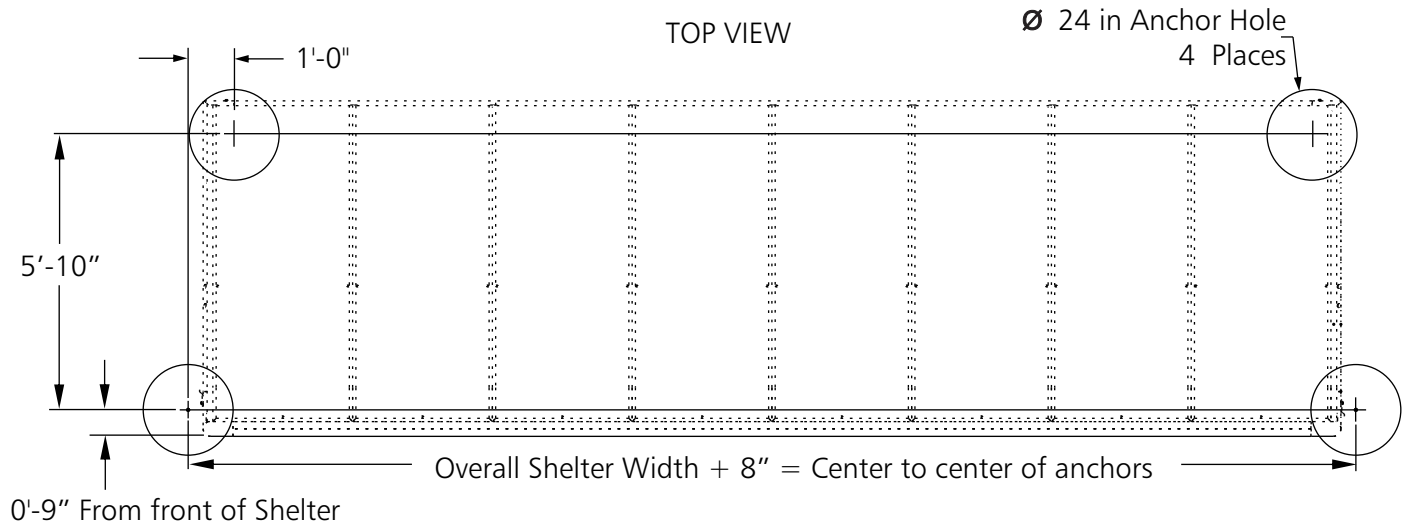
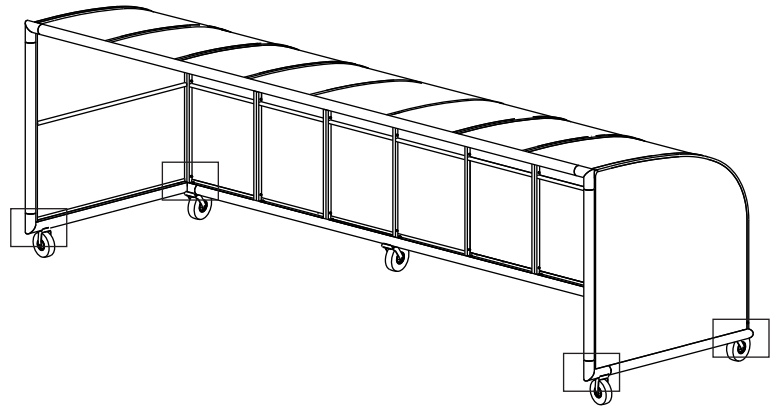

THIS UNIT MUST BE ANCHORED ACCORDING TO THESE INSTRUCTIONS AT ALL TIMES

⚠ WARNING

THIS EQUIPMENT MUST BE STORED IN A SECURED, SHELTERED AREA WHEN NOT IN USE OR IN THE THREAT OF HIGH WINDS. ANY WEATHER DAMAGE TO THIS EQUIPMENT WILL NOT BE COVERED UNDER KWIK GOAL'S PRODUCT GUARANTEE. DO NOT LEAVE THIS EQUIPMENT UNATTENDED.

18. If desired, panel joints may be sealed with a small bead of urethane sealant. Seal across crossbar to panel joint, then panel to panel joints.

NOTE: Panel to panel joints should only be sealed between crossbar and lower brace of panels. Sealant below lower brace line is not necessary.

Prevent sealant material from contacting polycarbonate.

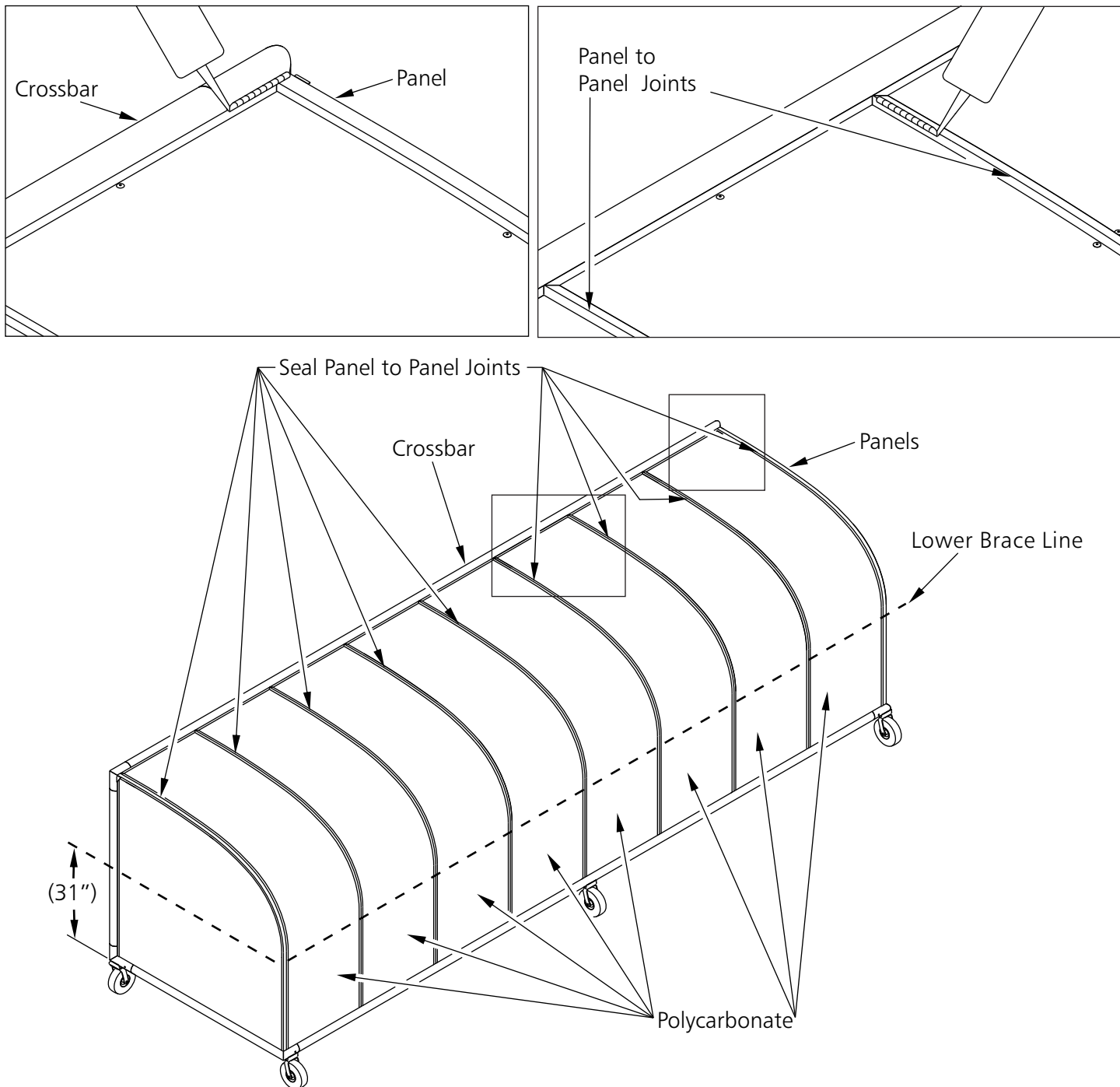

THIS UNIT MUST BE ANCHORED ACCORDING TO THESE INSTRUCTIONS AT ALL TIMES

⚠ WARNING

THIS EQUIPMENT MUST BE STORED IN A SECURED, SHELTERED AREA WHEN NOT IN USE OR IN THE THREAT OF HIGH WINDS. ANY WEATHER DAMAGE TO THIS EQUIPMENT WILL NOT BE COVERED UNDER KWIK GOAL'S PRODUCT GUARANTEE. DO NOT LEAVE THIS EQUIPMENT UNATTENDED.

19. Recommended seat and aisle layout for 9B5538.

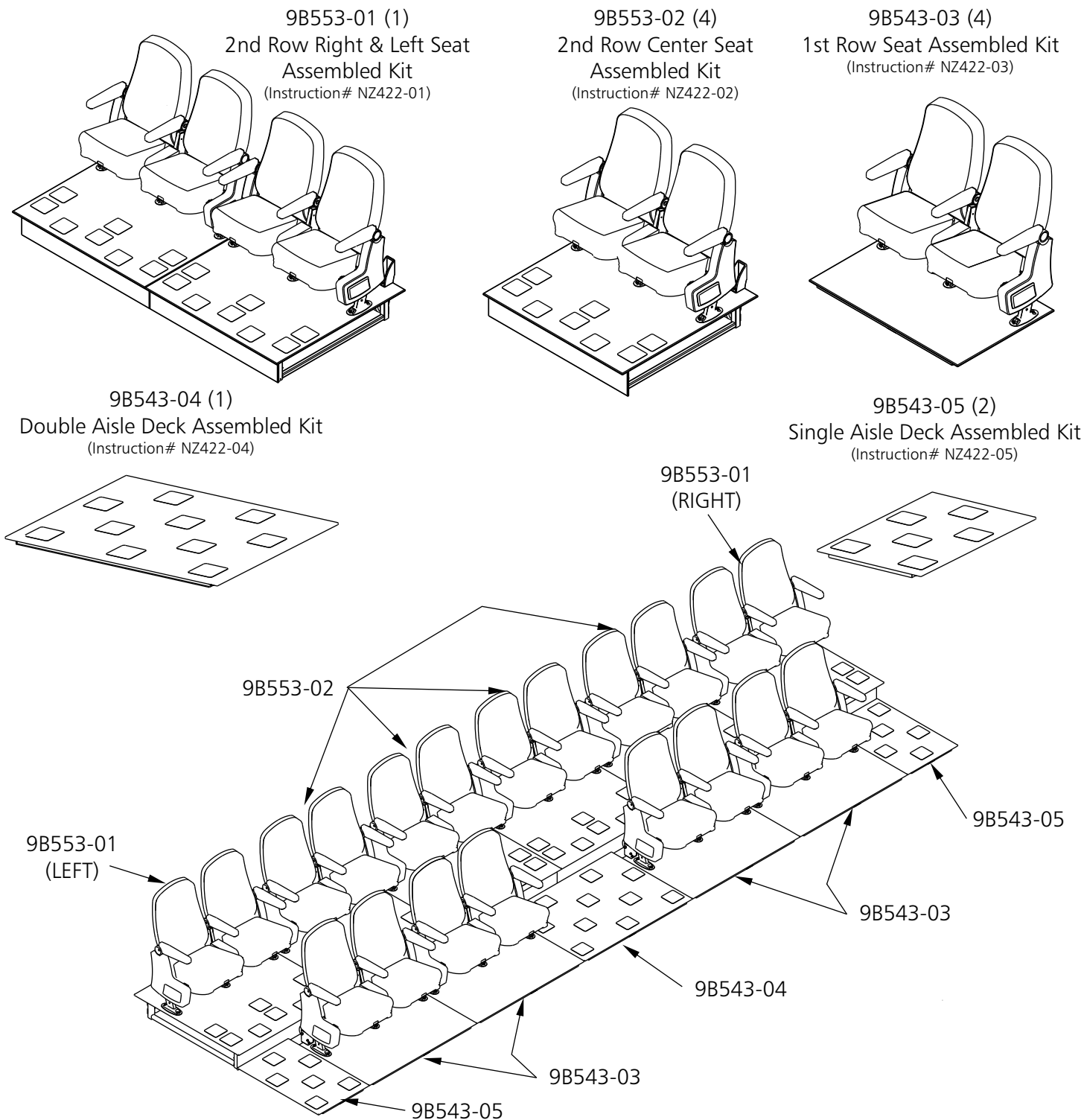

Go to kwikgoal.com for additional product information.

THIS UNIT MUST BE ANCHORED ACCORDING TO THESE INSTRUCTIONS AT ALL TIMES

⚠ WARNING

THIS EQUIPMENT MUST BE STORED IN A SECURED, SHELTERED AREA WHEN NOT IN USE OR IN THE THREAT OF HIGH WINDS. ANY WEATHER DAMAGE TO THIS EQUIPMENT WILL NOT BE COVERED UNDER KWIK GOAL'S PRODUCT GUARANTEE. DO NOT LEAVE THIS EQUIPMENT UNATTENDED.



ASSEMBLY INSTRUCTIONS FOR 9B552-01
2ND ROW RIGHT AND LEFT MOLDED SEAT KIT

1. Unpack all parts and check for damage that may have occurred during shipping. If damage has occurred, notify Kwik Goal immediately. Lay out all parts. Remove all cardboard and packaging immediately. Wet or damp packaging may damage contents.
2. Read through entire instruction before beginning assembly and installation.

Parts

Molded Seat (4)
(Part# VZ689)

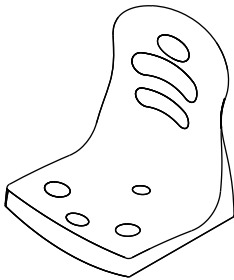

Seat Frame (4)
(Part# UZ1677)

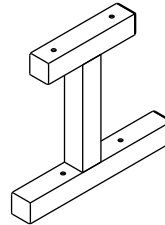

2nd Row Deck (2)
(Part # UZ1675)

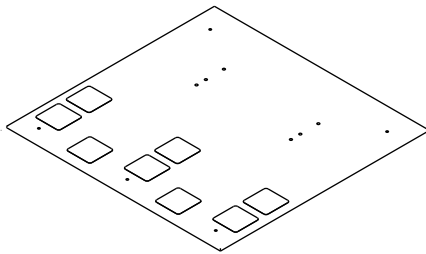

2nd Row Deck Frame (2)
(Part# UZ1585)

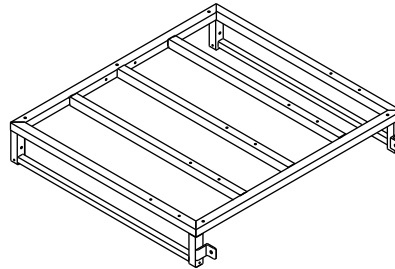

Wheel (4)
(Part# VZ802)

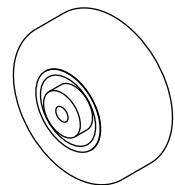

Frame Plate (2)
(Part# UZ1591)

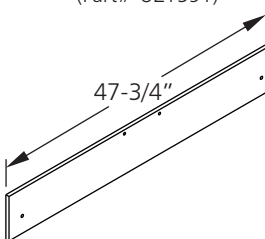

Handle (2)
(Part# VZ679)

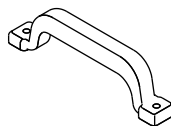

Seat Deck Stop (4)
(Part# VZ838)



RT & LT 2nd Row Seat Deck Hdw (JZ274)

Note: Hardware may be packaged separately in one or more boxes. Open all packages before beginning assembly.

Molded Seat Crossbar Front (2)
(Part# UZ1678)

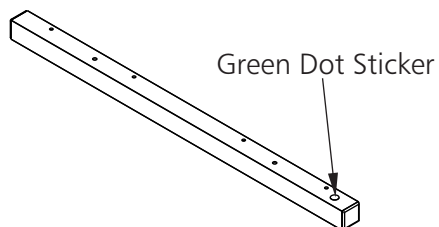

Molded Seat Crossbar Rear (2)
(Part# UZ1679)

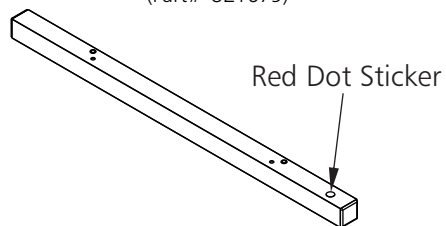

1/4" x 1" Hex Bolt (Part# TZ373)	(4)
1/4" x 1-1/4" Hex Bolt (Part# TZ399)	(8)
1/4" x 3" Sidewalk Bolt (Part# TZ393)	(14)
1/4" x 2-3/4" Hex Bolt (Part# TZ18)	(8)
1/4" x 3" Hex Bolt (Part# TZ385)	(4)
1/4" x 4-3/4" Hex Bolt (Part# TZ299)	(8)
1/4" Lock Nut (Part# TZ19)	(42)
1/4" Flat Washer (Part# TZ147)	(70)
1/4" Lock Washer (Part# TZ187)	(4)
5/16" x 4-1/2" Hex Bolt (Part# TZ377)	(8)
5/16" Flat Washer (Part# TZ4)	(16)
5/16" Lock Nut (Part# TZ321)	(8)
1/2" Jam Nut (Part# TZ318)	(4)
1/2" Lock Nut (Part# TZ349)	(4)
1/2" x 3-1/2" Hex Bolt (Part# TZ320)	(4)

Assembly Tools

7/16", 1/2" & 3/4"
Wrenches



Ratchet with
7/16", 1/2" & 3/4"
Sockets

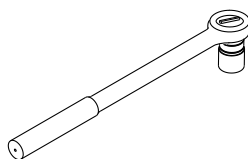

Phillips Screwdriver or Standard Screwdriver
P3

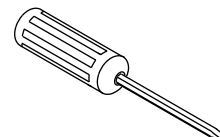
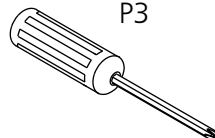

3. Assemble wheels to deck frame as shown. Tighten jam nut. Snug lock nut so that wheel spins freely.

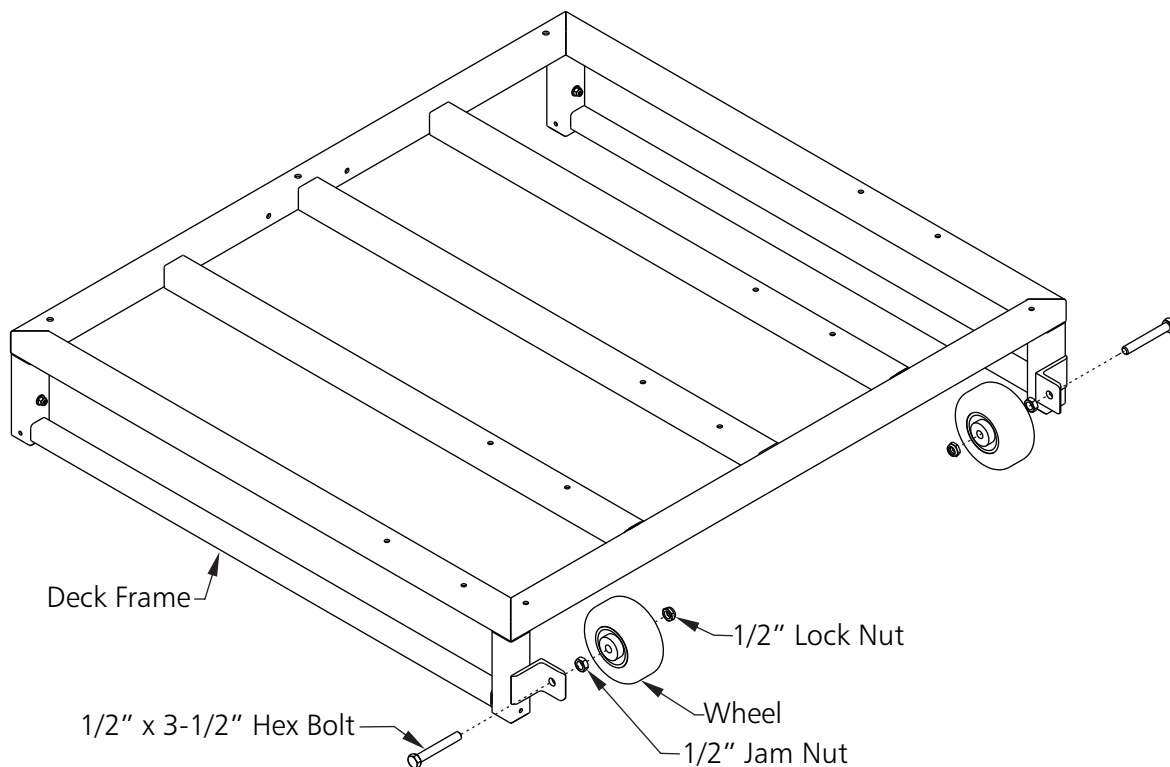

4. Attach frame plate to deck frame. Typical applications require one left and one right assembly
 Note: Depending on what side of frame plate faces out will determine a right or left deck assembly. Top of frame plate must be flush or below top of deck frame. For best appearance, snug sidewalk bolts and tighten hex bolts.

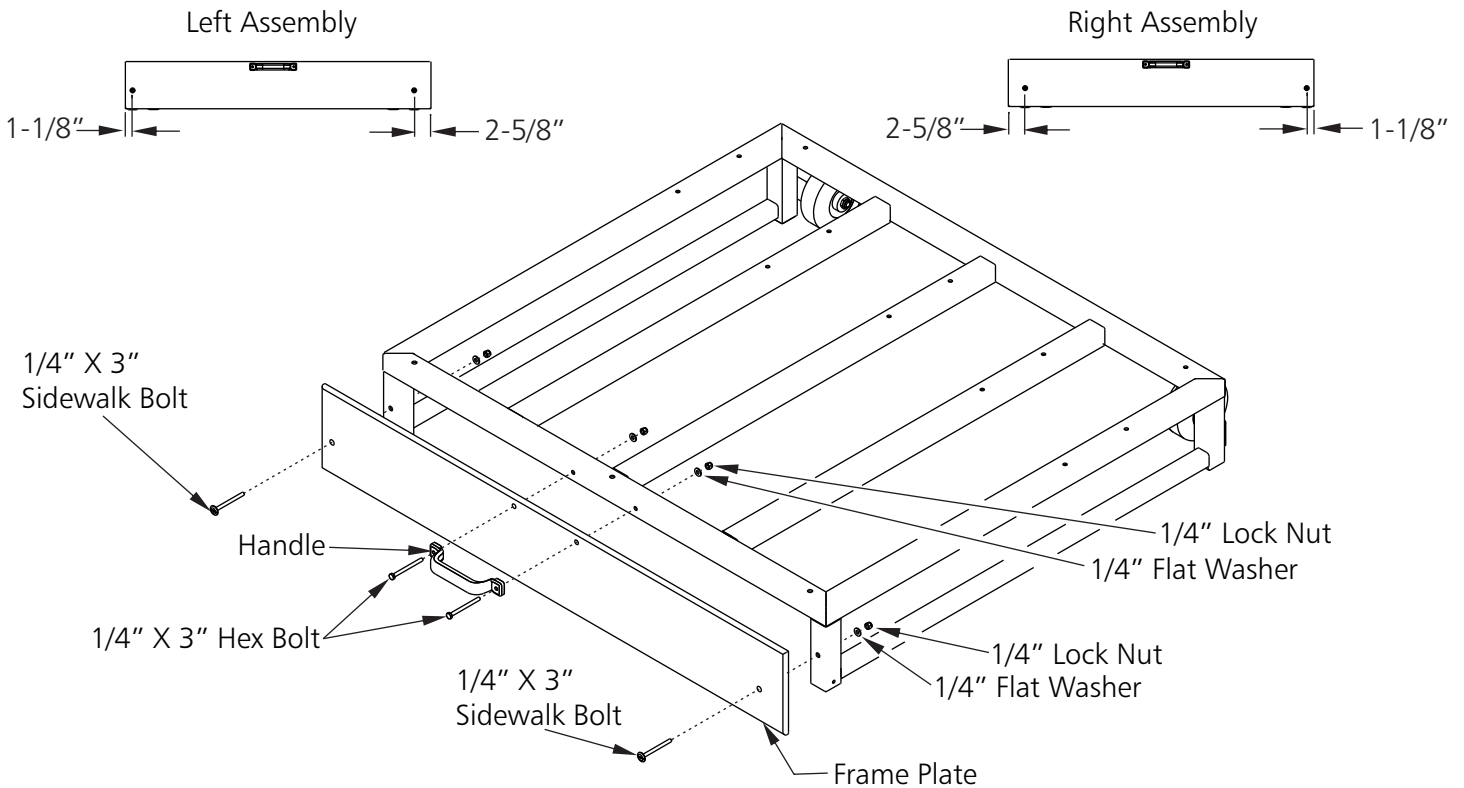

5. Attach 2nd row deck to deck frame and seat deck stops to deck plate as shown.
(Do NOT tighten bolts to deck frame at this time.)

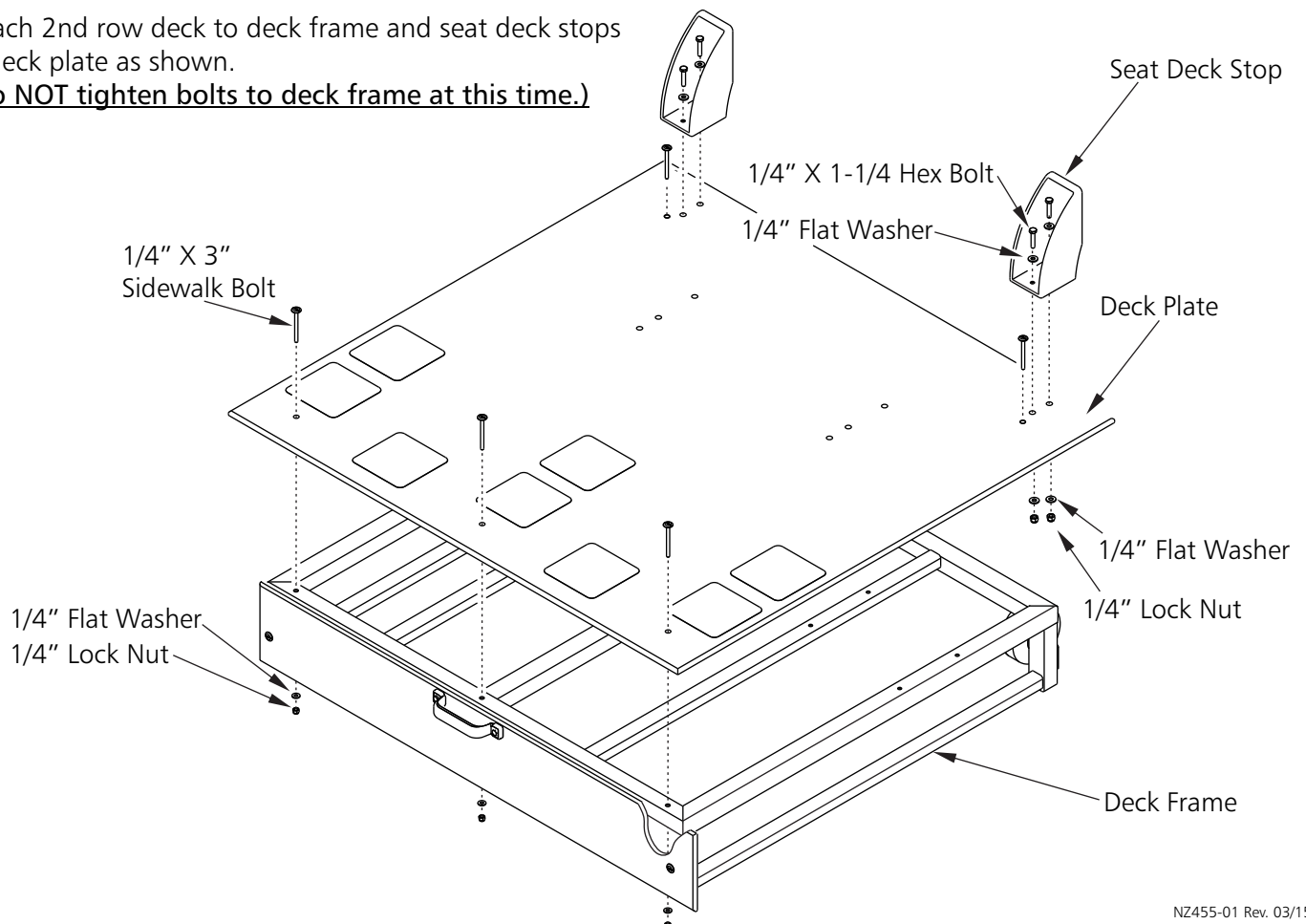

6. Attach seat frames to deck frame as shown.
(Do NOT tighten bolts at this time.)

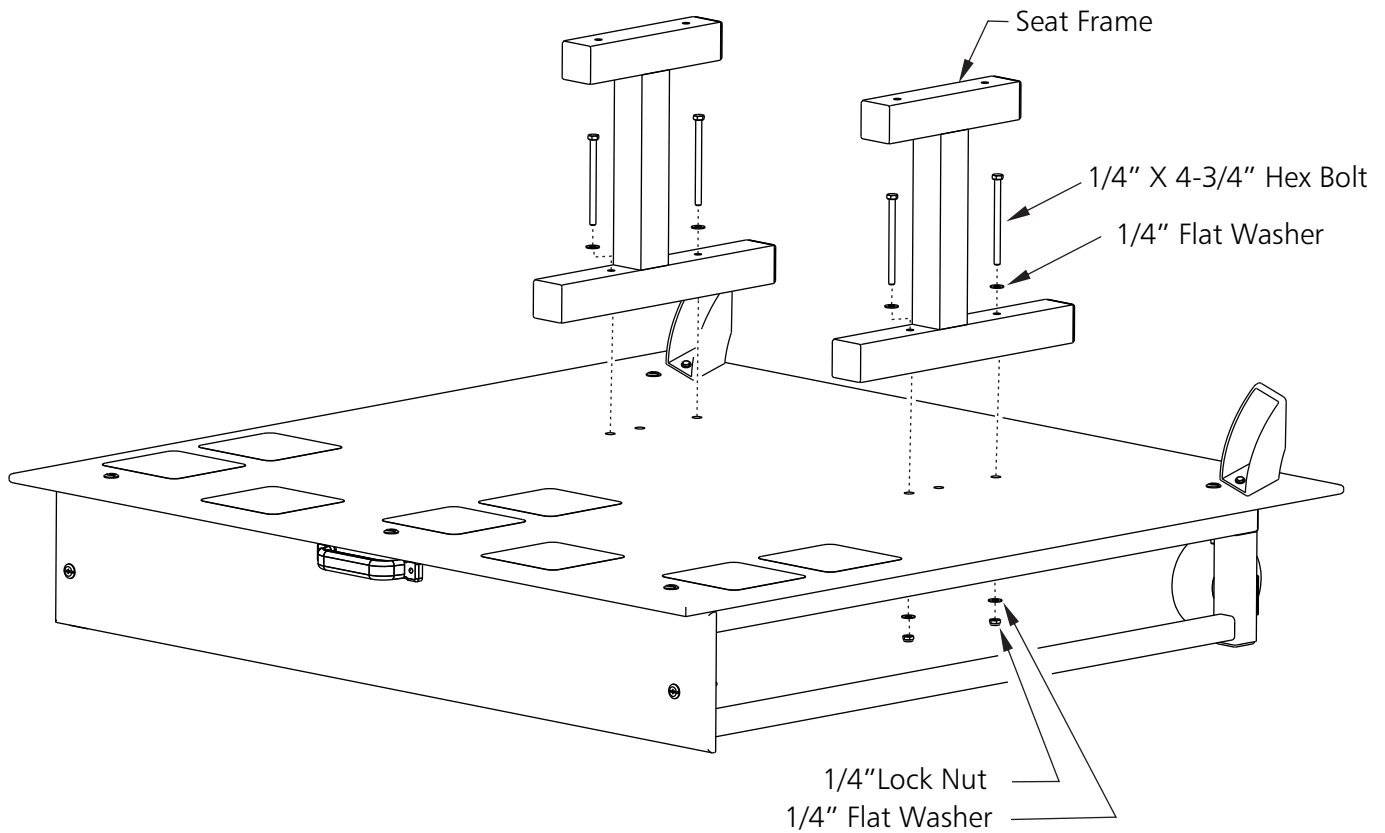

7. Attach the front and rear molded seat crossbars to seat frames as shown. Once the molded seat crossbars are attached, tighten the crossbars to the seat frames. Snug deck to deck frame bolts. Tighten seat frame to deck frame bolts.
(CAUTION DO NOT OVER TIGHTEN BOLTS.)

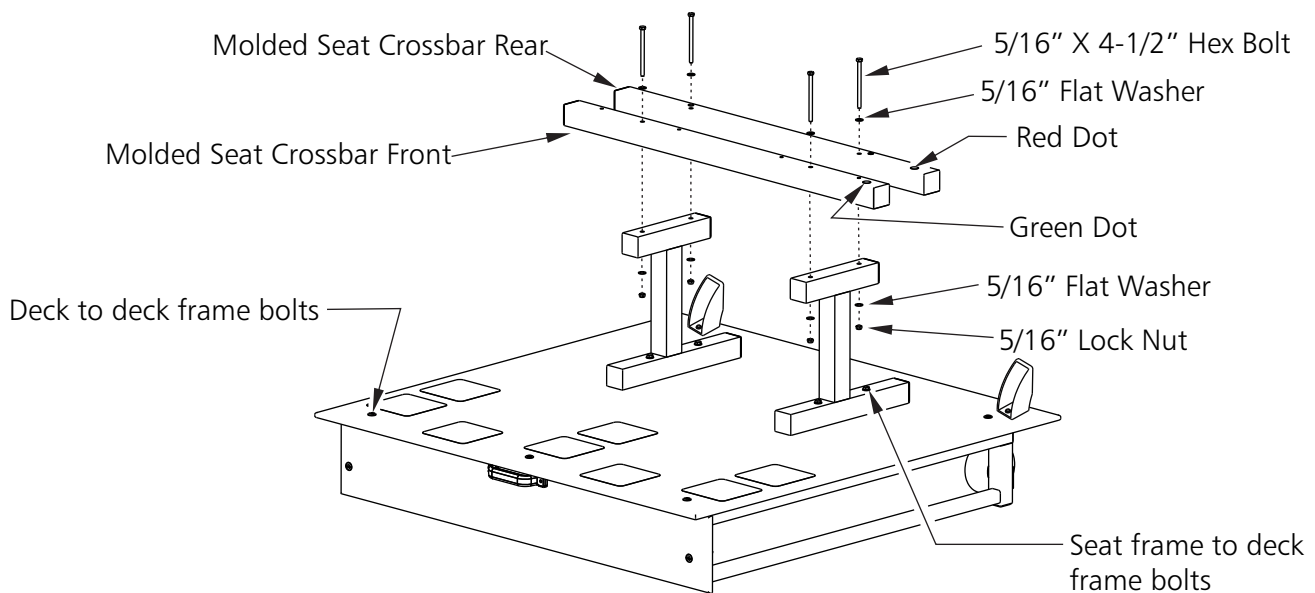

8. Attach molded seats to molded seat crossbars. After both molded seats are attached to molded seat crossbars, tighten all seating bolts.

(CAUTION DO NOT OVER TIGHTEN BOLTS.)

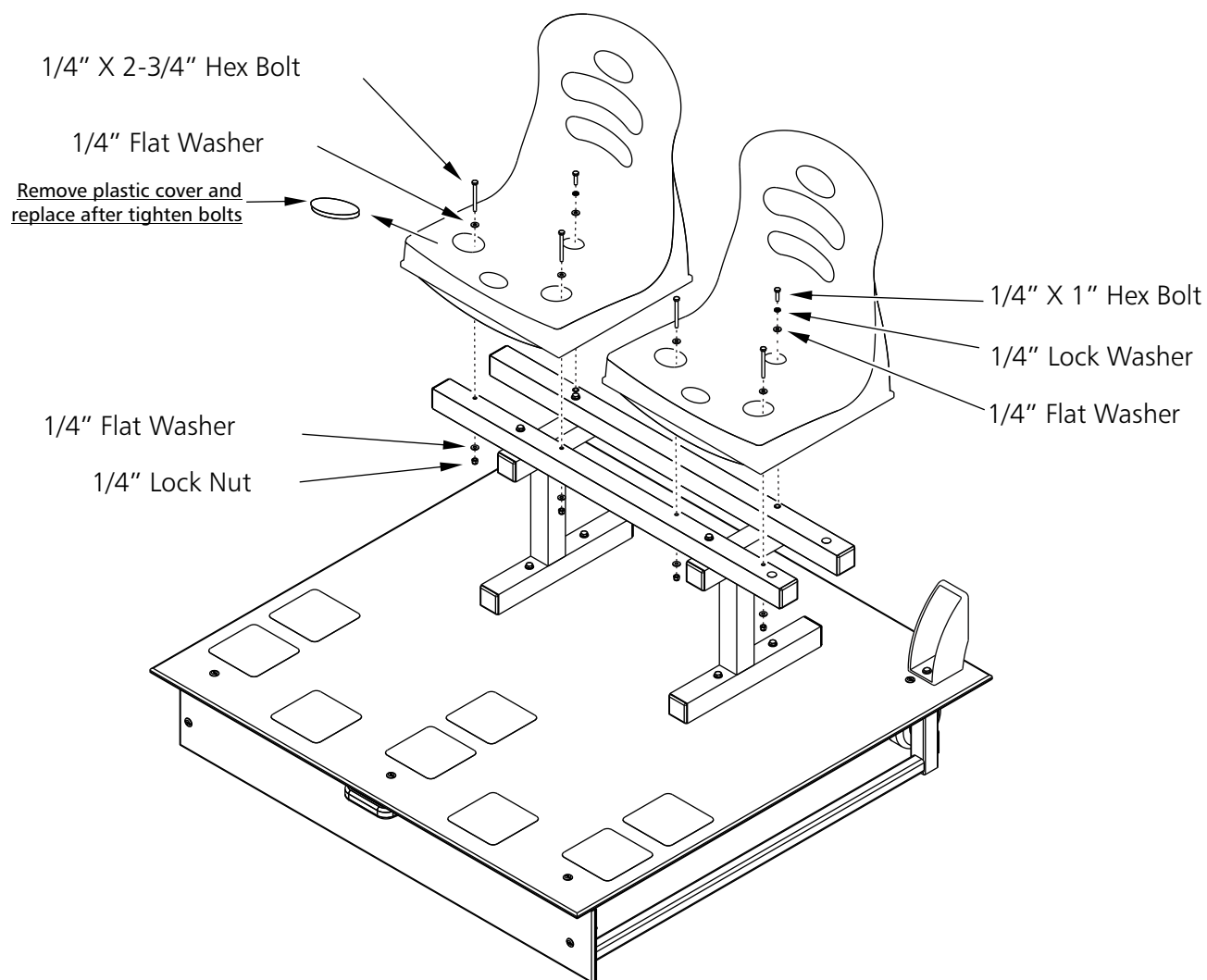

9. Starting at one end, lift handle on seat deck frame to roll in place inside shelter.

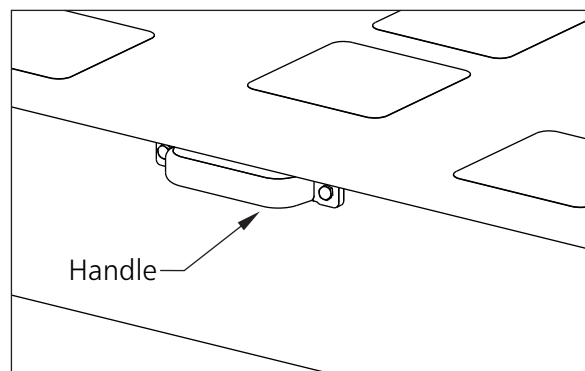
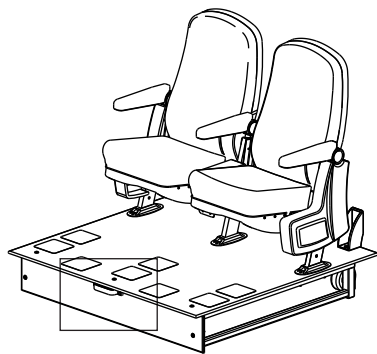

2ND ROW PLACEMENT IN SHELTER FRAME

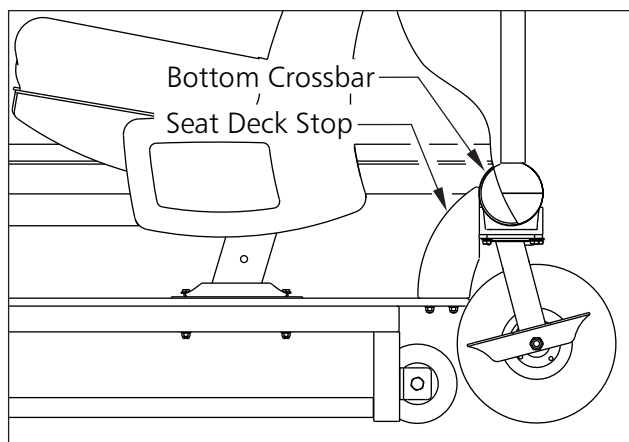
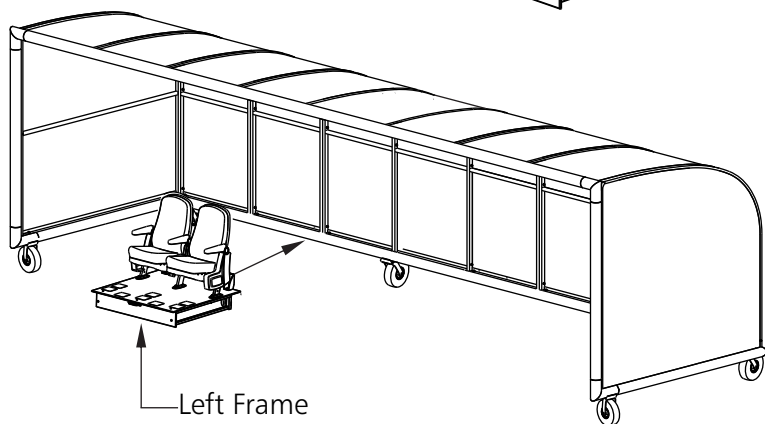

2ND ROW ARRANGEMENT SHELTER FRAME

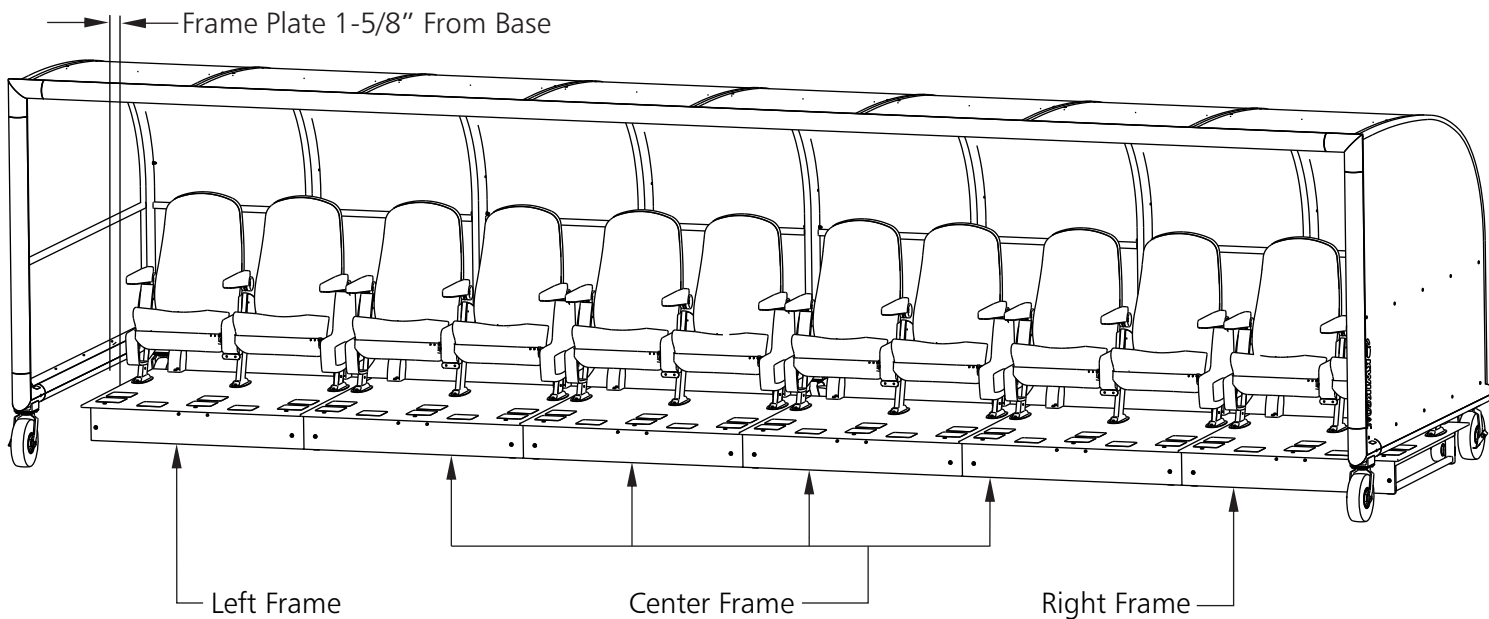

Go to kwikgoal.com for additional product information.



ASSEMBLY INSTRUCTIONS FOR 9B552-02
2ND ROW CENTER MOLDED SEAT KIT

1. Unpack all parts and check for damage that may have occurred during shipping. If damage has occurred, notify Kwik Goal immediately. Lay out all parts. Remove all cardboard and packaging immediately. Wet or damp packaging may damage contents.
2. Read through entire instruction before beginning assembly and installation.

Parts

Molded Seat (2)
(Part# VZ689)

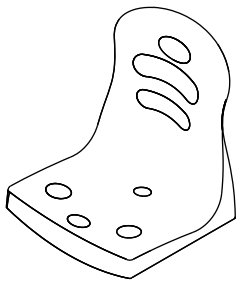

Seat Frame (2)
(Part# UZ1677)

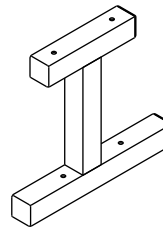

2nd Row Deck (1)
(Part # UZ1675)

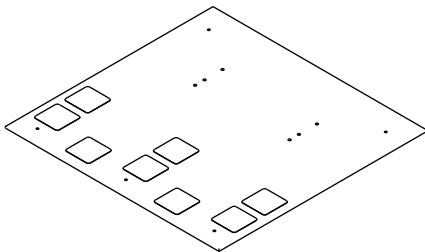

2nd Row Deck Frame (1)
(Part# UZ1671)

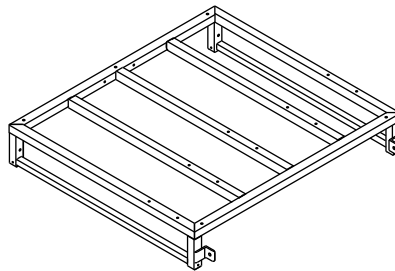

Wheel (2)
(Part# VZ802)

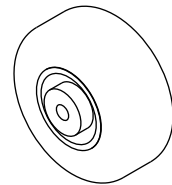

Frame Plate (1)
(Part# UZ1590)

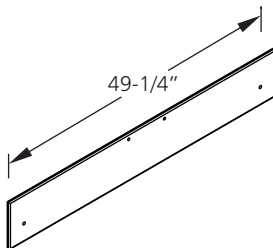

Handle (1)
(Part# VZ679)

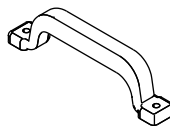

Seat Deck Stop (2)
(Part# VZ838)



Center 2nd Row Seat Deck Hdw (JZ275)

Note: Hardware may be packaged separately in one or more boxes. Open all packages before beginning assembly.

Molded Seat Crossbar Front (1)
(Part# UZ1678)

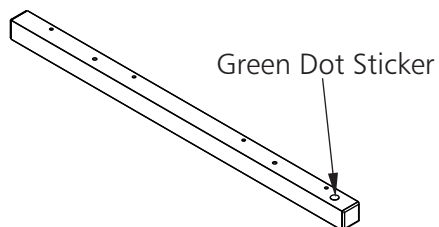

Molded Seat Crossbar Rear (1)
(Part# UZ1679)

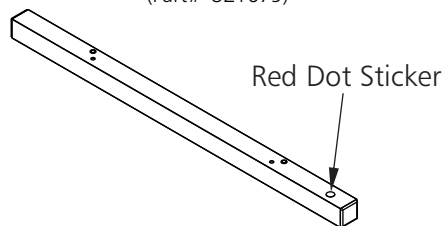

1/4" x 1" Hex Bolt (Part# TZ373)	(2)
1/4" x 1-1/4" Hex Bolt (Part# TZ399)	(4)
1/4" x 3" Sidewalk Bolt (Part# TZ393)	(7)
1/4" x 2-3/4" Hex Bolt (Part# TZ18)	(4)
1/4" x 3" Hex Bolt (Part# TZ385)	(2)
1/4" x 4-3/4" Hex Bolt (Part# TZ299)	(4)
1/4" Lock Nut (Part# TZ19)	(21)
1/4" Flat Washer (Part# TZ147)	(35)
1/4" Lock Washer (Part# TZ187)	(2)
5/16" x 4-1/2" Hex Bolt (Part# TZ377)	(4)
5/16" Flat Washer (Part# TZ4)	(8)
5/16" Lock Nut (Part# TZ321)	(4)
1/2" Jam Nut (Part# TZ318)	(2)
1/2" Lock Nut (Part# TZ349)	(2)
1/2" x 3-1/2" Hex Bolt (Part# TZ320)	(2)

Assembly Tools

7/16", 1/2" & 3/4"
Wrenches

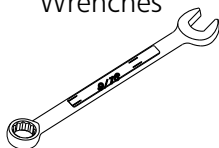

Ratchet with
7/16", 1/2" & 3/4"
Sockets

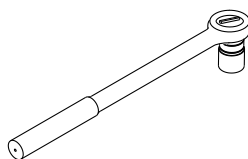

Phillips Screwdriver or Standard Screwdriver
P3

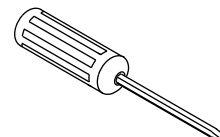
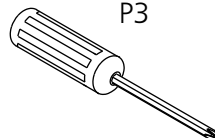

3. Assemble wheels to deck frame as shown. Tighten jam nut. Snug lock nut so that wheel spins freely.

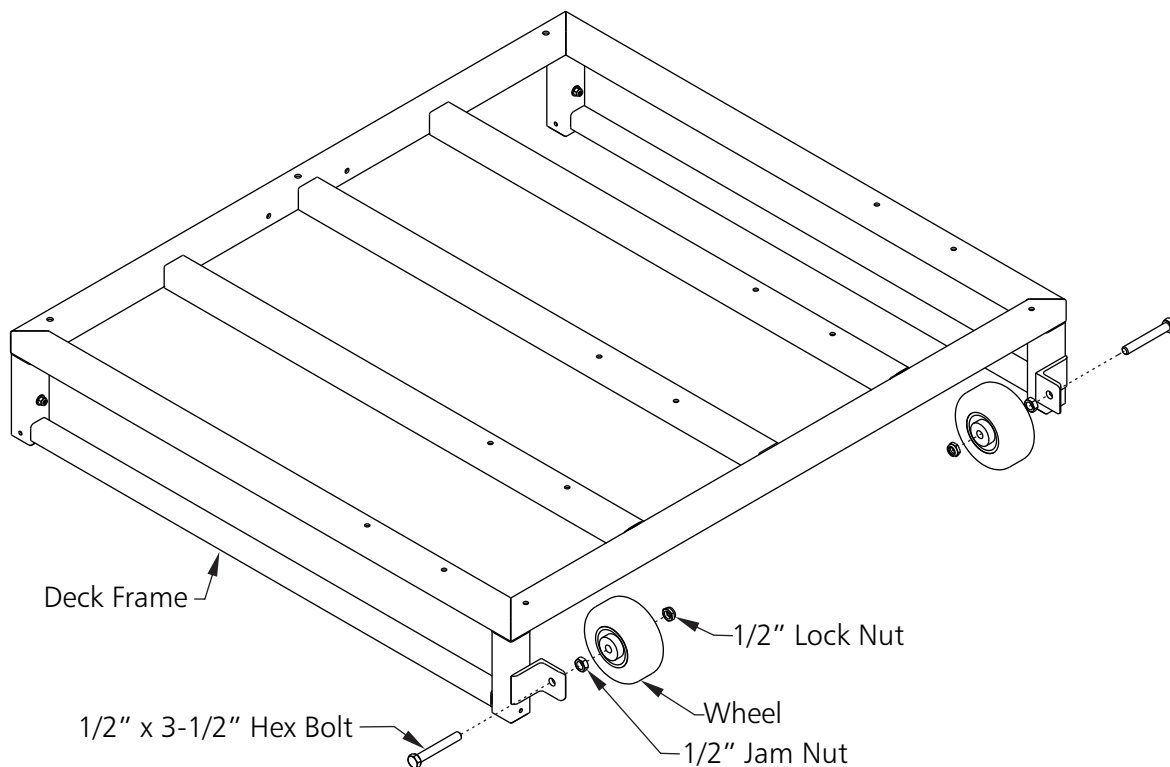

4. Attach frame plate to deck frame.

Note: Top of frame plate must be flush or below top of deck frame. For best appearance, snug sidewalk bolts and tighten hex bolts.

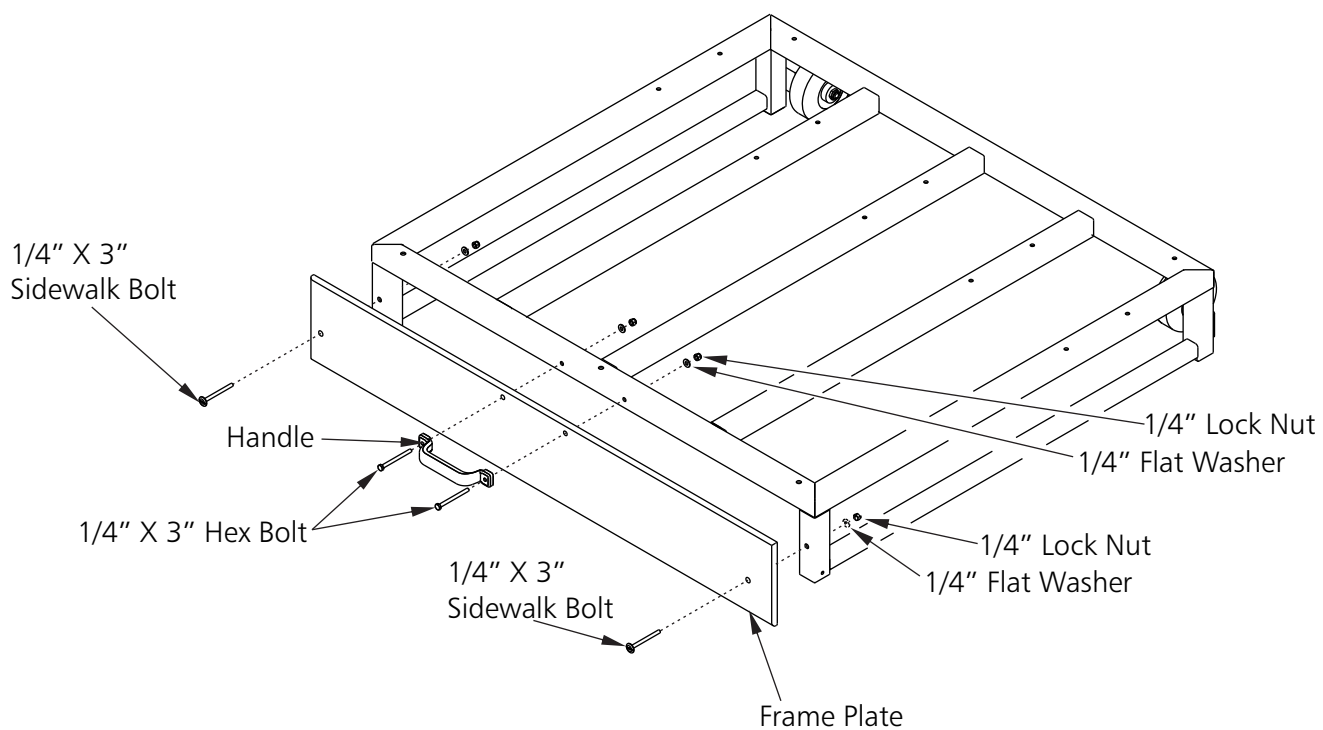

5. Attach 2nd row deck to deck frame and seat deck stops to deck plate as shown.

(Do NOT tighten bolts to deck frame at this time.)

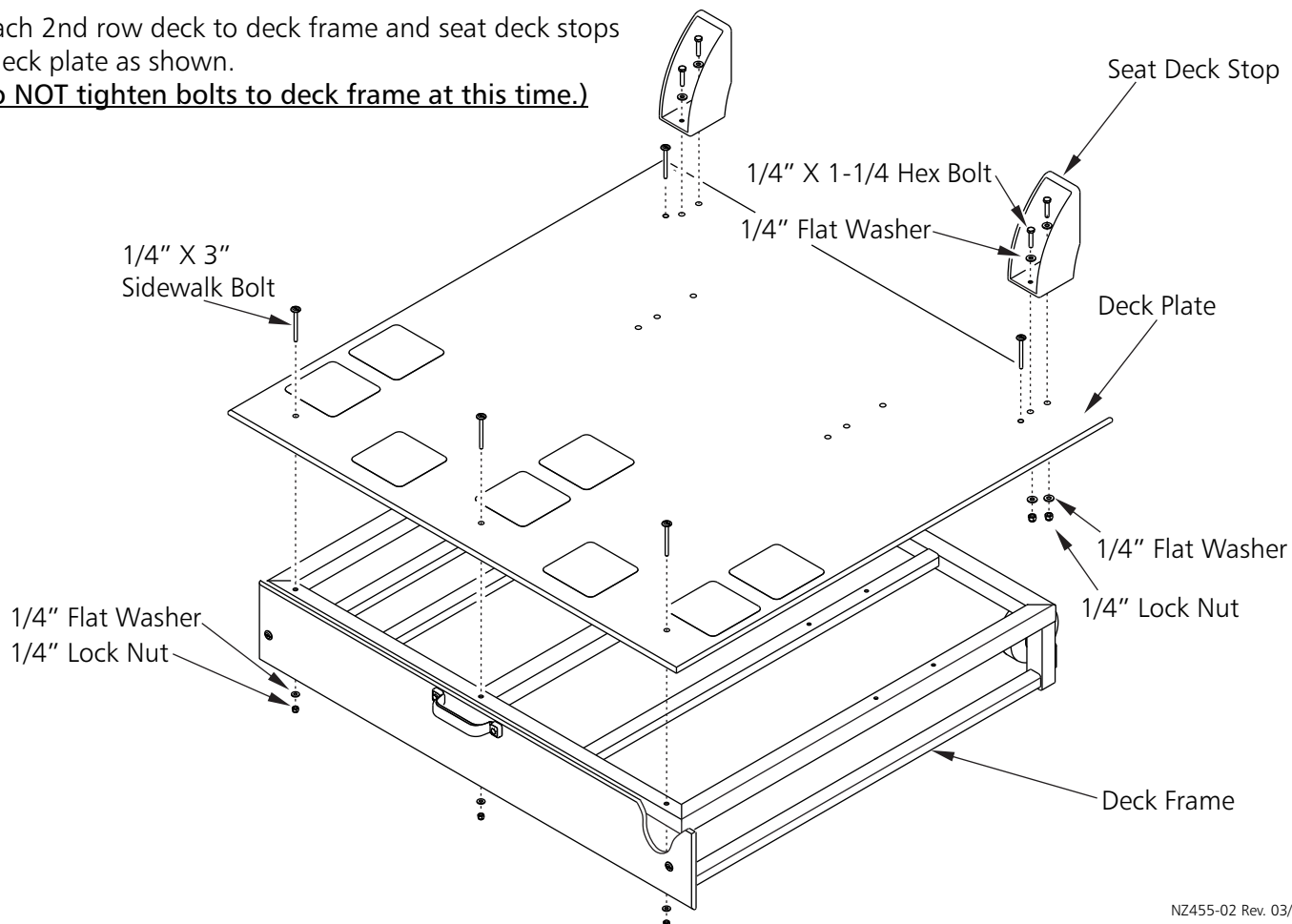

6. Attach seat frames to deck frame as shown.
(Do NOT tighten bolts at this time.)

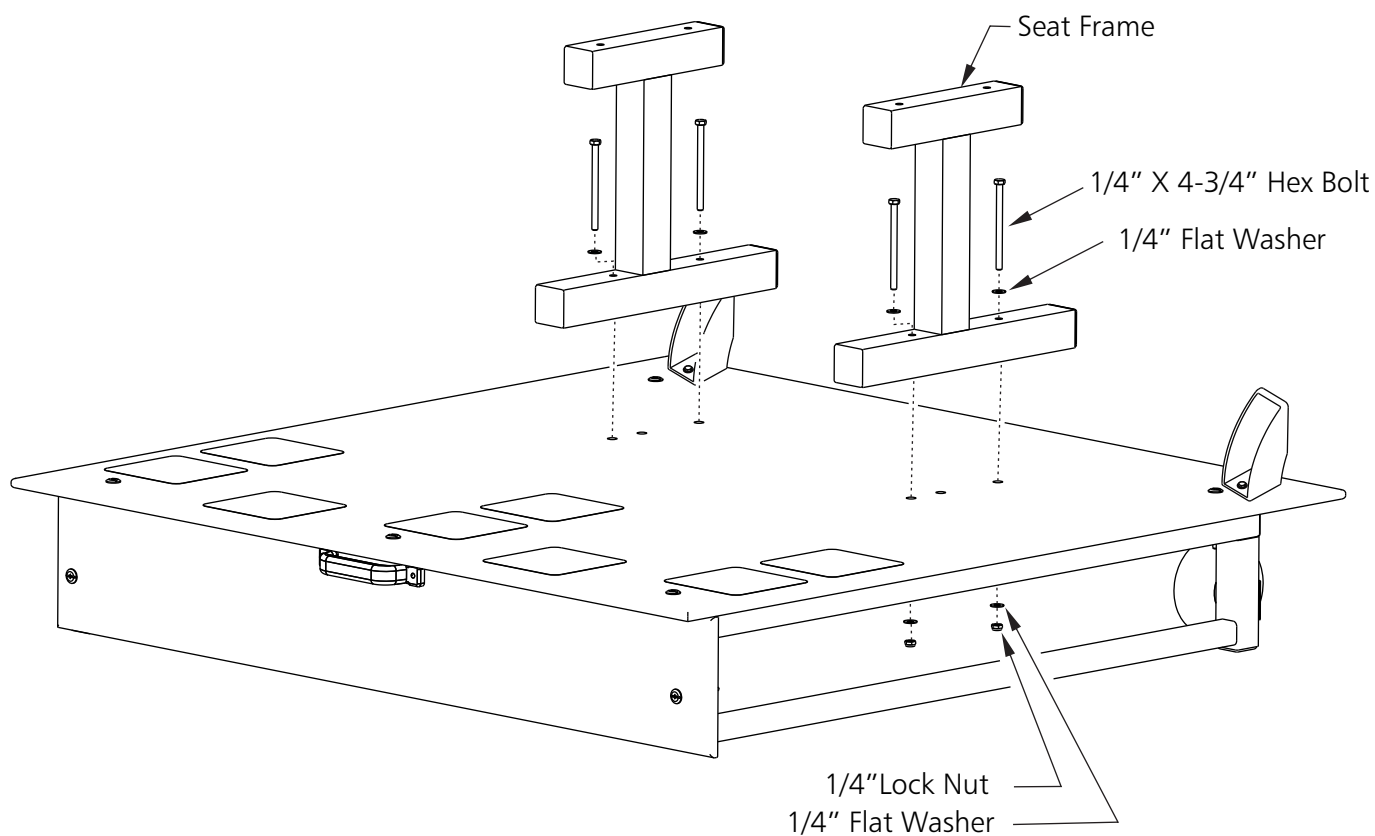

7. Attach the front and rear molded seat crossbars to seat frames as shown. Once the molded seat crossbars are attached, tighten the crossbars to the seat frames. Snug deck to deck frame bolts. Tighten seat frame to deck frame bolts.
(CAUTION DO NOT OVER TIGHTEN BOLTS.)

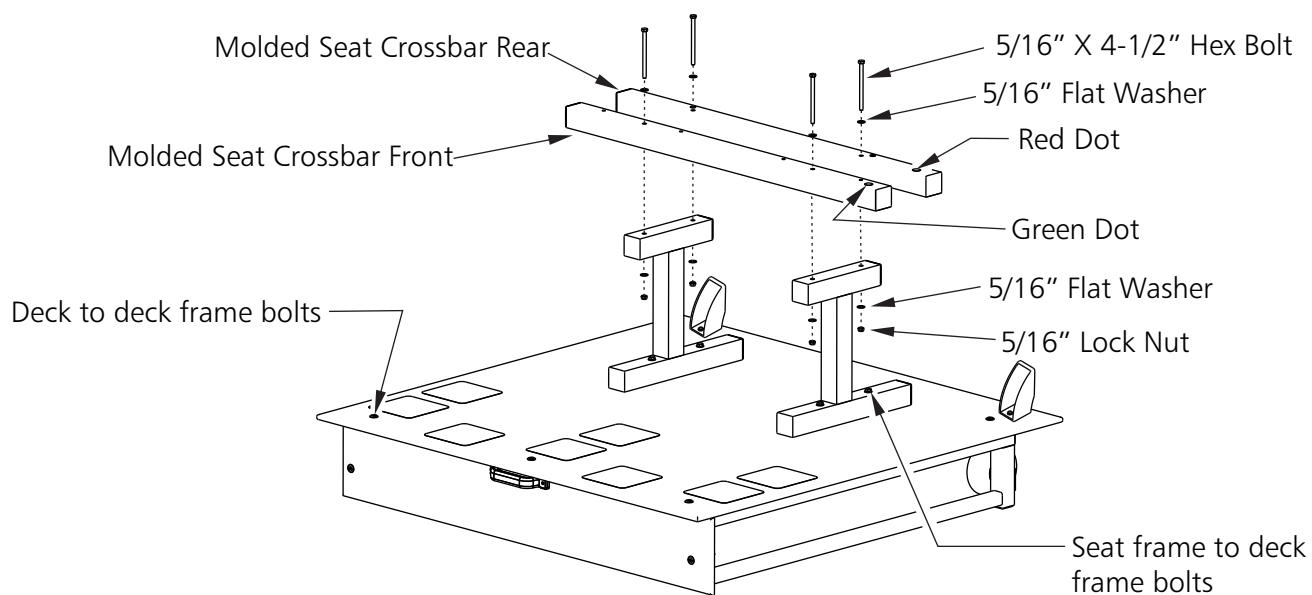

8. Attach molded seats to molded seat crossbars. After both molded seats are attached to molded seat crossbars, tighten all seating bolts.

(CAUTION DO NOT OVER TIGHTEN BOLTS.)

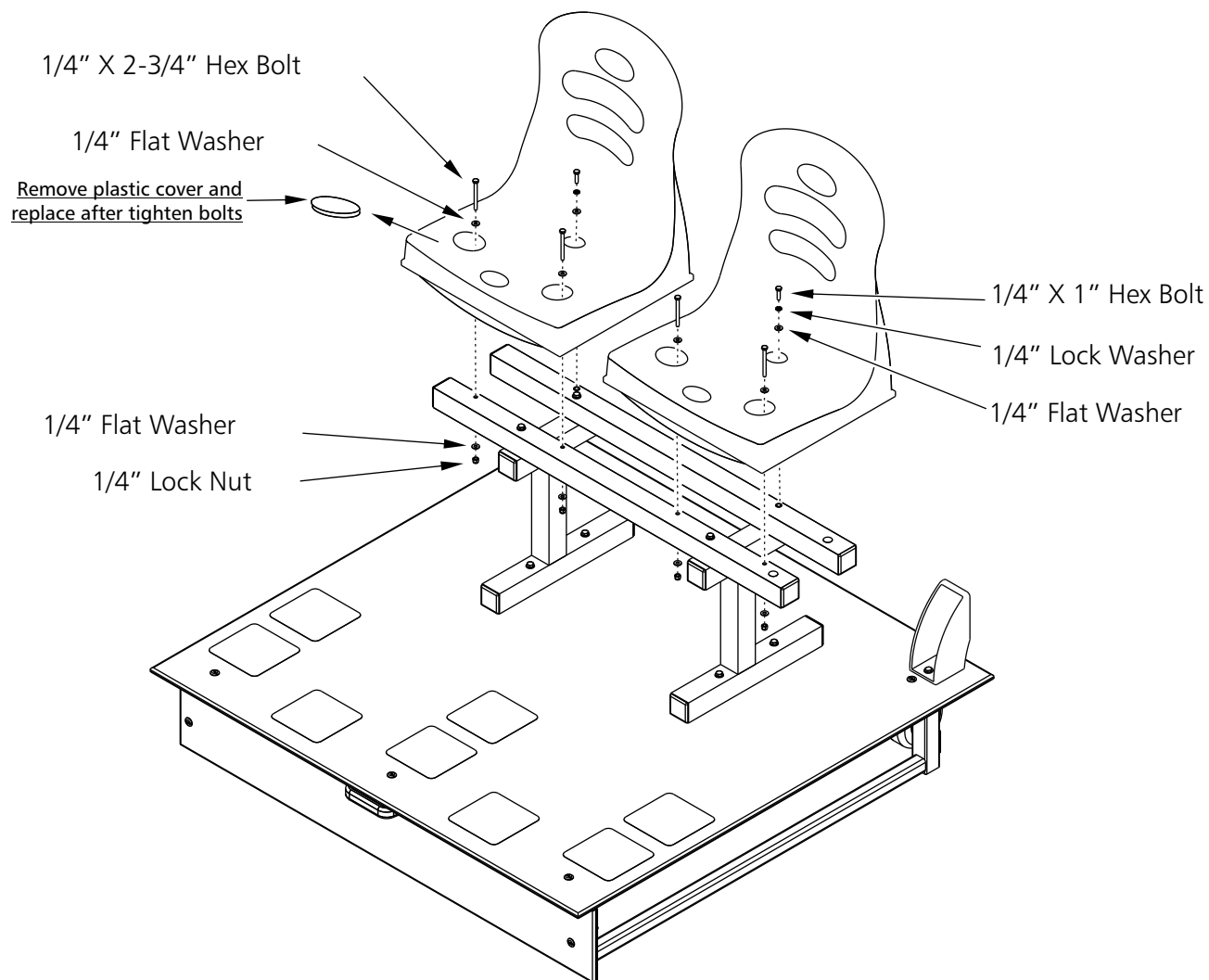

9. Starting at one end, lift handle on seat deck frame to roll in place inside shelter.

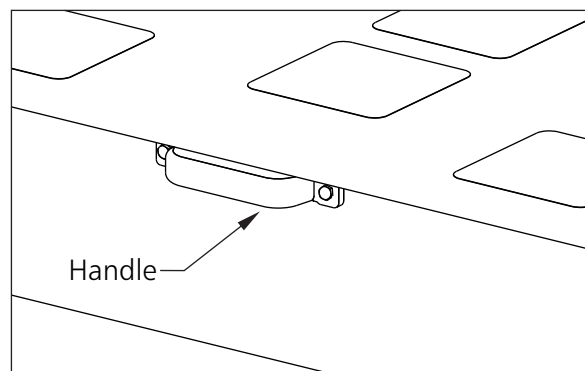
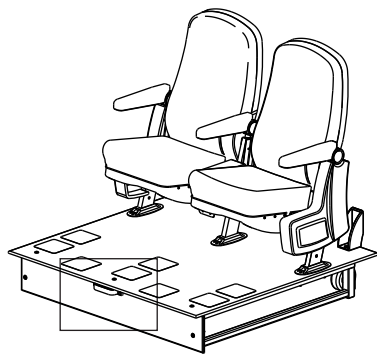

2ND ROW PLACEMENT IN SHELTER FRAME

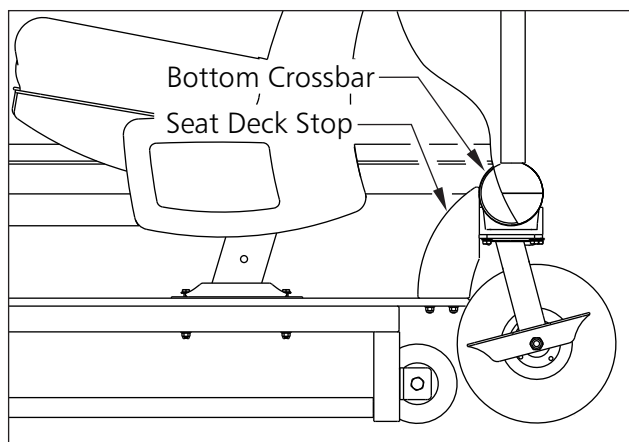
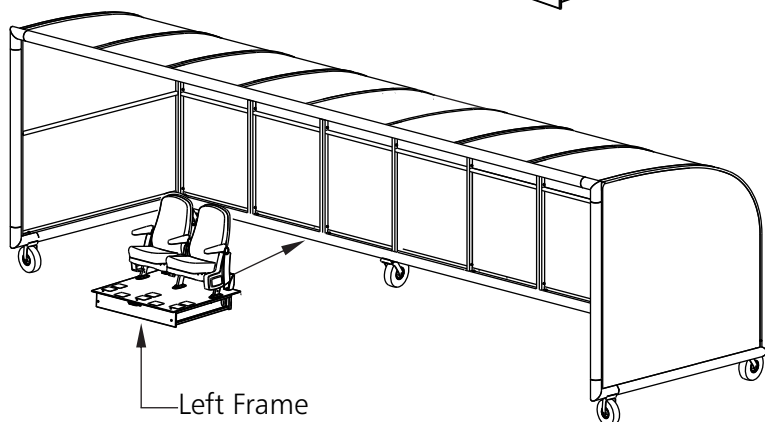

2ND ROW ARRANGEMENT SHELTER FRAME

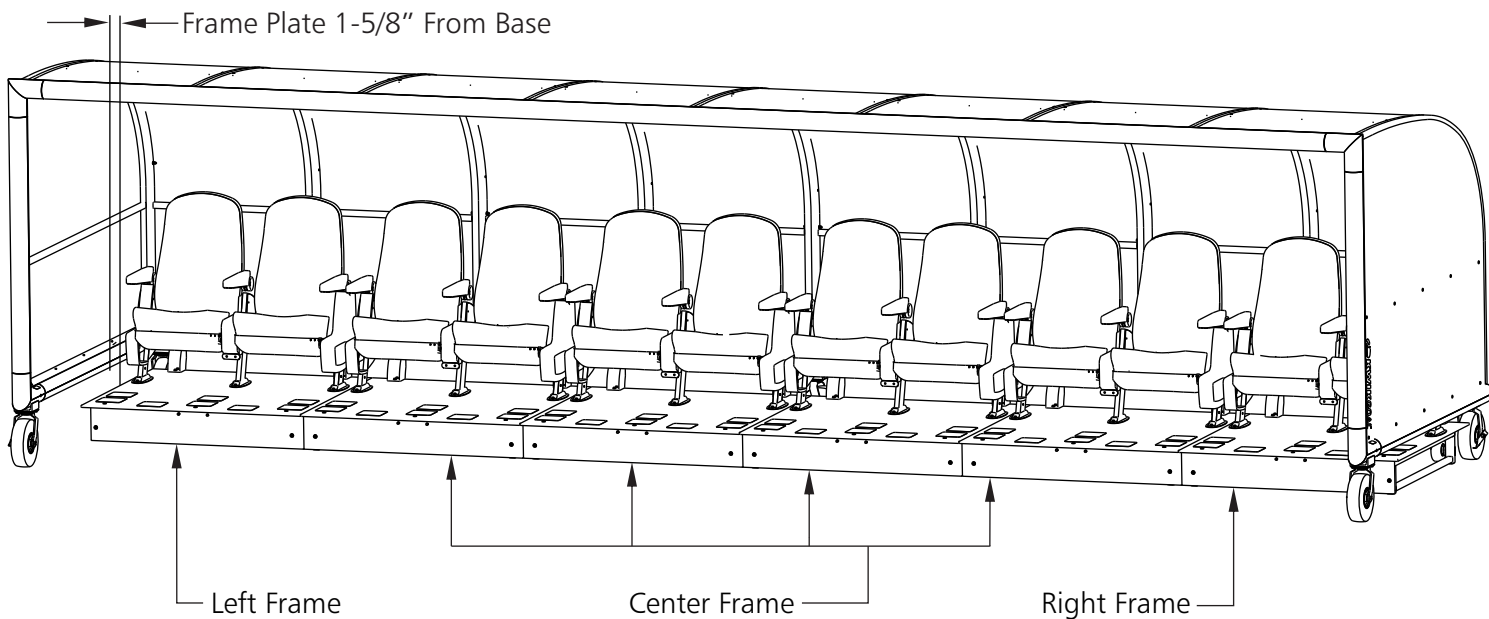

Go to kwikgoal.com for additional product information.



ASSEMBLY INSTRUCTIONS FOR 9B542-03 1st ROW MOLDED SEAT KIT

1. Unpack all parts and check for damage that may have occurred during shipping. If damage has occurred, notify Kwik Goal immediately. Lay out all parts. Remove all cardboard and packaging immediately. Wet or damp packaging may damage contents.
2. Read through entire instruction before beginning assembly and installation.

Parts

Molded Seat (2)
(Part# VZ689)

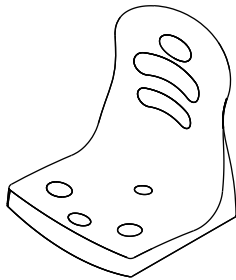

Seat Frame (2)
(Part# UZ1676)

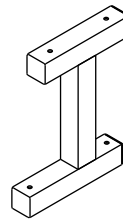

Deck (1)
(Part # UZ1674)

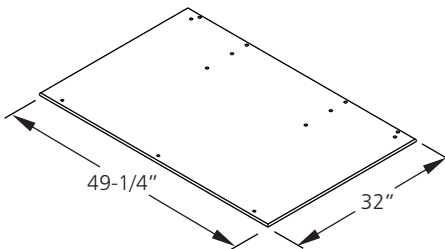

Deck Frame (1)
(Part# UZ1586)

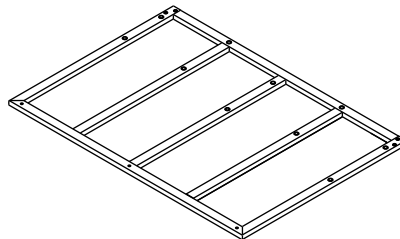

Wheel (2)
(Part# VZ802)

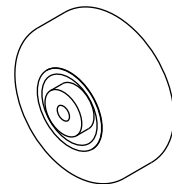

Right Wheel Bracket (1)
(Part# UZ1597)

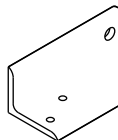

Left Wheel Bracket (1)
(Part# UZ1598)

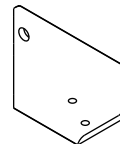

Molded Seat Crossbar Front (1)
(Part# UZ1678)

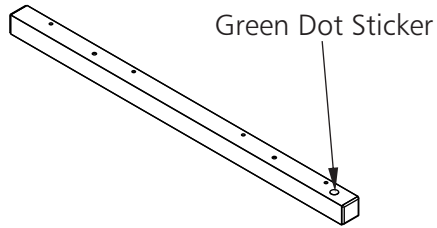

Molded Seat Crossbar Rear (1)
(Part# UZ1679)

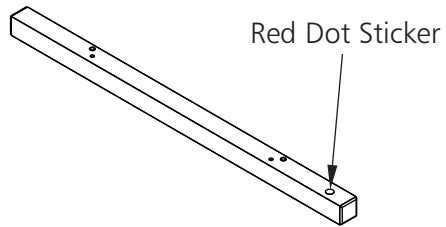

1st Row Seat Deck Hdw (JZ273)

Note: Hardware may be packaged separately in one or more boxes. Open all packages before beginning assembly.

1/4" x 1" Hex Bolt (Part# TZ373)	(2)
1/4" x 1-1/2" Hex Bolt (Part# TZ292)	(4)
1/4" x 1-1/4" Sidewalk Bolt (Part# TZ387)	(3)
1/4" x 2-3/4" Hex Bolt (Part# TZ18)	(4)
1/4" x 3-1/4" Hex Bolt (Part# TZ425)	(4)
1/4" Lock Nut (Part# TZ19)	(7)
1/4" Flat Washer (Part# TZ147)	(21)
1/4" Lock Washer (Part# TZ187)	(10)
5/16" x 4-1/2" Hex Bolt (Part# TZ377)	(4)
5/16" Flat Washer (Part# TZ4)	(8)
5/16" Lock Nut (Part# TZ321)	(4)
1/2" Jam Nut (Part# TZ318)	(2)
1/2" Lock Nut (Part# TZ349)	(2)
1/2" x 3-1/2" Hex Bolt (Part# TZ320)	(2)

Assembly Tools

7/16", 1/2" & 3/4"
Wrenches

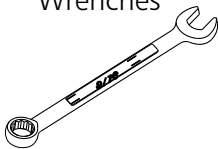

Ratchet with
7/16", 1/2" & 3/4"
Sockets

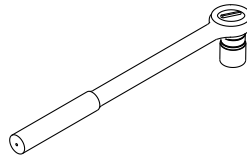

Phillips Screwdriver
P3

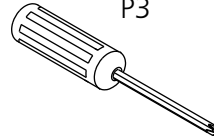

Standard Screwdriver

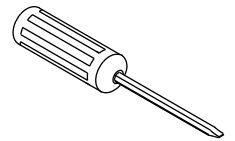

3. Assemble wheel assemblies as shown.

Right Wheel Assembly

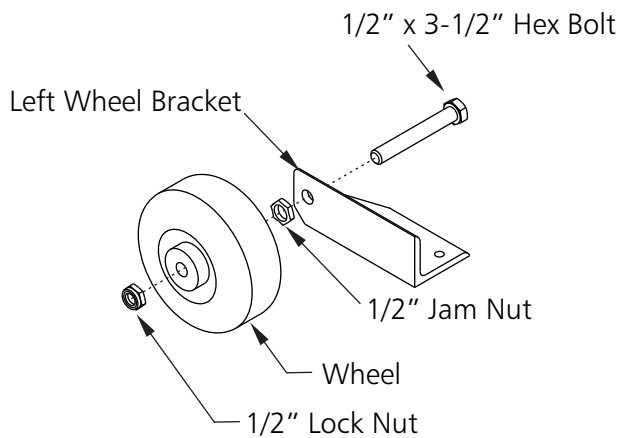

Left Wheel Assembly

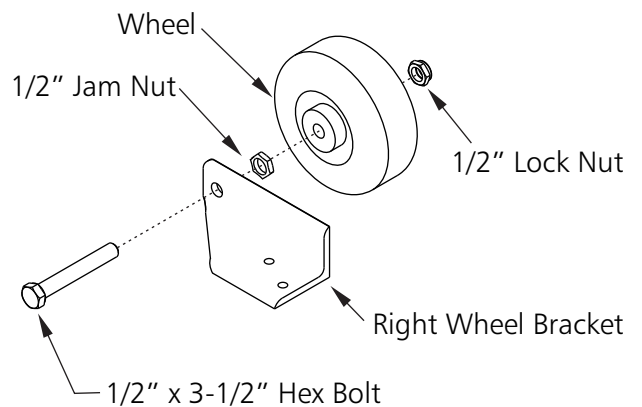

4. Attach deck to deck frame as shown.
(Do NOT tighten bolts at this time.)

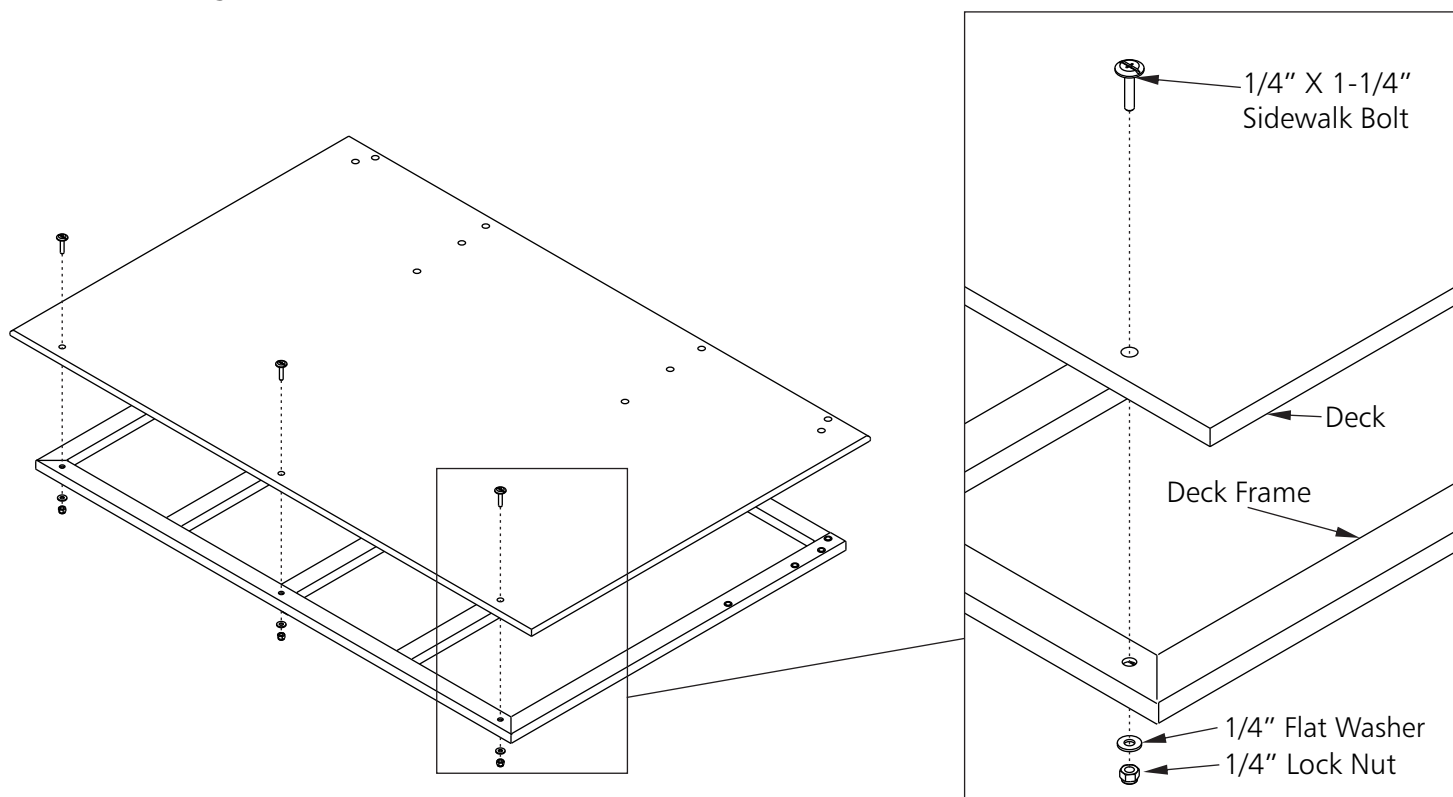

5. Attach the seat frames to deck frame as shown.
(Do NOT tighten bolts at this time.)

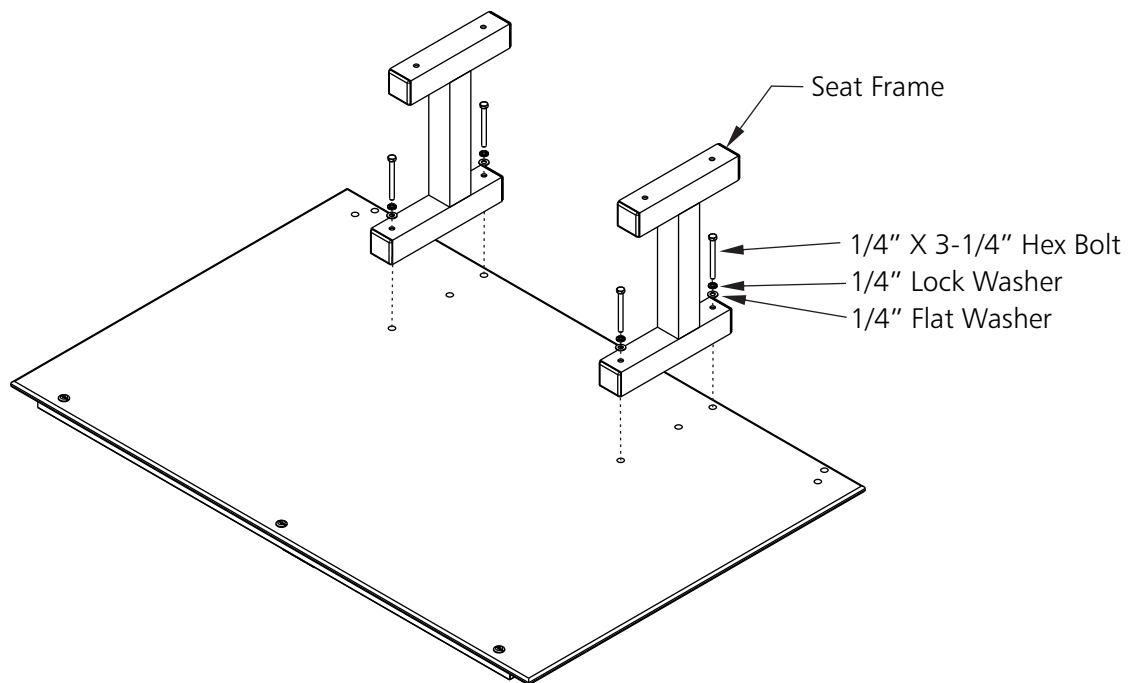

6. Attach the front and rear molded seat crossbars to seat frames as shown. Once the molded seat crossbars are attached, tighten the crossbars to the seat frames. Snug deck to deck frame bolts.
(CAUTION DO NOT OVER TIGHTEN BOLTS.)

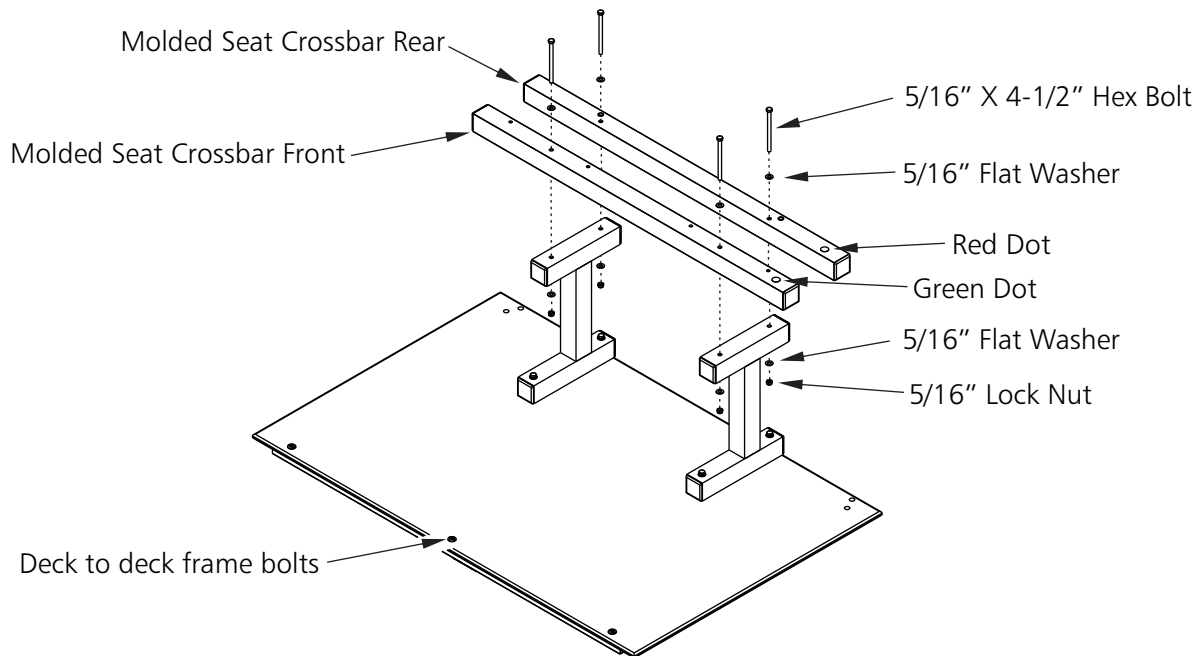

7. Attach molded seats to molded seat crossbars. After both molded seats are attached to molded seat crossbars, tighten all seating bolts.
(CAUTION DO NOT OVER TIGHTEN BOLTS.)

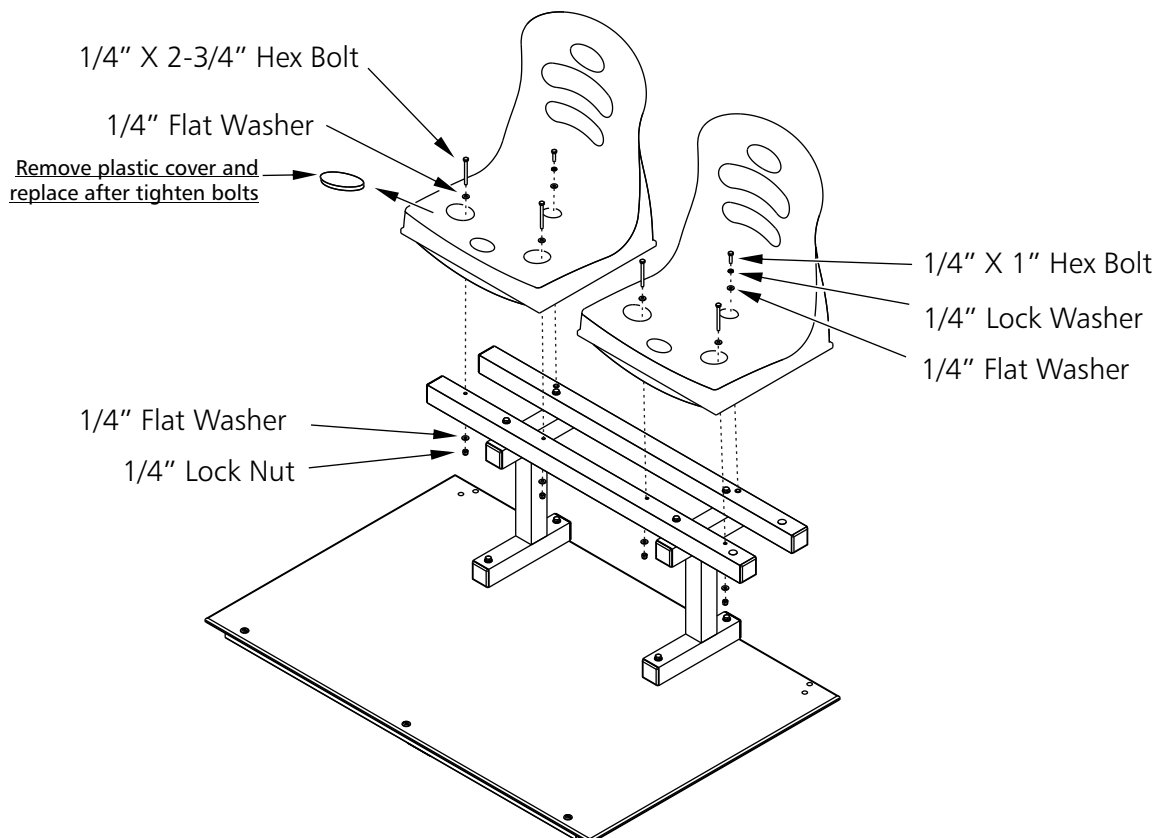

8. Attach wheel assemblies as shown below. Tighten seat frame to deck bolts.

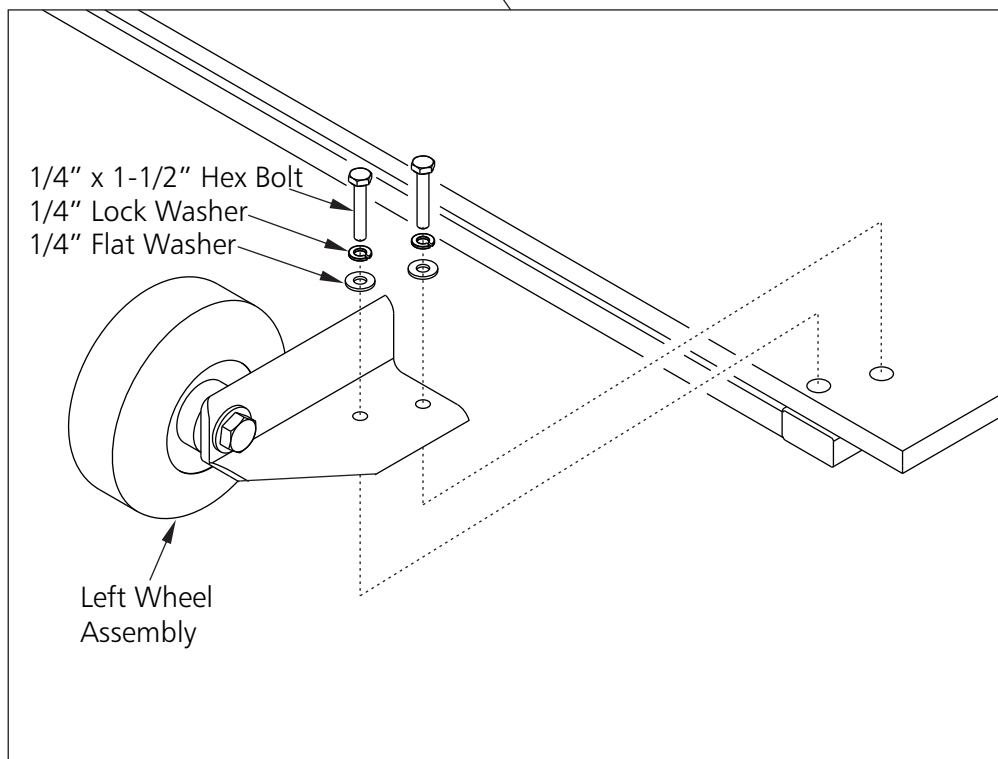
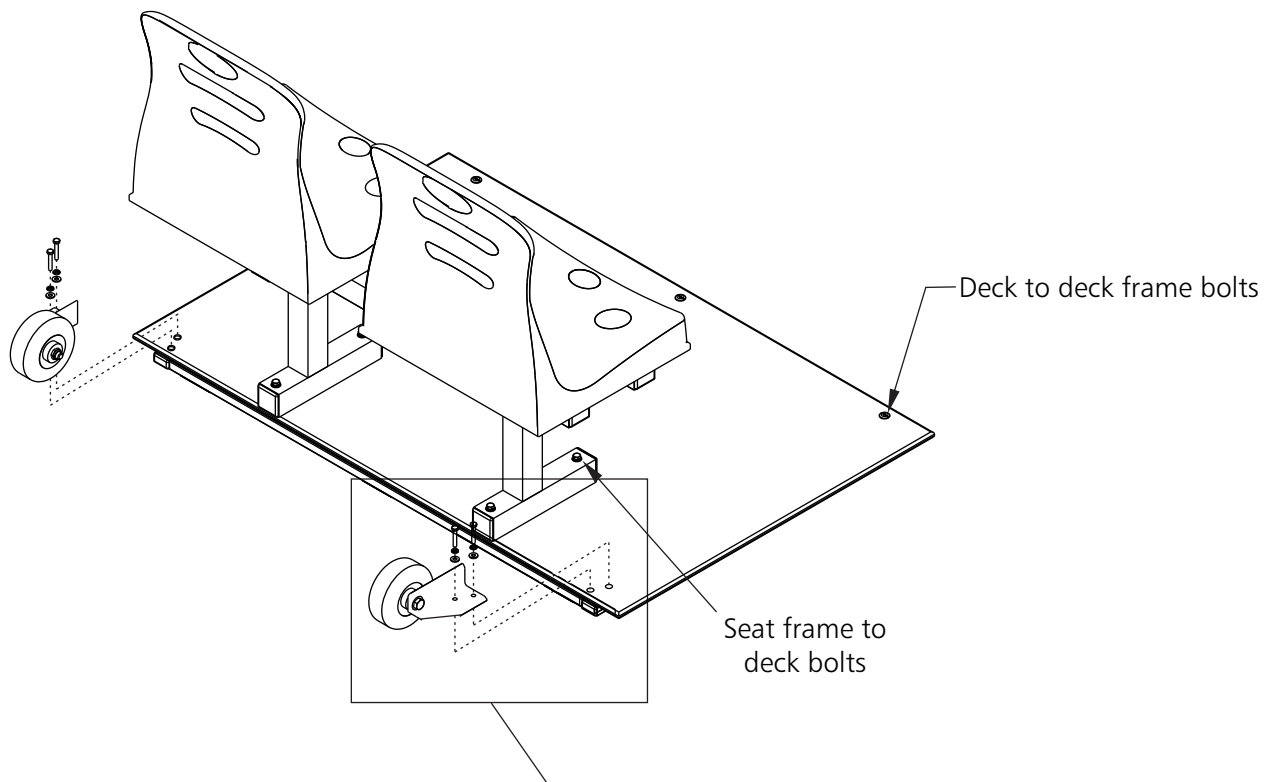

9. Recommended seating arrangement shown below.

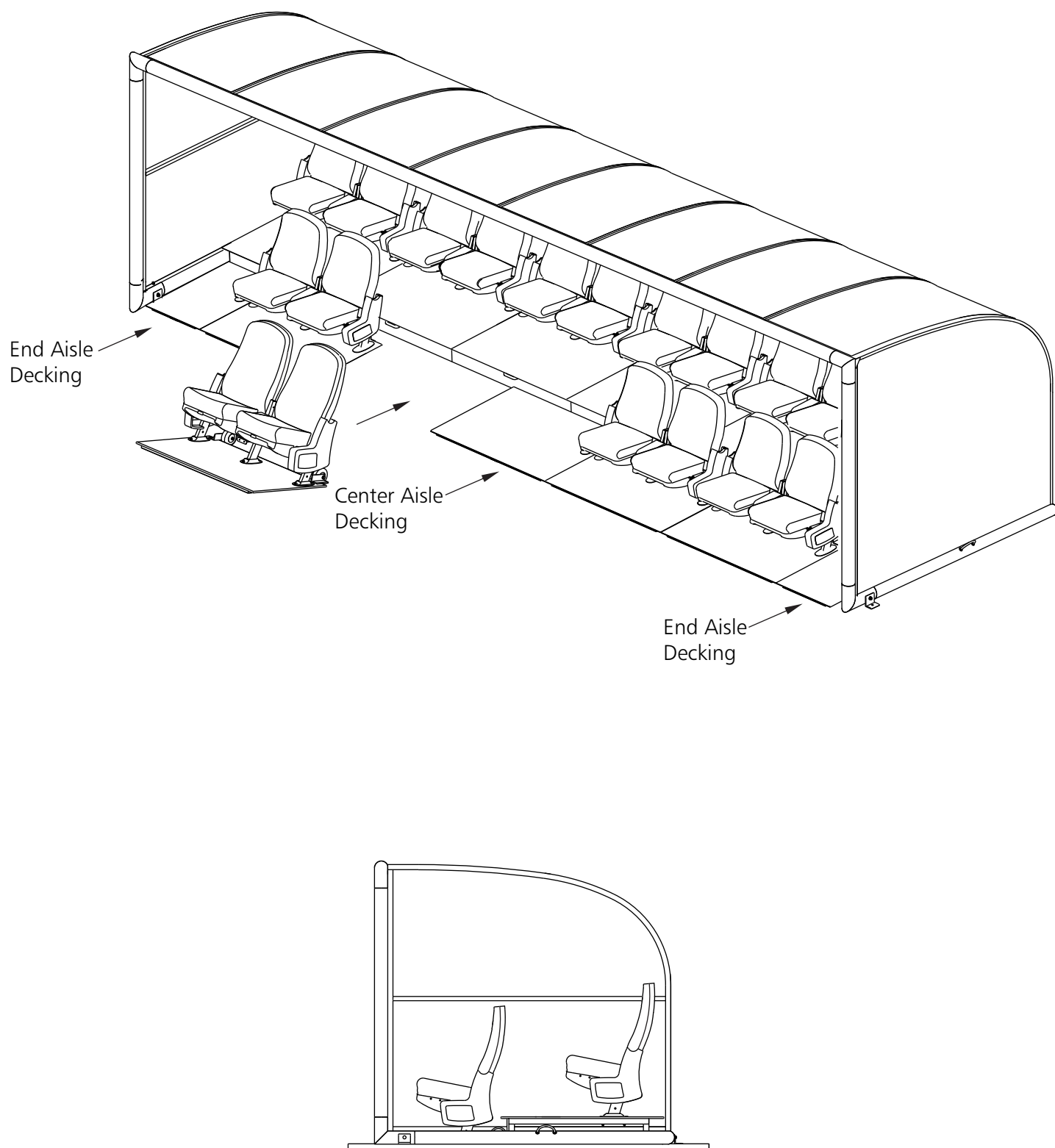

Go to kwikgoal.com for additional product information.



ASSEMBLY INSTRUCTIONS FOR 9B543-04 DOUBLE AISLE FRAME AND DECKING

1. Unpack all parts and check for damage that may have occurred during shipping. If damage has occurred, notify Kwik Goal immediately. Lay out all parts. Remove all cardboard and packaging immediately. Wet or damp packaging may damage contents.
2. Read through entire instruction before beginning assembly and installation.

Parts

Double Aisle Deck (1)
(Part #UZ1594)

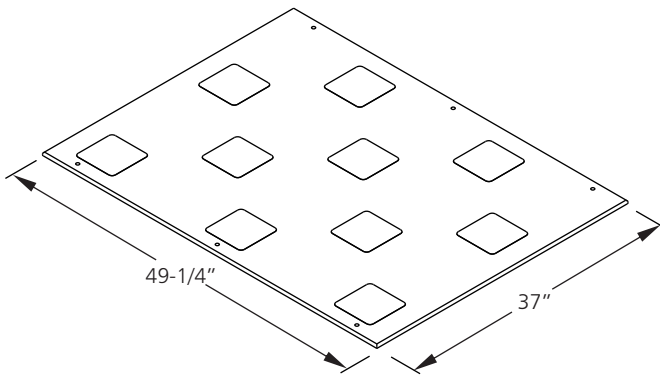

Double Aisle Deck Frame (1)
(Part# UZ1587)

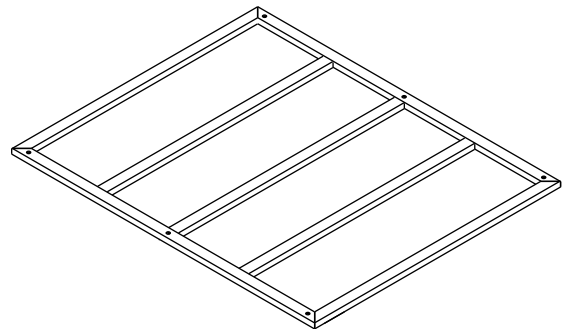

Hardware

Note: Hardware may be packaged separately in one or more boxes. Open all packages before beginning assembly.

1/4" x 1-1/4" Sidewalk (Part# TZ387)	(6)
1/4" Lock Nut (Part# TZ19)	(6)
1/4" Flat Washer (Part# TZ147)	(6)

Assembly Tools

Ratchet with
7/16" Socket

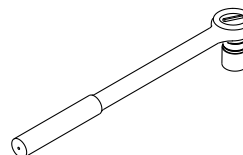

Phillips Screwdriver
P3

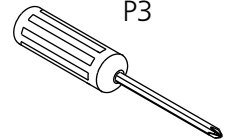

3. Assemble the double aisle deck frame plate to deck frame as shown.

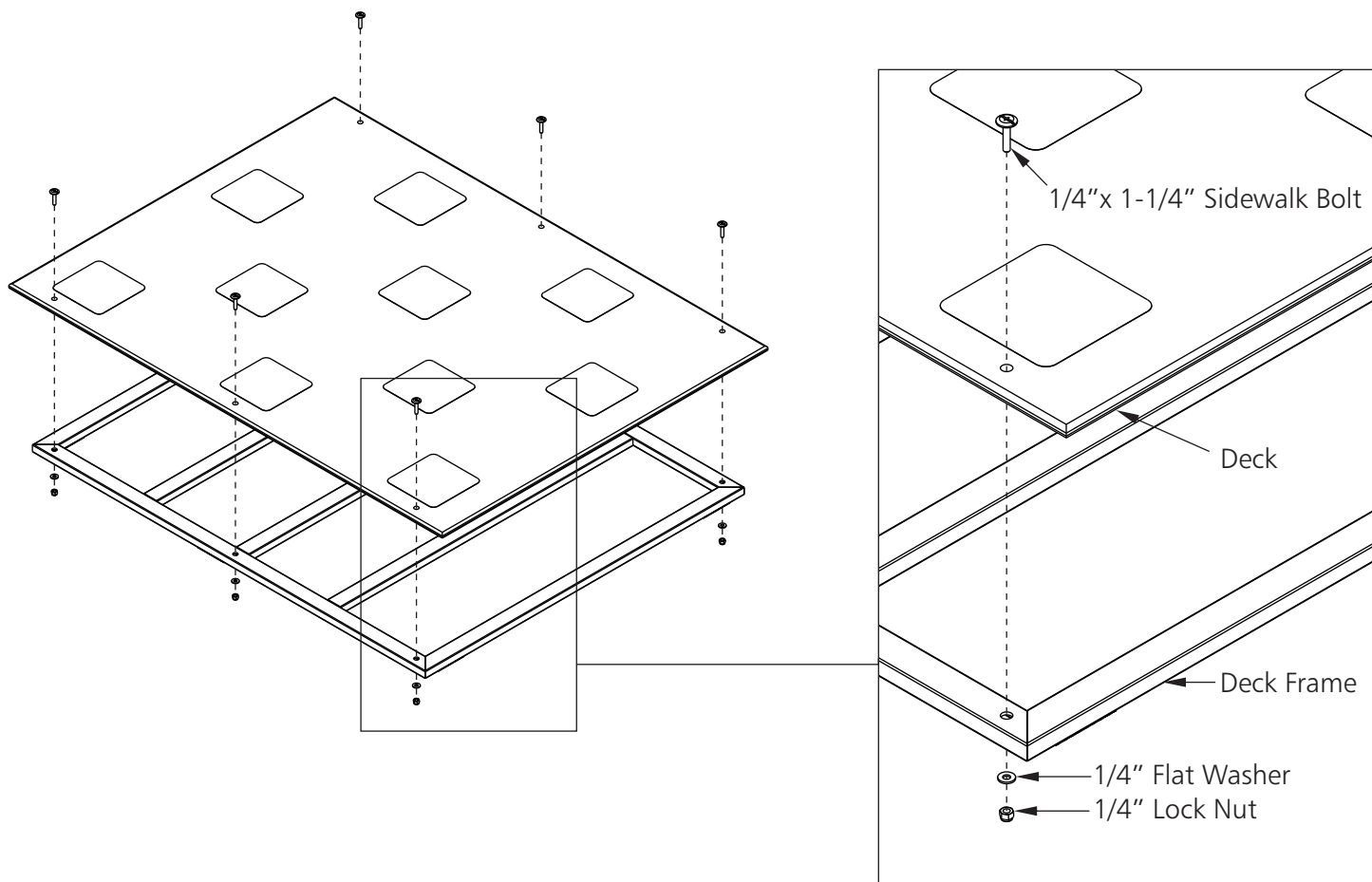

4. Recommended aisle deck arrangement shown below.

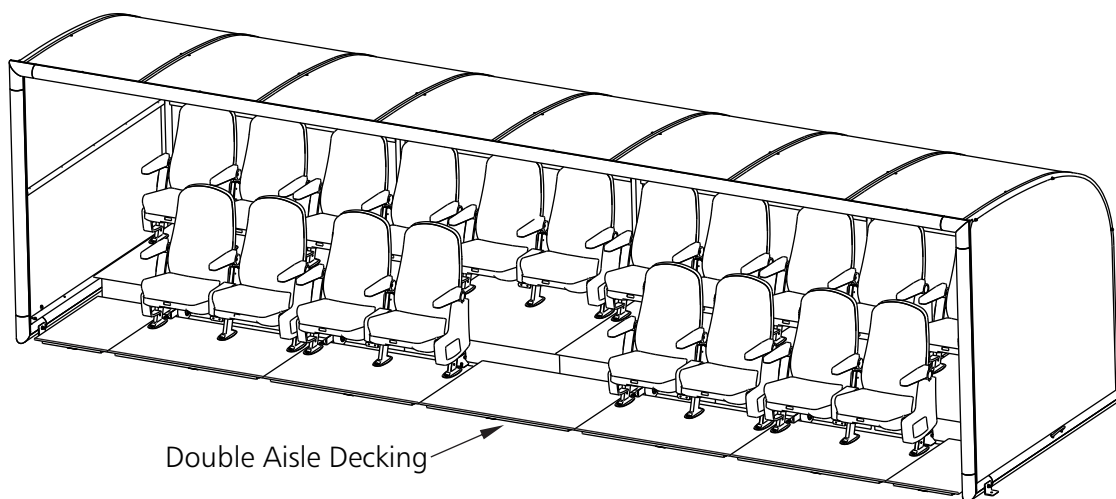

Go to kwikgoal.com for additional product information.



ASSEMBLY INSTRUCTIONS FOR 9B543-05 AISLE FRAME AND DECKING

1. Unpack all parts and check for damage that may have occurred during shipping. If damage has occurred, notify Kwik Goal immediately. Lay out all parts. Remove all cardboard and packaging immediately. Wet or damp packaging may damage contents.
2. Read through entire instruction before beginning assembly and installation.

Parts

Single Aisle Deck (1)
(Part #UZ1595)

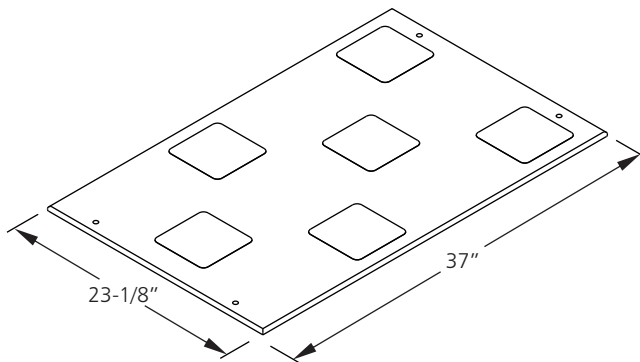

Single Aisle Deck Frame (1)
(Part# UZ1588)

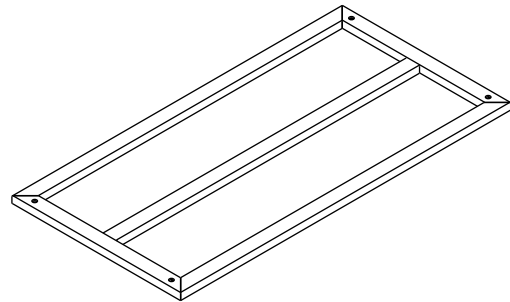

Hardware

Note: Hardware may be packaged separately in one or more boxes. Open all packages before beginning assembly.

1/4" x 1-1/4" Sidewalk (Part# TZ387)	(4)
1/4" Lock Nut (Part# TZ19)	(4)
1/4" Flat Washer (Part# TZ147)	(4)

Assembly Tools

Ratchet with
7/16" Socket

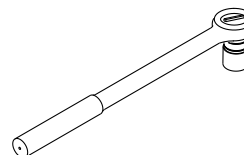

Phillips Screwdriver
P3

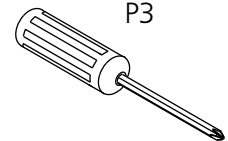

3. Assemble the single aisle deck frame plate to deck frame as shown.

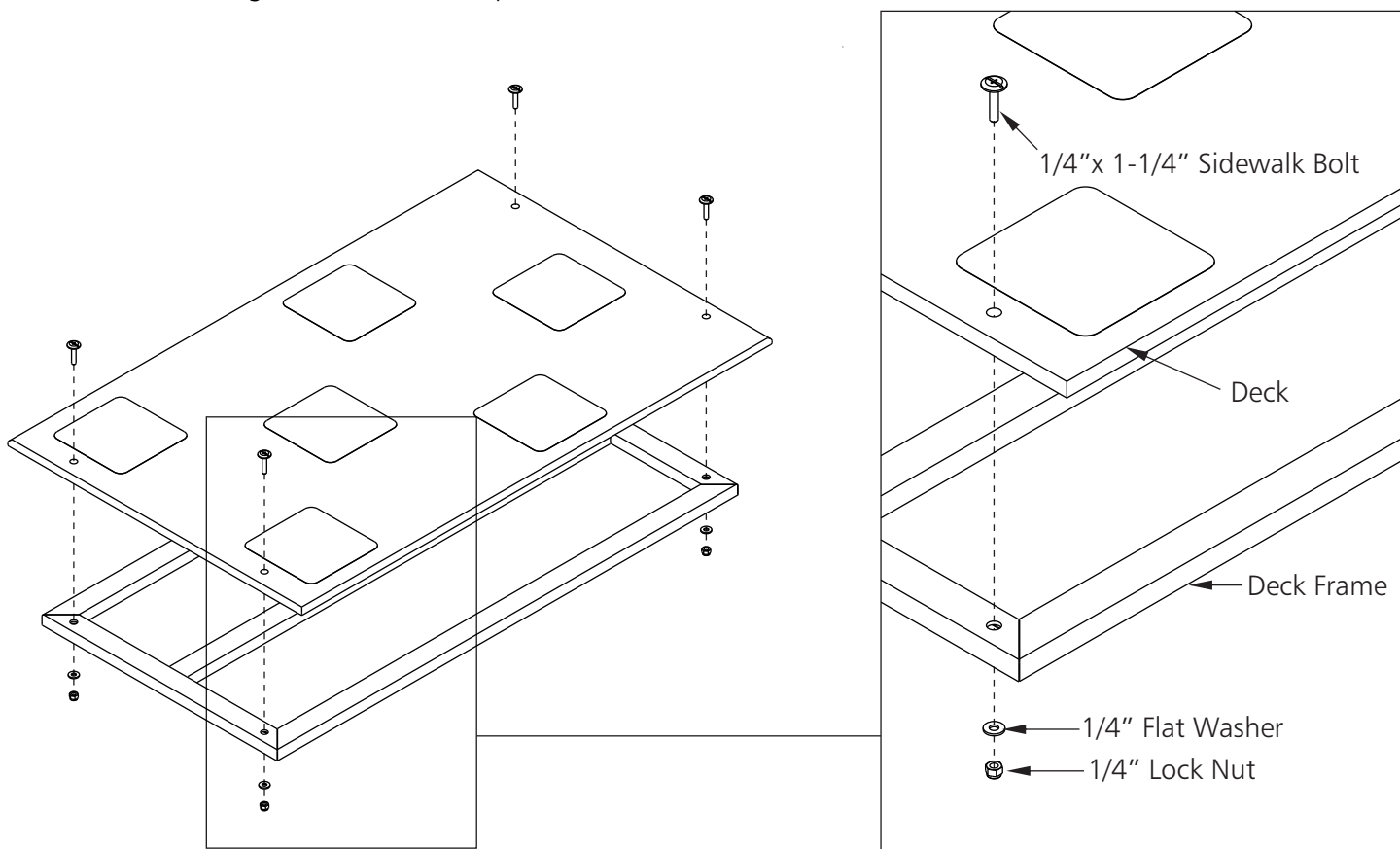

4. Recommended aisle deck arrangement shown below.

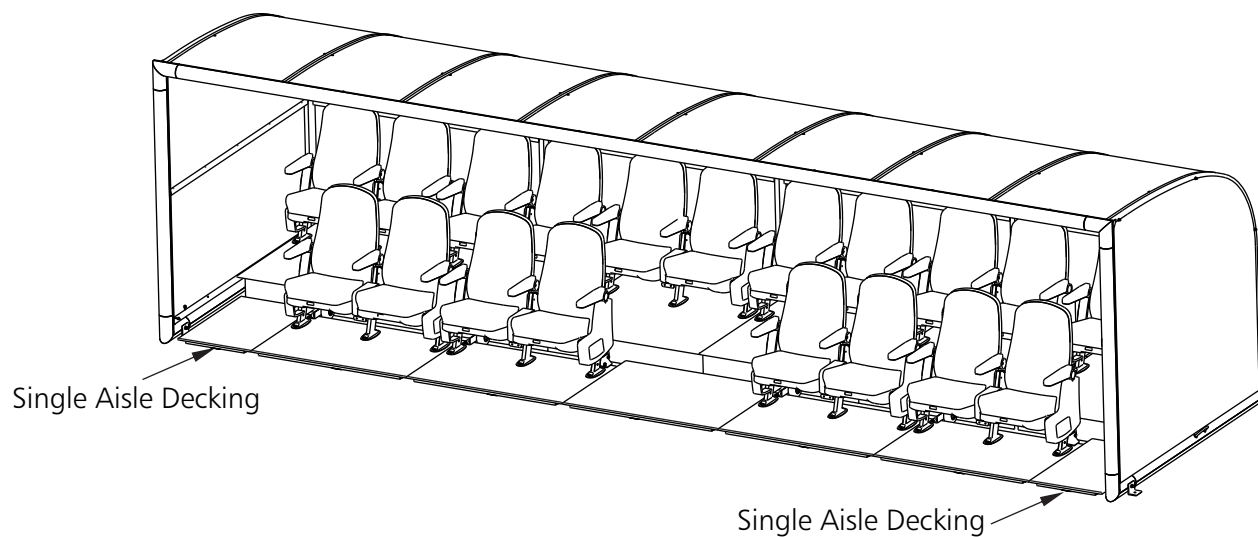

Go to kwikgoal.com for additional product information.



SHELTER CARE INSTRUCTIONS

Kwik Goal shelters are made with the best materials available for outdoor use. However, long term weather exposure will diminish their appearance. Storing shelters out of direct sunlight, or indoors, whenever practical will prolong their life.

Direct contact covering of shelters is NOT recommended. Trapped moisture, dirt, and increased temperature may cause more damage than leaving the units exposed to weather. If a cover is used, be sure it is made of a breathable, heat reflective material.

For best appearance, occasional cleaning of your shelter and seating may be necessary. It is important to use proper procedures and materials to avoid damaging surfaces and finishes.

1. Choose an appropriate time of day and location. Avoid direct sunlight and high temperatures.
2. Remove luxury seats and clean separately, according to LUXURY SEAT CLEANING INSTRUCTIONS below. Benches and molded seats may be cleaned with shelter.
3. Rinse thoroughly with clean, warm water to remove loose dirt.
4. Use a soft microfiber cloth or non-abrasive sponge with diluted, mild soap to gently wash the unit. Joy® and Palmolive Liquid® are acceptable mild soaps.
5. Immediately rinse thoroughly with clean, warm water.
6. Dry with a soft, clean cloth to prevent water spots.

NOTE: DO NOT use ammonia or ammonia based cleaners. Most formulas of Windex® contain ammonia.

LUXURY SEAT CLEANING INSTRUCTIONS

1. Use a soft cloth dampened with 10% mild dish soap and warm water solution to wipe vinyl seating and metal framework clean. Joy® and Palmolive Liquid® are acceptable mild dish soaps.
2. Wipe with soft cloth dampened with plain warm water to remove soap solution.
3. Allow to air dry.

**NOTE: Avoid drenching or flooding luxury seats with water.
DO NOT use silicone based protectants on vinyl seating.**

⚠ WARNING

THIS EQUIPMENT MUST BE STORED IN A SECURED, SHELTERED AREA WHEN NOT IN USE OR IN THE THREAT OF HIGH WINDS. ANY WEATHER DAMAGE TO THIS EQUIPMENT WILL NOT BE COVERED UNDER KWIK GOAL'S PRODUCT GUARANTEE. DO NOT LEAVE THIS EQUIPMENT UNATTENDED.