



ASSEMBLY INSTRUCTIONS FOR ALL 9B51 PORTABLE SHELTER FRAMES

THIS UNIT MUST BE ASSEMBLED BY A MINIMUM OF TWO QUALIFIED PERSONS

NOTICE Sunlight reflecting off polycarbonate panels can contribute to increased temperatures of surrounding objects. In certain situations, these increased temperatures can damage some artificial turf surfaces. Kwik Goal is not responsible for any damage to artificial turf.

1. Unpack all parts and check for damage that may have occurred during shipping. If damage has occurred, notify Kwik Goal immediately. Lay out all parts. Remove all cardboard and packaging immediately. Wet or damp packaging may damage contents.
2. Read through entire instruction before beginning assembly and installation.

NOTE: Components may be packaged in one or more additional boxes.

Parts

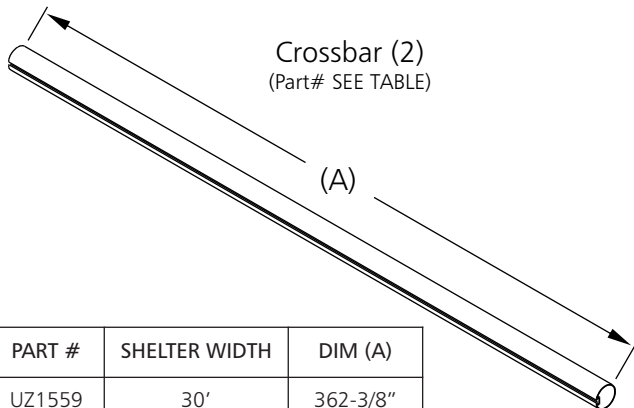

PART #	SHELTER WIDTH	DIM (A)
UZ1559	30'	362-3/8"
UZ1116	24'	287-3/4"
UZ1433	21'	250-7/16"
UZ1434	18'	213-1/8"
UZ1435	15'	175-13/16"
UZ1436	12'	138-1/2"
UZ1114	9'	101-3/16"

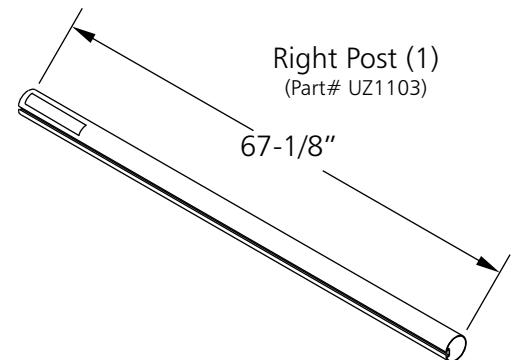
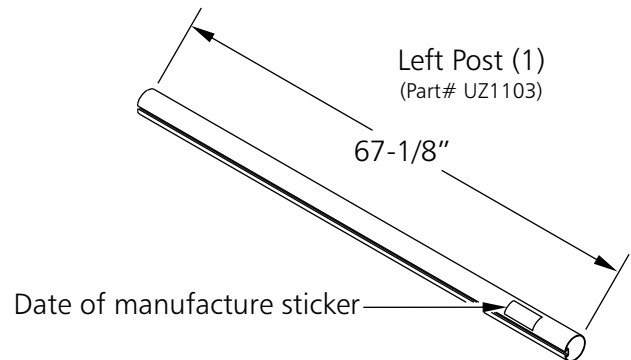

THIS UNIT MUST BE ANCHORED ACCORDING TO THESE INSTRUCTIONS AT ALL TIMES

⚠WARNING

THIS EQUIPMENT MUST BE STORED IN A SECURED, SHELTERED AREA WHEN NOT IN USE OR IN THE THREAT OF HIGH WINDS. ANY WEATHER DAMAGE TO THIS EQUIPMENT WILL NOT BE COVERED UNDER KWIK GOAL'S PRODUCT GUARANTEE. DO NOT LEAVE THIS EQUIPMENT UNATTENDED.



⚠ WARNING **IMPORTANT SAFETY INSTRUCTIONS**
READ CAREFULLY

1. Lifting and moving heavy field equipment can be dangerous if not done properly. All Kwik Goal shelters must be moved by qualified personnel who are experienced in moving large, heavy field equipment. Kwik Goal recommends storing dolly and wheels in a secured area to prevent unauthorized use.
2. A minimum of four qualified, experienced people are required to install wheels and move shelter.
3. Do not attempt to lift, move, or remove anchors from any shelter in windy conditions.
4. Shelters must not be left unattended when wheels are installed.
5. Shelter must be on level, flat ground to use dolly handle and/or wheels.
6. Dolly is to be used as a wheel transport/storage and shelter lifting device. Do not use dolly to move shelter.
7. Use extreme caution when pushing shelter. Excessive force can overturn shelter. Always push at lowest point on shelter frame possible.
8. Do not push shelter directly from the front to rear or rear to front. Push from end to end. (Refer to 9B1201 - Shelter Dolly instructions for details.)
9. Always use two people to lift shelter with dolly. With one person maintaining light pressure on the handle, the second may insert wheels into shelter. Install both wheels before resting shelter on the ground. (Refer to 9B1201 - Shelter Dolly instructions for details.)

NEVER LOWER SHELTER WITH ONLY ONE WHEEL INSTALLED

Parts Continued

Left Base (1)
(Part# UZ1101)

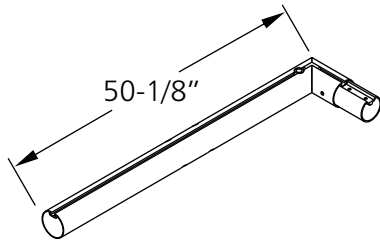

Right Base (1)
(Part# UZ1102)

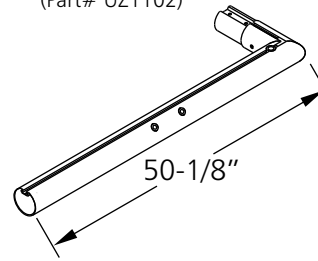

Left Panel (1)
(Part# UZ1098)

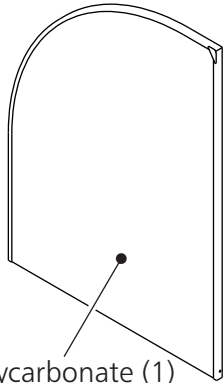

Right Panel (1)
(Part# UZ1097)

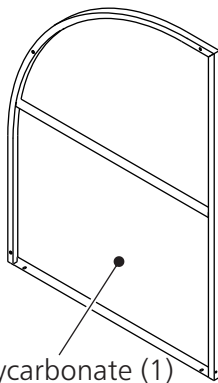

Center Panel (SEE TABLE)
(Part# UZ1096)

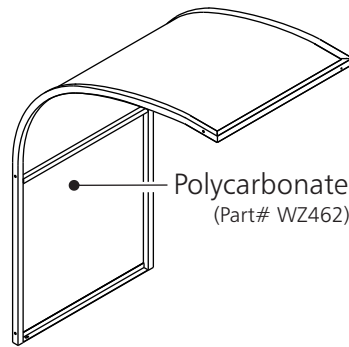

SHELTER WIDTH	QTY
30'	10
24'	8
21'	7
18'	6
15'	5
12'	4
9'	3

Polycarbonate (1)
(Part# WZ510)

Polycarbonate (1)
(Part# WZ464)

Polycarbonate (1)
(Part# WZ462)

Note: Hardware is packed separately in one or more boxes.
Open all boxes and layout all sealed hardware packs
before beginning assembly.

Frame Hdw (Part# JZ131)

3/8" X 1" Socket Head (Part# TZ323) (20)
3/8" Lock Washer (Part# TZ65) (20)

Lift Hdw (Part# JZ137)

1/2" U-bolt (Part# TZ306) (2)
1/2" Lock Nut (Part# TZ28) (4)
1/2" Flat Washer (Part# TZ297) (4)

Anchor Hdw (Part# JZ210)

7/16" X 5" Hex Bolt (Part# TZ307) (4)
7/16" X 5-1/2" Hex Bolt (Part# TZ291) (4)
7/16" Lock Nut (Part# TZ47) (4)
7/16" Flat Washer (Part# TZ171) (8)
Anchor Chain (Part# VZ564-12) (4)

Ground Anchor (4)
(Part# 10B103 Pack of 4)

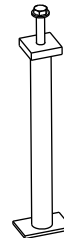

Anchor Bracket (8)
(Part# UZ1430)

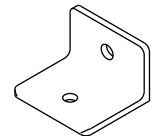

Crossbar Corner (2)
(Part# UZ1211)

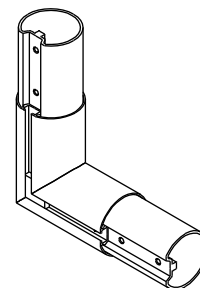

Post Corner (2)
(Part# UZ1099)

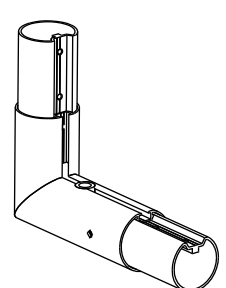

THIS UNIT MUST BE ANCHORED ACCORDING TO THESE INSTRUCTIONS AT ALL TIMES

⚠ WARNING

THIS EQUIPMENT MUST BE STORED IN A SECURED, SHELTERED AREA WHEN NOT IN USE OR IN THE THREAT OF HIGH WINDS. ANY WEATHER DAMAGE TO THIS EQUIPMENT WILL NOT BE COVERED UNDER KWIK GOAL'S PRODUCT GUARANTEE. DO NOT LEAVE THIS EQUIPMENT UNATTENDED.

Quantity per shelter length

Panel Hdw (Part# JZ199, JZ202)	9ft	12ft	15ft	18ft	21ft	24ft	30ft
3/8" X 7/8" Hex Bolt (Part# TZ249)	(5)	(6)	(7)	(8)	(9)	(10)	(12)
3/8" X 2-1/4" Hex Bolt (Part# TZ305)	(7)	(8)	(9)	(10)	(11)	(12)	(14)
3/8" Square Nut (Part# TZ247)	(12)	(14)	(16)	(18)	(20)	(22)	(26)
3/8" Lock Washer (Part# TZ65)	(32)	(34)	(36)	(38)	(40)	(42)	(46)
3/8" Flat Washer (Part# TZ60)	(12)	(14)	(16)	(18)	(20)	(22)	(26)
5/16" X 3-3/4" Hex Bolt (Part# TZ264)	(6)	(9)	(12)	(15)	(18)	(21)	(27)
5/16" Lock Nut (Part# TZ5)	(12)	(15)	(18)	(21)	(24)	(27)	(33)
5/16" Flat Washer (Part# TZ4)	(18)	(24)	(30)	(36)	(42)	(48)	(60)

Assembly Tools

Polyurethane Sealant
(Part# VZ837)

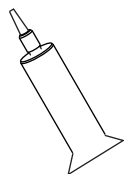

1/2", 9/16", 5/8" & 3/4"
Wrenches

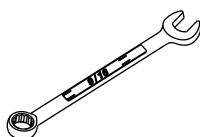

Ratchet with
1/2", 9/16", 5/8" & 3/4"
Sockets

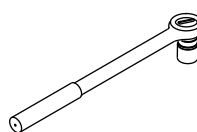

5/16" Hex wrench



3. Hardware for this step is in Lift Hdw pack.

Attach 1/2" U-bolt to left and right bases.

NOTE: Tighten 1/2" nuts only until flush with end of U-bolts.

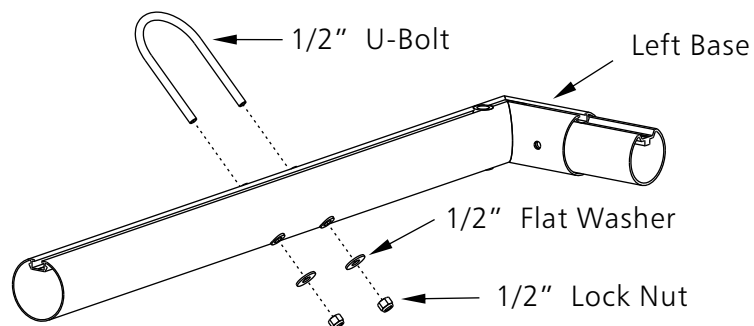
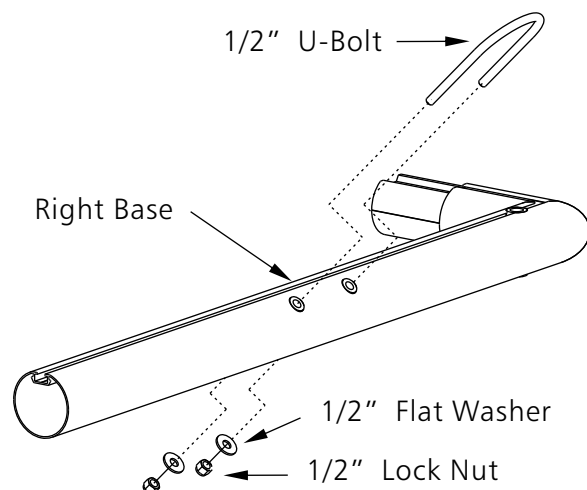

THIS UNIT MUST BE ANCHORED ACCORDING TO THESE INSTRUCTIONS AT ALL TIMES

⚠ WARNING

THIS EQUIPMENT MUST BE STORED IN A SECURED, SHELTERED AREA WHEN NOT IN USE OR IN THE THREAT OF HIGH WINDS. ANY WEATHER DAMAGE TO THIS EQUIPMENT WILL NOT BE COVERED UNDER KWIK GOAL'S PRODUCT GUARANTEE. DO NOT LEAVE THIS EQUIPMENT UNATTENDED.

4. Hardware for this step is in **Frame Hdw** & **Panel Hdw** packs.

Assemble crossbar, bases, and post corners. Press joints together firmly before tightening bolts.

NOTE: Square nuts will float loose in channels until used later.

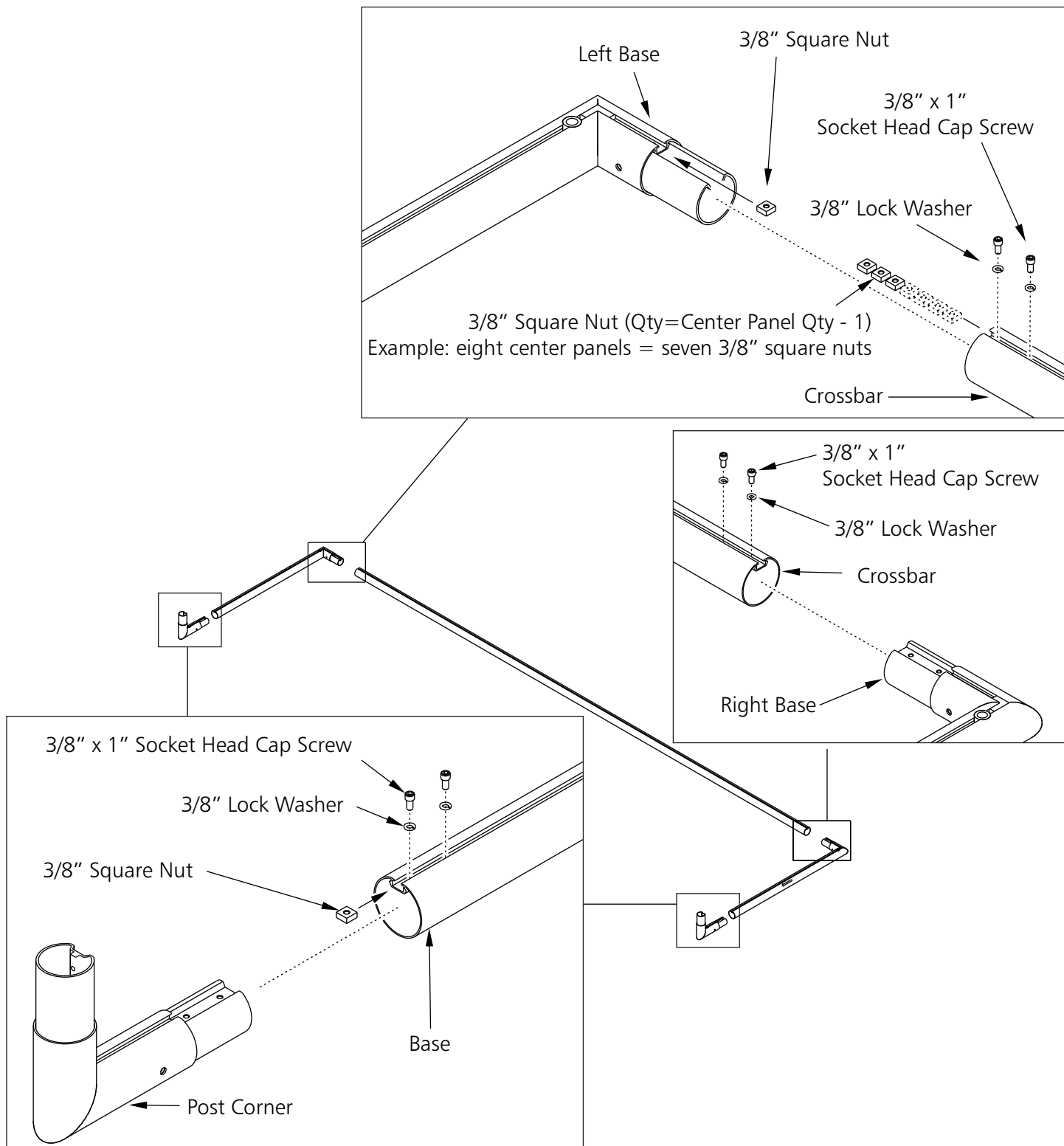

THIS UNIT MUST BE ANCHORED ACCORDING TO THESE INSTRUCTIONS AT ALL TIMES

⚠ WARNING

THIS EQUIPMENT MUST BE STORED IN A SECURED, SHELTERED AREA WHEN NOT IN USE OR IN THE THREAT OF HIGH WINDS. ANY WEATHER DAMAGE TO THIS EQUIPMENT WILL NOT BE COVERED UNDER KWIK GOAL'S PRODUCT GUARANTEE. DO NOT LEAVE THIS EQUIPMENT UNATTENDED.

5. Hardware for this step is in **Frame Hdw** & **Panel Hdw** packs.

Assemble crossbar, posts, and crossbar corners. Press joints together firmly before tightening bolts.

NOTE: Square nuts will float loose in channels until used later.

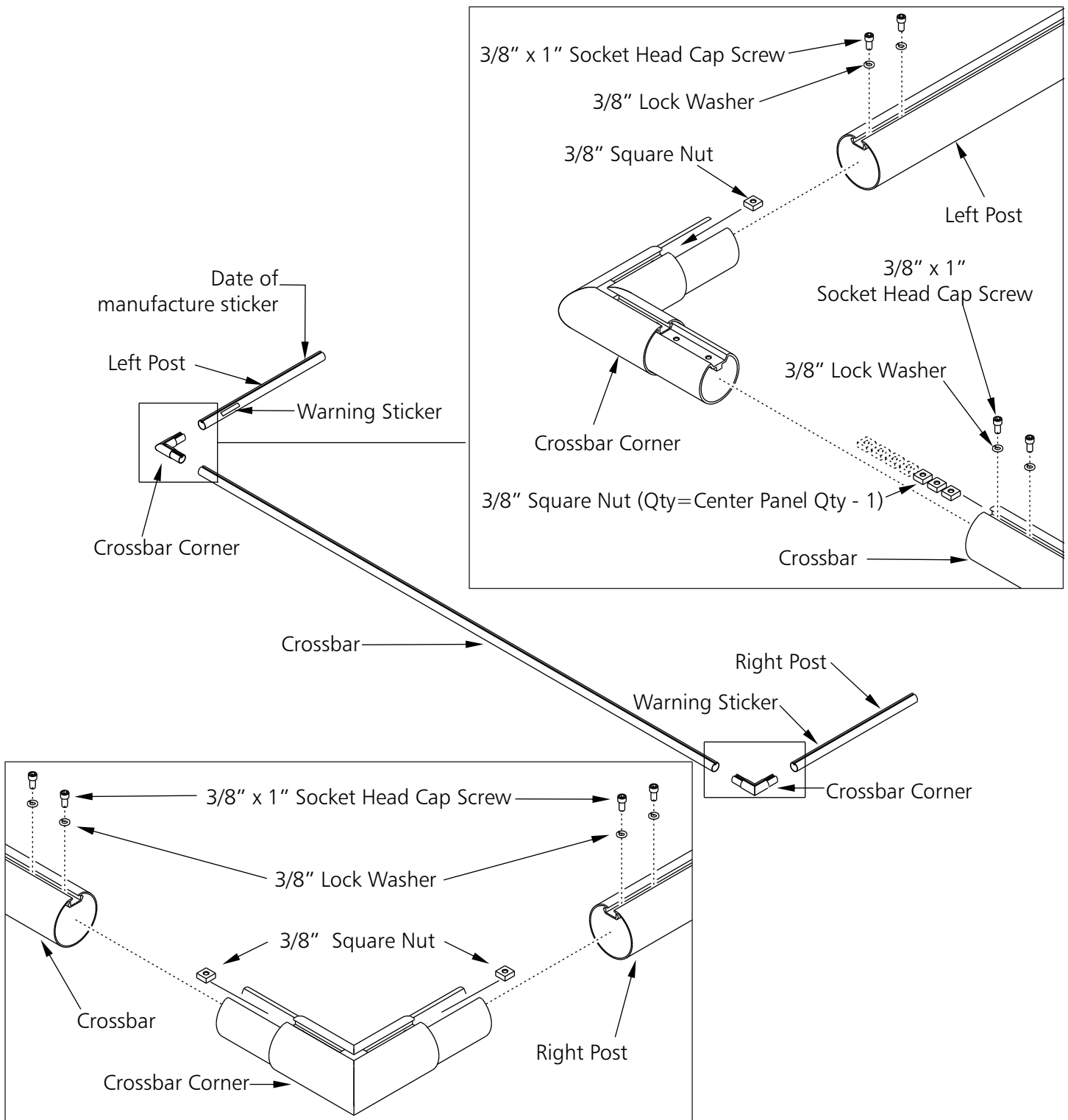

THIS UNIT MUST BE ANCHORED ACCORDING TO THESE INSTRUCTIONS AT ALL TIMES

⚠ WARNING

THIS EQUIPMENT MUST BE STORED IN A SECURED, SHELTERED AREA WHEN NOT IN USE OR IN THE THREAT OF HIGH WINDS. ANY WEATHER DAMAGE TO THIS EQUIPMENT WILL NOT BE COVERED UNDER KWIK GOAL'S PRODUCT GUARANTEE. DO NOT LEAVE THIS EQUIPMENT UNATTENDED.

6. Hardware for this step is in **Frame Hdw** & **Panel Hdw** packs.

Insert one 3/8" square nut in each side of assembled base corner. Connect assembled base and post as shown. Press joints together firmly before tightening bolts.

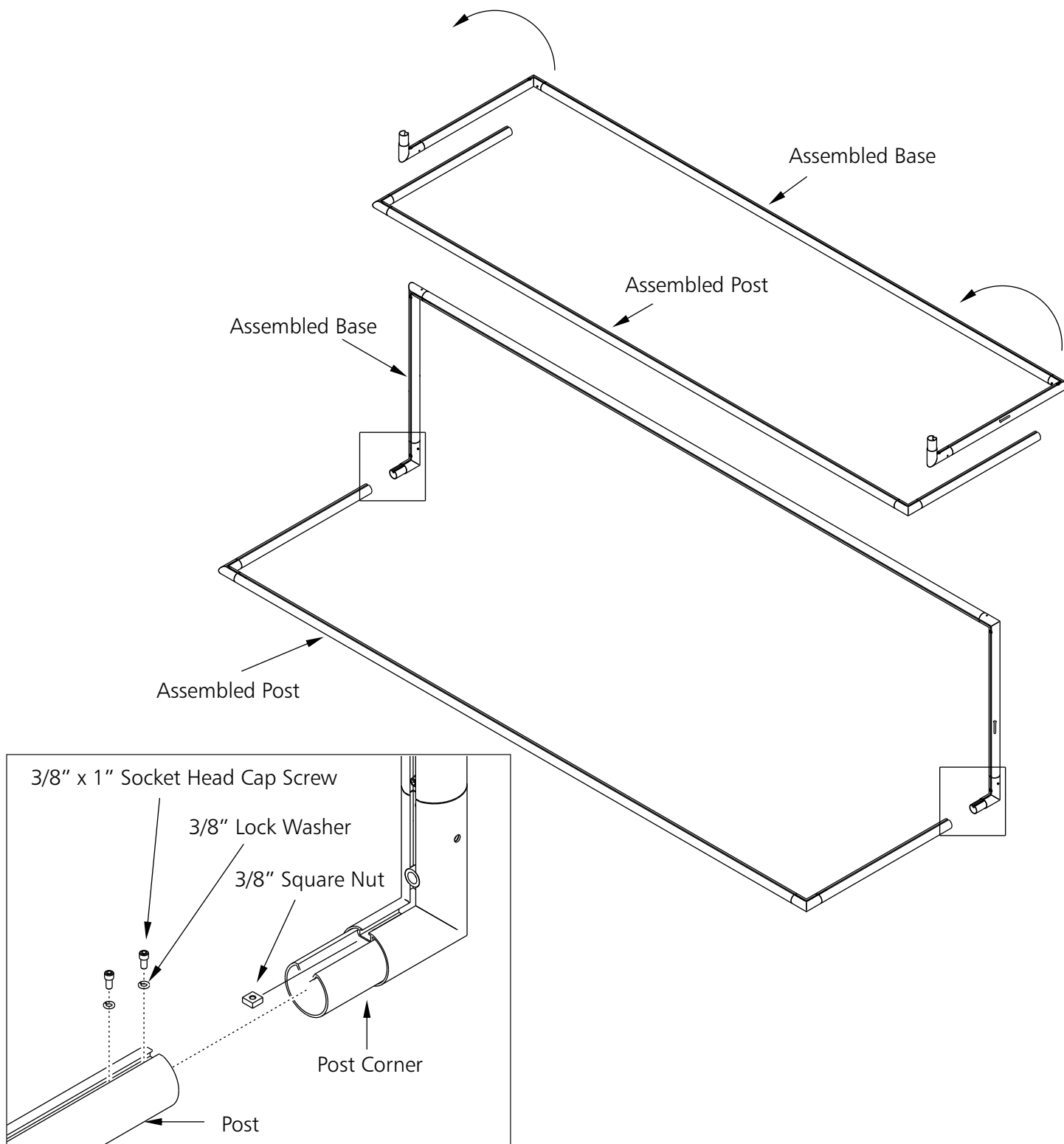

THIS UNIT MUST BE ANCHORED ACCORDING TO THESE INSTRUCTIONS AT ALL TIMES

⚠WARNING

THIS EQUIPMENT MUST BE STORED IN A SECURED, SHELTERED AREA WHEN NOT IN USE OR IN THE THREAT OF HIGH WINDS. ANY WEATHER DAMAGE TO THIS EQUIPMENT WILL NOT BE COVERED UNDER KWIK GOAL'S PRODUCT GUARANTEE. DO NOT LEAVE THIS EQUIPMENT UNATTENDED.

7. Hardware for this step is in **Panel Hdw** packs.
Attach right and left panels to assembled frame as shown.
Do NOT tighten bolts at this time.

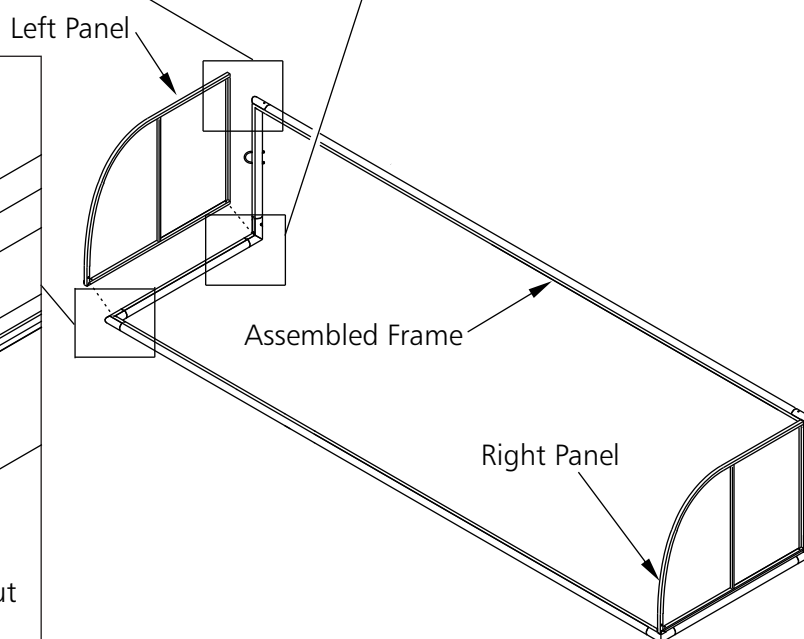
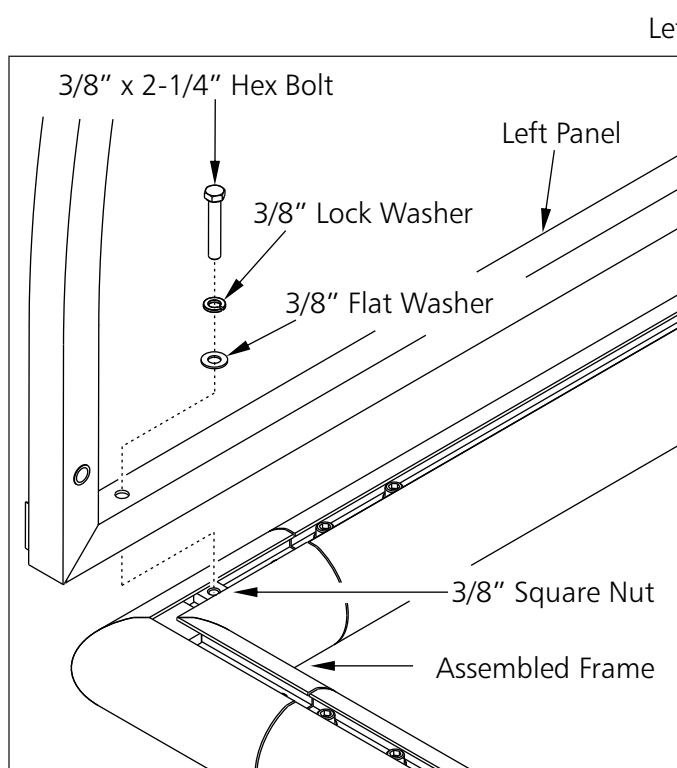
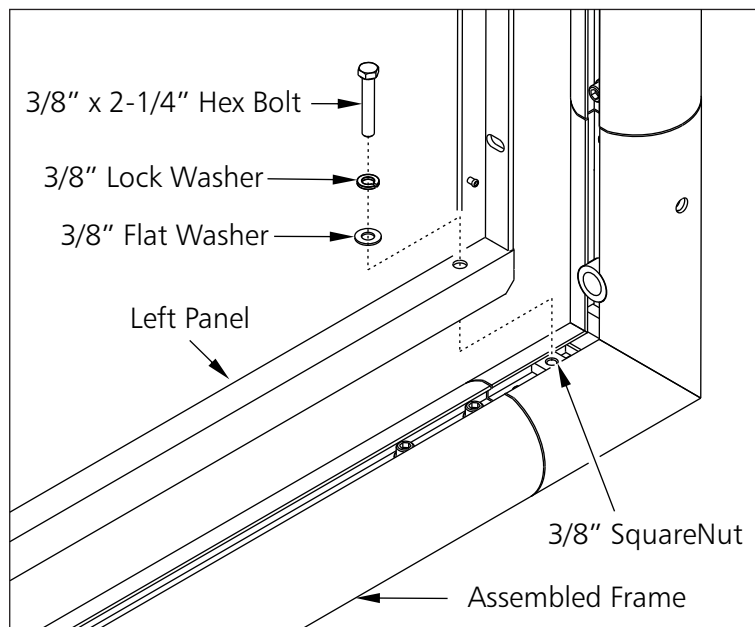
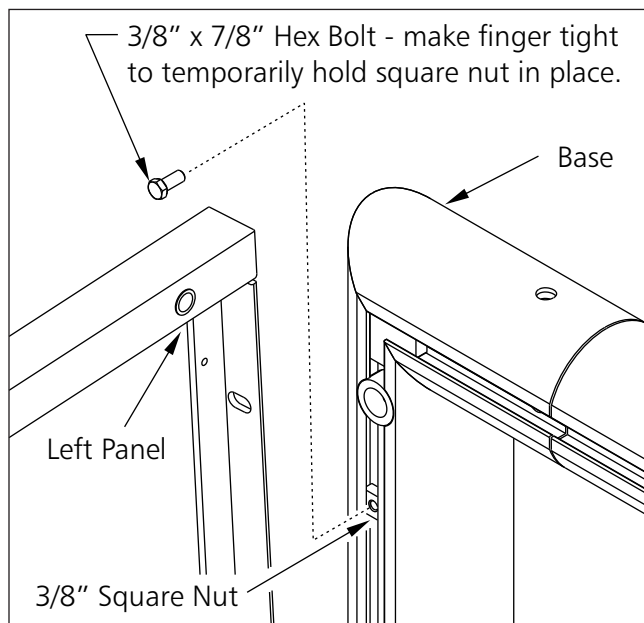

THIS UNIT MUST BE ANCHORED ACCORDING TO THESE INSTRUCTIONS AT ALL TIMES

⚠WARNING

THIS EQUIPMENT MUST BE STORED IN A SECURED, SHELTERED AREA WHEN NOT IN USE OR IN THE THREAT OF HIGH WINDS. ANY WEATHER DAMAGE TO THIS EQUIPMENT WILL NOT BE COVERED UNDER KWIK GOAL'S PRODUCT GUARANTEE. DO NOT LEAVE THIS EQUIPMENT UNATTENDED.

8. Turn shelter frame onto base and remove temporary 3/8" X 7/8" bolt then connect bottom of right and left panel as shown.
Do NOT tighten bolts at this time.

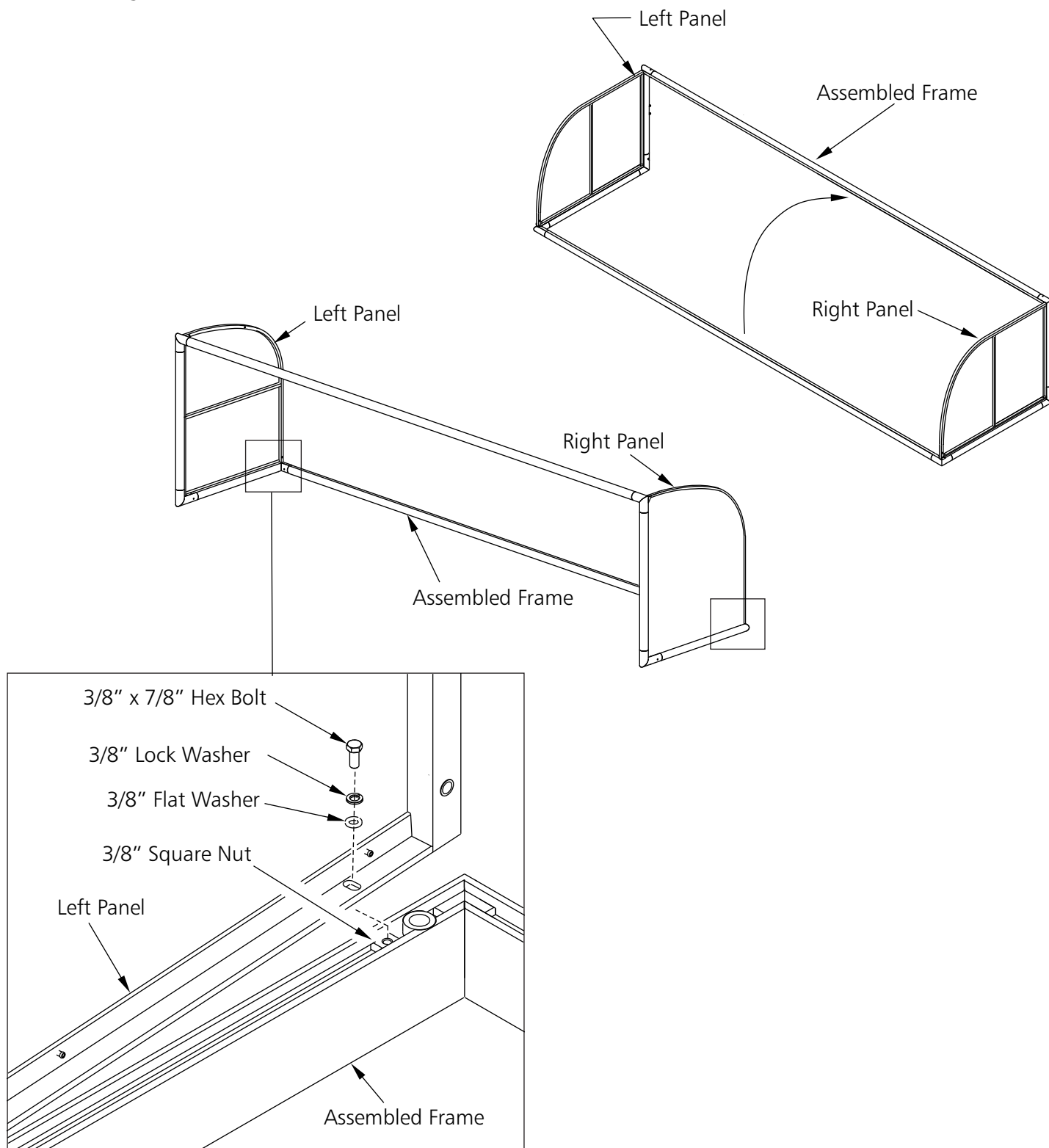

THIS UNIT MUST BE ANCHORED ACCORDING TO THESE INSTRUCTIONS AT ALL TIMES

⚠WARNING

THIS EQUIPMENT MUST BE STORED IN A SECURED, SHELTERED AREA WHEN NOT IN USE OR IN THE THREAT OF HIGH WINDS. ANY WEATHER DAMAGE TO THIS EQUIPMENT WILL NOT BE COVERED UNDER KWIK GOAL'S PRODUCT GUARANTEE. DO NOT LEAVE THIS EQUIPMENT UNATTENDED.

9. Hardware for this step is in **Panel Hdw** packs.

Insert double end studs into left panel. Move unneeded square nuts in top and bottom crossbars away from left side at least one center panel width.

Do NOT tighten bolts at this time.

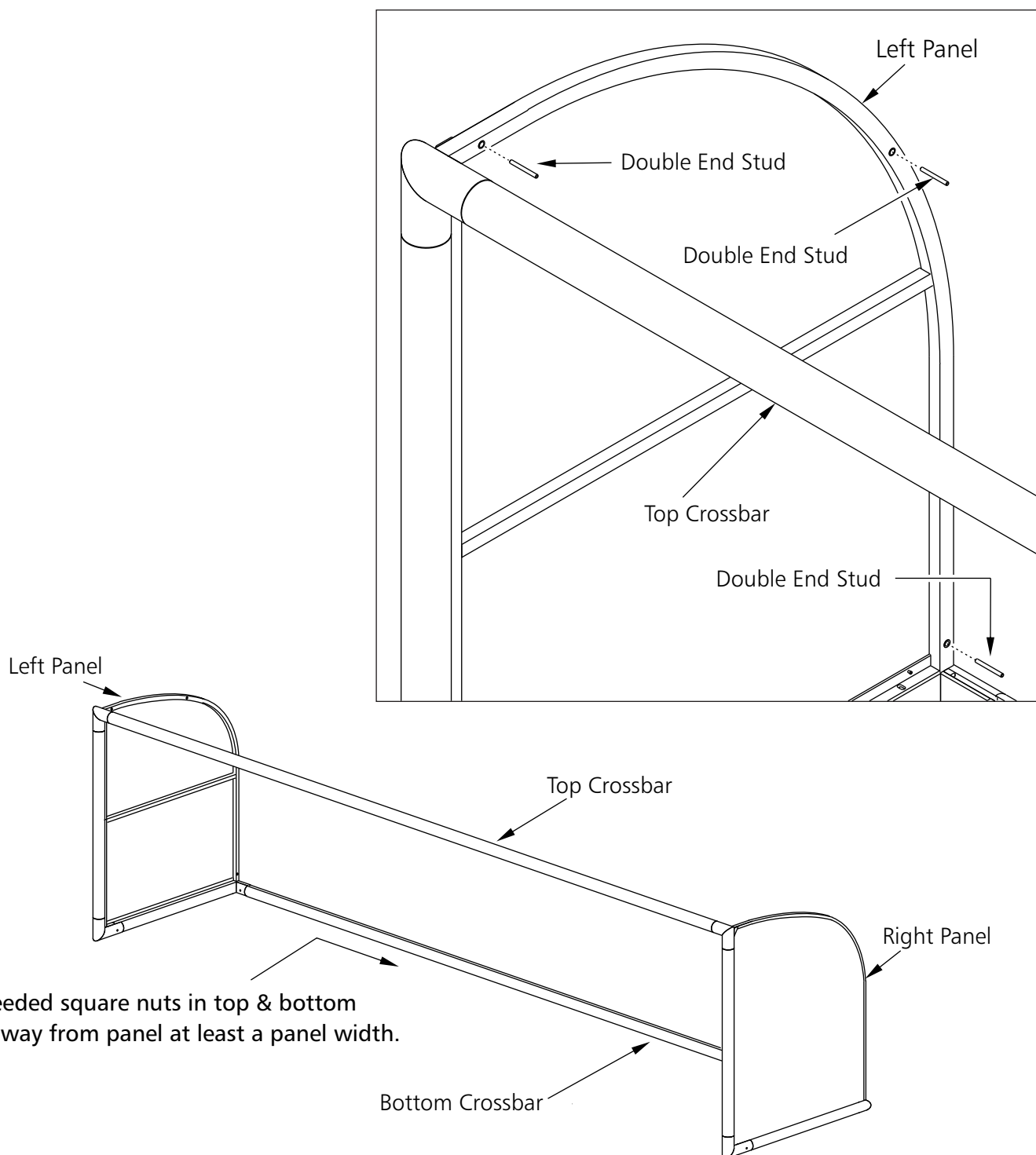

THIS UNIT MUST BE ANCHORED ACCORDING TO THESE INSTRUCTIONS AT ALL TIMES

⚠ WARNING

THIS EQUIPMENT MUST BE STORED IN A SECURED, SHELTERED AREA WHEN NOT IN USE OR IN THE THREAT OF HIGH WINDS. ANY WEATHER DAMAGE TO THIS EQUIPMENT WILL NOT BE COVERED UNDER KWIK GOAL'S PRODUCT GUARANTEE. DO NOT LEAVE THIS EQUIPMENT UNATTENDED.

10. Hardware for this step is in **Panel Hdw** packs.

Line up square nut with holes in center panel and attach center panel to shelter frame. Slide center panel to mate with left panel lining up double end studs, as shown. Repeat steps 9 & 10 to attach center panel to the right side.

Do NOT tighten bolts at this time.

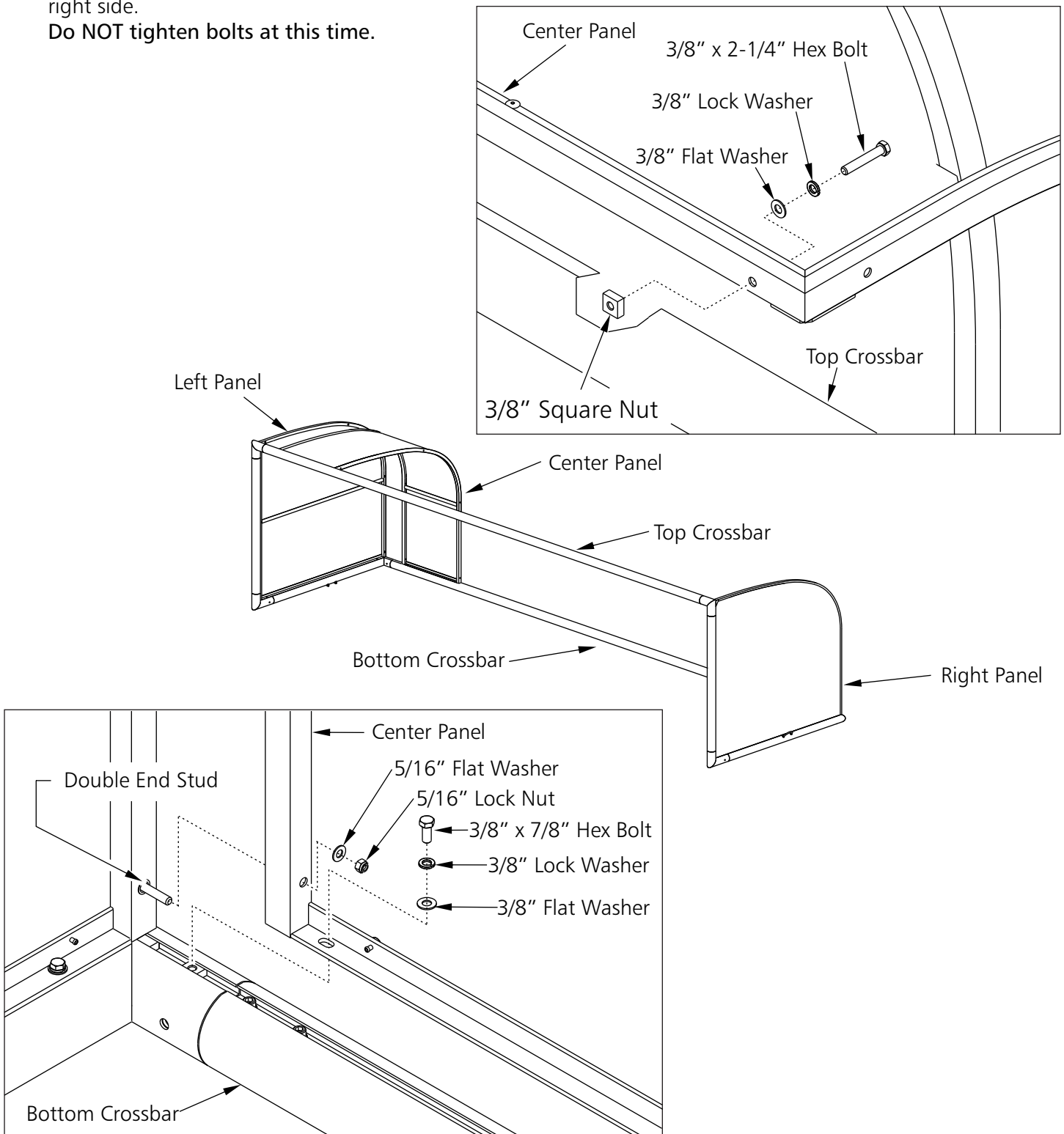

THIS UNIT MUST BE ANCHORED ACCORDING TO THESE INSTRUCTIONS AT ALL TIMES

⚠ WARNING

THIS EQUIPMENT MUST BE STORED IN A SECURED, SHELTERED AREA WHEN NOT IN USE OR IN THE THREAT OF HIGH WINDS. ANY WEATHER DAMAGE TO THIS EQUIPMENT WILL NOT BE COVERED UNDER KWIK GOAL'S PRODUCT GUARANTEE. DO NOT LEAVE THIS EQUIPMENT UNATTENDED.

11. Hardware for this step is in **Panel Hdw** packs.

Repeat step 10 to attach center panels to crossbars then connect center panels together until the only 1 center panel is left. Remember to move unneeded square nuts on top and bottom crossbars out from under the center panel being attached before bolting center panel in place.

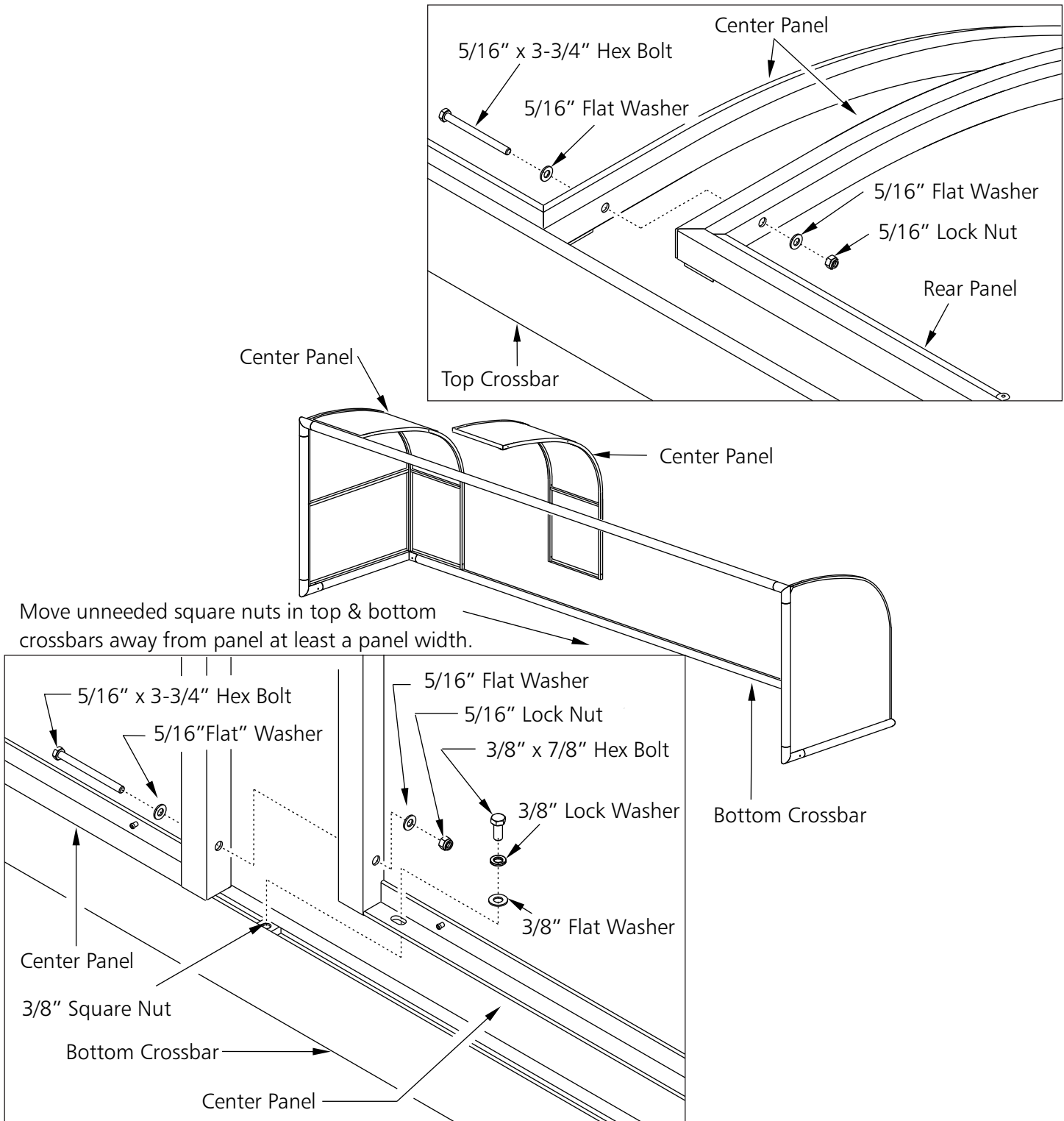

THIS UNIT MUST BE ANCHORED ACCORDING TO THESE INSTRUCTIONS AT ALL TIMES

⚠ WARNING

THIS EQUIPMENT MUST BE STORED IN A SECURED, SHELTERED AREA WHEN NOT IN USE OR IN THE THREAT OF HIGH WINDS. ANY WEATHER DAMAGE TO THIS EQUIPMENT WILL NOT BE COVERED UNDER KWIK GOAL'S PRODUCT GUARANTEE. DO NOT LEAVE THIS EQUIPMENT UNATTENDED.

12. If installing Bench or Molded Seating, skip to step 13.

If installing Luxury Seating, tighten all panel joint bolts. Begin at center joint and work outward. Tighten 3 bolts per joint. Tighten 3 panel frame bolts on each of the left and right end panels. Tighten panel to frame bolts at top and bottom of each center panel.

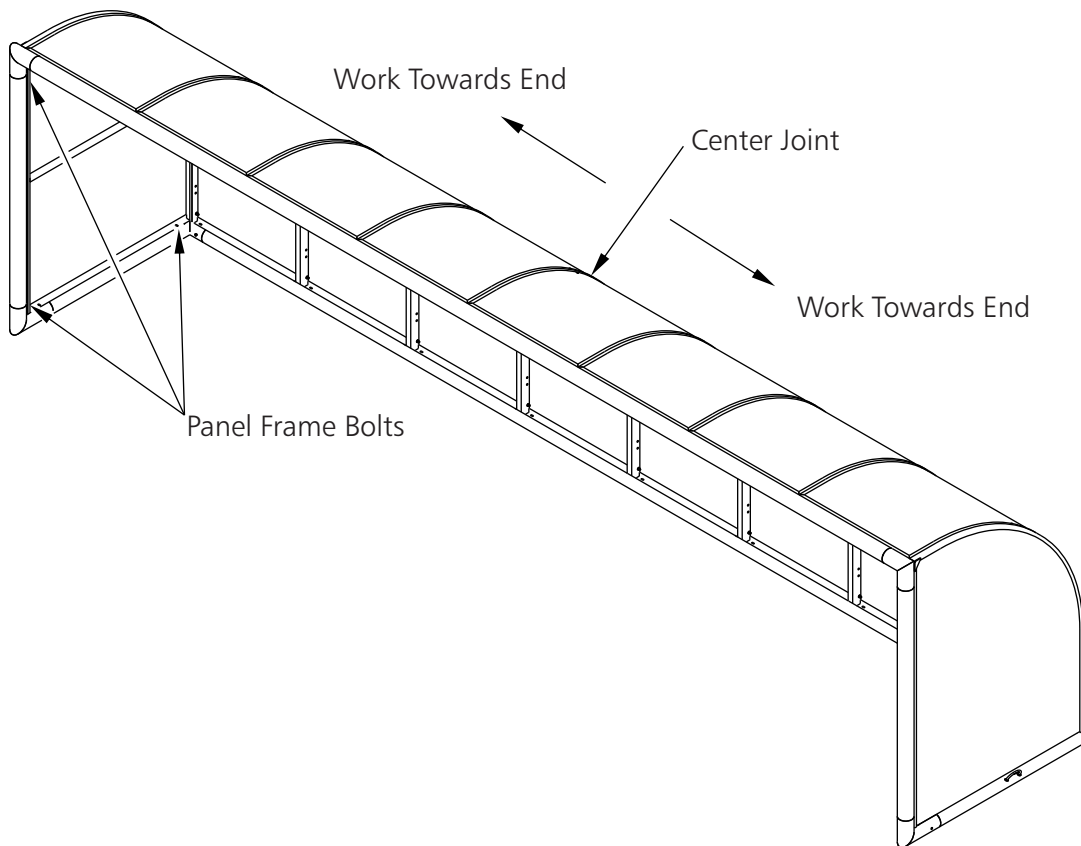

THIS UNIT MUST BE ANCHORED ACCORDING TO THESE INSTRUCTIONS AT ALL TIMES

⚠ WARNING

THIS EQUIPMENT MUST BE STORED IN A SECURED, SHELTERED AREA WHEN NOT IN USE OR IN THE THREAT OF HIGH WINDS. ANY WEATHER DAMAGE TO THIS EQUIPMENT WILL NOT BE COVERED UNDER KWIK GOAL'S PRODUCT GUARANTEE. DO NOT LEAVE THIS EQUIPMENT UNATTENDED.

13. If anchoring to concrete slab, skip to step 16.

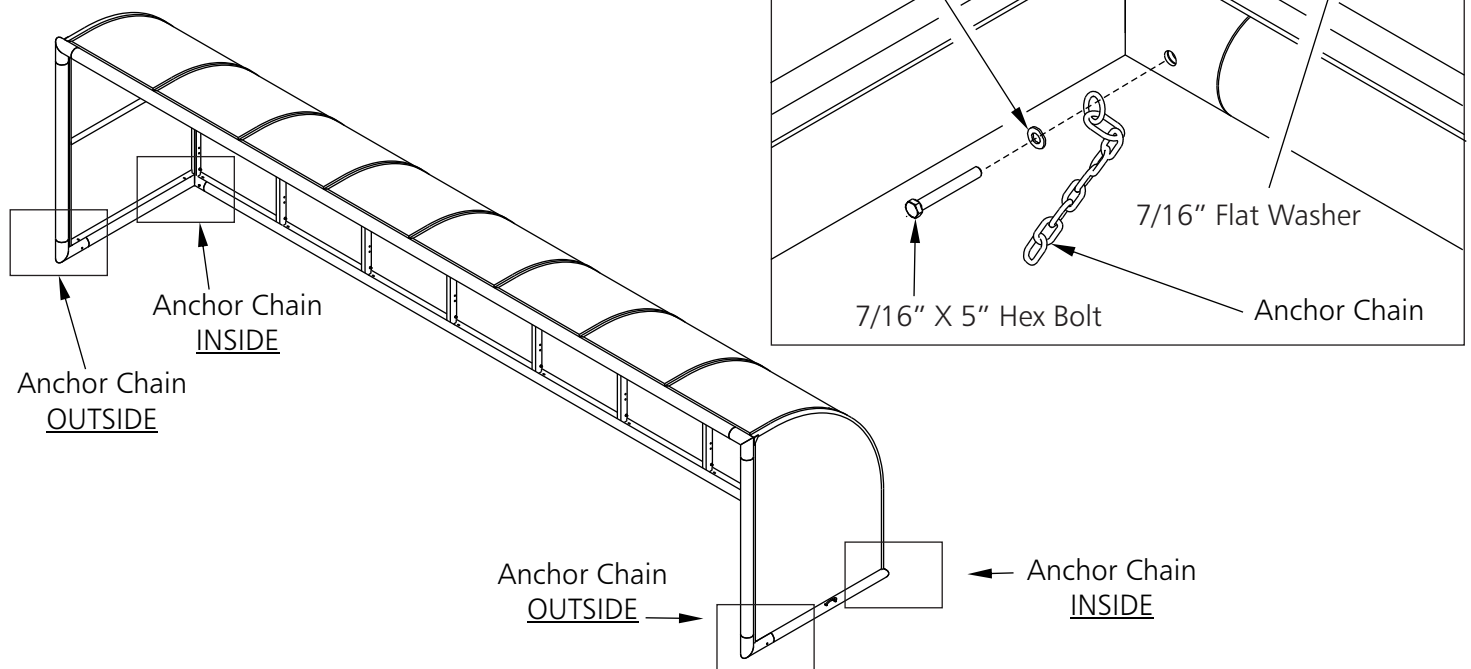

14. Hardware for this step are in **Anchor Hdw** pack.

Attach anchor chain to shelter frame, 2 in the front on the outside and 2 on the inside at the back as shown.

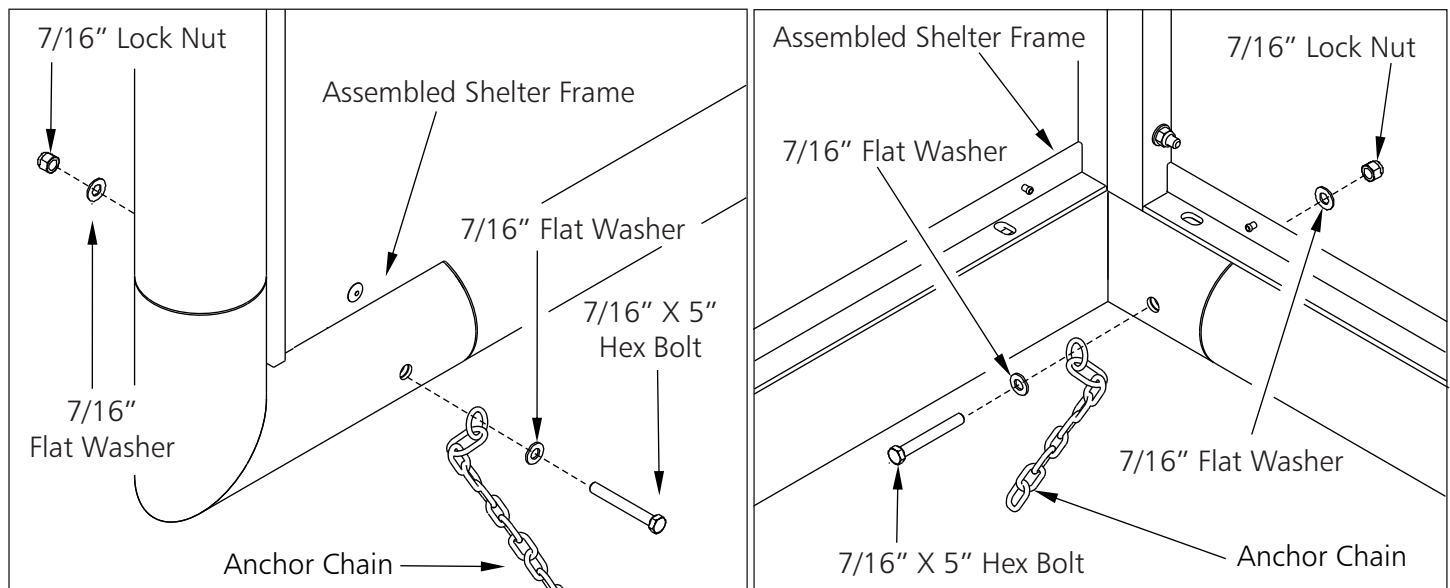

THIS UNIT MUST BE ANCHORED ACCORDING TO THESE INSTRUCTIONS AT ALL TIMES

⚠ WARNING

THIS EQUIPMENT MUST BE STORED IN A SECURED, SHELTERED AREA WHEN NOT IN USE OR IN THE THREAT OF HIGH WINDS. ANY WEATHER DAMAGE TO THIS EQUIPMENT WILL NOT BE COVERED UNDER KWIK GOAL'S PRODUCT GUARANTEE. DO NOT LEAVE THIS EQUIPMENT UNATTENDED.

15. Hardware for this step is in **Anchor Hdw** pack.

Permanent ground anchors must be used at all times. Dig four holes according to the layout below. Note: areas subject to heavy frost may require depths as deep as 36". Prepare holes and add drain stone as shown. Install anchor in each hole and fill hole with concrete. Allow concrete to cure before attaching shelter to anchors. Upon completion of shelter frame, refer to seating instructions to complete your seating shelter.

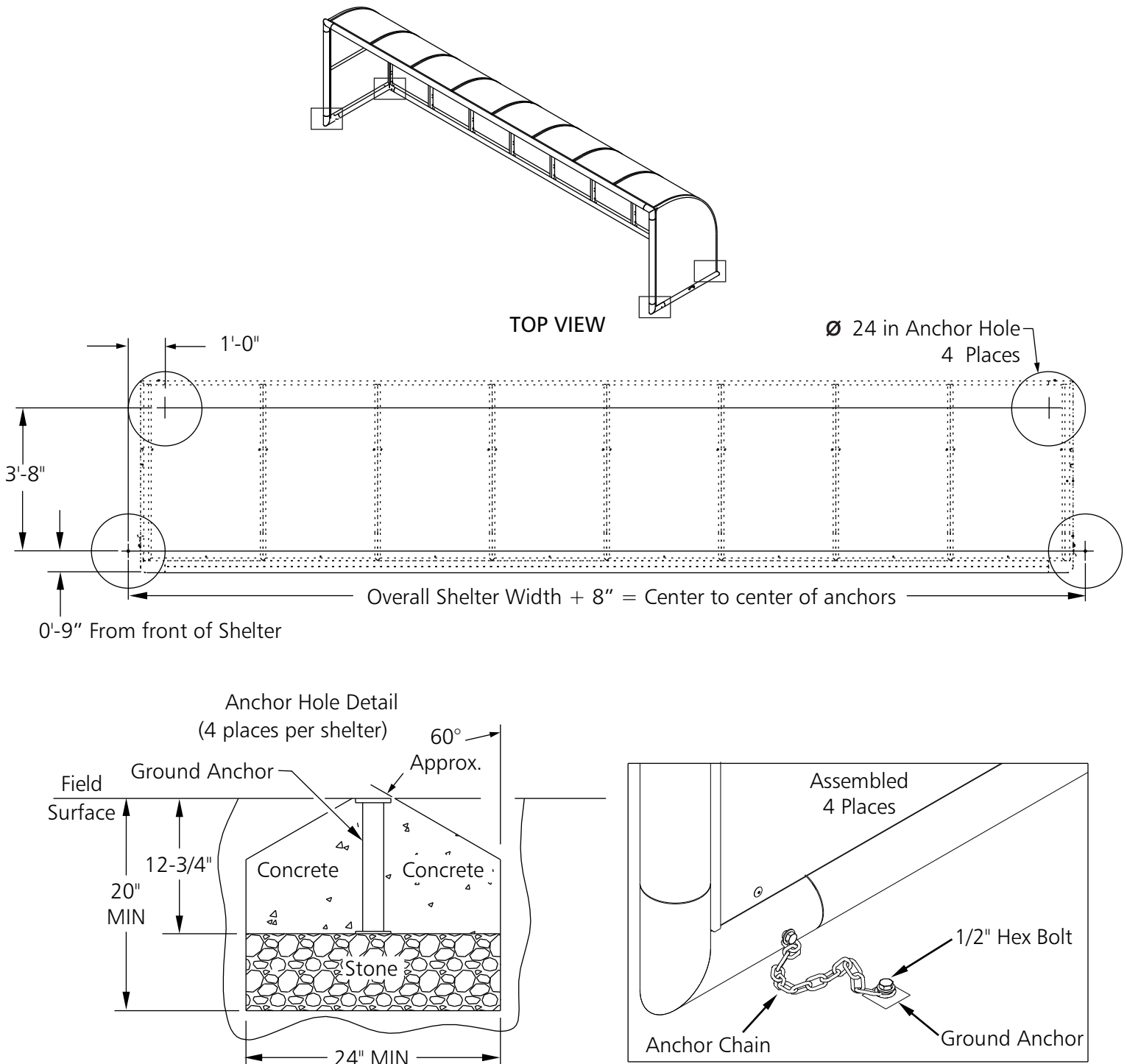

THIS UNIT MUST BE ANCHORED ACCORDING TO THESE INSTRUCTIONS AT ALL TIMES

⚠ WARNING

THIS EQUIPMENT MUST BE STORED IN A SECURED, SHELTERED AREA WHEN NOT IN USE OR IN THE THREAT OF HIGH WINDS. ANY WEATHER DAMAGE TO THIS EQUIPMENT WILL NOT BE COVERED UNDER KWIK GOAL'S PRODUCT GUARANTEE. DO NOT LEAVE THIS EQUIPMENT UNATTENDED.

16. Hardware for this step is in **Anchor Hdw** pack.

Shelter may be anchored to a concrete pad using anchor brackets. Attach 8 brackets to shelter as shown.

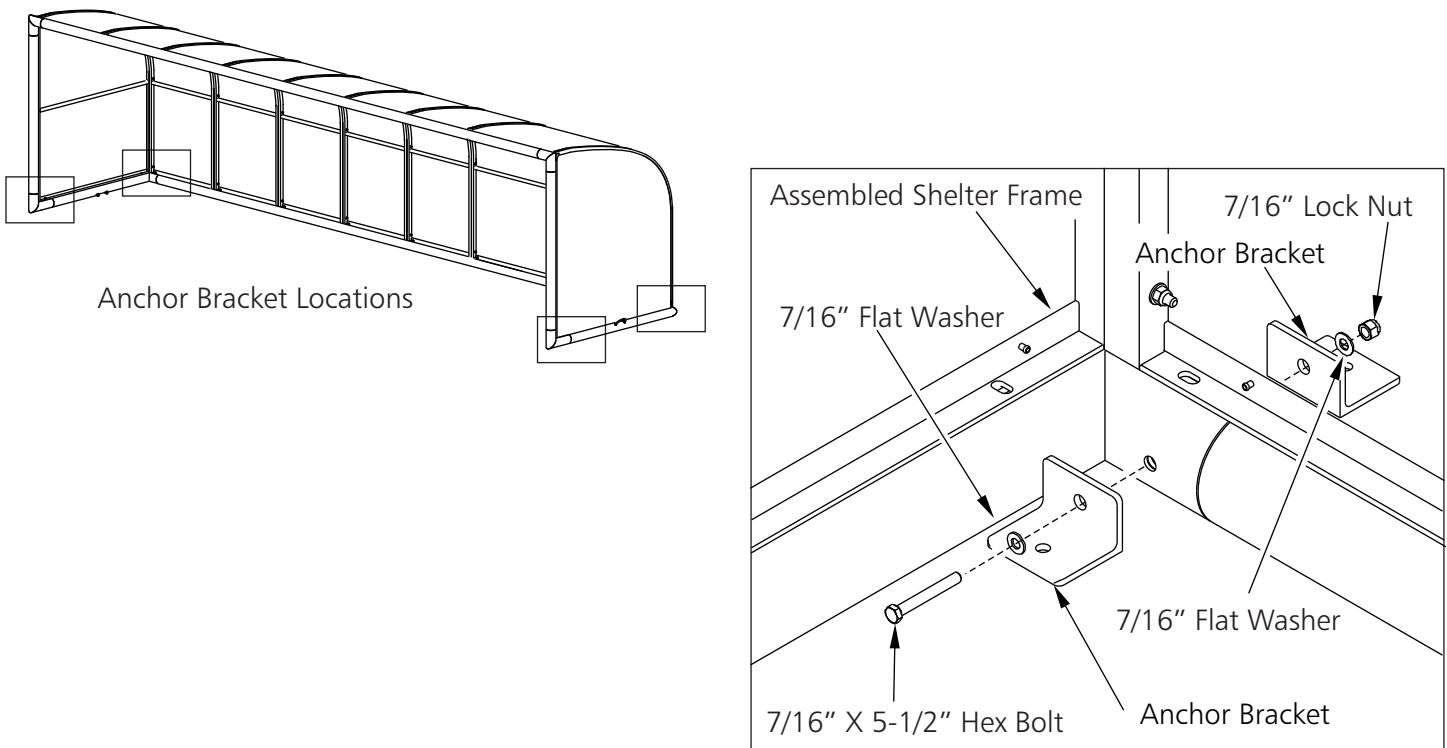

17. Place shelter in location of install and mark 8 anchor locations on concrete. Install eight 1/2" diameter anchors with a minimum rating of 2500 lbs. each. Upon completion of shelter frame, refer to seating instructions to complete your seating shelter.

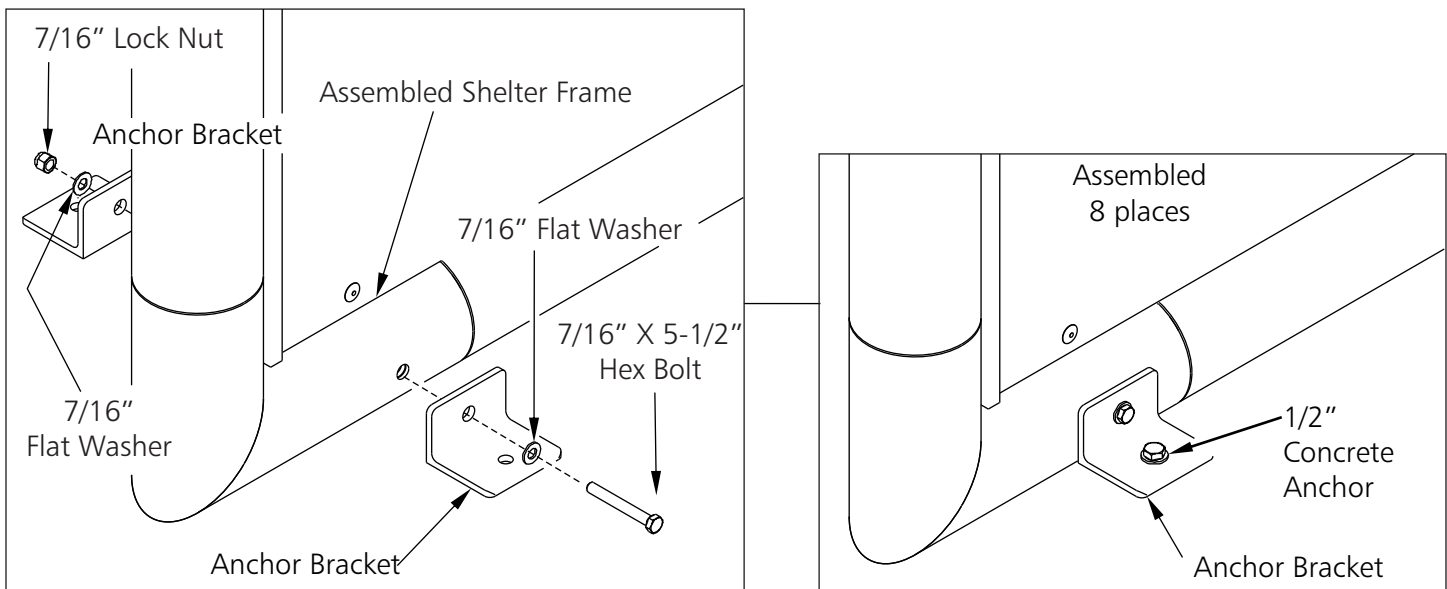

THIS UNIT MUST BE ANCHORED ACCORDING TO THESE INSTRUCTIONS AT ALL TIMES

⚠ WARNING

THIS EQUIPMENT MUST BE STORED IN A SECURED, SHELTERED AREA WHEN NOT IN USE OR IN THE THREAT OF HIGH WINDS. ANY WEATHER DAMAGE TO THIS EQUIPMENT WILL NOT BE COVERED UNDER KWIK GOAL'S PRODUCT GUARANTEE. DO NOT LEAVE THIS EQUIPMENT UNATTENDED.

18. If desired, panel joints may be sealed with a small bead of urethane sealant. Seal across crossbar to panel joint, then panel to panel joints.

NOTE: Panel to panel joints should only be sealed between crossbar and lower brace of panels. Sealant below lower brace line is not necessary.

Prevent sealant material from contacting polycarbonate.

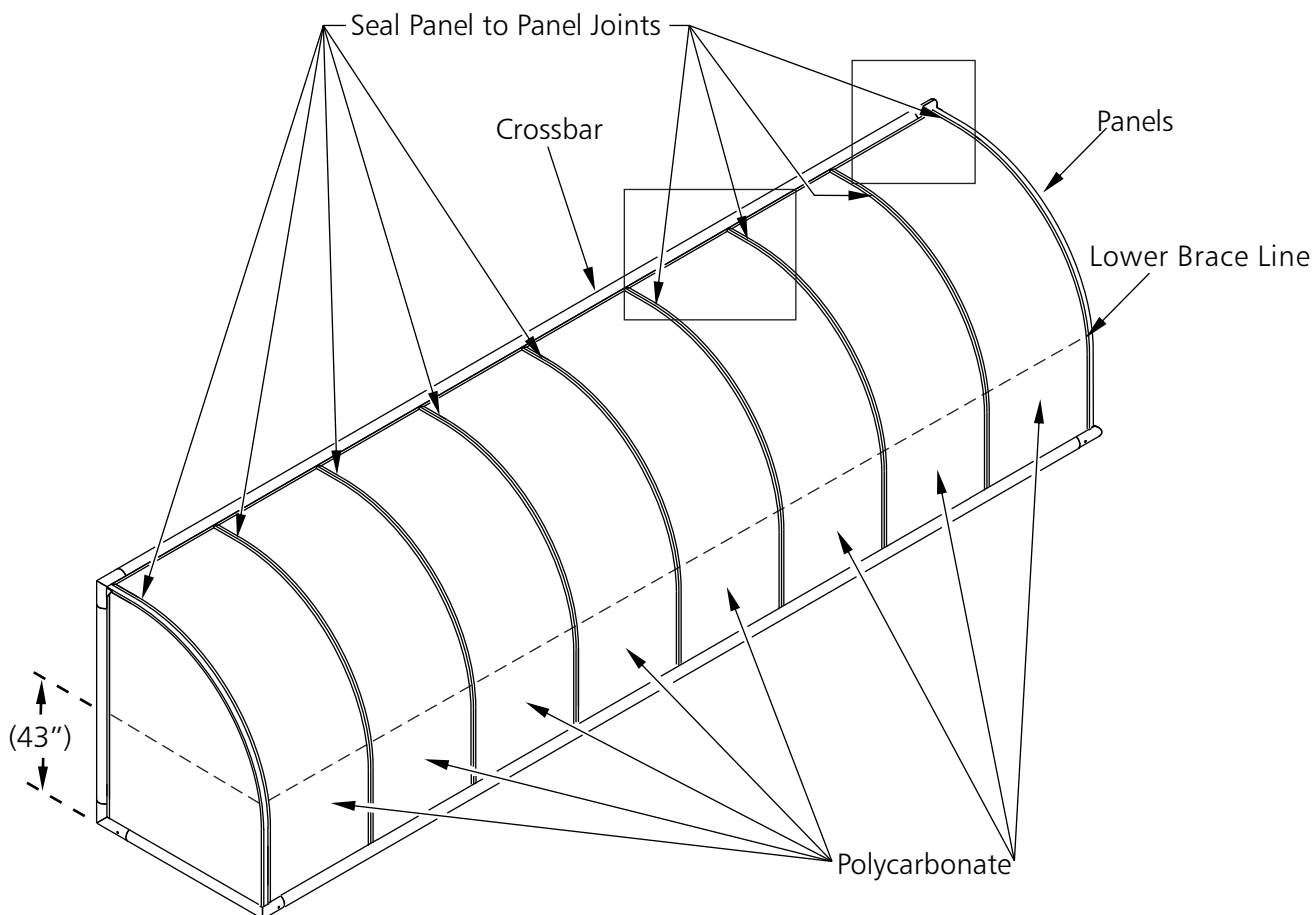
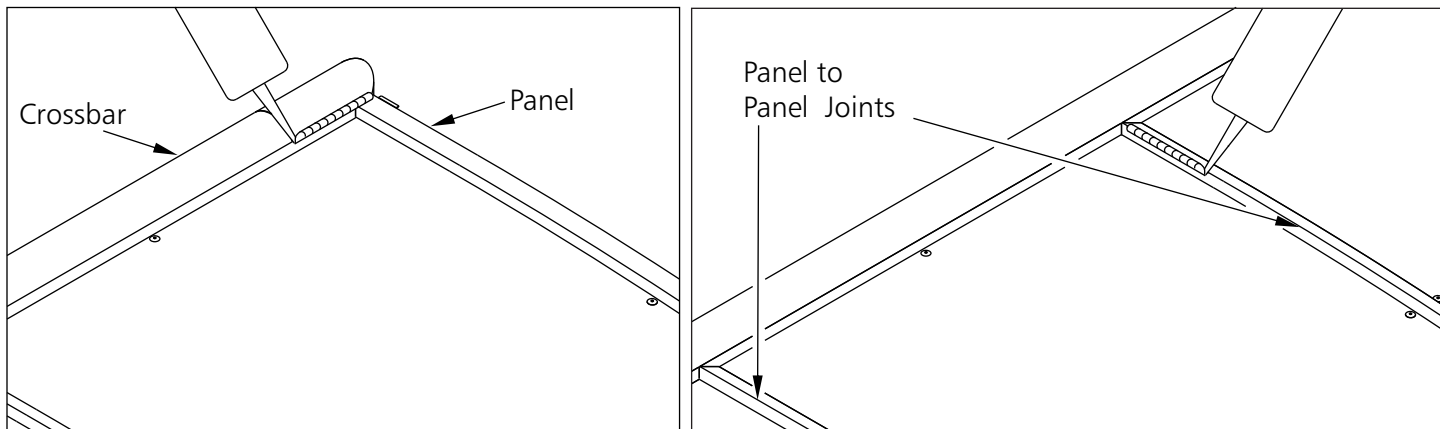

Go to kwikgoal.com for additional product information.

THIS UNIT MUST BE ANCHORED ACCORDING TO THESE INSTRUCTIONS AT ALL TIMES

⚠WARNING

THIS EQUIPMENT MUST BE STORED IN A SECURED, SHELTERED AREA WHEN NOT IN USE OR IN THE THREAT OF HIGH WINDS. ANY WEATHER DAMAGE TO THIS EQUIPMENT WILL NOT BE COVERED UNDER KWIK GOAL'S PRODUCT GUARANTEE. DO NOT LEAVE THIS EQUIPMENT UNATTENDED.



ASSEMBLY INSTRUCTIONS FOR MOLDED SEATS FOR ALL 9B512 PORTABLE SHELTERS

THIS UNIT MUST BE ASSEMBLED BY A MINIMUM OF TWO QUALIFIED PERSONS
SHELTERS MUST BE ANCHORED AT ALL TIMES WITH PERMANENT GROUND ANCHORS.

1. Unpack all parts and check for damage that may have occurred during shipping. If damage has occurred, notify Kwik Goal immediately. Lay out all parts. Remove all cardboard and packaging immediately. Wet or damp packaging may damage contents.
2. Refer to 9B51 instructions to assemble shelter frame prior to beginning seat assembly.
3. Read through entire instruction before beginning assembly and installation.

NOTE: Components may be packaged in one or more additional boxes.

Parts

Molded Seat (SEE TABLE)
(Part# VZ689)

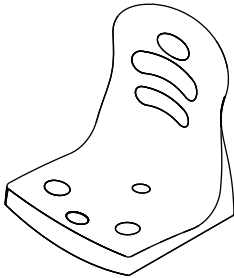

MODEL#	QTY
9B5120	17
9B5128	14
9B5127	12
9B5126	10
9B5125	8
9B5124	7
9B5123	5

Seat Frame (SEE TABLE)
(Part# UZ1457)

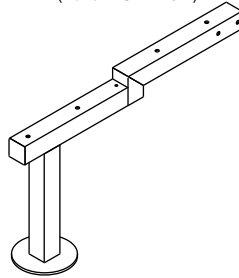

MODEL#	QTY
9B5120	6
9B5128	4
9B5127	4
9B5126	3
9B5125	3
9B5124	2
9B5123	2

Seat Support (SEE TABLE)
(Part# UZ1458)

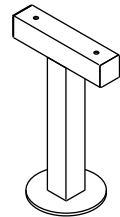

MODEL#	QTY
9B5120	3
9B5128	2
9B5127	2
9B5126	2
9B5125	2
9B5124	2
9B5123	2

THIS UNIT MUST BE ANCHORED ACCORDING TO THESE INSTRUCTIONS AT ALL TIMES

⚠ WARNING

THIS EQUIPMENT MUST BE STORED IN A SECURED, SHELTERED AREA WHEN NOT IN USE OR IN THE THREAT OF HIGH WINDS. ANY WEATHER DAMAGE TO THIS EQUIPMENT WILL NOT BE COVERED UNDER KWIK GOAL'S PRODUCT GUARANTEE. DO NOT LEAVE THIS EQUIPMENT UNATTENDED.

**⚠ WARNING****IMPORTANT SAFETY INSTRUCTIONS**
READ CAREFULLY

1. Lifting and moving heavy field equipment can be dangerous if not done properly. All Kwik Goal shelters must be moved by qualified personnel who are experienced in moving large, heavy field equipment. Kwik Goal recommends storing dolly and wheels in a secured area to prevent unauthorized use.
2. A minimum of four qualified, experienced people are required to install wheels and move shelter.
3. Do not attempt to lift, move, or remove anchors from any shelter in windy conditions.
4. Shelters must not be left unattended when wheels are installed.
5. Shelter must be on level, flat ground to use dolly handle and/or wheels.
6. Dolly is to be used as a wheel transport/storage and shelter lifting device. Do not use dolly to move shelter.
7. Use extreme caution when pushing shelter. Excessive force can overturn shelter. Always push at lowest point on shelter frame possible.
8. Do not push shelter directly from the front to rear or rear to front. Push from end to end. (Refer to 9B1201 - Shelter Dolly instructions for details.)
9. Always use two people to lift shelter with dolly. With one person maintaining light pressure on the handle, the second may insert wheels into shelter. Install both wheels before resting shelter on the ground. (Refer to 9B1201 - Shelter Dolly instructions for details.)

NEVER LOWER SHELTER WITH ONLY ONE WHEEL INSTALLED

Parts Continued

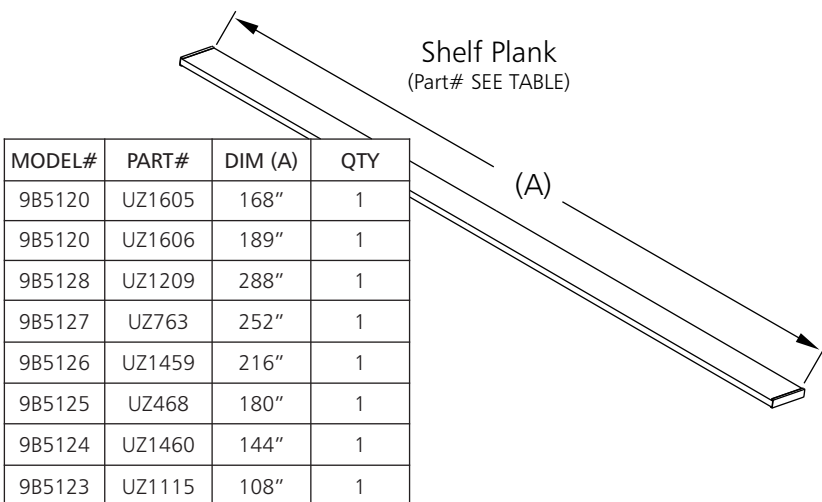
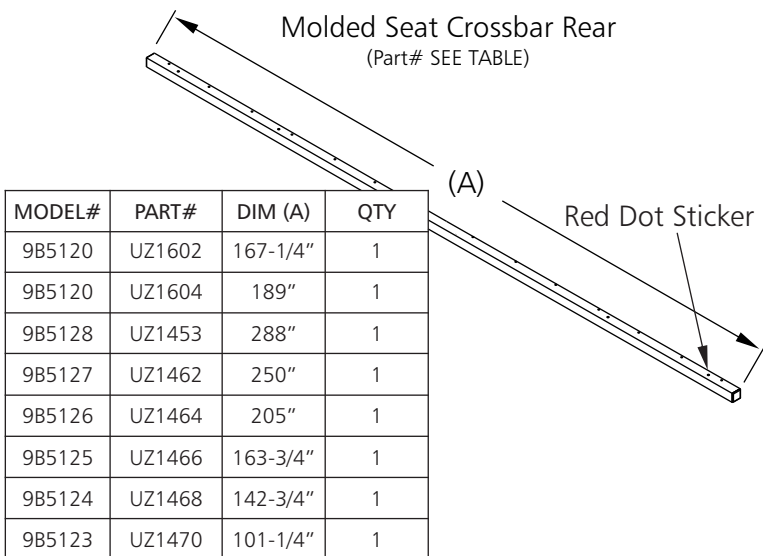
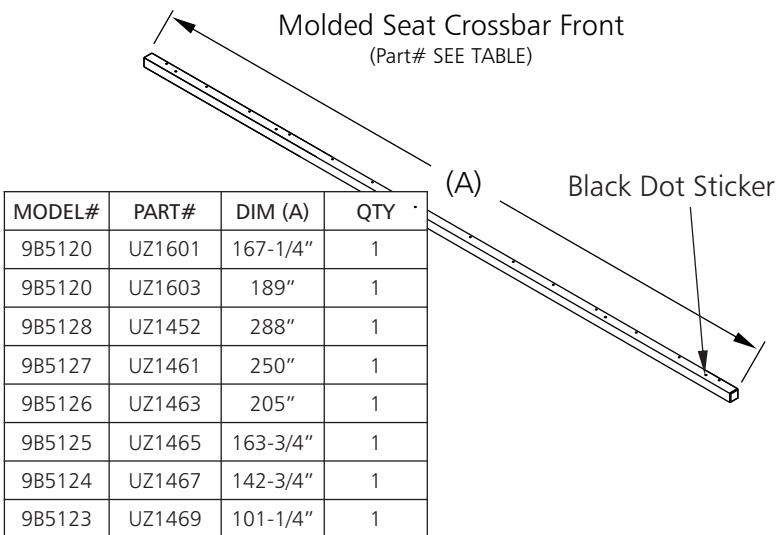

Seat Frame Plate (SEE TABLE)

(Part# UZ1107)

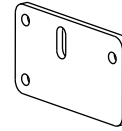

MODEL#	QTY
9B5120	12
9B5128	8
9B5127	8
9B5126	6
9B5125	6
9B5124	4
9B5123	4

Plank Hold Down (SEE TABLE)

(Part# UZ475)

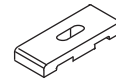

MODEL#	QTY
9B5120	12
9B5128	8
9B5127	8
9B5126	6
9B5125	6
9B5124	4
9B5123	4

3/8" Seat Frame Spacers (SEE TABLE)

(Part# TZ308)



MODEL#	QTY
9B5120	24
9B5128	16
9B5127	16
9B5126	12
9B5125	12
9B5124	8
9B5123	8

Assembly Tools

7/16", 1/2" & 9/16"
Wrenches

Ratchet with Socket
7/16", 1/2" & 9/16"

AND

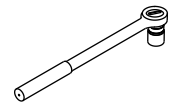
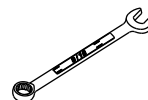

THIS UNIT MUST BE ANCHORED ACCORDING TO THESE INSTRUCTIONS AT ALL TIMES

⚠ WARNING

THIS EQUIPMENT MUST BE STORED IN A SECURED, SHELTERED AREA WHEN NOT IN USE OR IN THE THREAT OF HIGH WINDS. ANY WEATHER DAMAGE TO THIS EQUIPMENT WILL NOT BE COVERED UNDER KWIK GOAL'S PRODUCT GUARANTEE. DO NOT LEAVE THIS EQUIPMENT UNATTENDED.

Hardware needed per Model	9B5123	9B5124	9B5125	9B5126	9B5127	9B5128	9B5120
1/4" X 2-3/4" Hex Bolt (Part# TZ18)	(15)	(21)	(24)	(30)	(36)	(42)	(51)
1/4" Flat Washer (Part# TZ147)	(30)	(42)	(48)	(60)	(72)	(84)	(102)
1/4" Lock Nut (Part# TZ19)	(15)	(21)	(24)	(30)	(36)	(42)	(51)
5/16" X 3" Carriage Bolt (Part# TZ172)	(4)	(4)	(6)	(6)	(8)	(8)	(12)
5/16" X 4-1/2" Hex Bolt (Part# TZ377)	(8)	(8)	(10)	(10)	(12)	(12)	(18)
5/16" Flat Washer (Part# TZ4)	(20)	(20)	(26)	(26)	(32)	(32)	(48)
5/16" Lock Nut (Part# TZ5)	(12)	(12)	(16)	(16)	(20)	(20)	(30)
3/8" X 4-1/4" Hex Bolt (Part# TZ303)	(8)	(8)	(12)	(12)	(16)	(16)	(24)
3/8" Flat Washer (Part# TZ60)	(16)	(16)	(24)	(24)	(32)	(32)	(48)
3/8" Lock Nut (Part# TZ197)	(8)	(8)	(12)	(12)	(16)	(16)	(24)

4. **9B5120** - skip to step 12, for all other models continue to step 5.

5. Start at each end and attach seat frame plates to assembled shelter panels as shown. Attach remaining seat frame plates to assembled shelter panels at needed locations, do not exceed two panels between seat frame plates. Do not tighten bolts at this time.

NOTE: It may be necessary to loosen panel bolts to allow frame plate bolts to be inserted.

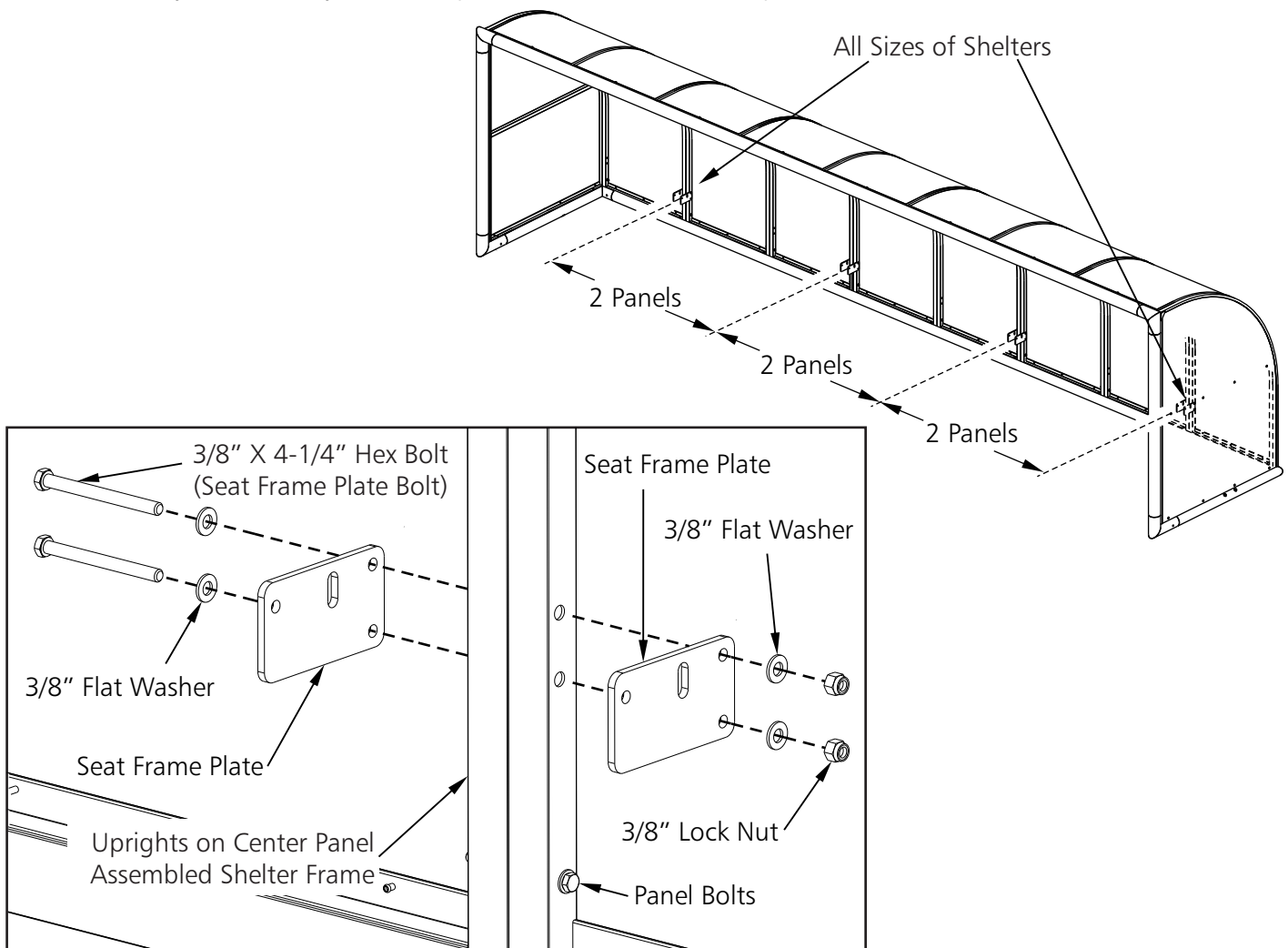

THIS UNIT MUST BE ANCHORED ACCORDING TO THESE INSTRUCTIONS AT ALL TIMES

⚠WARNING

THIS EQUIPMENT MUST BE STORED IN A SECURED, SHELTERED AREA WHEN NOT IN USE OR IN THE THREAT OF HIGH WINDS. ANY WEATHER DAMAGE TO THIS EQUIPMENT WILL NOT BE COVERED UNDER KWIK GOAL'S PRODUCT GUARANTEE. DO NOT LEAVE THIS EQUIPMENT UNATTENDED.

6. Attach seat frames at seat frame plate locations.
(CAUTION DO NOT OVER TIGHTEN BOLTS.)

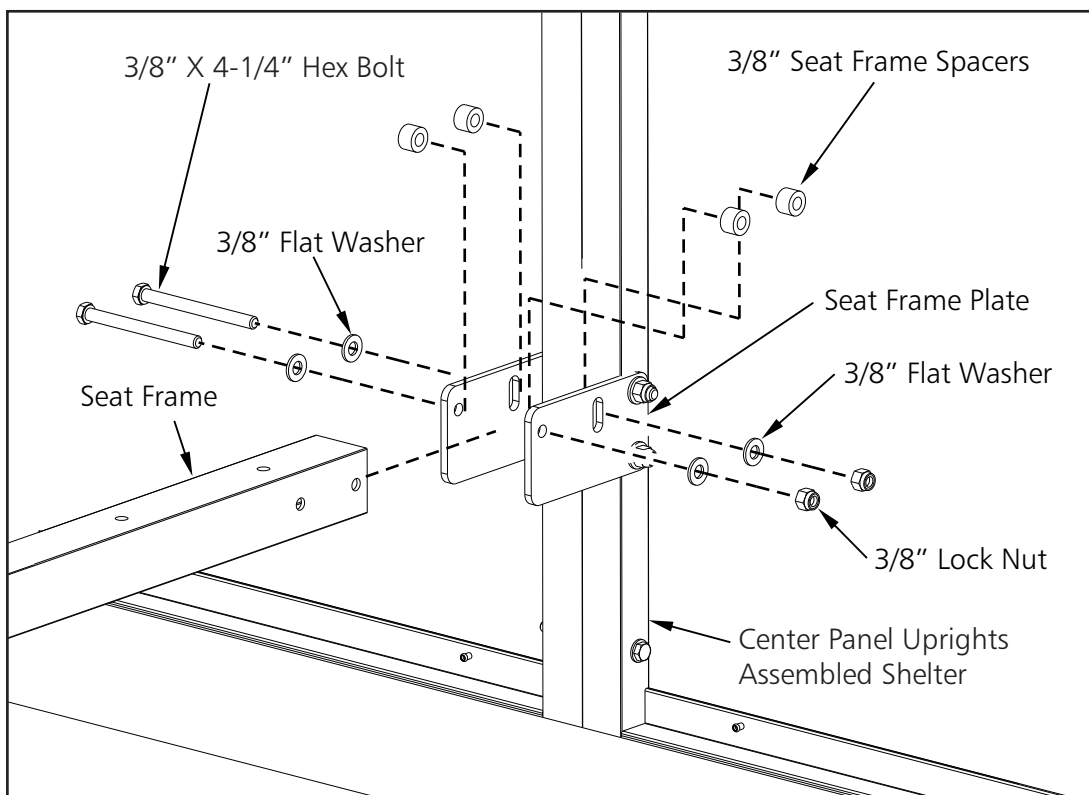
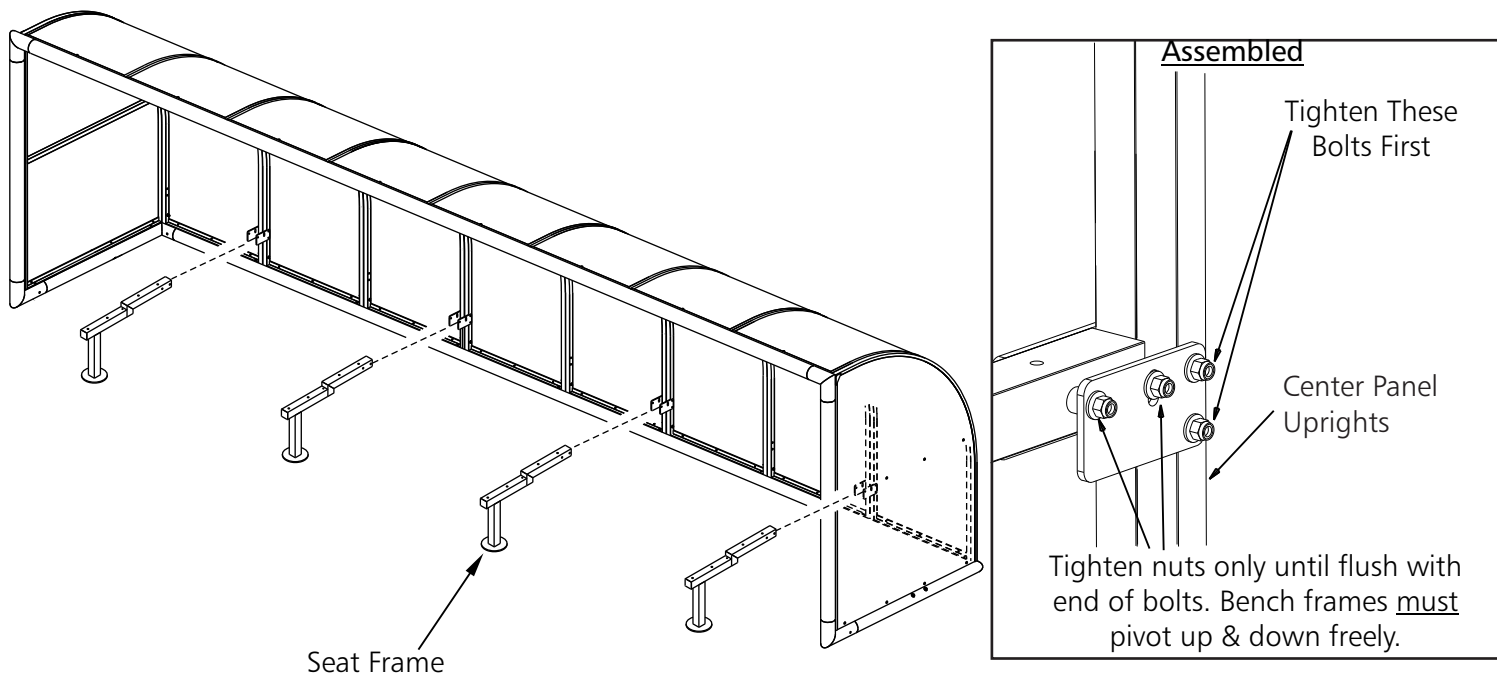

THIS UNIT MUST BE ANCHORED ACCORDING TO THESE INSTRUCTIONS AT ALL TIMES

⚠WARNING

THIS EQUIPMENT MUST BE STORED IN A SECURED, SHELTERED AREA WHEN NOT IN USE OR IN THE THREAT OF HIGH WINDS. ANY WEATHER DAMAGE TO THIS EQUIPMENT WILL NOT BE COVERED UNDER KWIK GOAL'S PRODUCT GUARANTEE. DO NOT LEAVE THIS EQUIPMENT UNATTENDED.

7. Tighten all panel joint bolts. Begin at center joint and work outward. Tighten 3 bolts per joint. Tighten 3 panel frame bolts on each of the left and right end panels. Tighten panel to frame bolts at top and bottom of each center panel.

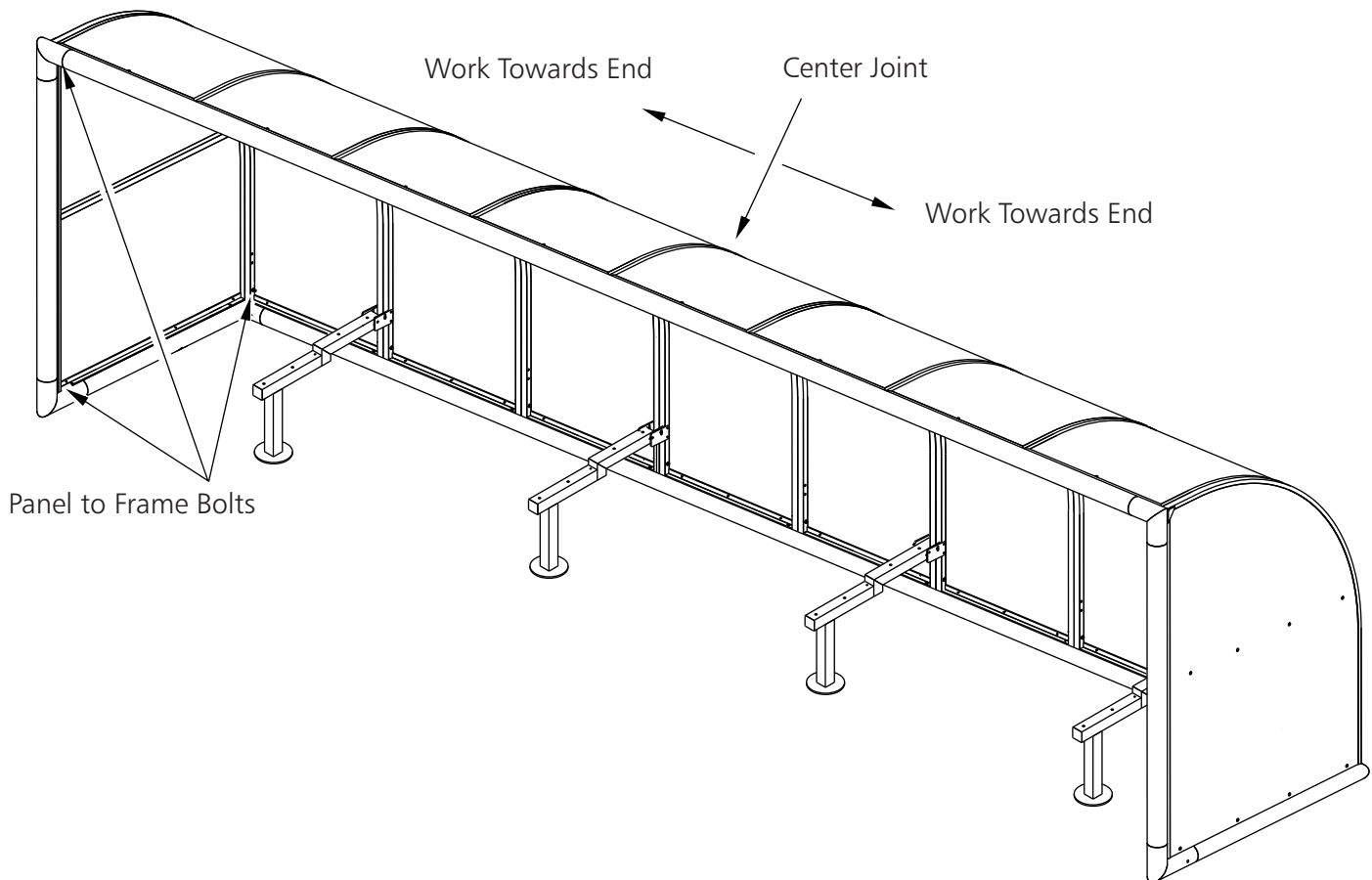

THIS UNIT MUST BE ANCHORED ACCORDING TO THESE INSTRUCTIONS AT ALL TIMES

⚠ WARNING

THIS EQUIPMENT MUST BE STORED IN A SECURED, SHELTERED AREA WHEN NOT IN USE OR IN THE THREAT OF HIGH WINDS. ANY WEATHER DAMAGE TO THIS EQUIPMENT WILL NOT BE COVERED UNDER KWIK GOAL'S PRODUCT GUARANTEE. DO NOT LEAVE THIS EQUIPMENT UNATTENDED.

8. Center the shelf plank at location shown. Be sure sticker is legible from front of shelter. Attach shelf plank to each seat frame. Align bench hold down parallel with slot in shelf plank, insert, and turn ninety degrees (quarter turn) to attach shelf plank to seat frame.

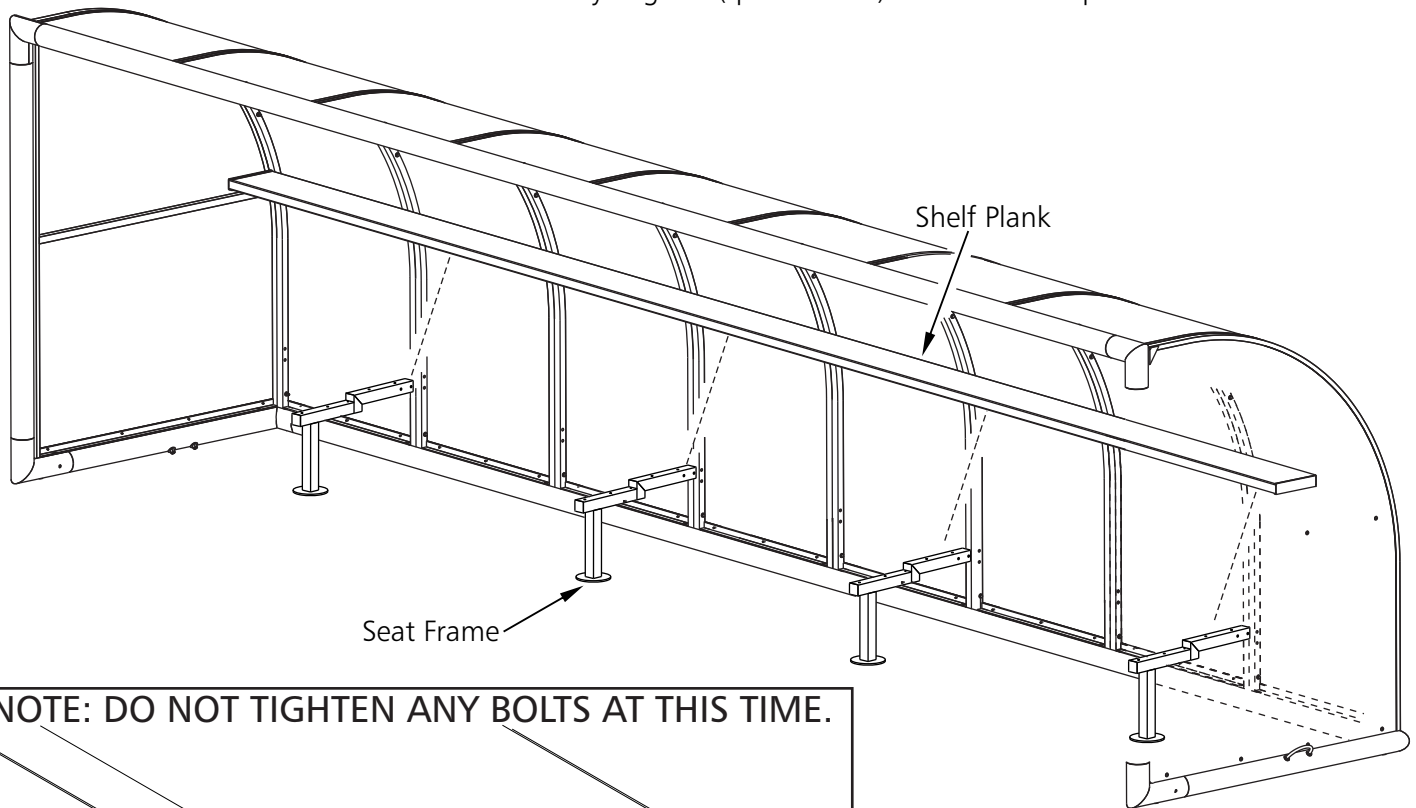

NOTE: DO NOT TIGHTEN ANY BOLTS AT THIS TIME.

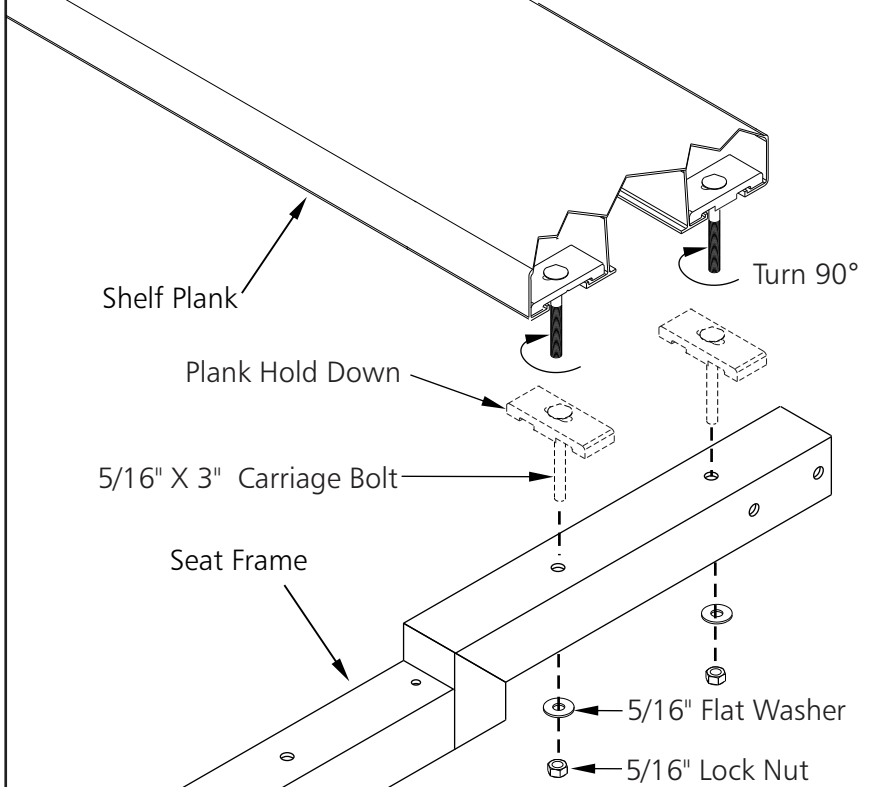

THIS UNIT MUST BE ANCHORED ACCORDING TO THESE INSTRUCTIONS AT ALL TIMES

⚠WARNING

THIS EQUIPMENT MUST BE STORED IN A SECURED, SHELTERED AREA WHEN NOT IN USE OR IN THE THREAT OF HIGH WINDS. ANY WEATHER DAMAGE TO THIS EQUIPMENT WILL NOT BE COVERED UNDER KWIK GOAL'S PRODUCT GUARANTEE. DO NOT LEAVE THIS EQUIPMENT UNATTENDED.

9. Attach molded seat crossbar front and rear to seat frames and seat supports.
Note: Make sure colored dots on molded seat crossbars are located as shown below. Tighten shelf plank bolts at this time.
(CAUTION DO NOT OVER TIGHTEN BOLTS.)

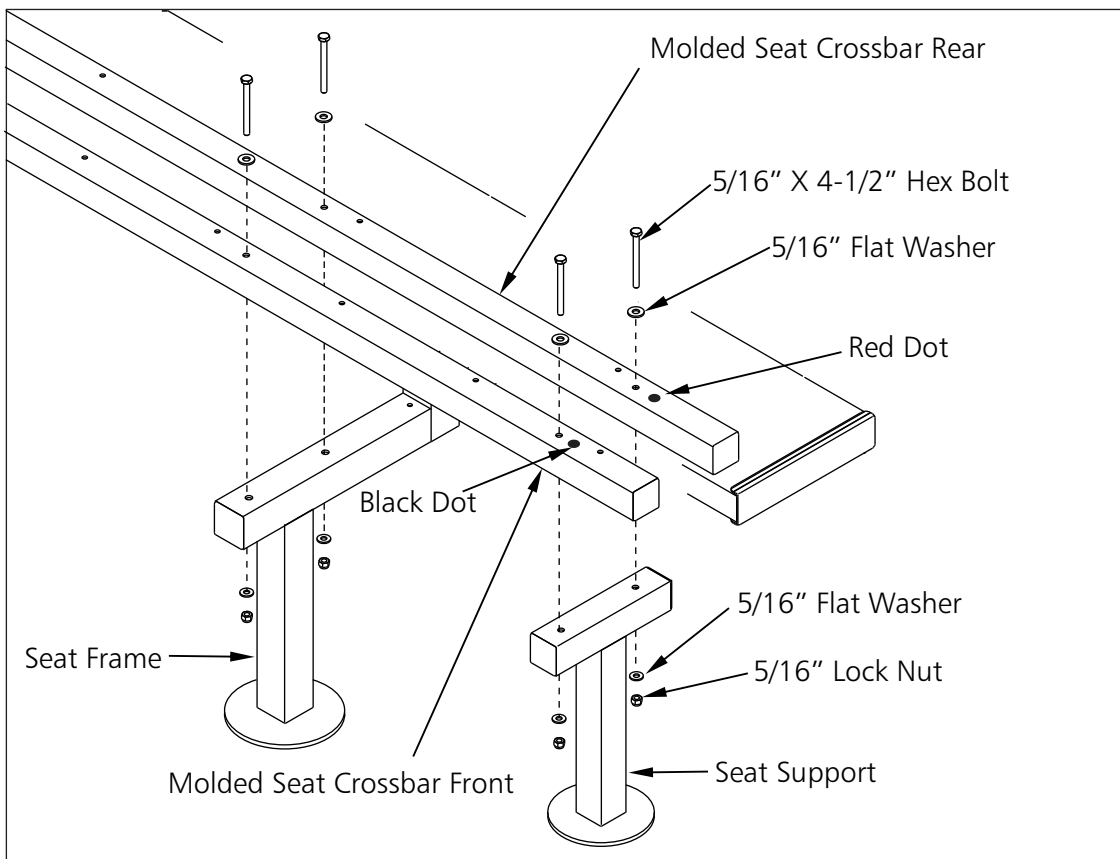
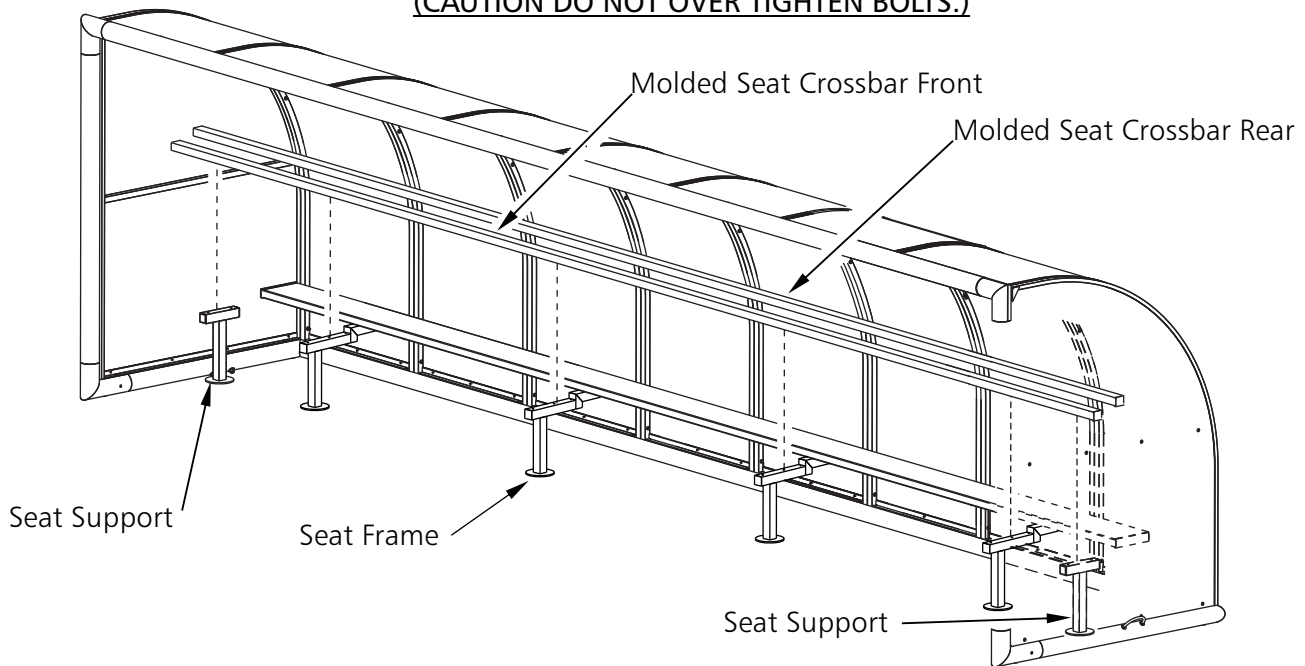

THIS UNIT MUST BE ANCHORED ACCORDING TO THESE INSTRUCTIONS AT ALL TIMES

⚠WARNING

THIS EQUIPMENT MUST BE STORED IN A SECURED, SHELTERED AREA WHEN NOT IN USE OR IN THE THREAT OF HIGH WINDS. ANY WEATHER DAMAGE TO THIS EQUIPMENT WILL NOT BE COVERED UNDER KWIK GOAL'S PRODUCT GUARANTEE. DO NOT LEAVE THIS EQUIPMENT UNATTENDED.

10. Starting at one end, attach molded seats to molded seat crossbars. After all molded seats are attached to molded seat crossbars, tighten all seating bolts. **(CAUTION DO NOT OVER TIGHTEN BOLTS.)**

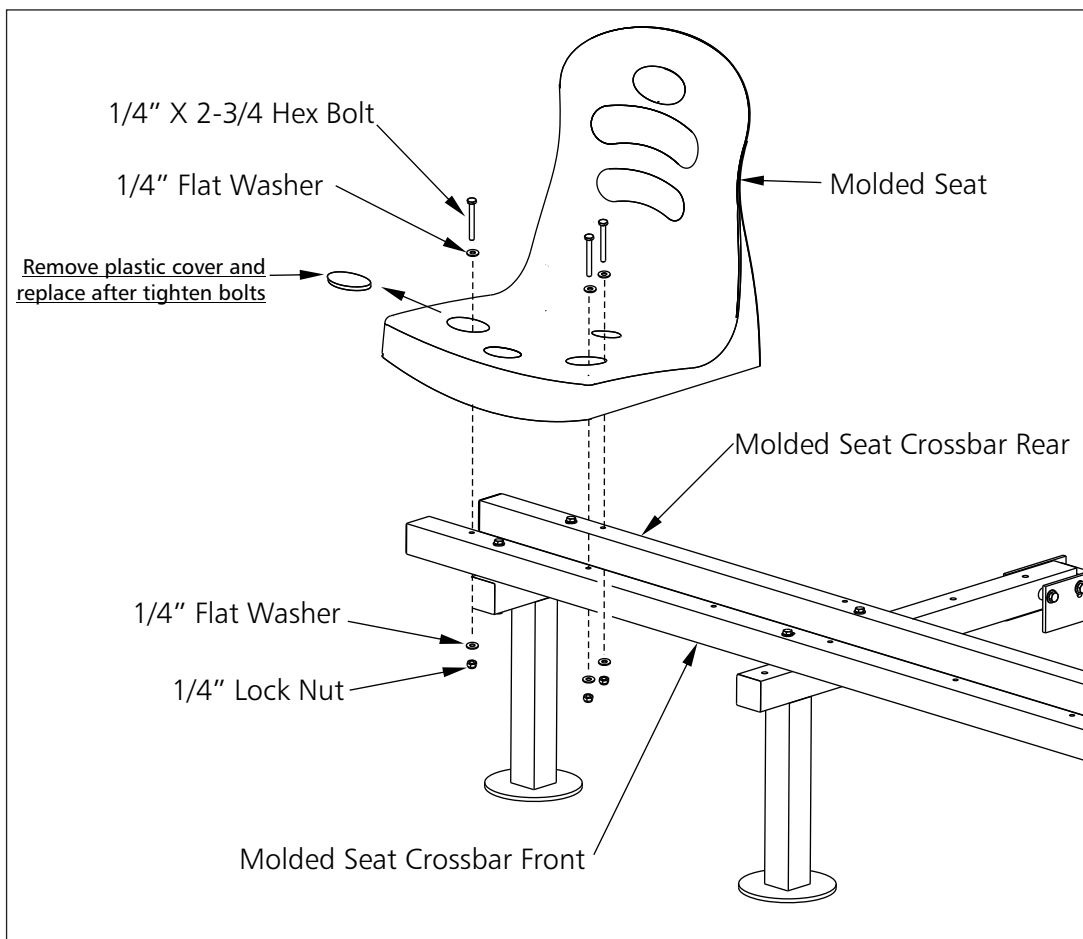
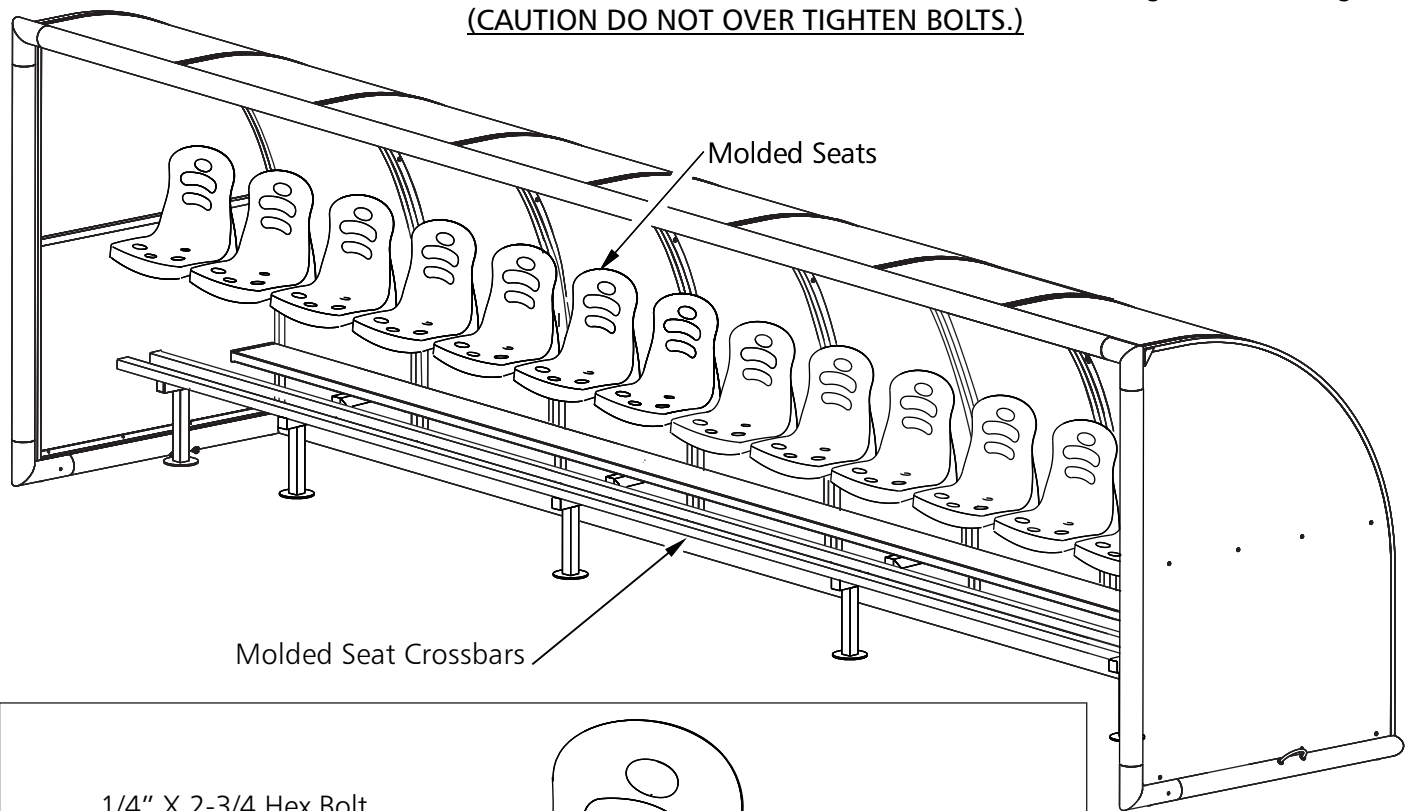

THIS UNIT MUST BE ANCHORED ACCORDING TO THESE INSTRUCTIONS AT ALL TIMES

⚠WARNING

THIS EQUIPMENT MUST BE STORED IN A SECURED, SHELTERED AREA WHEN NOT IN USE OR IN THE THREAT OF HIGH WINDS. ANY WEATHER DAMAGE TO THIS EQUIPMENT WILL NOT BE COVERED UNDER KWIK GOAL'S PRODUCT GUARANTEE. DO NOT LEAVE THIS EQUIPMENT UNATTENDED.

11. Be sure Shelter is properly anchored according to 9B51 Shelter Frame Instructions.

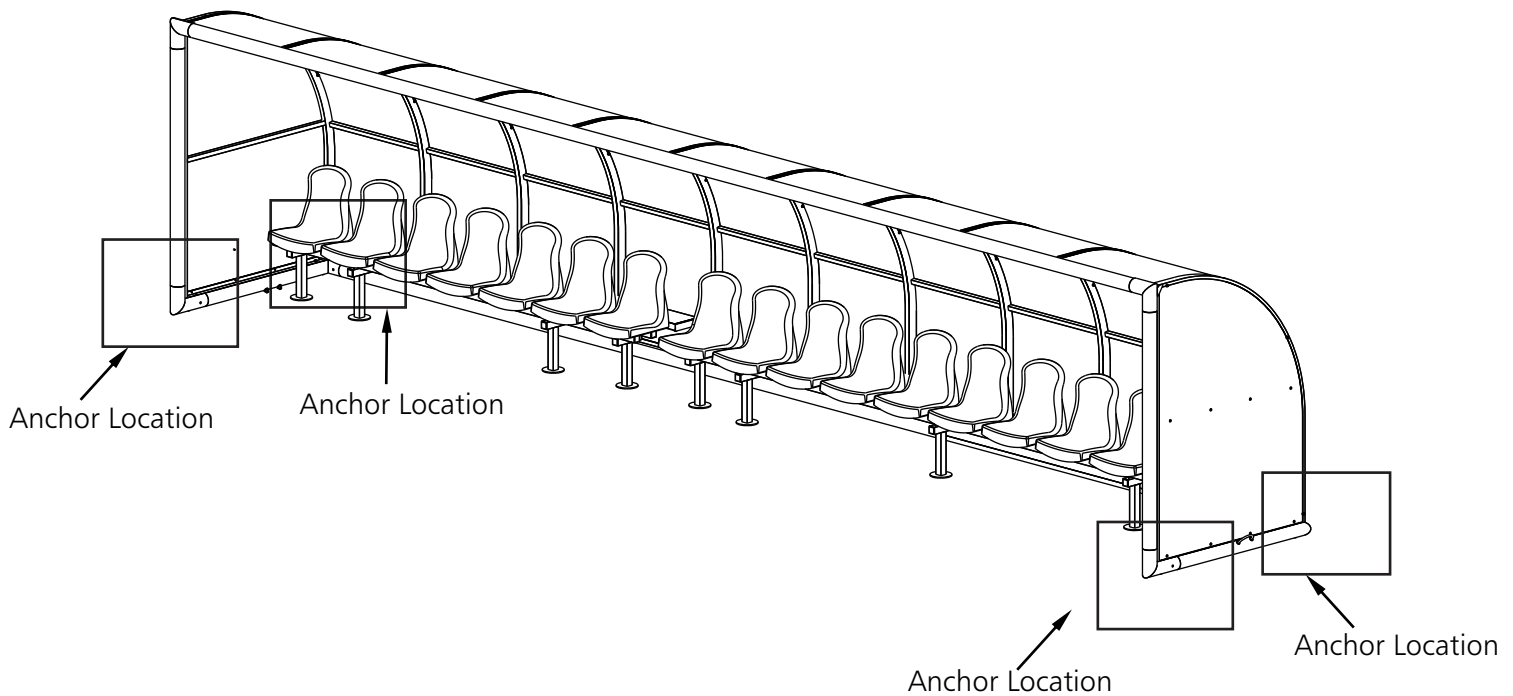

THIS UNIT MUST BE ANCHORED ACCORDING TO THESE INSTRUCTIONS AT ALL TIMES

⚠ WARNING

THIS EQUIPMENT MUST BE STORED IN A SECURED, SHELTERED AREA WHEN NOT IN USE OR IN THE THREAT OF HIGH WINDS. ANY WEATHER DAMAGE TO THIS EQUIPMENT WILL NOT BE COVERED UNDER KWIK GOAL'S PRODUCT GUARANTEE. DO NOT LEAVE THIS EQUIPMENT UNATTENDED.

12. Attach seat frame plates to assembled shelter panels as shown. Attach remaining seat frame plates to assembled shelter panels at needed locations, do not exceed two panels between seat frame plates. Do not tighten bolts at this time.
NOTE: It may be necessary to loosen panel bolts to allow frame plate bolts to be inserted.

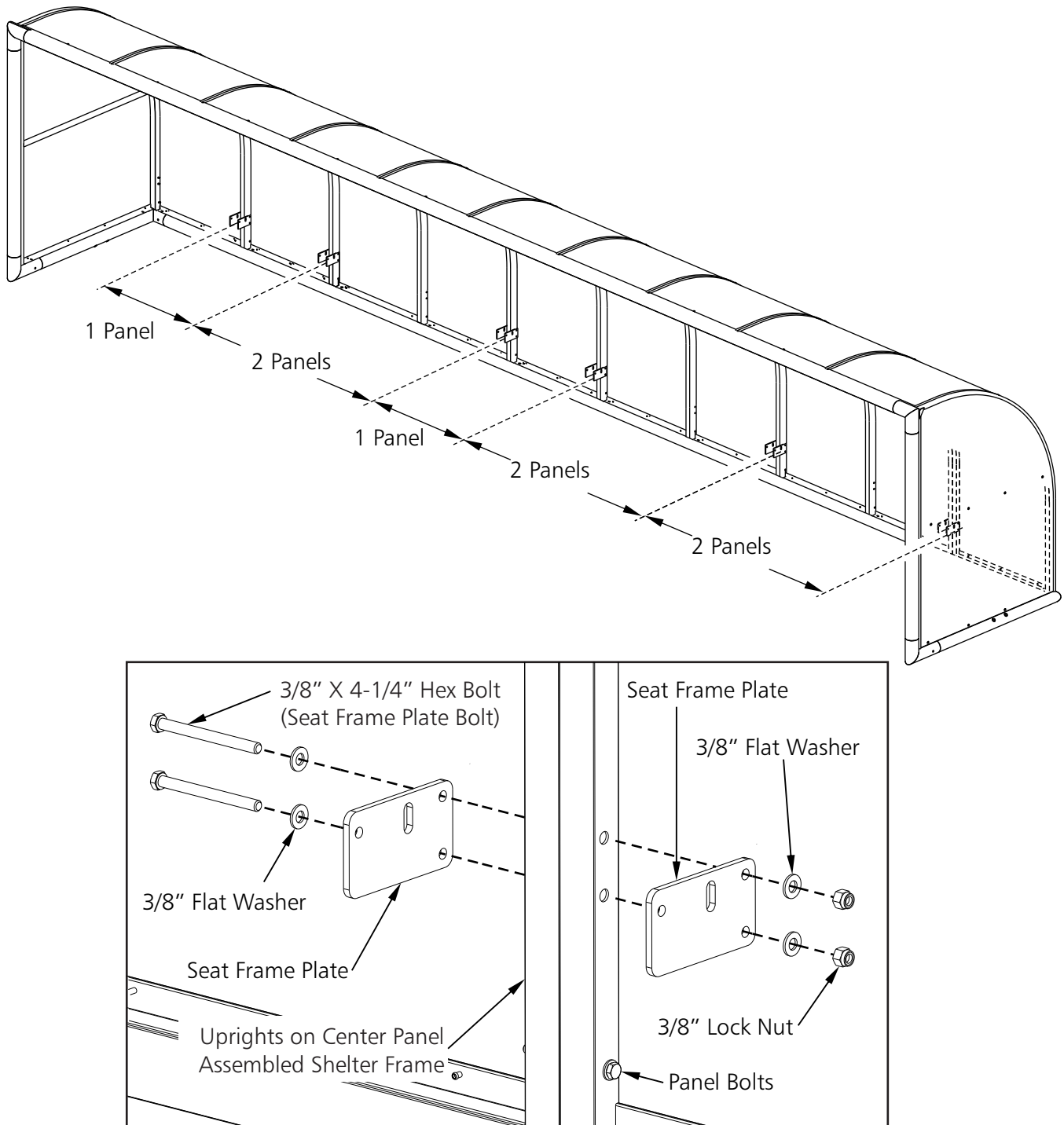

THIS UNIT MUST BE ANCHORED ACCORDING TO THESE INSTRUCTIONS AT ALL TIMES

⚠WARNING

THIS EQUIPMENT MUST BE STORED IN A SECURED, SHELTERED AREA WHEN NOT IN USE OR IN THE THREAT OF HIGH WINDS. ANY WEATHER DAMAGE TO THIS EQUIPMENT WILL NOT BE COVERED UNDER KWIK GOAL'S PRODUCT GUARANTEE. DO NOT LEAVE THIS EQUIPMENT UNATTENDED.

13. Attach seat frames at seat frame plate locations.
(CAUTION DO NOT OVER TIGHTEN BOLTS.)

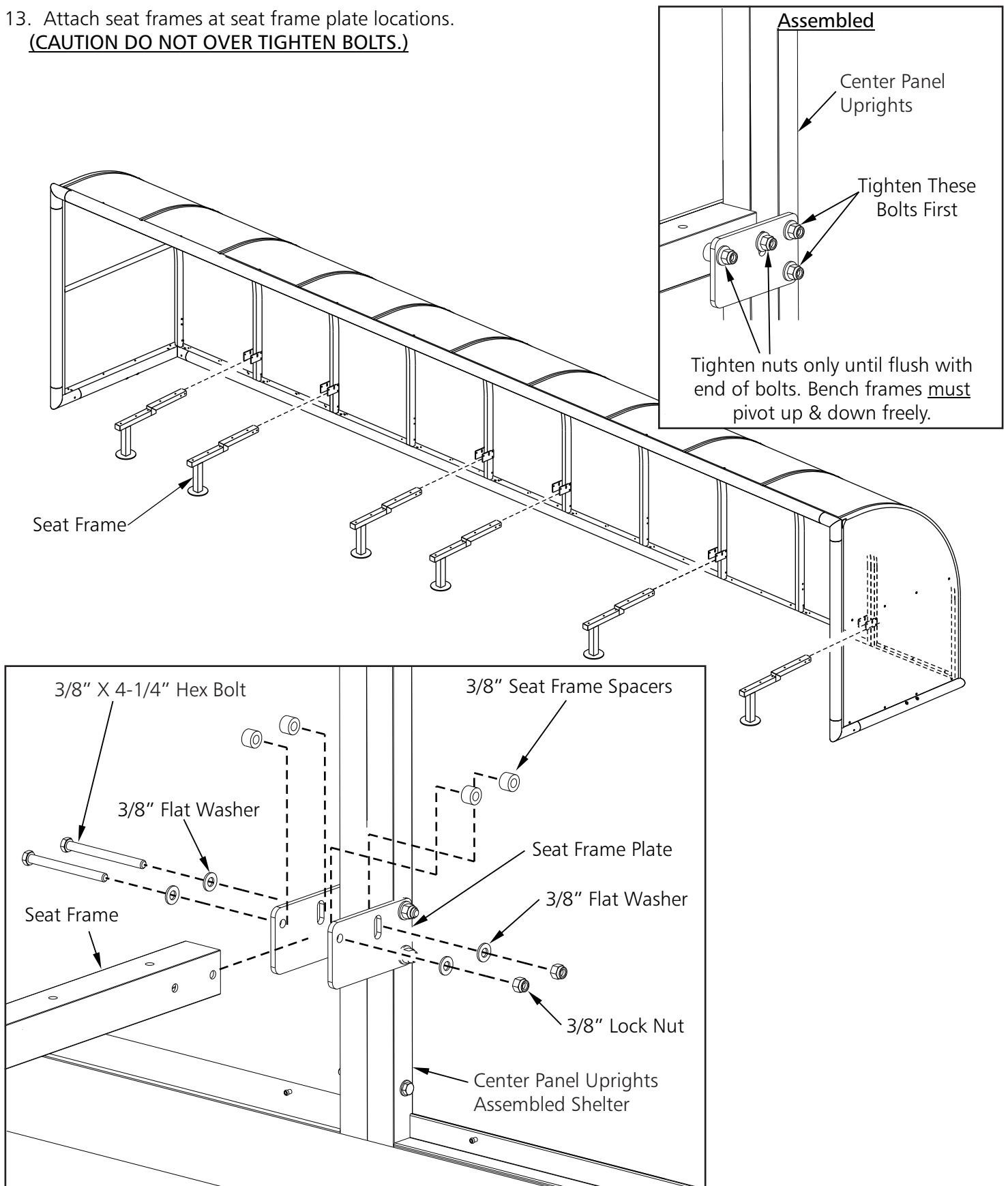

THIS UNIT MUST BE ANCHORED ACCORDING TO THESE INSTRUCTIONS AT ALL TIMES

⚠WARNING

THIS EQUIPMENT MUST BE STORED IN A SECURED, SHELTERED AREA WHEN NOT IN USE OR IN THE THREAT OF HIGH WINDS. ANY WEATHER DAMAGE TO THIS EQUIPMENT WILL NOT BE COVERED UNDER KWIK GOAL'S PRODUCT GUARANTEE. DO NOT LEAVE THIS EQUIPMENT UNATTENDED.

14. Tighten all panel joint bolts. Begin at center joint and work outward. Tighten 3 bolts per joint. Tighten 3 panel frame bolts on each of the left and right end panels. Tighten panel to frame bolts at top and bottom of each center panel.

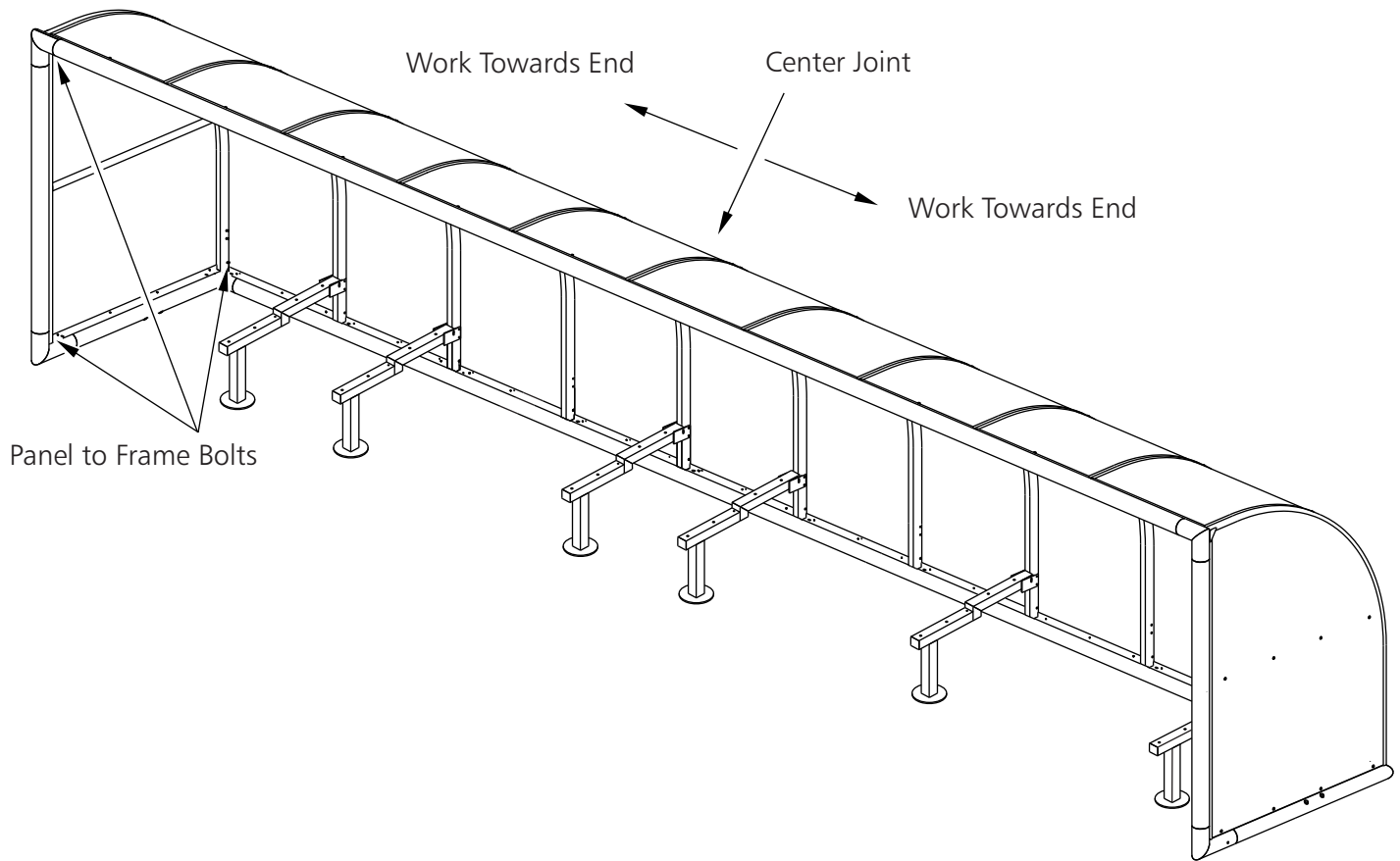

THIS UNIT MUST BE ANCHORED ACCORDING TO THESE INSTRUCTIONS AT ALL TIMES

⚠WARNING

THIS EQUIPMENT MUST BE STORED IN A SECURED, SHELTERED AREA WHEN NOT IN USE OR IN THE THREAT OF HIGH WINDS. ANY WEATHER DAMAGE TO THIS EQUIPMENT WILL NOT BE COVERED UNDER KWIK GOAL'S PRODUCT GUARANTEE. DO NOT LEAVE THIS EQUIPMENT UNATTENDED.

15. Install shelf planks at locations shown. Leave 6-1/4" of space between planks and from each end to polycarbonate of side panels. Be sure sticker is legible from front of shelter. Attach shelf plank to each seat frame. Align bench hold down parallel with slot in shelf plank, insert, and turn ninety degrees (quarter turn) to attach shelf plank to seat frame.

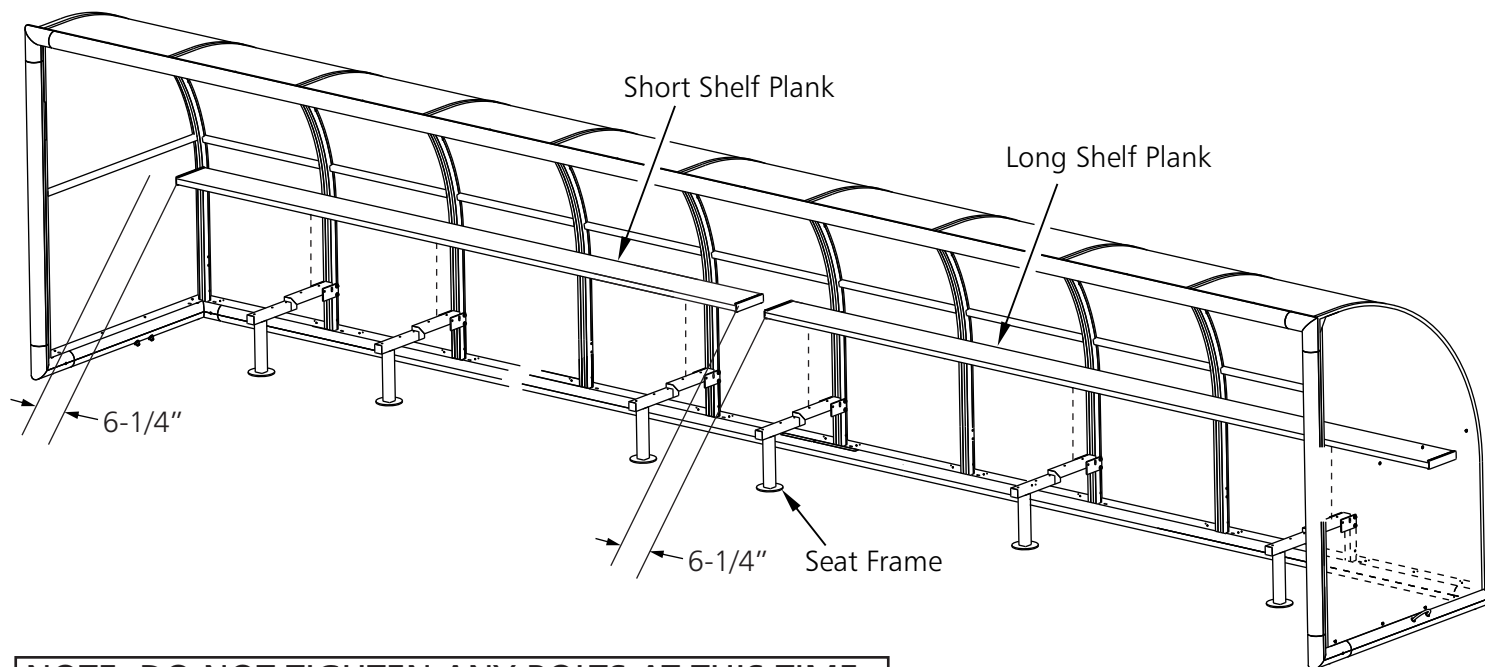

NOTE: DO NOT TIGHTEN ANY BOLTS AT THIS TIME.

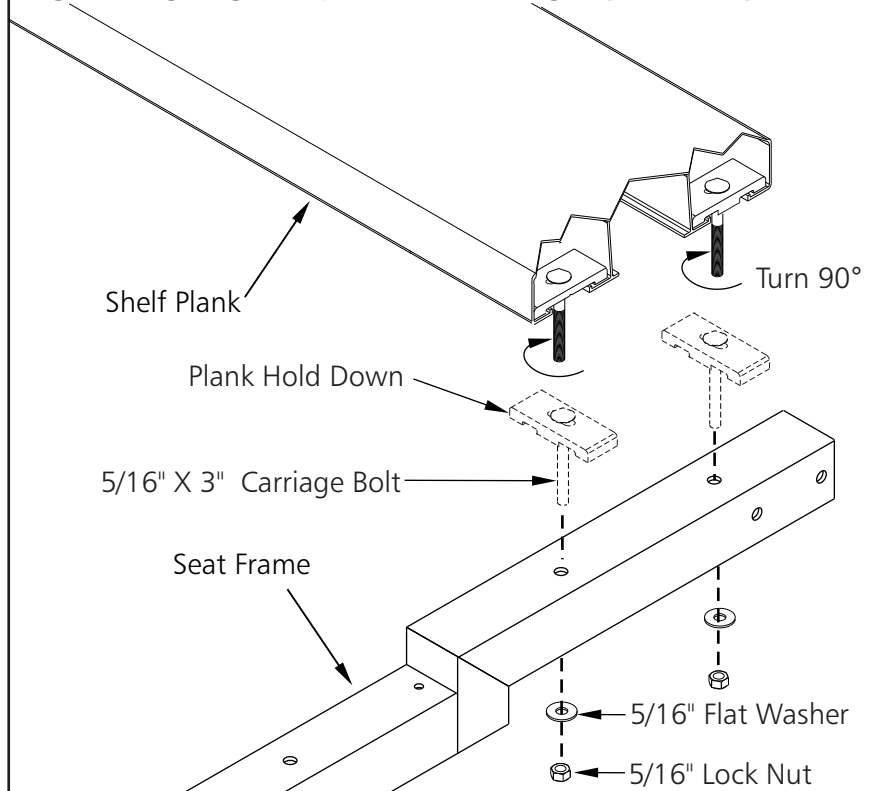

THIS UNIT MUST BE ANCHORED ACCORDING TO THESE INSTRUCTIONS AT ALL TIMES

⚠ WARNING

THIS EQUIPMENT MUST BE STORED IN A SECURED, SHELTERED AREA WHEN NOT IN USE OR IN THE THREAT OF HIGH WINDS. ANY WEATHER DAMAGE TO THIS EQUIPMENT WILL NOT BE COVERED UNDER KWIK GOAL'S PRODUCT GUARANTEE. DO NOT LEAVE THIS EQUIPMENT UNATTENDED.

16. Attach molded seat crossbar front and rear to seat frames and seat supports. Note: Make sure colored dots on molded seat crossbars are located as shown below. Tighten shelf plank bolts at this time.

(CAUTION DO NOT OVER TIGHTEN BOLTS.)

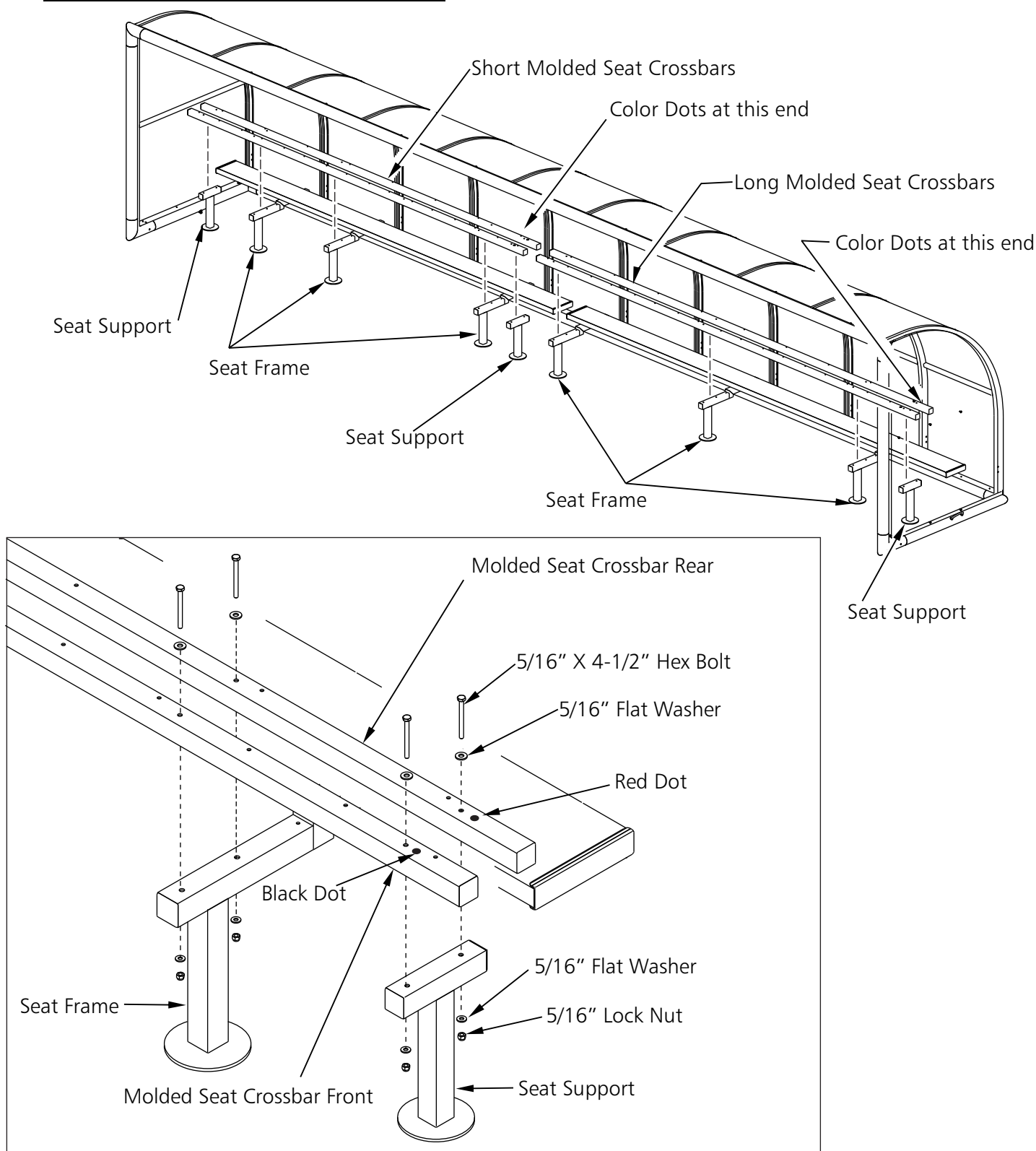

THIS UNIT MUST BE ANCHORED ACCORDING TO THESE INSTRUCTIONS AT ALL TIMES

⚠ WARNING

THIS EQUIPMENT MUST BE STORED IN A SECURED, SHELTERED AREA WHEN NOT IN USE OR IN THE THREAT OF HIGH WINDS. ANY WEATHER DAMAGE TO THIS EQUIPMENT WILL NOT BE COVERED UNDER KWIK GOAL'S PRODUCT GUARANTEE. DO NOT LEAVE THIS EQUIPMENT UNATTENDED.

17. Starting at one end, attach molded seats to molded seat crossbars. After all molded seats are attached to molded seat crossbars, tighten all seating bolts.
(CAUTION DO NOT OVER TIGHTEN BOLTS.)

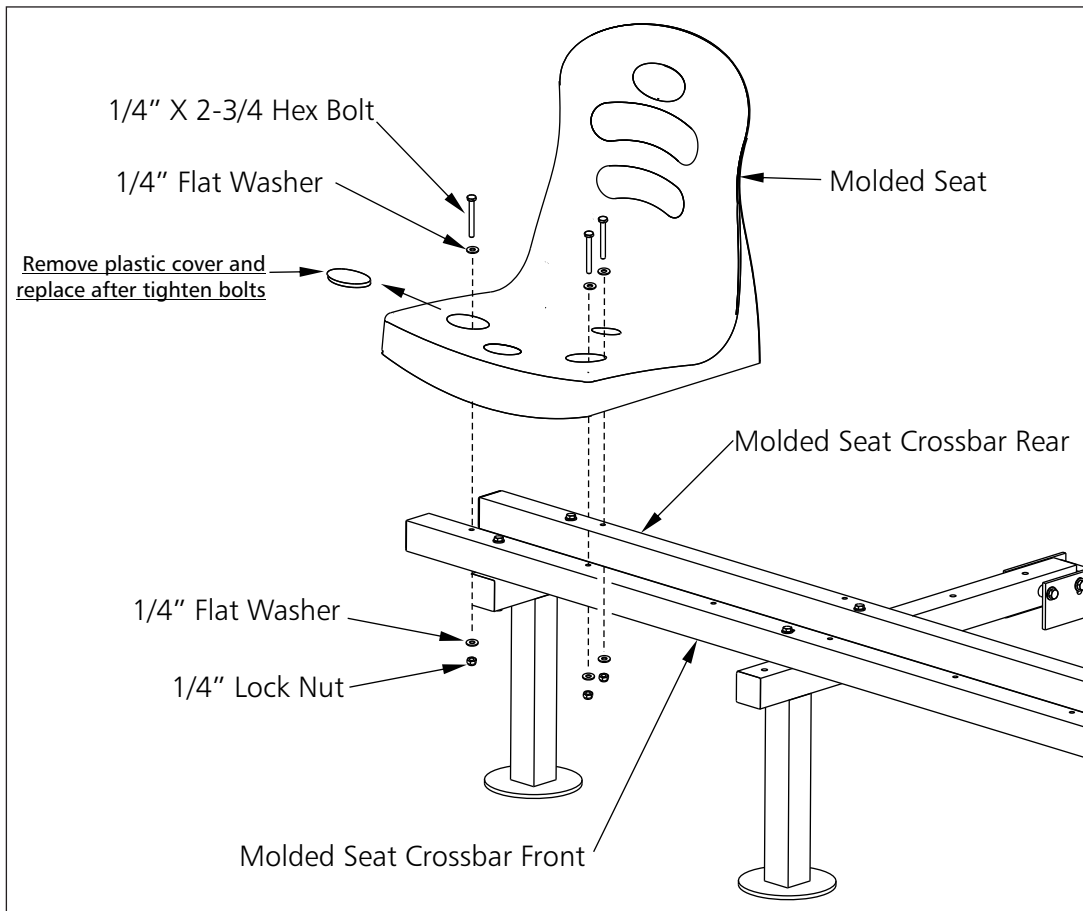
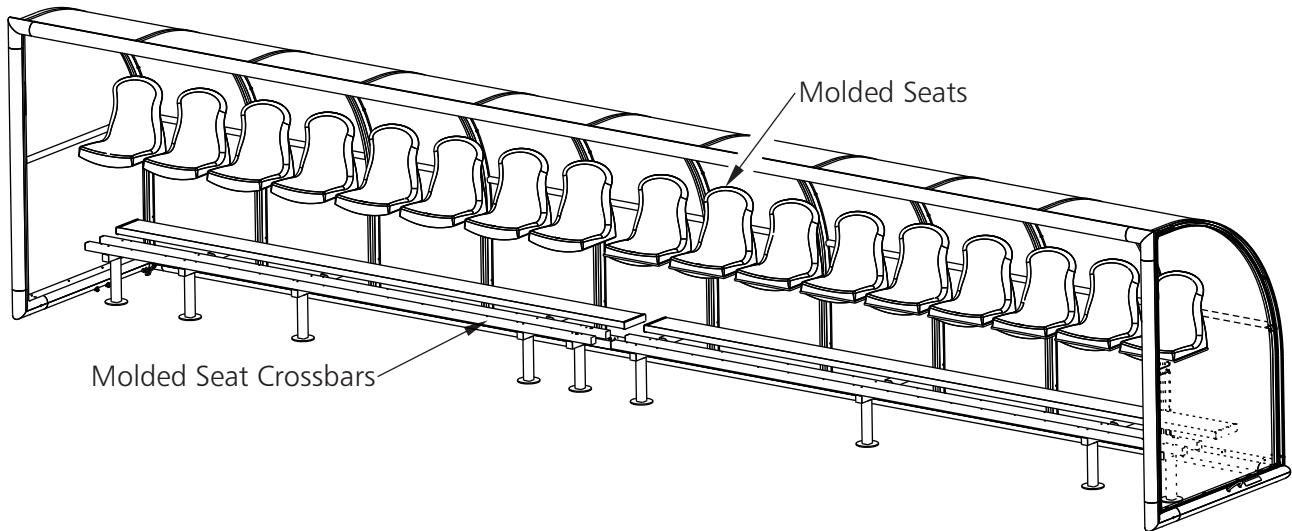

THIS UNIT MUST BE ANCHORED ACCORDING TO THESE INSTRUCTIONS AT ALL TIMES

⚠ WARNING

THIS EQUIPMENT MUST BE STORED IN A SECURED, SHELTERED AREA WHEN NOT IN USE OR IN THE THREAT OF HIGH WINDS. ANY WEATHER DAMAGE TO THIS EQUIPMENT WILL NOT BE COVERED UNDER KWIK GOAL'S PRODUCT GUARANTEE. DO NOT LEAVE THIS EQUIPMENT UNATTENDED.

18. Be sure Shelter is properly anchored according to 9B51 Shelter Frame Instructions.

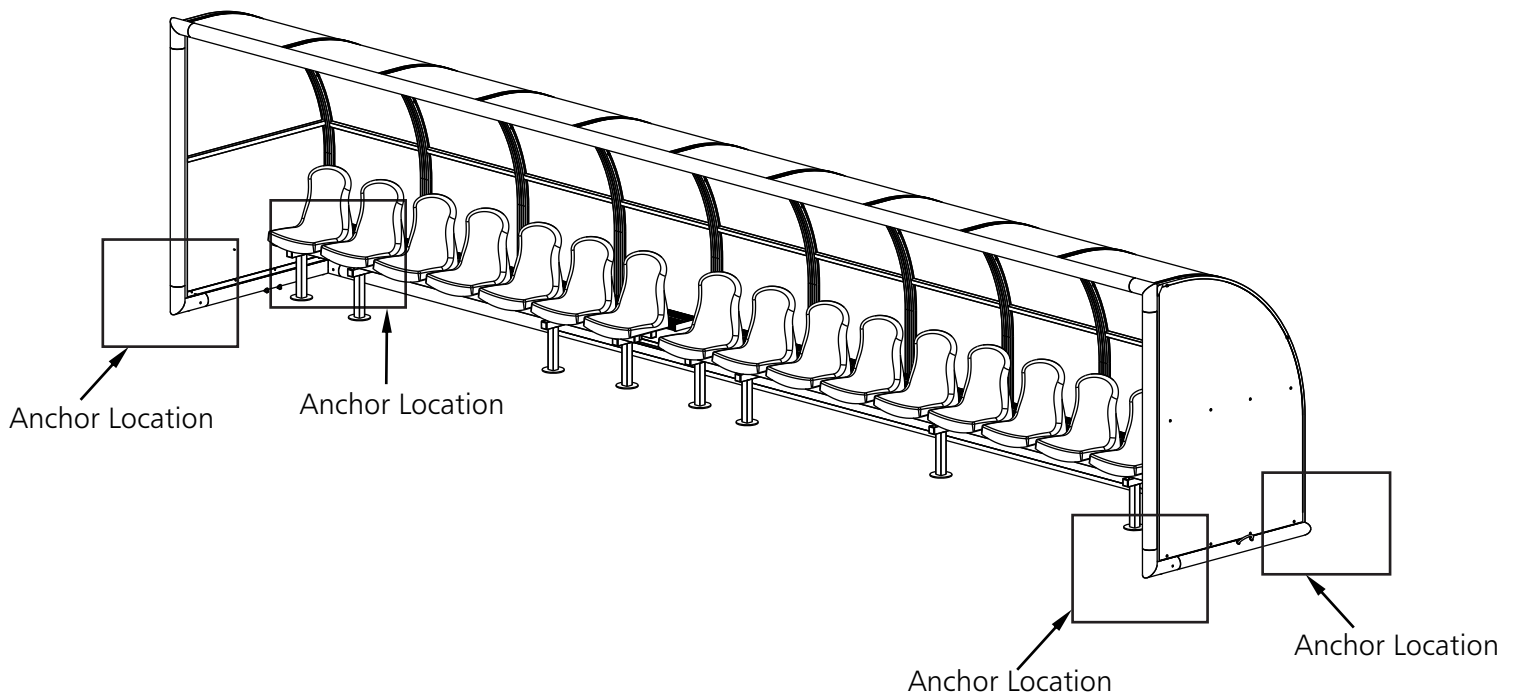

Go to kwikgoal.com for additional product information.

THIS UNIT MUST BE ANCHORED ACCORDING TO THESE INSTRUCTIONS AT ALL TIMES

⚠ WARNING

THIS EQUIPMENT MUST BE STORED IN A SECURED, SHELTERED AREA WHEN NOT IN USE OR IN THE THREAT OF HIGH WINDS. ANY WEATHER DAMAGE TO THIS EQUIPMENT WILL NOT BE COVERED UNDER KWIK GOAL'S PRODUCT GUARANTEE. DO NOT LEAVE THIS EQUIPMENT UNATTENDED.