



## ASSEMBLY INSTRUCTIONS FOR 9B1201 SHELTER DOLLY

### **SHELTERS MUST BE ANCHORED AT ALL TIMES WITH PERMANENT GROUND ANCHORS.**

1. Unpack all parts and check for damage that may have occurred during shipping. If damage has occurred, notify Kwik Goal immediately. Lay out all parts. Remove all cardboard and packaging immediately. Wet or damp packaging may damage contents.
2. Read through entire instruction before beginning assembly and installation.

### Parts

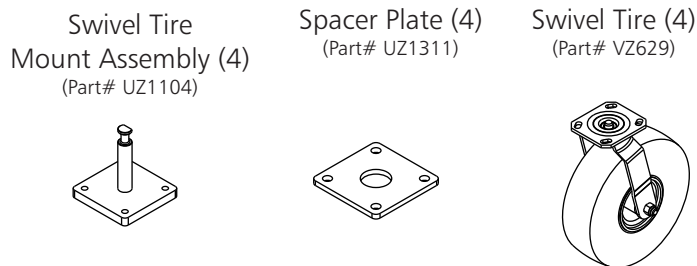
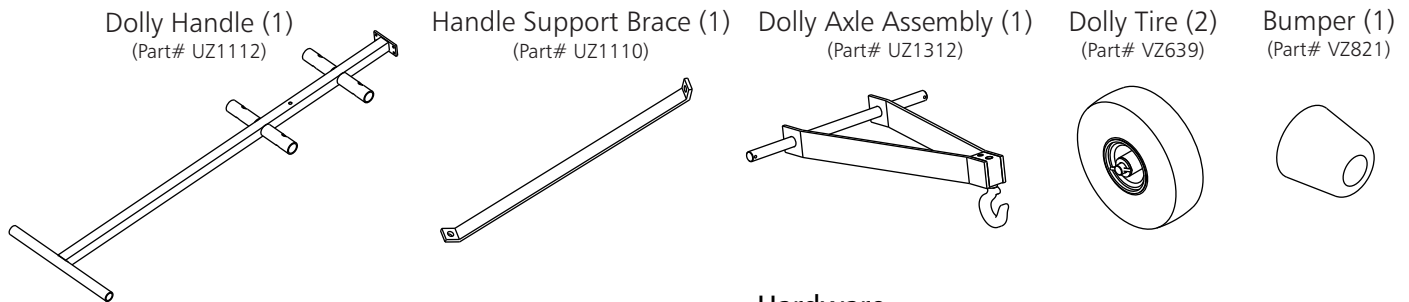

### Hardware

**Note: Hardware may be packaged separately in one or more boxes. Open all packages before beginning assembly.**

- |   |      |
|---|------|
| 3/16" X 1-1/2" Cotter Pin (Part# TZ310) | (2)  |
| 1/4" U-Bolt (Part# TZ309)               | (2)  |
| 1/4" Flat Washer (Part# TZ147)          | (4)  |
| 1/4" Lock Nut (Part# TZ19)              | (4)  |
| 5/16" X 1-1/2" Hex Bolt (Part# TZ341)   | (16) |
| 5/16" Flat Washer (Part# TZ4)           | (16) |
| 5/16" Lock Nut (Part# TZ5)              | (16) |
| 3/8" X 2-1/2" Hex Bolt (Part# TZ165)    | (1)  |
| 3/8" X 3" Hex Bolt (Part# TZ325)        | (1)  |
| 3/8" Flat Washer (Part# TZ189)          | (4)  |
| 3/8" Lock Nut (Part# TZ197)             | (2)  |
| 3/4" Flat Washer (Part# TZ2)            | (4)  |
| 1/4" X 1-1/4" Button Head (Part# TZ397) | (1)  |

### Assembly Tools

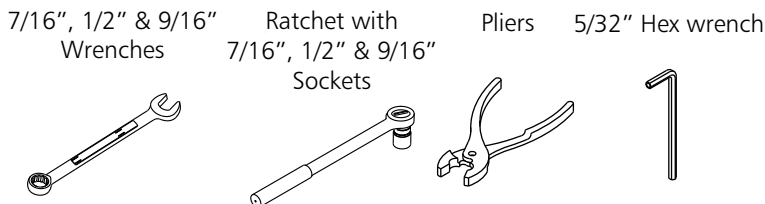

### **⚠ WARNING**

**THIS EQUIPMENT MUST BE STORED IN A SECURED, SHELTERED AREA WHEN NOT IN USE OR IN THE THREAT OF HIGH WINDS. ANY WEATHER DAMAGE TO THIS EQUIPMENT WILL NOT BE COVERED UNDER KWIK GOAL'S PRODUCT GUARANTEE. DO NOT LEAVE THIS EQUIPMENT UNATTENDED.**



## **⚠️ WARNING**

## **IMPORTANT SAFETY INSTRUCTIONS** **READ CAREFULLY**

1. Lifting and moving heavy field equipment can be dangerous if not done properly. All Kwik Goal shelters must be moved by qualified personnel who are experienced in moving large, heavy field equipment. Kwik Goal recommends storing dolly and wheels in a secured area to prevent unauthorized use.
2. A minimum of four qualified, experienced people are required to install wheels and move shelter.
3. Do not attempt to lift, move, or remove anchors from any shelter in windy conditions.
4. Shelters must not be left unattended when wheels are installed.
5. Shelter must be on level, flat ground to use dolly handle and/or wheels.
6. Dolly is to be used as a wheel transport/storage and shelter lifting device. Do not use dolly to move shelter.
7. Use extreme caution when pushing shelter. Excessive force can overturn shelter. Always push at lowest point on shelter frame possible.
8. Do not push shelter directly from the front to rear or rear to front. Push from end to end. (Refer to 9B1201 - Shelter Dolly instructions for details.)
9. Always use two people to lift shelter with dolly. With one person maintaining light pressure on the handle, the second may insert wheels into shelter. Install both wheels before resting shelter on the ground. (Refer to 9B1201 - Shelter Dolly instructions for details.)

**NEVER LOWER SHELTER WITH ONLY ONE WHEEL INSTALLED**

3. Assemble all 4 swivel tires as shown.

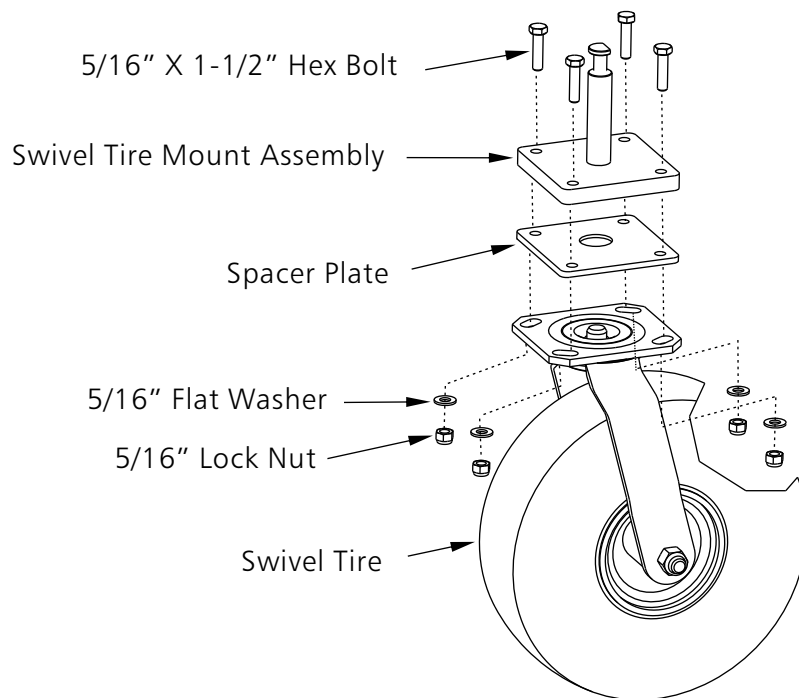

4. Attach tires to dolly axle assembly and secure on axle with cotter pin. Be sure that long side of hub faces in. Apply 5 "pumps" of grease to the grease fitting on each of the six tires.

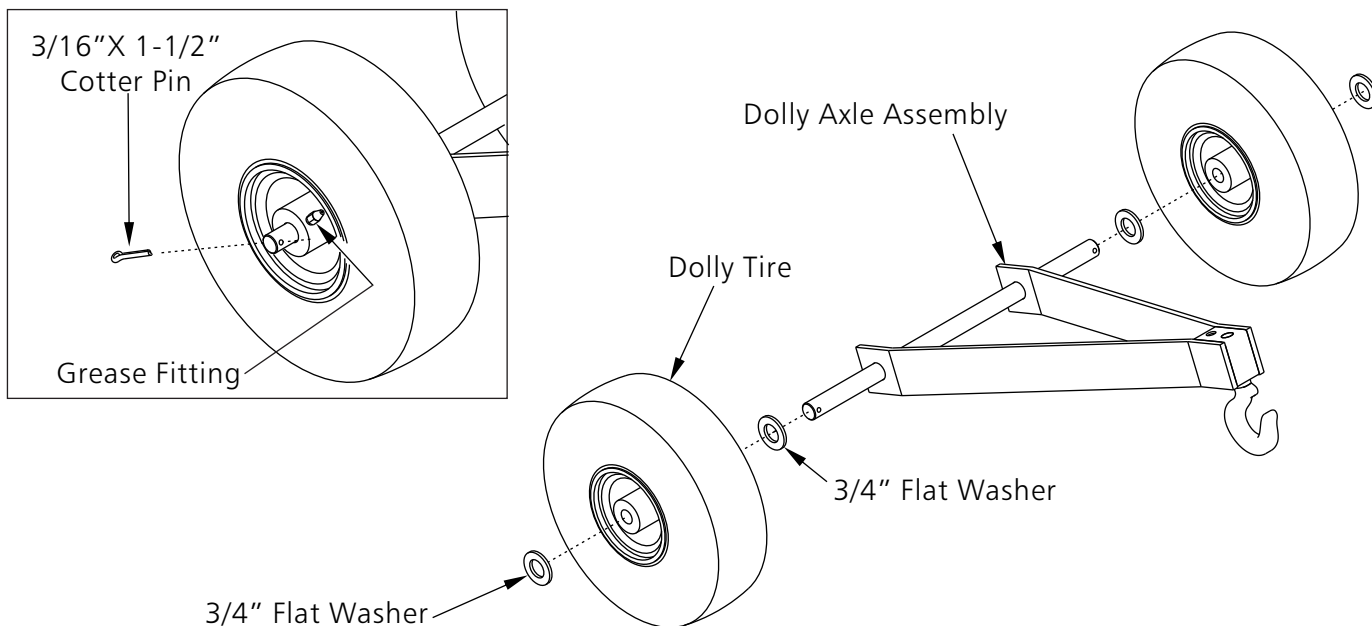

**⚠ WARNING**

THIS EQUIPMENT MUST BE STORED IN A SECURED, SHELTERED AREA WHEN NOT IN USE OR IN THE THREAT OF HIGH WINDS. ANY WEATHER DAMAGE TO THIS EQUIPMENT WILL NOT BE COVERED UNDER KWIK GOAL'S PRODUCT GUARANTEE. DO NOT LEAVE THIS EQUIPMENT UNATTENDED.

5. Complete the assembly of dolly as shown but do NOT tighten bolt until all parts are attached. Note the orientation of holes in dolly handle.

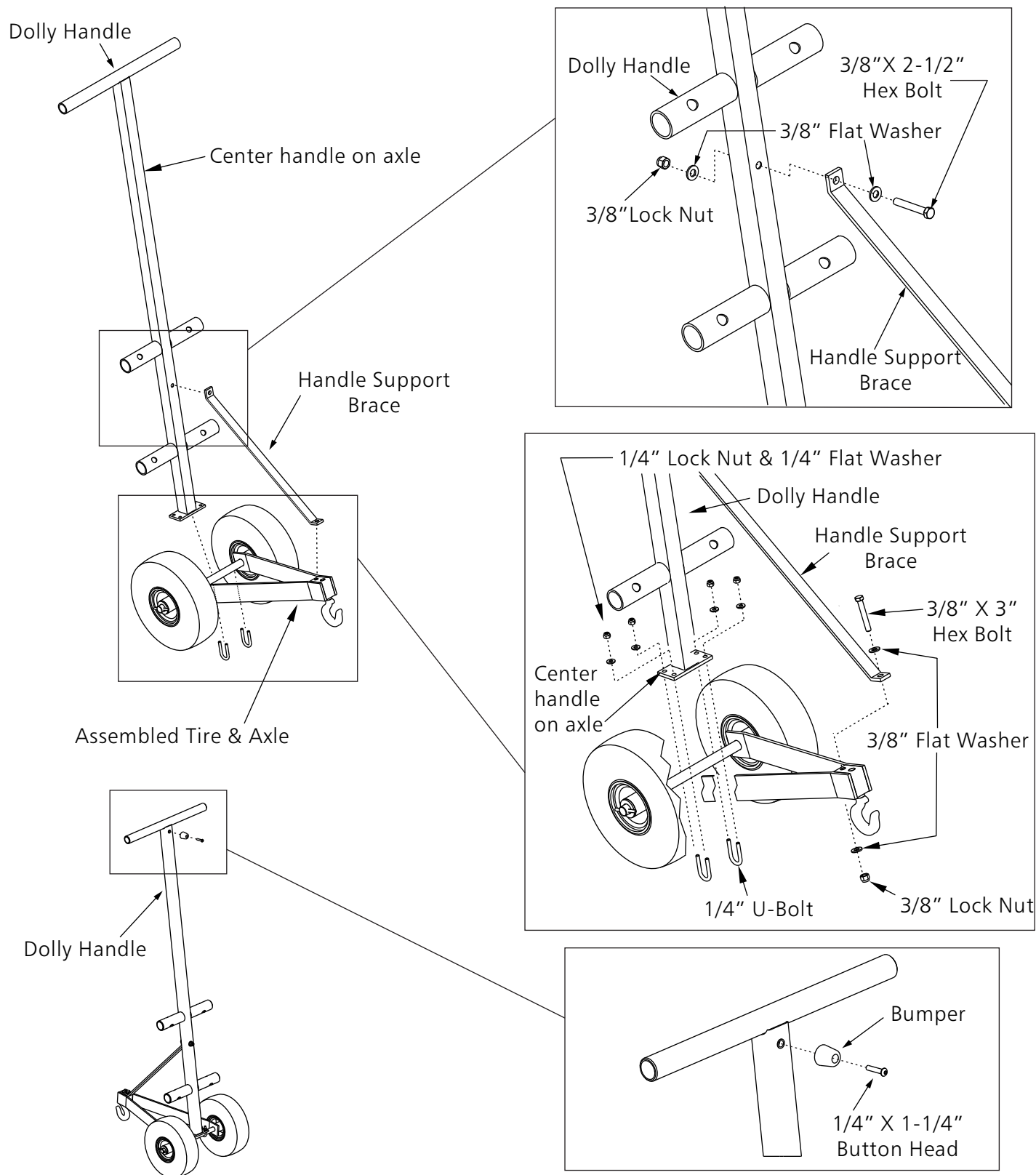

**⚠ WARNING**

THIS EQUIPMENT MUST BE STORED IN A SECURED, SHELTERED AREA WHEN NOT IN USE OR IN THE THREAT OF HIGH WINDS. ANY WEATHER DAMAGE TO THIS EQUIPMENT WILL NOT BE COVERED UNDER KWIK GOAL'S PRODUCT GUARANTEE. DO NOT LEAVE THIS EQUIPMENT UNATTENDED.

6. To lift shelter, insert hook of dolly under lift U-bolt, and with two people, push handle down to ground. With one person maintaining light pressure on the handle, the second may insert tires into shelter. With flat of pin facing forward, insert pin completely into hole in underside of shelter frame and rotate swivel tire mount 1/2 turn to lock tire into place. After installing both tires, use two people to raise dolly handle and rest tires onto ground. **NEVER LOWER SHELTER WITH ONLY ONE TIRE INSTALLED.**

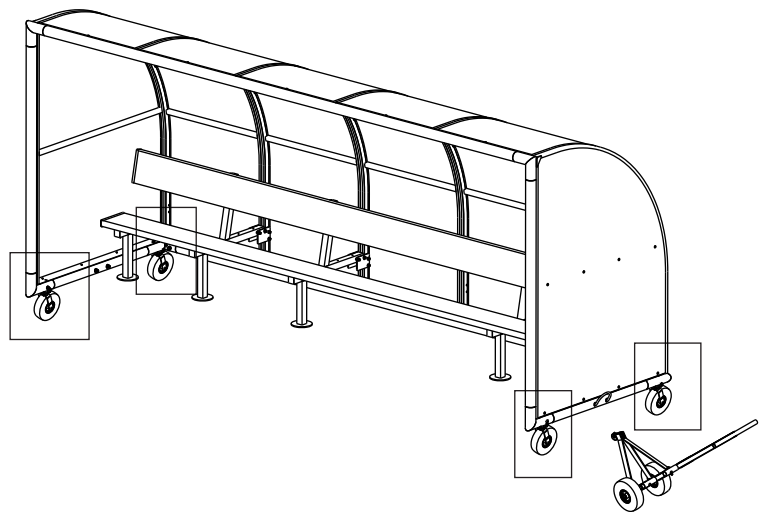
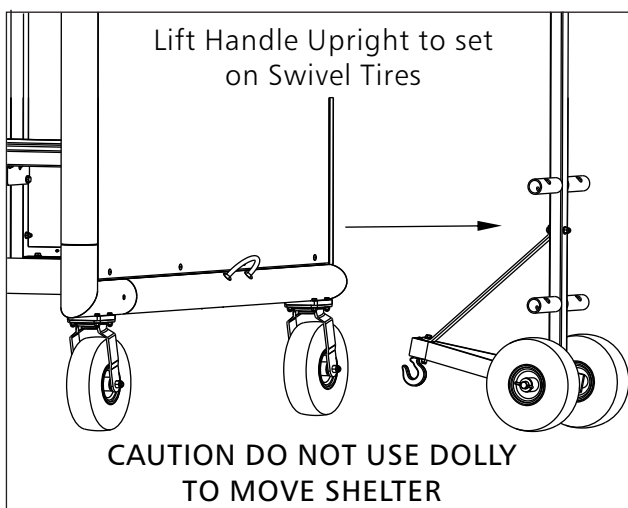
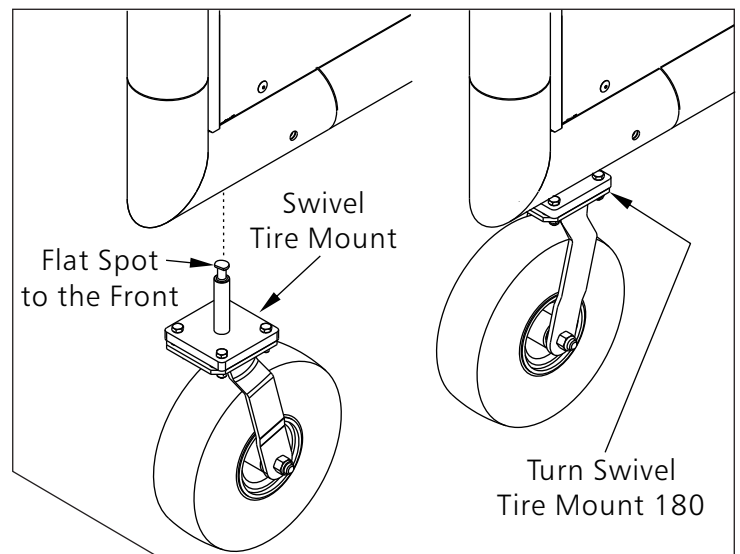
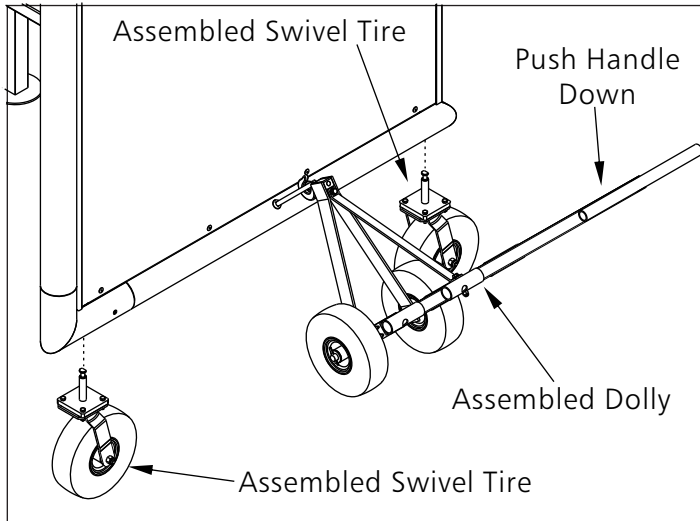
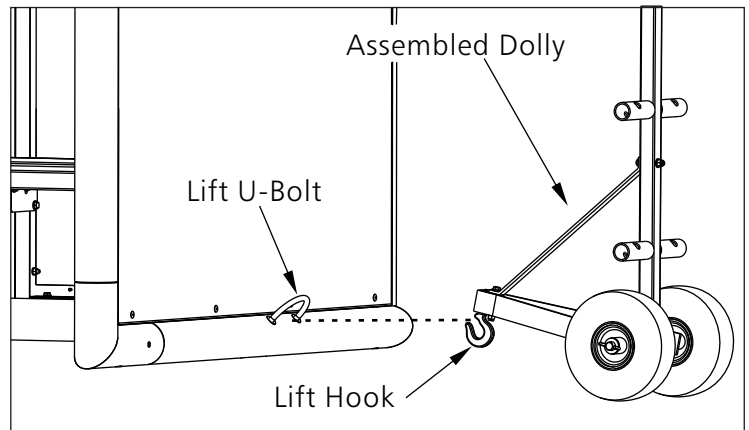

**⚠ WARNING**

THIS EQUIPMENT MUST BE STORED IN A SECURED, SHELTERED AREA WHEN NOT IN USE OR IN THE THREAT OF HIGH WINDS. ANY WEATHER DAMAGE TO THIS EQUIPMENT WILL NOT BE COVERED UNDER KWIK GOAL'S PRODUCT GUARANTEE. DO NOT LEAVE THIS EQUIPMENT UNATTENDED.

7. All 4 swivel tires must be locked into frame before attempting to move shelter. A minimum of 4 people are needed to move one shelter. One person on each corner is recommended. Push from end to end, note acceptable directions to push below.

WARNING: DO NOT ATTEMPT TO MOVE SHELTER WITH DOLLY. MOVING SHELTER WITH DOLLY WILL CAUSE INJURY AND/OR DAMAGE.

# WARNING

DO NOT PUT ANY WEIGHT ON SEATING OR STORAGE SHELF WHEN UNIT IS ON WHEELS OR RAISED. UNIT MUST BE ANCHORED AT ALL TIMES.

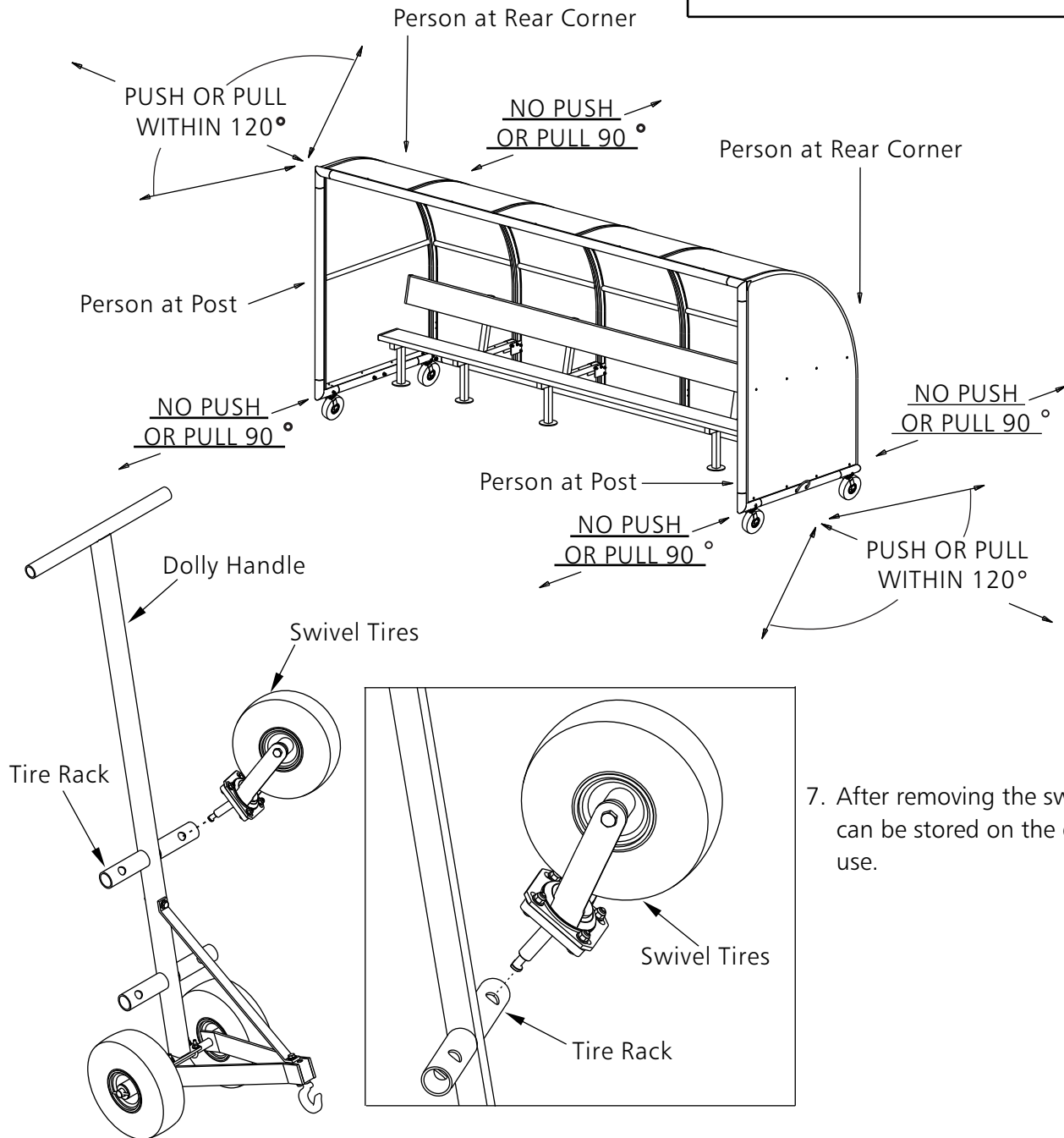

7. After removing the swivel tires they can be stored on the dolly for later use.

Go to [kwikgoal.com](http://kwikgoal.com) for additional product information.

**WARNING**

THIS EQUIPMENT MUST BE STORED IN A SECURED, SHELTERED AREA WHEN NOT IN USE OR IN THE THREAT OF HIGH WINDS. ANY WEATHER DAMAGE TO THIS EQUIPMENT WILL NOT BE COVERED UNDER KWIK GOAL'S PRODUCT GUARANTEE. DO NOT LEAVE THIS EQUIPMENT UNATTENDED.