

# 9931XX - PROTECTIVE PADS

SET OF PROTECTIVE PADS FOR No. 889-1 AND 999 JUDGE'S STANDS

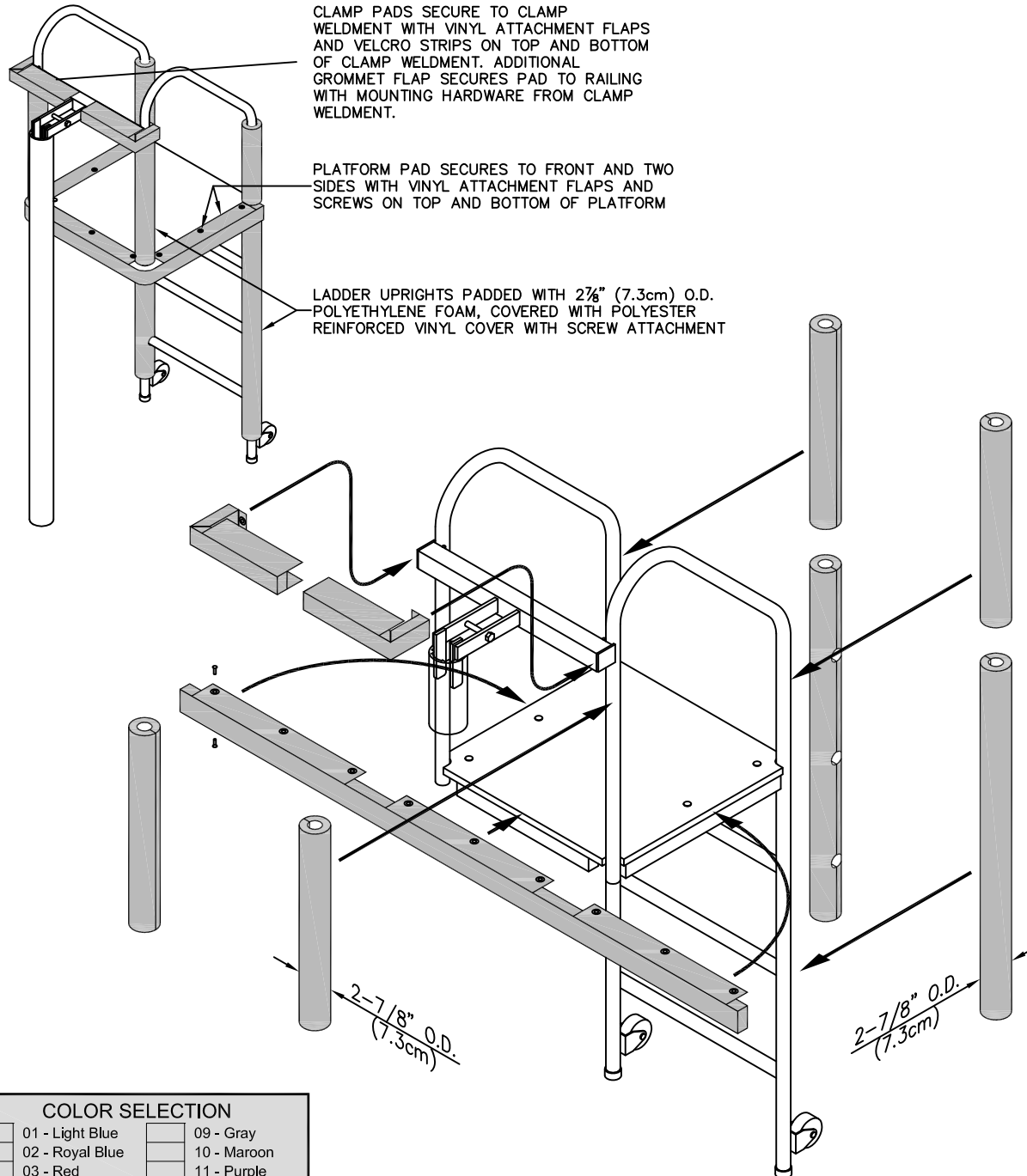

## COLOR SELECTION

01 - Light Blue	09 - Gray
02 - Royal Blue	10 - Maroon
03 - Red	11 - Purple
04 - White	12 - Black
05 - Orange	13 - Navy Blue
06 - Yellow Gold	14 - Kelly Green
08 - Tan	15 - Dark Green

- 9931XX SET OF PROTECTIVE PADS FOR No. 889-1 AND 999 JUDGE'S STANDS - SPECIFY COLOR

**Porter**<sup>®</sup>

888-277-7778 PORTER@PORTERATHLETIC.COM  
© COPYRIGHT 2017 PORTER ATHLETIC - ALL RIGHTS RESERVED

PROJECT NUMBER

PROJECT NAME

**Porter**

WWW.PORTERATHLETIC.COM/FACILITY

VOLLEYBALL SPECIFICATION SHEET

V-993-1

11/13/2017

# 9931XX - PROTECTIVE PADS

SET OF PROTECTIVE PADS FOR No. 889-1 AND 999 JUDGE'S STANDS

## SPECIFICATIONS

### PORTER No. 9931XX SET OF PROTECTIVE PADS FOR No. 00889100 AND 00999-000 JUDGE'S STANDS

Pads recommended for use on No. 00889-100 and 00999-000 Judge's Stands for player safety as required for all competition volleyball activities.

Set of pads shall consist of a wrap around platform pad (1), ladder upright pads (2), railing pads (4), and clamp pads (2).

Wrap around platform pad shall be of 1-1/4" (3.2cm) thick polyethylene shock absorbing foam, covered in a polyester reinforced vinyl cover, with grommet flaps for securing to wood platform by means of phillips, flat-head wood screws. Pad shall cover the front and two side edges of the platform.

Clamp pads shall be of 1-1/4" (3.2cm) thick polyethylene shock absorbing foam, covered in a polyester reinforced vinyl cover, with Velcro flaps for securing to clamp weldment. Grommet flap shall be provided for securing to railing by means of mounting hardware from clamp weldment.

Ladder upright and front railing pads shall consist of 2-7/8" (7.3cm) O.D. shock absorbing polyethylene foam with special Velcro-attached, red polyester reinforced vinyl covers.

Protective pads meet the latest requirements as specified by the USAV, NFHS, and NCAA for player protection and safety.